

EUROMATIC



1500W Ceramic Fan Heater with Oscillation

USER MANUAL

Model Number CH15M

After Sales Support

☎ (AU) 1300 886 649 (NZ) 0800 836 761 | 🌐 tempo.org/support



Contents

Important Safety Instructions	3
Product Overview	6
Getting Started	7
Operating Instructions	9
Other Useful Information	11

Important Safety Instructions

READ CAREFULLY AND KEEP FOR FUTURE REFERENCE

Read this manual thoroughly before first use, even if you are familiar with this type of product. The safety precautions enclosed herein reduce the risk of fire, electric shock and injury when correctly adhered to. Make sure you understand all instructions and warnings. Keep the manual in a safe place for future reference, along with any warranty information, your purchase receipt and packaging. If you sell or transfer ownership of this product, please pass on these instructions to the new owner.

Always follow basic safety precautions and accident prevention measures when using an electrical appliance, including the following:

Electrical safety and cord handling

- **Voltage:** Before plugging in the heater, make sure your outlet voltage and circuit frequency correspond to the voltage stated on the rating label.
- **Electrical circuit:** Always plug this heater into a separate wall outlet socket. Use a safe socket with an earthed connection. To ensure you do not overload the circuit, do not operate another high-wattage product on the same circuit.
- **Connection:** To insert the plug, grasp it firmly and guide it into the outlet.
- **WARNING! No no extension cord:** Do not use the heater with a power board, adaptor or extension cord as these may overheat and create a fire risk.
- **Protect the power cord:**
 - – Do not operate the heater with the cord coiled up; always fully unwind.
 - – Do not twist or kink the cord or let it touch heated surfaces.
 - – Do not put any stress on the cord where it connects to the product.
 - – Never pull/carry the heater by the cord.
 - – Arrange the cord away from any traffic areas so no one will trip over it.
 - – Do not run the cord under carpeting or cover it with rugs, runners, etc.
- **WARNING! To reduce the risk of fire, electric shock or injury:**
 - – Never touch the heater with wet or damp hands or feet.
 - – Do not use the heater if any part of it has become wet. Immediately call a qualified service technician to inspect the heater and replace any part of the electrical system that has got wet.
 - – Never spill liquid into the heater; never immerse the cord, plug or any part of the appliance in water or other liquids.
 - – Do not reach for an appliance that has fallen into water; switch off and unplug immediately.
- **Damaged cord:** Check the power cord regularly for visible damage. If the cord is damaged, it must be replaced by the manufacturer or appropriately qualified personnel in order to avoid any hazards.
- **WARNING! Damaged heater:** Do not use this heater if there are visible signs of damage to the heater, after it malfunctions, or after it has been dropped or damaged in any manner.

Important Safety Instructions (Cont.)

- **Plug:** It is normal for the plug to feel warm; however, a loose fit between the AC outlet and plug may cause overheating and distortion of the plug. Contact a qualified electrician to replace a loose outlet.
- **After use:** Switch off and unplug the heater from the power outlet when it is not in use and before cleaning, servicing, moving or storing it. To disconnect, switch off the heater, then remove the plug from the outlet. Grip the plug, do not pull the cord.
- **Safety switch:** Unless your home is already fitted with a residual current device (safety switch), we recommend installing an RCD with a rated residual operating current not exceeding 30mA, to provide additional safety protection when using electrical appliances. See your electrician for professional advice.

Usage conditions and restrictions

- **Domestic use only:** This heater is intended only for the heating of indoor living spaces and only for domestic use. It is not suitable for commercial, industrial or trade use.
- **WARNING! Space heating only:** Do not use the heater to dry or heat clothing, shoes, pipes or any other item, or for anything other than its intended use. Only use it as described in this manual. Any other use is not recommended and may cause fire, electric shock or injury.
- **No outdoor use:** Do not use this appliance outdoors or on wet surfaces.
- **Altitude:** This appliance is not intended for use at altitudes exceeding 2000m.
- **Protect from moisture:** This appliance is not intended for use in bathrooms, laundry areas and similar indoor locations. Never locate this appliance where it may fall into a bathtub or otherwise become exposed to water. Never place containers filled with liquid, such as drinking glasses, vases, etc. on the heater.
- **Ventilation:** Only use this heater in a well ventilated area.
- **Openings:** To prevent a possible fire, do not insert fingers or allow objects to enter any ventilation or exhaust openings. Do not block air intakes or exhaust openings. Keep the heater clean. Keep objects at least 1.5m from the front and 0.5m from the back of the appliance.
- **WARNING! No external timer:** Never operate the heater on a program switch, external timer switch or any other appliance for automatic operation, as there is a risk of fire if the heater is covered or positioned incorrectly. In order to avoid a hazard due to inadvertent resetting of the thermal cut-out, do not connect it to a circuit that is regularly switched on and off by your energy provider.
- **Children:** Do not let children operate the heater, supervise children at all times when the heater is in use. Do not let children or animals touch or play with the heater. The air outlet gets hot during operation. Close supervision is necessary when any appliance is used by or near children.
- **WARNING! Do not leave unattended** during use. Always unplug it.
- **WARNING!** Do not use this heater in small rooms when they are occupied by persons not capable of leaving the room on their own, unless constant supervision is provided.

Important Safety Instructions (Cont.)

- **Usage restriction:** This appliance is not intended for use by persons (including children) with reduced physical, sensory or mental capabilities, or lack of experience and knowledge, unless they have been given supervision or instruction concerning the use of the appliance by a person responsible for their safety.
- **Accessories:** The use of accessory attachments not recommended by the appliance distributor may result in fire, electric shock or personal injury.
- **Location:** Only use the heater in an upright position. Make sure to place it on a horizontal and stable surface; do not place it on a soft surface such as on a bed, sofa or long pile carpet, as this could cause the appliance to tip over.
- **WARNING! To avoid creating a fire risk, do NOT use this heater:**
 - – In front of or immediately below an electrical socket outlet
 - – Close to a radiant heat source
 - – Behind a door
 - – On long pile carpet or a flokati rug
 - – Near a window where it may get splashed with rain
 - – In areas where petrol, paint or other flammable liquids are stored (e.g. in a garage or workshop), as the heater has hot and arcing parts inside which may spark
 - – In the immediate surroundings of a bath, shower or swimming pool.
- **WARNING! To reduce the risk of fire,** keep textiles, curtains, or any other flammable material a minimum distance of 1.5m from the air outlet. Do not place towels or other objects on the heater.
- **CAUTION: Hot!** Some parts of this heater are hot during use and remain hot for some time afterwards. To avoid burns, do not let bare skin touch hot surfaces. Be particularly careful when children and vulnerable persons are present. Always let the heater cool down before touching it, even if it is unplugged.
- **Misuse:** Improper use or installation may result in the risk of fire, electric shock and/or injury. We assume no liability for any eventual damages caused by improper use or incorrect handling.
- **Service:** This heater contains no user-serviceable parts inside. Do not attempt to open and/or repair the heater yourself. Components should only be serviced by a qualified technician. In case of malfunction, disconnect the plug immediately and contact our after sales support line for advice.
- **Installation:** The appliance requires no installation, it should be used solely as a portable appliance.
- **On first use,** the heater may emit some slight odour and/or smoke. This is normal and will only last for a moment. It is no cause for concern. Ensure good ventilation.



WARNING! Do not cover!

In order to avoid overheating and creating a fire risk, do not cover the heater in any manner.

Product Overview

Scope of delivery



Parts of the heater

- 1 Control panel
- 2 Front safety grille
- 3 Ceramic heating elements (behind grille)
- 4 Base

At the back, not visible here:

- 5 Power cord and plug

NOTE:

Due to continued product improvement, images and illustrations in this manual may vary slightly from the product purchased. All images in this manual are for reference purposes only. Parts are not necessarily pictured to scale.

Getting Started

Unpacking

- **Carton:** This product has been packaged to protect it against transportation damage. Unpack the appliance and keep the original packaging carton and materials in a safe place. It will help prevent any damage if the product needs to be transported in the future, and you can use it to store the appliance when it is not in use. In the event that the carton is to be disposed of, please recycle all packaging materials where possible.
- **Plastic wrapping** can be a suffocation hazard for babies and young children, so ensure all packaging materials are out of their reach and disposed of safely.
- **Cord:** Inspect the power supply cord and plug, and all other parts of the appliance, for visual damage. Do not use the appliance if anything appears to be damaged or not working properly. In case of damage, contact our after sales support centre using the details at the bottom of the page.
- **Documentation:** Make sure you have read and understood all instructions and warnings in this manual. Refer to the Product Overview, opposite, to familiarise yourself with the product and identify all parts. Pay particular attention to the safety instructions on the previous pages.
- **Assembly:** This product comes fully assembled and requires no assembly or installation. It is intended solely for portable use. (Portable appliances are not suitable for use in a bathroom.).

Getting Started (Cont.)

Control panel

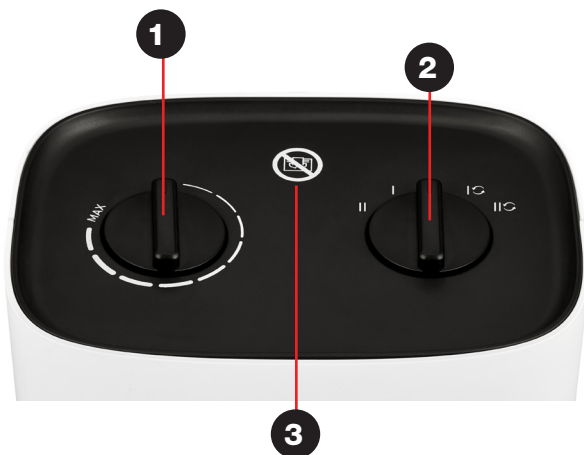

Controls:

- 1 Thermostat dial
- 2 ON/OFF/Power Level dial:
 - [0] - Off
 - [I] - Low fan strength
 - [II] - High fan strength
 - [I C] - Low fan strength with oscillation
 - [II C] - High fan strength with oscillation
- 3 DO NOT COVER symbol (no function)

NOTE:

Due to continued product improvement, images and illustrations in this manual may vary slightly from the product purchased. All images in this manual are for reference purposes only. Parts are not necessarily pictured to scale.

Operating Instructions

FIRST USE

As the appliance and heating coils are supplied with a thin film of grease, there might be a small amount of smoke and odour the first time the appliance is used. This is not harmful to humans and will stop after a short while. Please ensure meanwhile that there is sufficient ventilation.

NOTE: This smoke may adversely affect the health of birds and some small pets, so it is recommended that this heater not be used around birds or small pets during its initial use until the smoke and odour dissipate.

Using the heater

Location

- Place the heater in an upright position on a firm, level, dry and heat-resistant surface, taking into considering all relevant safety information on the previous pages.
- Ensure that there is a minimum space of 50cm from the wall, fixtures and other appliances and at least 1.5m at the front of the heater to exclude the risk of fire.
- Do not place the heater in a hot, wet or very damp environment or in the vicinity of flammable materials.
- The mains socket must be easily accessible so that in an emergency the mains power cable can be easily disconnected.

Connection

- Plug the heater into a suitable power point and switch on power to the outlet.
- Always use a separate socket that has no other high wattage appliances connected at the same time – do not plug it into a power board or socket adaptor; do not use an extension cord.

Switching on/off

- Once the appliance is plugged in, turn the thermostat switch to the maximum position, before turning the heat select dial to the desired level.
- To switch the device off, turn the thermostat to the lowest position, and turn the heat select dial to the “0” position.

Operating Instructions (Cont.)

Fan strength

- When turning the heat select dial to the [I] position, the heater blows warm air, working at a lower fan strength.
- When turning the heat select dial to the [II] position, the heater blows warm air, working at a higher fan strength.
- When turning the heat select dial to the [I ☺] position, the heater blows warm air, working at a lower fan strength while oscillating.
- When turning the heat select dial to the [II ☺] position, the heater blows warm air, working at a higher fan strength while oscillating.

Temperature adjustment

- Turn the thermostat dial to its maximum position (clockwise).
- When the room reaches the desired temperature, turn the thermostat dial anti-clockwise slowly, until the appliance switches off. The thermostat switch will then maintain the desired room temperature automatically.
- If you wish to change the temperature, you can turn the thermostat knob either anti-clockwise or clockwise to make the temperature lower or higher.

Other Useful Information

Safety features

- The heater has a **tip-over safety switch**, which will turn off the heater and sound an alarm if it is knocked over or if it is not in the upright position. Should this occur, stand the heater upright again but take extreme care as it may still be hot. Before restarting the heater, inspect it for damage. Do not operate the heater if any damage is visible.
- The unit is equipped with an **overheat protection mechanism** which shuts off the heater automatically in case of overheating. The most common cause of overheating is deposits of dust or fluff in the appliance. Ensure these deposits are removed regularly by unplugging the appliance and vacuum cleaning air vents and grilles.

Should the overheat protection be triggered, switch off the heater, unplug it and let it cool down completely. Remove any obstruction. Plug the heater in again and operate as normal, making sure that there is sufficient room all around the heater, and nothing is covering or obstructing the air outlet or intake.

CAUTION!

Always switch off and disconnect the appliance from the power supply before attempting any maintenance or cleaning the heater.

Troubleshooting

If your heater fails to operate, or you experience any other problem with the appliance, contact our after sales centre for advice or to arrange a service. Before phoning for a service, please ensure that:

- Your heater is properly plugged in.
- The outlet is working and the circuit breaker or fuse are also working properly.

Other Useful Information (Cont.)

Cleaning and maintenance

The heater requires regular cleaning to ensure trouble-free operation.

- Before cleaning your heater, switch off the heater and allow it to cool. Disconnect the electricity supply to the appliance.
- Use a vacuum cleaner to remove dust and fluff from around the grilles.
- Use a damp cloth (not wet!) to wipe the exterior of the heater to remove dust and dirt. Allow some time for the heater to dry thoroughly before reconnecting it to the power supply.
- Do not use harsh detergents, abrasive cleaning powders, petrol or furniture polish.
- Do not immerse the cord, plug or heater in water or other liquid for cleaning. Do not allow water to enter the heater.

Storage

- If you are not going to use the heater for an extended period of time, please unplug it from the power supply.
- Store the heater in its original carton (or cover it with some material or plastic bag) to protect it from dust.
- Store the heater in a cool, dry place, out of children's reach.

Servicing

- If your heater requires servicing, please contact our after sales support centre using the details at the bottom of the page.
- If the power cord is damaged and needs replacing, it must be replaced by a service agent or equivalent qualified person in order to prevent a hazard.

CAUTION!

Do not attempt to open the heater and repair it yourself. Any repairs must be carried out by a qualified technician.

Other Useful Information (Cont.)

Technical specifications

Model No	CH15M
Rated Power	1500W
Rated Voltage	220-240V~, 50-60Hz
Safety Features	Tip-Over Safety Switch Overheat Protection
Dimensions	237 (H) x 128 (W) x 175 (D) mm (approx.)
Weight	1.5kg (approx.)



CLASS II - DOUBLE INSULATED APPLIANCE

This symbol indicates that the appliance has been designed in such a way that it does not require a safety connection to electrical earth (ground).

Compliance

This appliance has been fully tested and meets all requirements as set out by standards AS/NZS 60335.1 and AS/NZS 60335.2.30.



The RCM Mark (Regulatory Compliance Mark) indicates that the product complies with the relevant guidelines of the ACMA as well as corresponding government requirements for the safety of electrical devices.

Responsible disposal



Packaging materials are recyclable. Please dispose of them responsibly for recycling.



At the end of its working life, do not throw this appliance out with your household waste. Electrical and electronic products contain substances that can have a detrimental effect on the environment and human health if disposed of inappropriately. Observe any local regulations regarding the disposal of electrical consumer goods and dispose of it appropriately for recycling.

Contact your local authorities for advice on recycling facilities in your area. Or find recycling scheme services listed on Planet Ark's website at www.recyclingnearyou.com.au, or call Planet Ark on 1300 733 712.

After Sales Support

☎ (AU) 1300 886 649 (NZ) 0800 836 761 | 🌐 tempo.org/support

This page has been left blank intentionally.

This page has been left blank intentionally.

Warranty returns

Should you for any reason need to return this product for a warranty claim, make sure to include all accessories with the product.

Product does not work?

If you encounter problems with this product, or if it fails to perform to your expectations, make sure to contact our After Sales Support Centre on (AU) 1300 886 649 or (NZ) 0800 836 761 for advice.

Distributed by Tempo (Aust) Pty Ltd ABN 70 106 100 252

PO BOX 132, Frenchs Forest NSW 1640, Australia

Customer Helpline:

(AU) 1300 886 649 (NZ) 0800 836 761

Web Support: tempo.org/support

For an electronic copy of this manual, please contact our after sales support centre.