

LUGNA

FORM & FUNCTION

ASSEMBLY INSTRUCTIONS

Corner Shell

HEIGHT	DEPTH
2048mm	380mm

HEIGHT	DEPTH
2048mm	580mm

LUGNA understands the importance of timeless style and practical durability for a home's form and function. Our European-inspired collection is simple and easy to use, with five modern colours that complement any style and space. LUGNA's modular system allows for endless configurations and additions, with various-sized cabinets, drawers, shelving, and hinged doors that can be combined to create a bespoke look on any budget. Whether you're looking for something modern and sleek or classic and elegant, LUGNA has something for everyone.



SCAN for
more info

10 YEAR
WARRANTY



⚠ WARNING

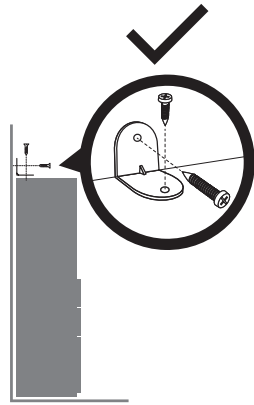

Children have died from furniture tipover.

- ALWAYS secure this furniture with an anchor device.
- NEVER allow children to stand, climb or hang on drawers, doors or shelves.
- Never open more than one drawer at a time.
- Place heavy items down low.

NEVER put a TV
on this furniture.



Serious injury or death can be caused by toppling furniture. Attach this unit to the wall using the safety bracket anchor device provided. Fix bracket to the middle of the unit with 16mm screw (provided) and use a suitable wall fixing (not supplied) to fix L-bracket to wall.

What you will need



Includes



22x

Cam Lock
Screws



22x

Cam Lock
Nuts

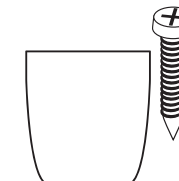

6x

Foot
Mounts

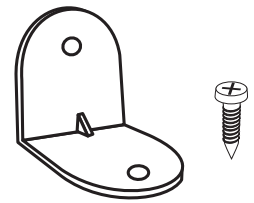

1x

Safety
Bracket

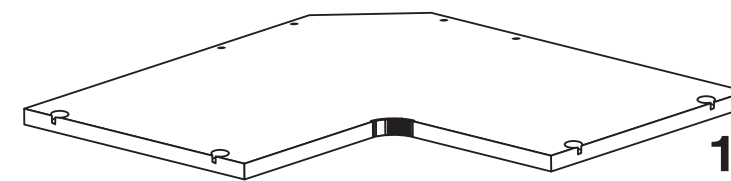

1x Top Panel

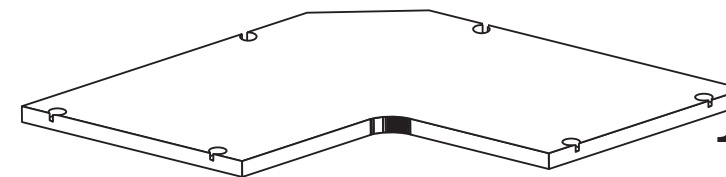

1x Fixed Shelf

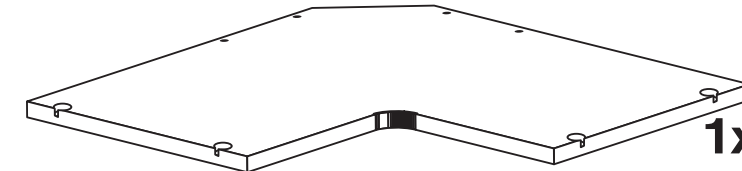

1x Base Panel

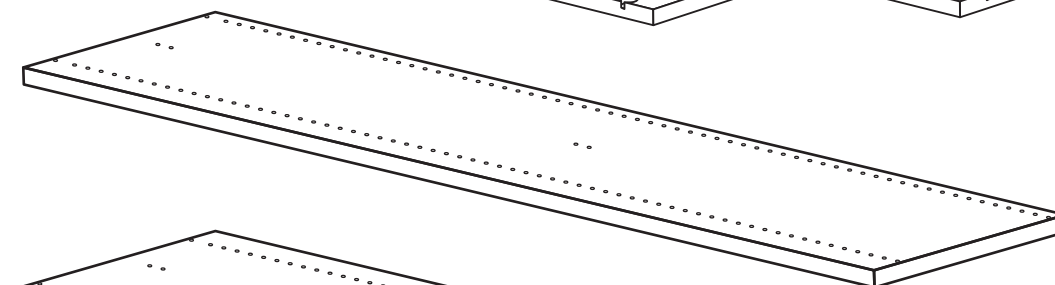

1x Left Side Panel

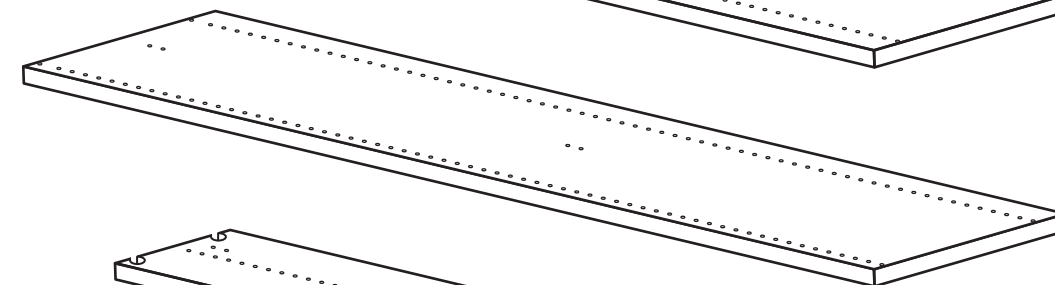

1x Right Side Panel

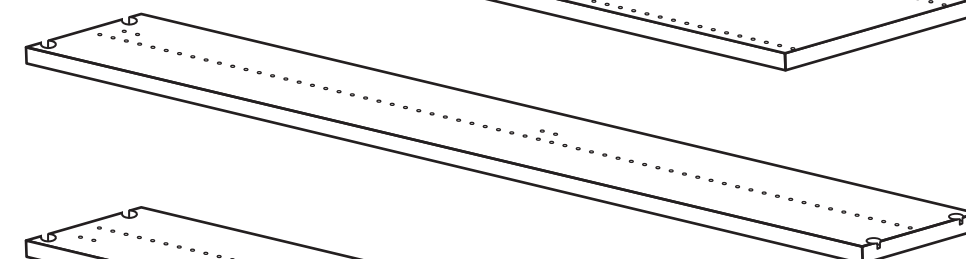

1x Left Back Panel

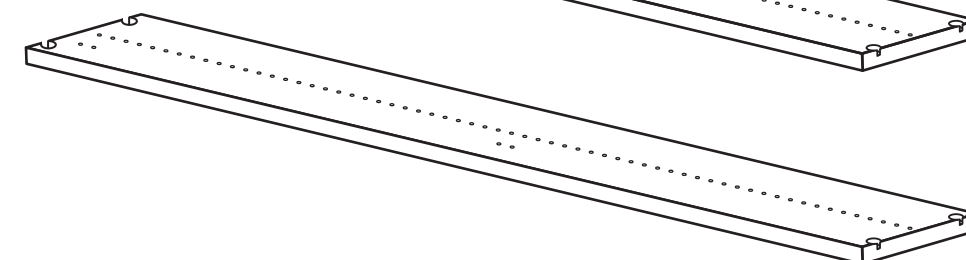

1x Right Back Panel

Carpet Floors

When placing the cabinet on carpet, the carpet can prevent the bottom drawers or doors from opening. To fix this, install the optional foot mounts.

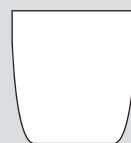

4x

Foot Mounts

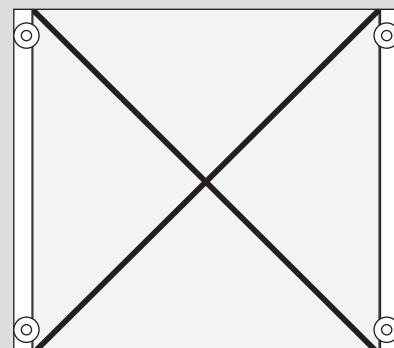

WARNING!
Do not screw
foot mounts
to the base.
Fix to cabinet
sides as
shown.

STEP 1

1x Top Panel

1x Base Panel



8x



8x

8x

8x

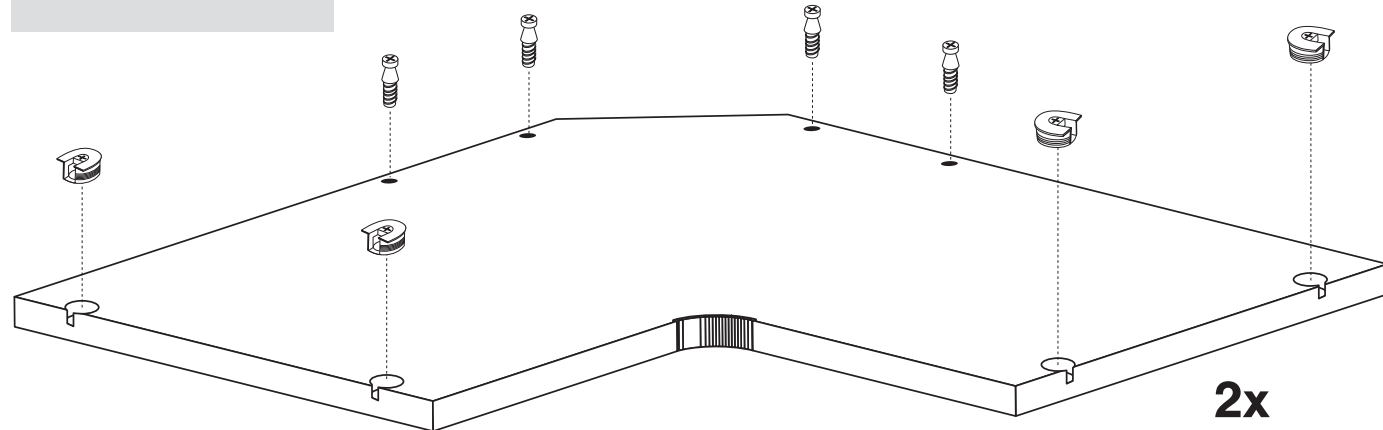
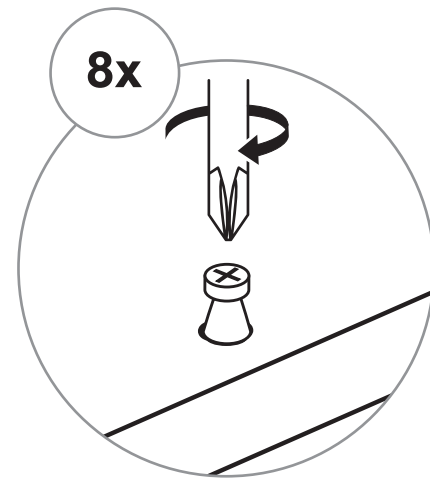

2x

STEP 2

1x Fixed Shelf



6x

6x

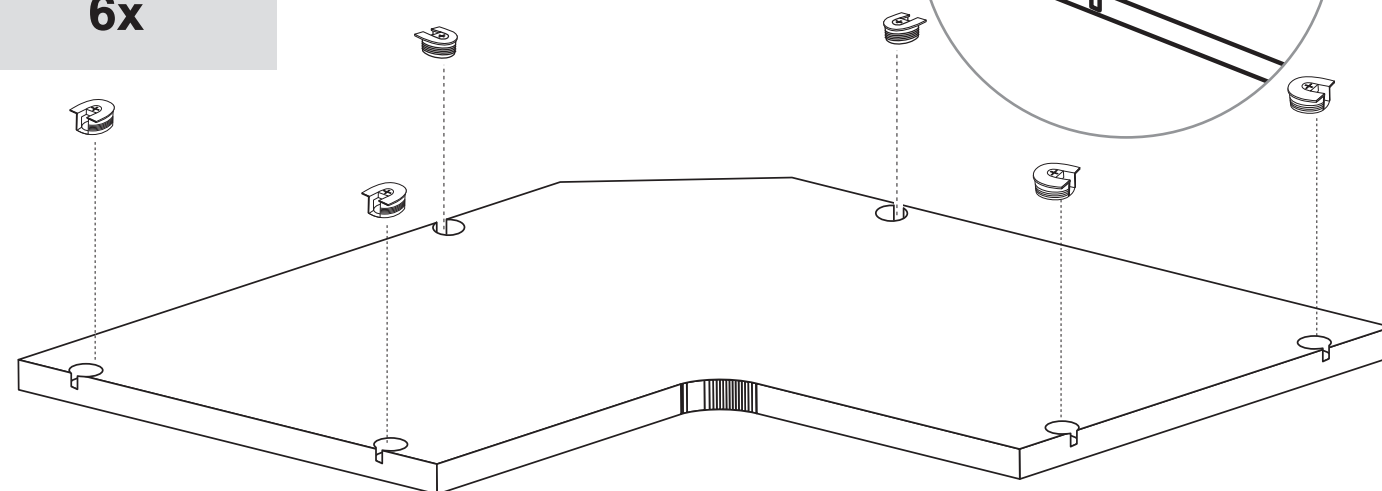
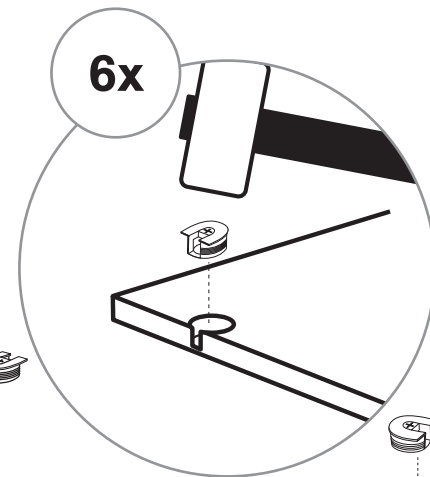

STEP 3



14x



8x

8x

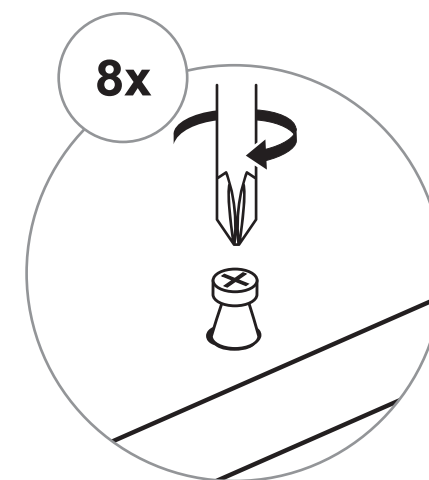

6x

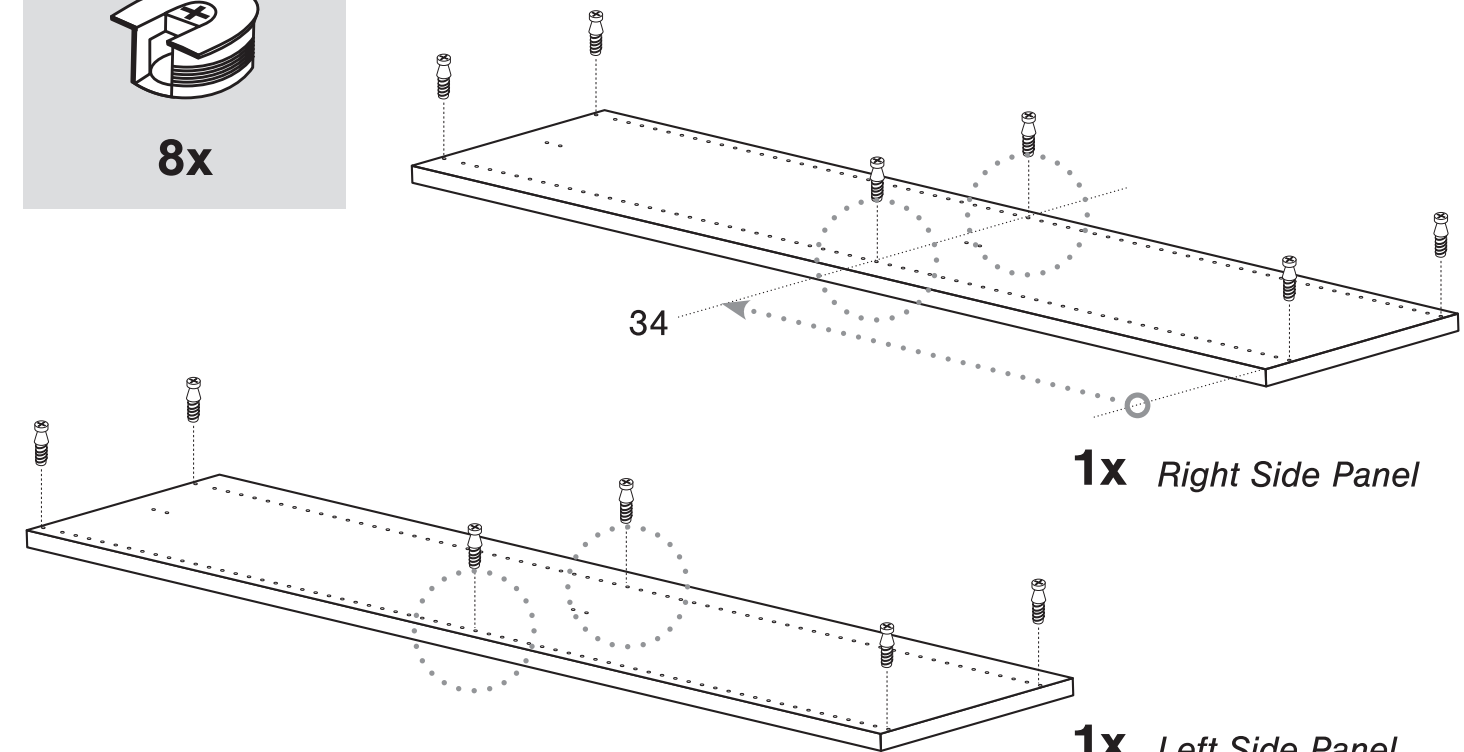
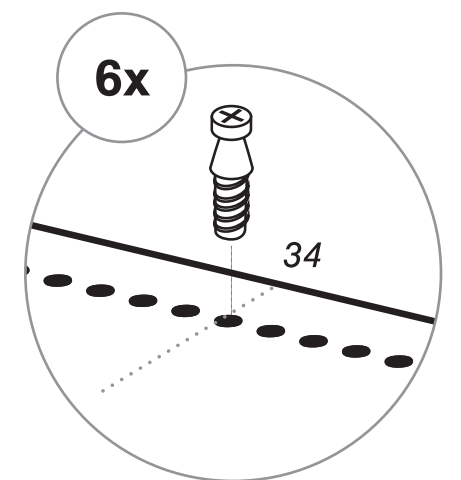

1x Right Side Panel

1x Left Side Panel

8x

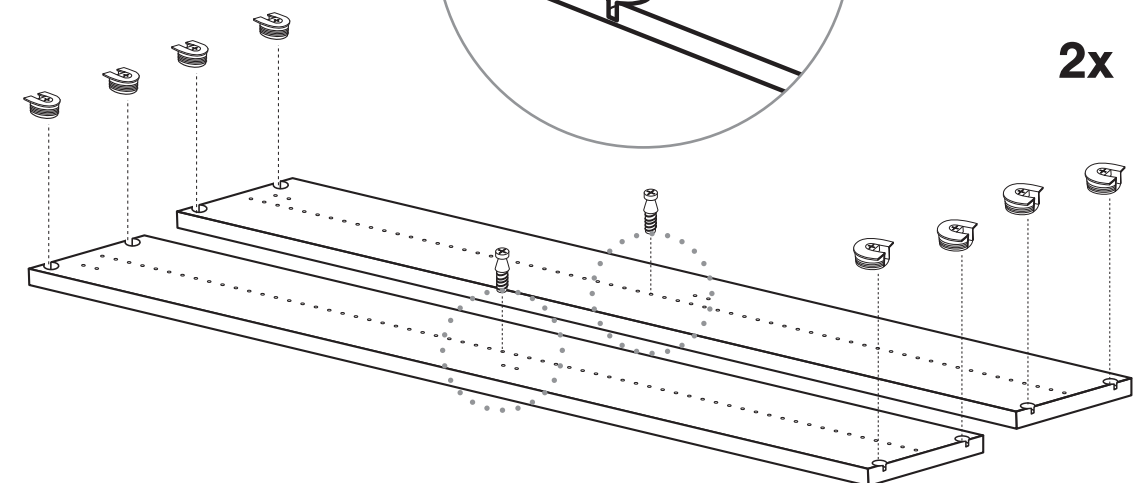
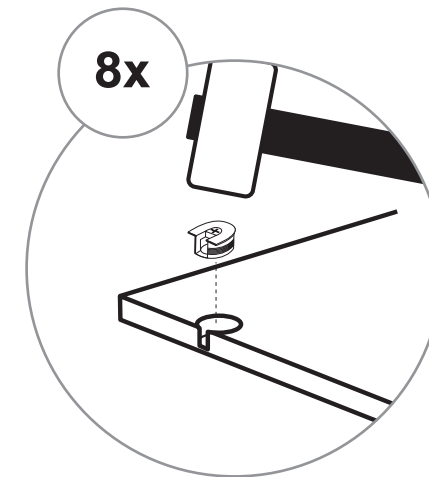

2x Back Panels

STEP 4

1x Base Panel

1x Fixed Shelf

1x Top Panel

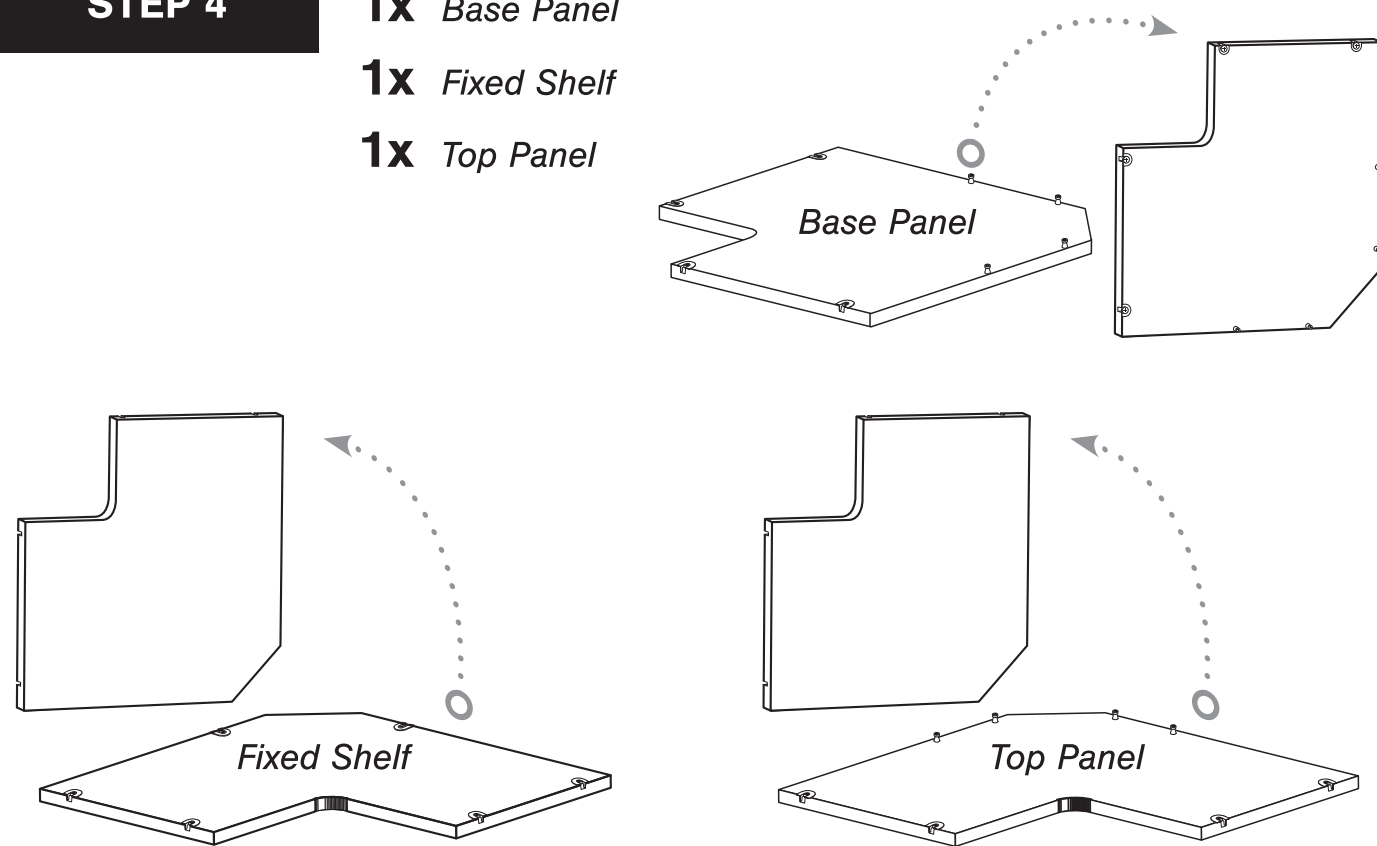

Note — If using the 4 shelf insert kit do not install the middle fixed shelf.

STEP 5

1x Right Side Panel

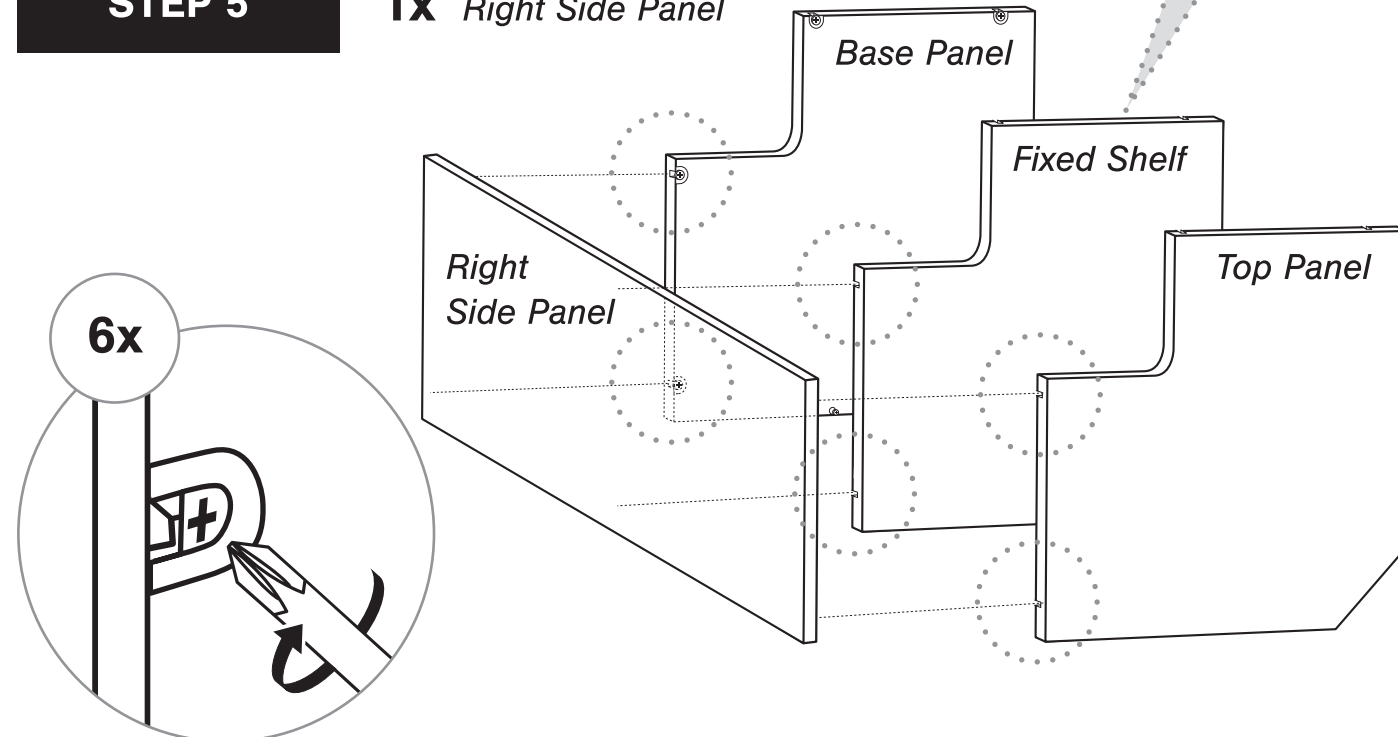

STEP 6

1x Left Side Panel

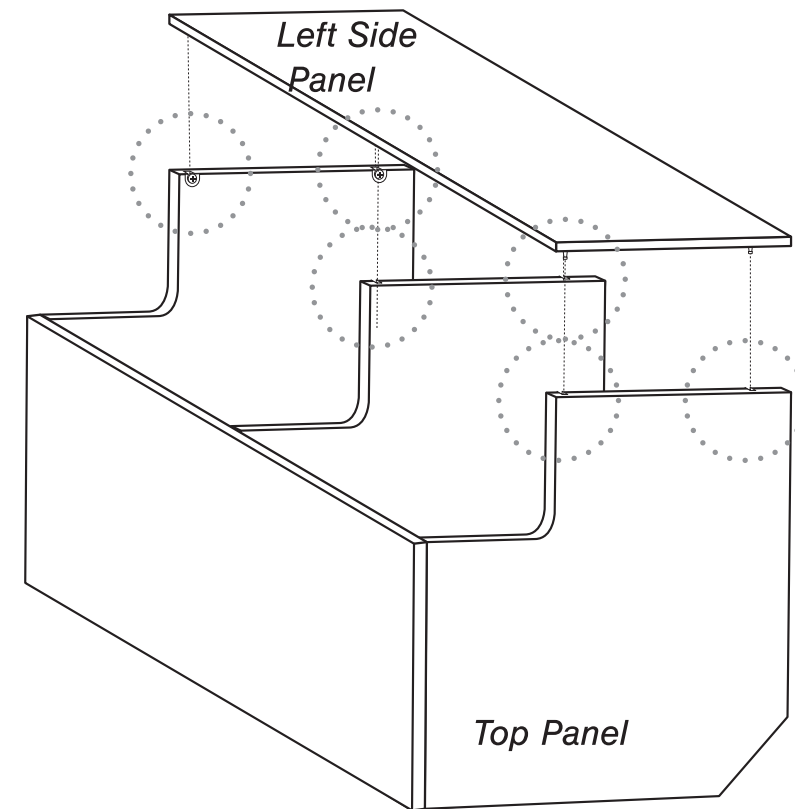

6x

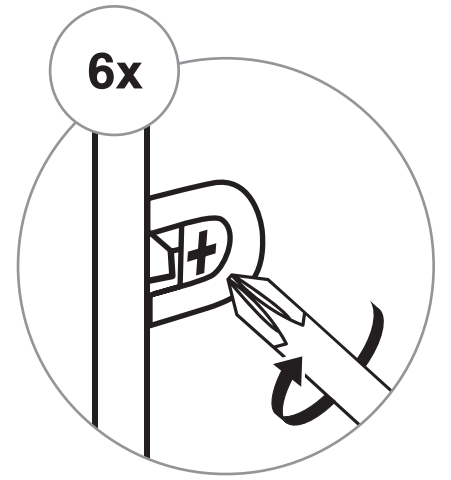

STEP 7

1x Left Back Panel

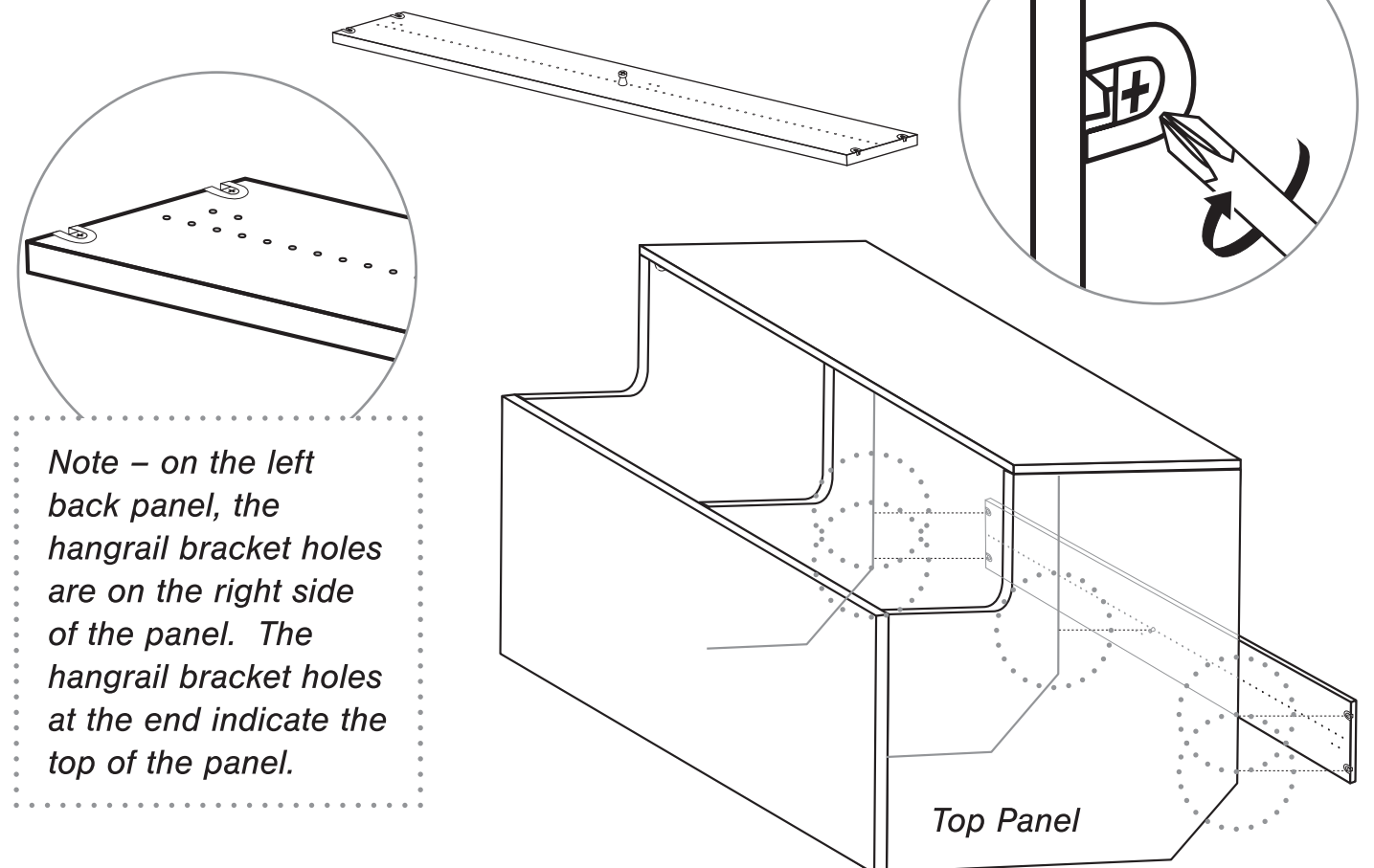

5x

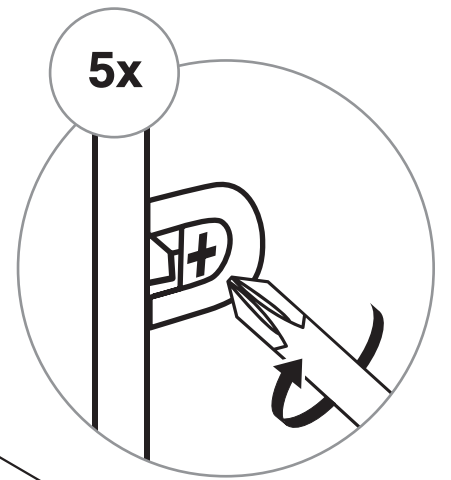

Note – on the left back panel, the hangrail bracket holes are on the right side of the panel. The hangrail bracket holes at the end indicate the top of the panel.

STEP 8

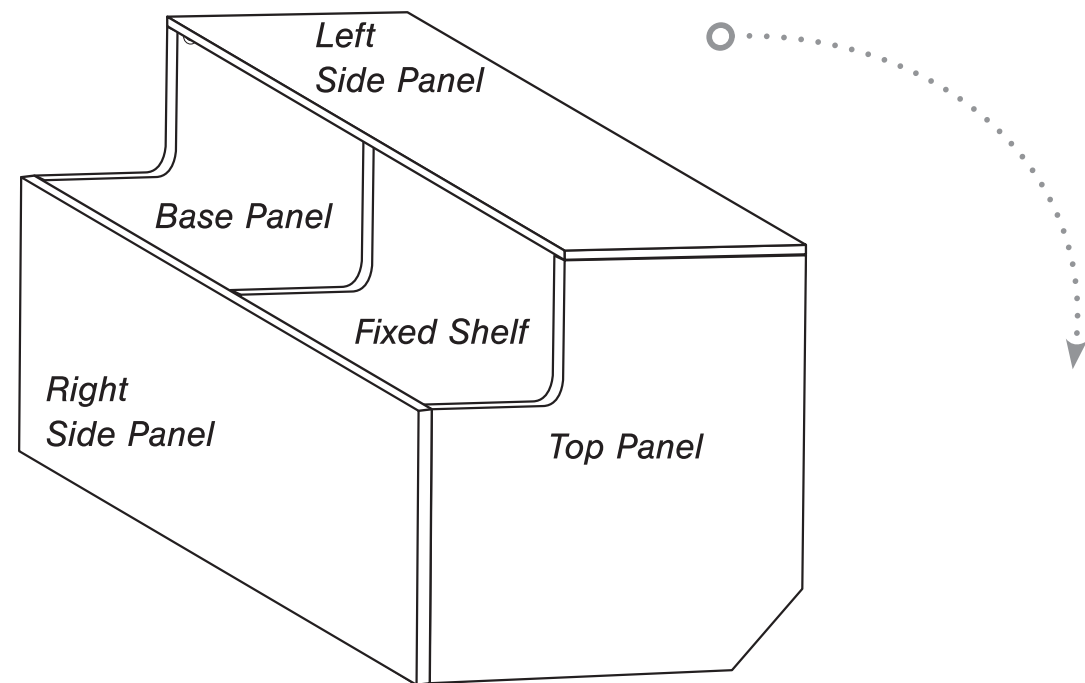

STEP 9

1x Right Back Panel

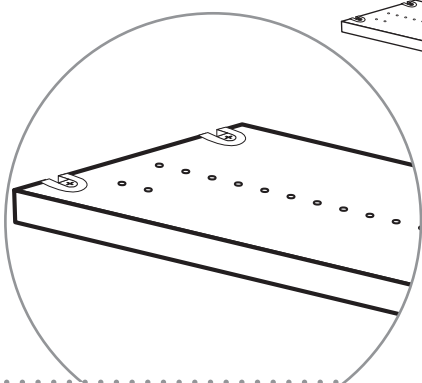

Note – on the right back panel, the hanging bracket holes are on the left side of the panel. The hanging bracket holes at the end indicate the top of the panel.

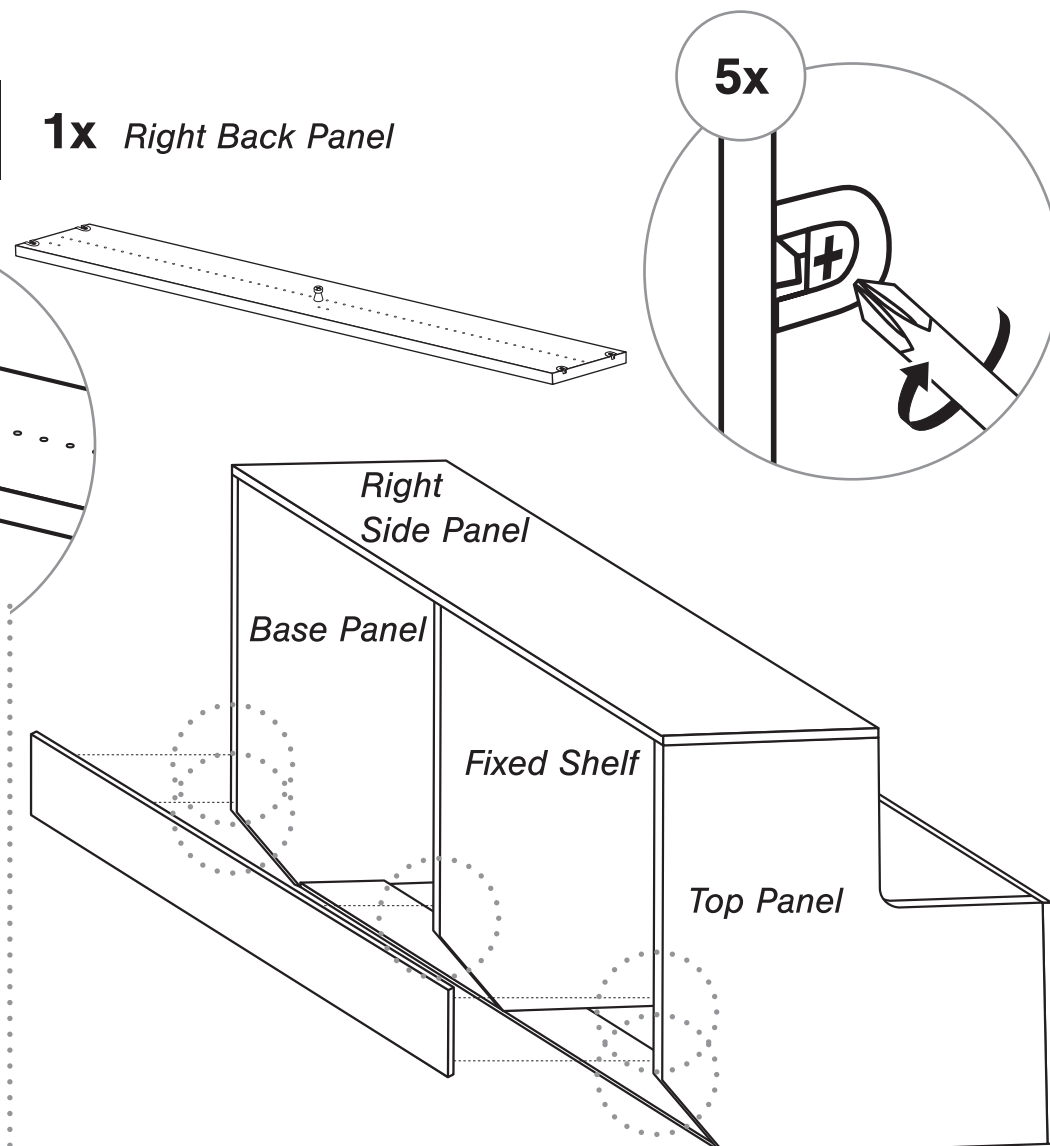

STEP 10

Stand the cabinet upright.

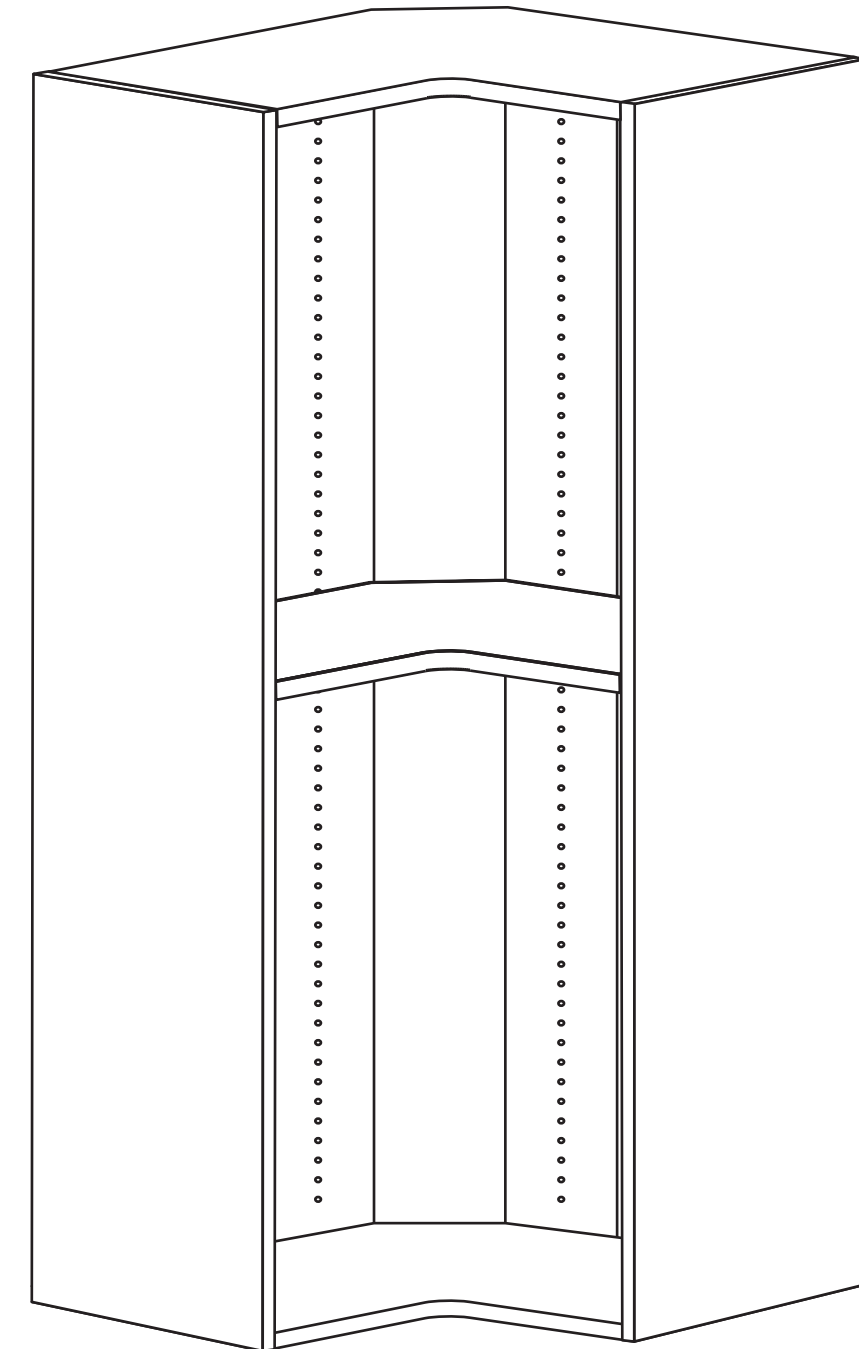

WARNING

The assembled cabinet will be heavy.

For your safety, a minimum of two people is recommended to lift the cabinet upright. Bend your knees and lift with your legs - not your back!

LUGNA

FORM & FUNCTION

CABINET CARE INSTRUCTIONS

Everyday care for your cabinets:

Liquid spills should be cleaned up as they occur. Liquids and other damp objects, i.e. towels, will eventually cause permanent damage should they be left unattended.

Everyday clean-up of cabinets can be done with a damp cloth and a dry cloth. Ensure you use a clean cloth every time when wiping down your cabinets, as foreign dirt, grease, and oils may inadvertently be transferred to the surface.

Cleaning melamine products:

Oils, grease, and other soils that do not respond to water can be removed with a solution of mild soap and water. The surface should be rinsed immediately with a clean, damp cloth and dried thoroughly with a soft cloth to avoid streaking or moisture seeping into the seams around the edges.

PLEASE NOTE: Never use abrasive cleaners, ammonia, bleaching agents, scouring pads or powdered cleaners on any type of cabinetry.

Cleaning cabinet hardware:

Brass and Silver cleaners are not recommended for cleaning handles. Some of these cleaning solutions contain harsh chemicals that may damage the finish on your handles.

Wash your hardware with a solution of warm water and a small amount of mild dish detergent. Dry your hardware and areas around the cleaned area immediately.

Hinges can be cleaned with a dry cloth or cotton-tipped swab.