



### Product Description

The WallDriller™ is designed to offer you the maximum: A fine centered point that helps guide the anchor into the wall with flawless precision. A sharp cutting edge that reduces the force required to cut the material, making it a self-drilling anchor without pre-drilling. Also, a sharp profile thread that cuts deeply into the hole to ensure maximum holding power and stability.

### Features & Benefits

- ▶ Fast and easy to install
- ▶ No pre-drilling, the only tool required is a screwdriver
- ▶ Designed to install smoothly and easily through drywall
- ▶ Can easily be removed
- ▶ Available material: Zinc and nylon
- ▶ Note: Not recommended for ceiling applications.

### Perfect for:



Curtains, fire alarms, shelving, verticals, wall decorations, Etc.

### Packagings



## WallDriller



### Product sizes & Materials

- # 6 Nylon
- # 8 Long Nylon
- # 6 Zinc
- # 8 Short Zinc
- # 8 Long Zinc

### Suitable Base Materials

- ▶ Drywall 3/8"
- ▶ Drywall 1/2"
- ▶ Wallboard 10 mm
- ▶ Wallboard 13 mm
- ▶ Plywood
- ▶ Pegboard

Hollow Wall Anchors



### Load Capacities

Material	Size	Material	PULL MAX lbs	PULL SAFE lbs	SHEAR MAX lbs	SHEAR SAFE lbs	PULL MAX kg	PULL SAFE kg	SHEAR MAX kg	SHEAR SAFE kg
Drywall 3/8	# 6	Nylon	40	20	92	46	18	9	42	21
	# 8 Long	Nylon	45	23	100	50	20	10	45	23

Material	Size	Material	PULL MAX lbs	PULL SAFE lbs	SHEAR MAX lbs	SHEAR SAFE lbs	PULL MAX kg	PULL SAFE kg	SHEAR MAX kg	SHEAR SAFE kg
Drywall 1/2	# 6	Nylon	45	23	103	52	20	10	47	23
	# 8 Long	Nylon	50	25	110	55	23	11	50	25

•Allowable load capacities are calculated using applied safety factor of 2.0 in the SAFE column.  
 •We recommend to use that load in order to be safe.

### Tools required



No Pre-Drilling  
 Screw Driver: # 2 Phillips

### Installation instructions

1. Point the WallDriller™ the wall using only a screwdriver.
2. Turn clockwise until flush with surface and firmly in place. (Do not over torque)
3. Insert the screw in the object you need to afix and turn clockwise until firmly in place.

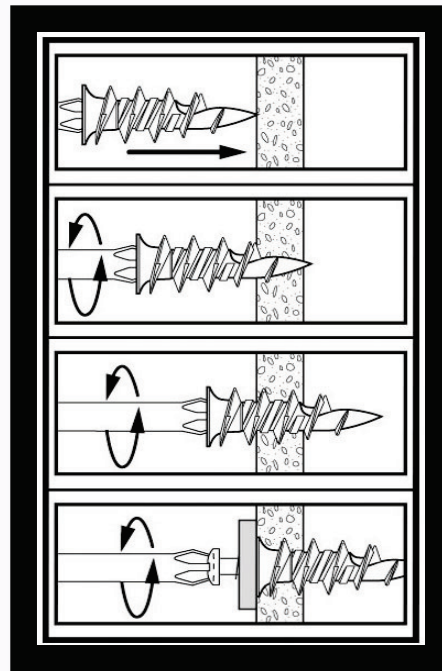

Hollow Wall Anchors