

# ozito

## CORDLESS PRUNER

**3.6V Lithium Ion**

**INSTRUCTION MANUAL**

### SPECIFICATIONS

Input:	3.6V
Battery:	1.5Ah Li-Ion
Max. Cutting Cap.:	Ø12mm
Cutting System:	Bypass
Charge Time:	3 Hours
Tool Weight:	0.6 kg

[ozito.com.au](http://ozito.com.au)

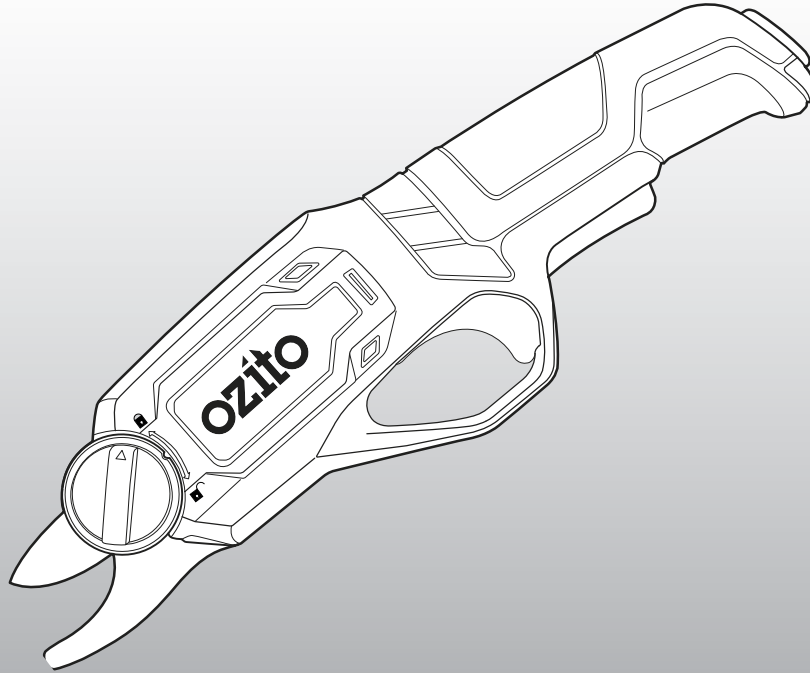

### STANDARD EQUIPMENT



Cordless Pruner



Blade Cover



AC Charging Adaptor

**3** YEAR REPLACEMENT WARRANTY

**OCPS-036**

## WARRANTY

IN ORDER TO MAKE A CLAIM UNDER THIS WARRANTY YOU MUST RETURN THE PRODUCT TO YOUR NEAREST BUNNINGS WAREHOUSE WITH YOUR BUNNINGS REGISTER RECEIPT. PRIOR TO RETURNING YOUR PRODUCT FOR WARRANTY PLEASE TELEPHONE OUR CUSTOMER SERVICE HELPLINE:

**Australia 1800 069 486**

**New Zealand 0508 069 486**

TO ENSURE A SPEEDY RESPONSE PLEASE HAVE THE MODEL NUMBER AND DATE OF PURCHASE AVAILABLE. A CUSTOMER SERVICE REPRESENTATIVE WILL TAKE YOUR CALL AND ANSWER ANY QUESTIONS YOU MAY HAVE RELATING TO THE WARRANTY POLICY OR PROCEDURE.

The benefits provided under this warranty are in addition to other rights and remedies which are available to you at law.

Our goods come with guarantees that cannot be excluded at law. You are entitled to a replacement or refund for a major failure and for compensation for any other reasonably foreseeable loss or damage. You are also entitled to have the goods repaired or replaced if the goods fail to be of acceptable quality and the failure does not amount to a major failure.

Generally you will be responsible for all costs associated with a claim under this warranty, however, where you have suffered any additional direct loss as a result of a defective product you may be able to claim such expenses by contacting our customer service helpline above.

### 3 YEAR REPLACEMENT WARRANTY

Your product is guaranteed for a period of **36 months from the original date of purchase**. If a product is defective it will be replaced in accordance with the terms of this warranty. Warranty excludes consumable parts, for example: cutting blade and included accessories.

### WARNING

**The following actions will result in the warranty being void.**

- If the tool has been operated on a supply voltage other than that specified on the tool.
- If the tool shows signs of damage or defects caused by or resulting from abuse, accidents or alterations.
- Failure to perform maintenance as set out within the instruction manual.
- If the tool is disassembled or tampered with in any way.
- Professional, industrial or high frequency use.

# KNOW YOUR PRODUCT

## CORDLESS PRUNER

1. Cutting Blade
2. Fixed Blade
3. Blade Lock
4. LED Work Light
5. On/Off Trigger
6. Sure Grip Handle
7. Safety Switch
8. State of Charge Indicator
9. Charging Socket

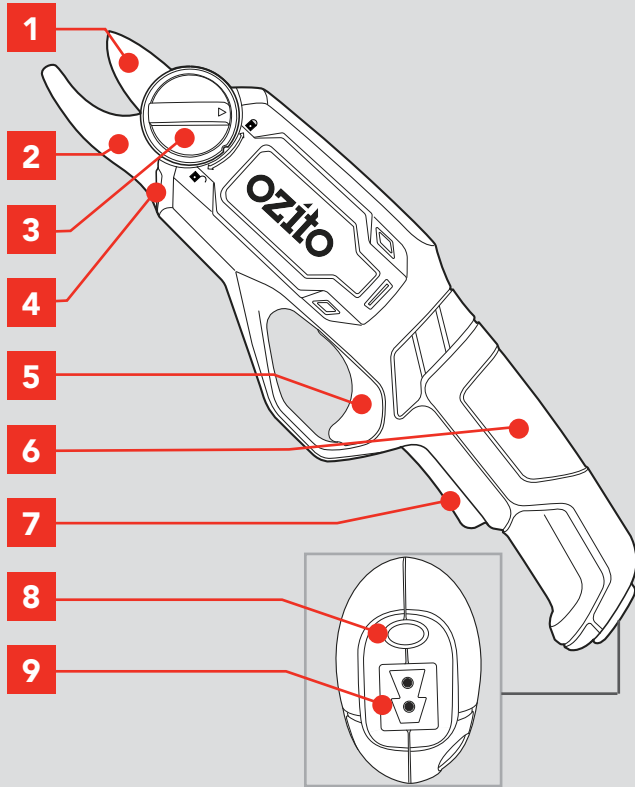

## ACCESSORIES

10. Charger Plug
11. AC Charging Adaptor
12. Blade Cover

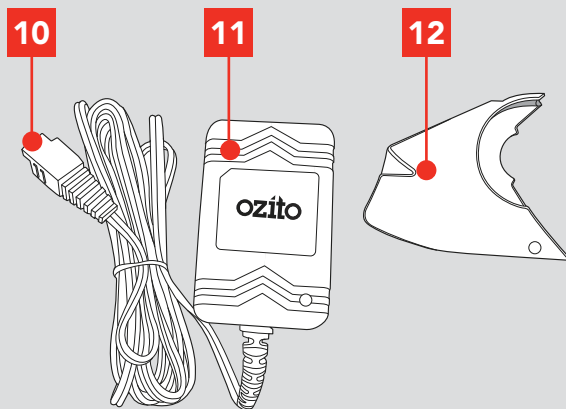

## ONLINE MANUAL

Scan this QR Code with your mobile device to take you to the online manual.



# SETUP & PREPARATION

## 1. BATTERY & CHARGING



**WARNING!** THE POWER SUPPLY FOR THIS CHARGER SHOULD BE PROTECTED BY A RESIDUAL CURRENT DEVICE (RATED AT 30mA OR LESS). A RESIDUAL CURRENT DEVICE REDUCES THE RISK OF ELECTRIC SHOCK.

### Charging your Lithium Ion Battery

The Cordless Pruner's battery has been shipped in a low charge condition, and requires charging prior to use. Allow several cycles of charging and discharging (through use of the pruner) for the battery to reach its optimum performance / runtime.

**Note:** The battery will not develop a memory, it does not have to be fully discharged before recharging.

1. Plug the charger plug into the tools charging socket.

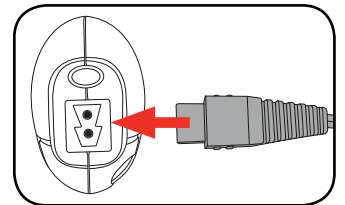

**Note:** The charger plug will only fit the charging socket one way, do not force it if it does not fit first time.

2. Plug the AC charging adaptor into a power outlet and switch on the mains power.

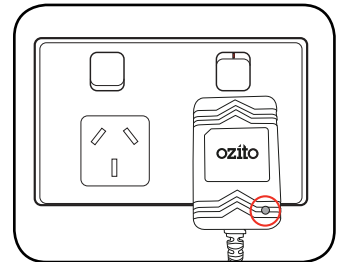

**Note:** The AC charging adaptor light will illuminate when power is being supplied to the charger.

**Note:** During the charging procedure, the handle and the housing of the tool will feel slightly warm to the touch. This is normal.

The pruner state of charge indicator will illuminate red signifying that the battery is charging. Charging will take up to 3 hours depending on the level of charge left in the battery.



Charging is complete when the state of charge indicator illuminates green.



**Note:** Do not use the pruner during the charging procedure.

3. Once the pruning is fully charged, switch the mains power supply off and remove the charger plug from the tool.

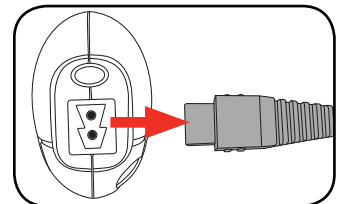

**WARNING!** THIS CHARGER DOES NOT AUTOMATICALLY TURN OFF WHEN THE BATTERY IS FULLY CHARGED. SWITCH OFF AND UNPLUG THE AC CHARGING ADAPTOR AT THE MAINS WHEN CHARGING IS COMPLETE.

# 3 YEAR REPLACEMENT WARRANTY

# OPERATION

## 2. STARTING AND STOPPING

### Before Starting the Pruner

- Remove the blade cover.
- Wear protective gloves and eye protection while working with the pruner.

**WARNING!** NEVER TOUCH THE BLADE WHILE THE TOOL IS IN OPERATION AND BE AWARE OF THE SHARP EDGES EVEN WHEN THE PRUNER IS NOT IN USE.

1. Press and hold the safety switch.

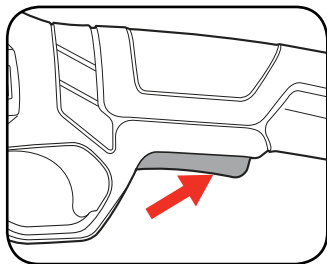

**Note:** While depressed the LED work light will illuminate.

2. Depress the on/off trigger, the cutting blade will move down and the two blades will close to cut.

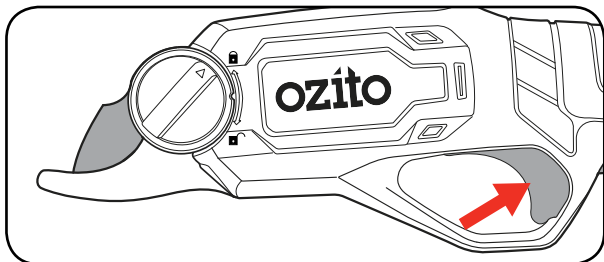

3. Release the on/off trigger, the two blades will open.

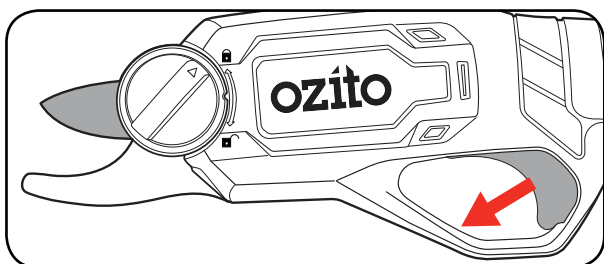

## 3. PRUNING TIPS

Pruning can be done all year round. It is advisable to prune lightly when the shrub/plant is in full bloom or in its peak. Prune more heavily when the plant is less active and dormant.

- Regular tip pruning of new growth should be carried out when plants or shrubs are at a young age ideally seedlings or rooted cutting stage.
- For higher results tip pruning is best after flowering and during the season. If you prune too late in the season this affects and reduces your bloom.
- Tip pruning increases your flowers and creates bushier plants.

### General Pruning

- For best results always make the cut above 8mm from the bud. This allows the wound to heal properly.

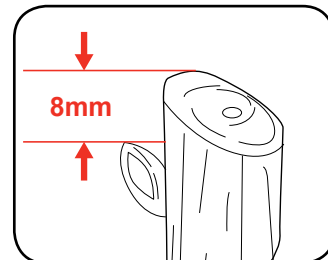

- When removing unwanted growth ensure you make clean cuts that are angled away from the buds.

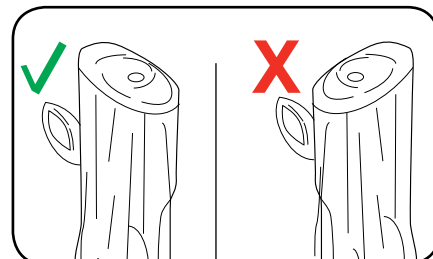

- Prune parallel to existing branches and leaf nodes to encourage new growth.

- When removing the entire stem, cut back to the point where it branched.

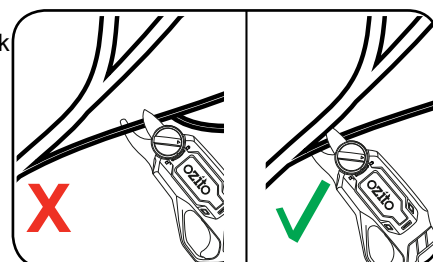

- Each plant is different, slow growing plants will require only light pruning, fast growing plants will require more frequent pruning to keep them healthy.

- Ensure you prune all parts of the plant at the same time as this ensures that there is an even and consistent growth.

## Screens & Hedges

- Light pruning is recommended for all screens and hedge plants. Pruning on a regular basis promotes and maintains dense growth.

## Pruning to Encourage Flowering

- After flowers have had their full bloom it is then recommended to prune to promote more flowers next season. All dead flowers should be removed as they drain the plant. This then prevents the plant possibly going to seed.

## Pruning to Decrease Rapid Growth

- To minimise new growth on shrubs and plants cut flush with the stem of the shrub/tree. This also assists if you want to create a topiary look and train your plant or shrub.

## Pruning to Repair Damage

- If severe weather conditions have damaged your plants or shrub, it is in the plants best interests to be pruned to help reinstate its condition.
- If any insects have infected your plants/shrubs, prune back the affected areas to assist with new growth.

## 4. BLADE MAINTENANCE



**WARNING!** ENSURE THAT THE SAFETY SWITCH AND ON/OFF TRIGGER ARE NOT ACCIDENTALLY DEPRESSED DURING CLEANING/MAINTENANCE.



**CAUTION!** DO NOT HANDLE BLADES WITHOUT GLOVES AS THEY ARE SHARP AND CAN BECOME HOT AFTER USE, POTENTIALLY CAUSING PERSONAL INJURY.

- After each use it is recommended you disinfect the blades by using methylated spirits. This helps prevent the spread of disease to other plants and shrubs the next time you are pruning.

## Blade Sharpening

Bypass pruners will generally only have one blade, the lower part being the counter blade which should never require sharpening.

The cut of a bypass tool is achieved by the blade precisely passing by the counter blade. It therefore follows that you should never sharpen the flat side of the blade. If steel is removed from here, the two parts will no longer meet precisely and the tool will fail to cut. You must only sharpen on the outside or bevelled side of the blade.

1. To sharpen the pruner blade, hold the open pruner flat in one hand and with the other hand place the diamond file at a 15 degree angle along the bevelled side of the blade.

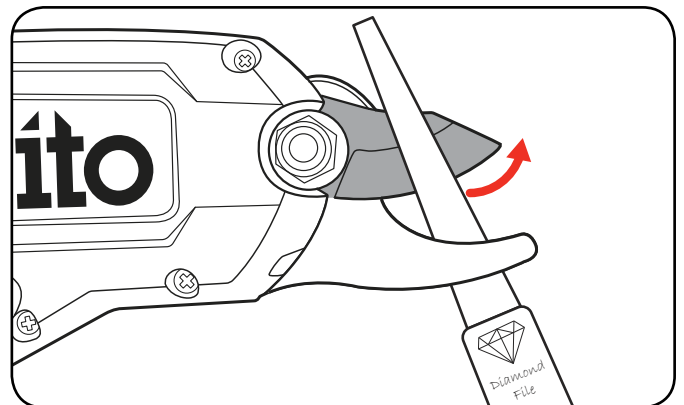

**Note:** Be careful to not sharpen at too steep an angle as this could damage the edge of the blade.

2. Move the diamond file in one direction only, with smooth strokes from base to end 4 to 5 times.



**CAUTION!** DO NOT OVER-SHARPEN. TEST THE BLADE REPEATEDLY THROUGHOUT THE SHARPENING PROCESS TO PREVENT OVER-SHARPENING.

3. Turn the pruner over so the flat side of the blade is facing up and slide the sharpener flush along the unbeveled edge to remove burrs created by sharpening the cutting blade.

# MAINTENANCE cont.

- If the housing of the pruner requires cleaning, do not use solvents. Use of a cloth only is recommended.

## Changing the Blade

**CAUTION!** DO NOT HANDLE BLADES WITHOUT GLOVES AS THEY ARE SHARP AND CAN BECOME HOT AFTER USE, POTENTIALLY CAUSING PERSONAL INJURY.

1. To unlock and remove the cutting blade, rotate the blade lock clockwise.

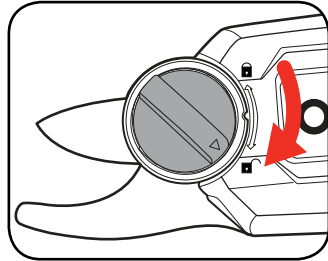

2. Carefully pull the cutting blade away from the pruner.

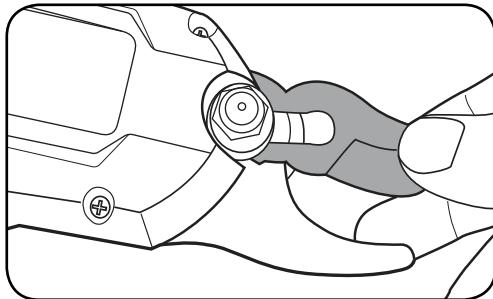

3. Insert the new cutting blade into position.

4. Lock the new cutting blade into position by rotating the blade lock anti-clockwise, you will hear a "CLICK" that indicates the blade is locked in position.

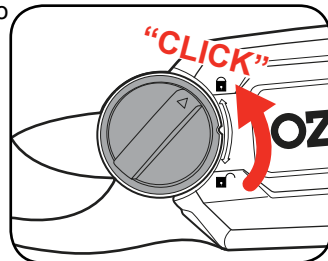

**Note:** Ozito Industries will not be responsible for any damage or injuries caused by repair of the pruner by an unauthorised person or by mishandling.

# STORAGE

- When not in use, the tool should be stored in a dry, frost free location, keep out of children's reach.
- When the tool will not be used for several months fully charge the battery.
- Make sure that the blade lock is in the lock position, then assembly the blade cover over the blades.

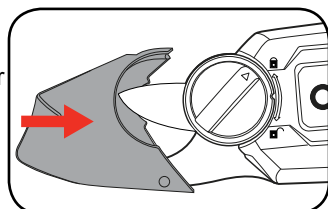

# DESCRIPTION OF SYMBOLS

V	Volts	Hz	Hertz
~	Alternating current	W	Watts
/min	Revolutions or reciprocation per minute	n <sub>0</sub>	No load speed
mm	Millimetres	∅	Diameter
	Double insulated	Ah	Amp hour
	Warning		Regulator compliance mark
mAh	milliamp hour	mA	milliamp
	Indoor use only	dc	Direct current
	Wear eye protection		Read instruction manual
	Transformer Energy Rating (MEPS)		Thermal cut-out protection

# SPARE PARTS

Spare parts can be ordered from the Special Orders Desk at your local Bunnings Warehouse.

For further information, or any parts not listed here, visit [www.ozito.com.au](http://www.ozito.com.au) or contact Ozito Customer Service:

Australia 1800 069 486

New Zealand 0508 069 486

E-mail: [enquiries@ozito.com.au](mailto:enquiries@ozito.com.au)

# BATTERY AND CHARGER SAFETY WARNINGS

THIS MANUAL CONTAINS IMPORTANT SAFETY AND OPERATING INSTRUCTIONS FOR YOUR BATTERY CHARGER.

1. Before using the charger read all instructions and cautionary markings on the charger, battery pack and the product using the battery pack.
2. This charger is not intended for any uses other than charging rechargeable batteries. Any other use may result in risk of fire, electric shock or electrocution.
3. Do not place any object on top of the charger or place the charger on a soft surface that may result in excessive internal heat. Place the charger in a position away from any heat source.
4. To reduce risk of damage to the electric plug and cord, pull by the plug rather than the cord when disconnecting the charger.
5. Make sure the cord is located so that it will not be stepped on, tripped over, or otherwise subjected to damage or stress.
6. An extension cord should not be used unless absolutely necessary. Use of an improper extension cord could result in the risk of fire, electric shock or electrocution.
7. Do not operate the charger if it has received a sharp blow, been dropped or otherwise damaged in any way. Have it checked by an electrician or power tool repairer.
8. Do not disassemble charger. Take it to an electrician or power tool repairer when service or repair is required. Incorrect reassembly may result in a risk of electric shock, electrocution or fire.
9. To reduce risk of electric shock, unplug the charger from the outlet before attempting any cleaning. Removing the battery pack will not reduce this risk.
10. Never attempt to connect 2 chargers together.
11. DO NOT store or use the tool and battery pack in locations where the temperature may reach or exceed 40°C (such as inside sheds or metal buildings in summer).
12. The charger is designed to operate on standard household electrical power (240 volts). Do not attempt to use it on any other voltage!
13. The battery pack is not fully charged out of the carton. First read the safety instructions and then follow the charging notes and procedures.
14. The longest life and best performance can be obtained if the battery pack is charged when the air temperature is between 18 - 24°C. Do not charge the battery pack in an air temperature below 10°C or above 40°C. This is important and will prevent damage to the battery pack.
15. Do not incinerate the battery pack even if it is seriously damaged or is completely worn out. The battery can explode in a fire.
16. Never attempt to open the battery pack for any reason. If the plastic housing of the battery pack breaks or cracks, immediately discontinue use and do not recharge.
17. During charging, the battery must be placed in a well ventilated area.

# ELECTRICAL SAFETY

 **WARNING!** When using mains-powered tools, basic safety precautions, including the following, should always be followed to reduce risk of fire, electric shock, personal injury and material damage.

Read the whole manual carefully and make sure you know how to switch the tool off in an emergency, before operating the tool.

Save these instructions and other documents supplied with this tool for future reference.

The manufacturer cannot accept any liability for damage or accidents which arise due to a failure to follow these instructions and the safety information.

This charger has been designed for 230V and 240V only. Always check that the power supply corresponds to the voltage on the rating plate.

Note: The supply of 230V and 240V is interchangeable for Australia and New Zealand.



This tool's charger is double insulated; therefore no earth wire is required.

The power supply for this product's charger should be protected by a residual current device (rated at 30mA or less). A residual current device reduces the risk of electric shock.

**Note:** Double insulation does not take the place of normal safety precautions when operating this tool. The insulation system is for added protection against injury resulting from a possible electrical insulation failure within the tool.

## Using an Extension Lead

Always use an approved extension lead suitable for the power input of this tool. Before use, inspect the extension lead for signs of damage, wear and ageing. Replace the extension lead if damaged or defective.

When using an extension lead on a reel, always unwind the lead completely. Use of an extension lead not suitable for the power input of the tool or which is damaged or defective may result in a risk of fire and electric shock.

# GENERAL POWER TOOL SAFETY WARNINGS

 **WARNING!** Read all safety warnings and all instructions. Failure to follow the warnings and instructions may result in electric shock, fire and/or serious injury.

Save all warnings and instructions for future reference. The term "power tool" in the warnings refers to your mains-operated (corded) power tool or battery-operated (cordless) power tool.

## 1. Work area safety

- Keep work area clean and well lit. Cluttered or dark areas invite accidents.
- Do not operate power tools in explosive atmospheres, such as in the presence of flammable liquids, gases or dust. Power tools create sparks which may ignite the dust or fumes.
- Keep children and bystanders away while operating a power tool. Distractions can cause you to lose control.

## 2. Electrical safety

- Power tool plugs must match the outlet. Never modify the plug in any way. Do not use any adapter plugs with earthed (grounded) power tools. Unmodified plugs and matching outlets will reduce risk of electric shock.
- Avoid body contact with earthed or grounded surfaces, such as pipes, radiators, ranges and refrigerators. There is an increased risk of electric shock if your body is earthed or grounded.
- Do not expose power tools to rain or wet conditions. Water entering a power tool will increase the risk of electric shock.
- Do not abuse the cord. Never use the cord for carrying, pulling or unplugging the power tool. Keep cord away from heat, oil, sharp edges or moving parts. Damaged or entangled cords increase the risk of electric shock.
- When operating a power tool outdoors, use an extension cord suitable for outdoor use. Use of a cord suitable for outdoor use reduces the risk of electric shock.
- If operating a power tool in a damp location is unavoidable, use a residual current device (RCD) protected supply. Use of an RCD reduces the risk of electric shock.

## 3. Personal safety

- Stay alert, watch what you are doing and use common sense when operating a power tool. Do not use a power tool while you are tired or under the influence of drugs, alcohol or medication. A moment of inattention while operating power tools may result in serious personal injury.
- Use personal protective equipment. Always wear eye protection. Protective equipment such as dust mask, non-skid safety shoes, hard hat, or hearing protection used for appropriate conditions will reduce personal injuries.
- Prevent unintentional starting. Ensure the switch is in the off-position before connecting to power source and/or battery pack, picking up or carrying the tool. Carrying power tools with your finger on the switch or energising power tools that have the switch on invites accidents.
- Remove any adjusting key or wrench before turning the power tool on. A wrench or a key left attached to a rotating part of the power tool may result in personal injury.
- Do not overreach. Keep proper footing and balance at all times. This enables better control of the power tool in unexpected situations.

- Dress properly. Do not wear loose clothing or jewellery. Keep your hair, clothing and gloves away from moving parts. Loose clothes, jewellery or long hair can be caught in moving parts.
- If devices are provided for the connection of dust extraction and collection facilities, ensure these are connected and properly used. Use of dust collection can reduce dust-related hazards.

## 4. Power tool use and care

- Do not force the power tool. Use the correct power tool for your application. The correct power tool will do the job better and safer at the rate for which it was designed.
- Do not use the power tool if the switch does not turn it on and off. Any power tool that cannot be controlled with the switch is dangerous and must be repaired.
- Disconnect the plug from the power source and/or the battery pack from the power tool before making any adjustments, changing accessories, or storing power tools. Such preventive safety measures reduce the risk of starting the power tool accidentally.
- Store idle power tools out of the reach of children and do not allow persons unfamiliar with the power tool or these instructions to operate the power tool. Power tools are dangerous in the hands of untrained users.
- Maintain power tools. Check for misalignment or binding of moving parts, breakage of parts and any other condition that may affect the power tool's operation. If damaged, have the power tool repaired before use. Many accidents are caused by poorly maintained power tools.
- Keep cutting tools sharp and clean. Properly maintained cutting tools with sharp cutting edges are less likely to bind and are easier to control.
- Use the power tool, accessories and tool bits etc. in accordance with these instructions, taking into account the working conditions and the work to be performed. Use of the power tool for operations different from those intended could result in a hazardous situation.

## 5. Battery tool use and care

- Recharge only with the charger specified by the manufacturer. A charger that is suitable for one type of battery pack may create a risk of fire when used with another battery pack.
  - Use power tools only with specifically designated battery packs. Use of any other battery packs may create a risk of injury and fire.
  - When battery pack is not in use, keep it away from other metal objects, like paper clips, coins, keys, nails, screws or other small metal objects, that can make a connection from one terminal to another. Shorting the battery terminals together may cause burns or a fire.
  - Under abusive conditions, liquid may be ejected from the battery; avoid contact. If contact accidentally occurs, flush with water. If liquid contacts eyes, additionally seek medical help. Liquid ejected from the battery may cause irritation or burns.
- ## 6. Service
- Have your power tool serviced by a qualified repair person using only identical replacement parts. This will ensure that the safety of the power tool is maintained.
  - If the supply cord is damaged, it must be replaced by the manufacturer, its service agent or similarly qualified persons in order to avoid a hazard.

# PRUNER SAFETY WARNINGS

Keep all parts of the body away from the cutter blade. Do not remove cut material or hold material to be cut when blades are moving. Make sure the switch is off when clearing jammed material. A moment of inattention while operating the pruner may result in serious personal injury.

• Carry the pruner by the handle with the cutter blade stopped. When transporting or storing the pruner always fit the blade cover. Proper handling of the pruner will reduce possible personal injury from the cutter blades.

• Hold the power tool by insulated gripping surfaces only, because the cutter blade may contact hidden wiring. Cutter blades contacting a "live" wire may make exposed metal parts of the power tool "live" and could give the operator an electric shock.

• Perform visual inspection on the plant being pruned. To ensure no wire fences or foreign objects that the pruner may contact during operation.

• Never allow children or people unfamiliar with these instructions to use the pruner.

• Avoid using the pruner, while people, especially children or pets, are nearby.

• Use the pruner only in daylight or good artificial light.

• Never operate the pruner with damaged blades in place.

• Switch on the pruner only when the hands and feet are away from the cutting blades.

• Use only the manufacturer's recommended replacement parts and accessories.

• Inspect and maintain the pruner regularly. Have the pruner repaired only by an authorized repairer.

• When not in use, store the pruner out of the reach of children.

• Face the cutting blades away from yourself, other people and animals while the power is connected to the pruner (especially during operation).

• Keep ventilation openings clear of debris. Keep handles dry, clean and free of oil and grease.

 **WARNING!** When servicing, use only identical replacement parts. Use of any other parts may create a hazard or cause product damage. To ensure safety and reliability, all repairs should be performed by a qualified service technician.

 **WARNING!** This appliance is not intended for use by young or infirm persons unless supervised by a responsible person to ensure that they can use the appliance safely. Young children should be supervised to ensure that they do not play with the appliance.

# CARING FOR THE ENVIRONMENT



Power tools that are no longer usable should not be disposed of with household waste but in an environmentally friendly way. Please recycle where facilities exist. Check with your local council authority for recycling advice.



Recycling packaging reduces the need for landfill and raw materials. Reuse of recycled material decreases pollution in the environment. Please recycle packaging where facilities exist. Check with your local council authority for recycling advice.