

# LUGNA

FORM & FUNCTION

## ASSEMBLY INSTRUCTIONS

### Shoe Tower

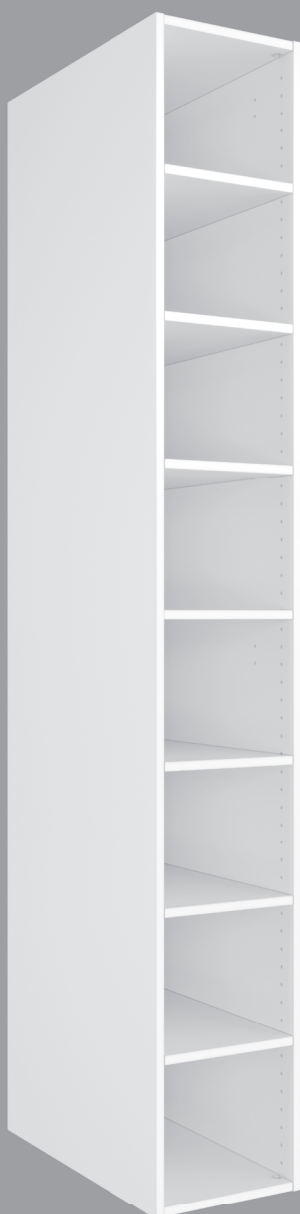

*LUGNA understands the importance of timeless style and practical durability for a home's form and function. Our European-inspired collection is simple and easy to use, with five modern colours that complement any style and space. LUGNA's modular system allows for endless configurations and additions, with various-sized cabinets, drawers, shelving, and hinged doors that can be combined to create a bespoke look on any budget. Whether you're looking for something modern and sleek or classic and elegant, LUGNA has something for everyone.*



**SCAN** for  
more info



## ⚠ WARNING

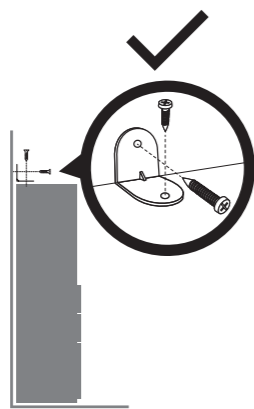

### Children have died from furniture tipover.

- ALWAYS secure this furniture with an anchor device.
- NEVER allow children to stand, climb or hang on drawers, doors or shelves.
- Never open more than one drawer at a time.
- Place heavy items down low.

NEVER put a TV on this furniture.



**Serious injury or death can be caused by toppling furniture. Attach this unit to the wall using the safety bracket anchor device provided. Fix bracket to the middle of the unit with 16mm screw (provided) and use a suitable wall fixing (not supplied) to fix L-bracket to wall.**

## What you will need

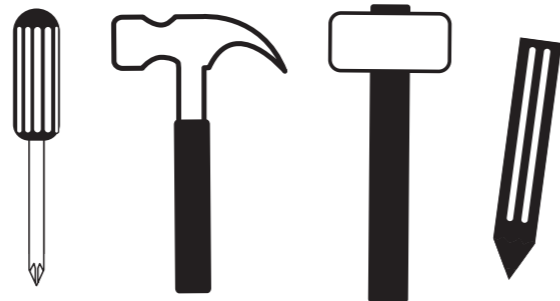

## Includes



**20x**

Cam  
Lock  
Screws



**20x**

Cam  
Lock  
Nuts



**75x**

Nails



**24x**

Shelf  
Support  
Pins

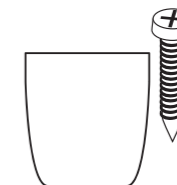

**4x**

Foot  
Mounts



**1x**

Safety Bracket

**1x** Fixed Shelf

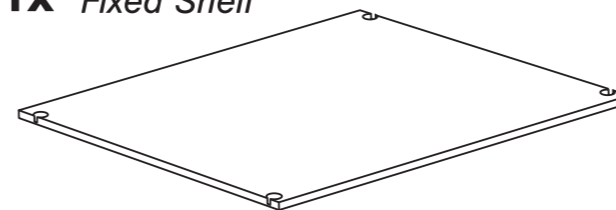

**6x** Adjustable Shelves

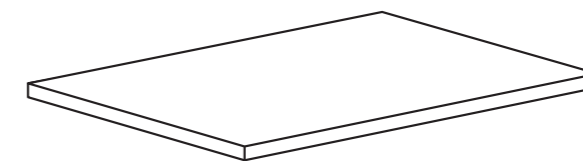

**2x** Top and Base

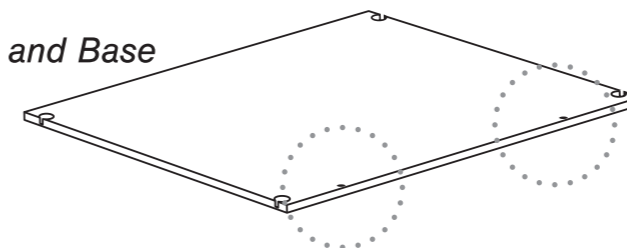

**2x** Cleats



**1x** Right Side Panel

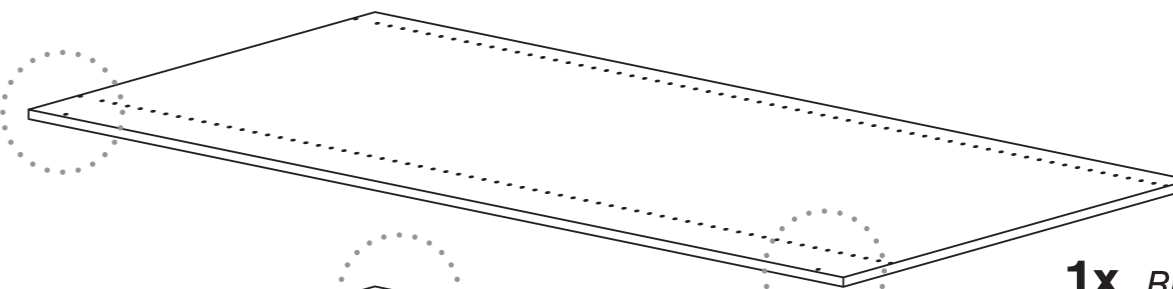

**1x** Left Side Panel

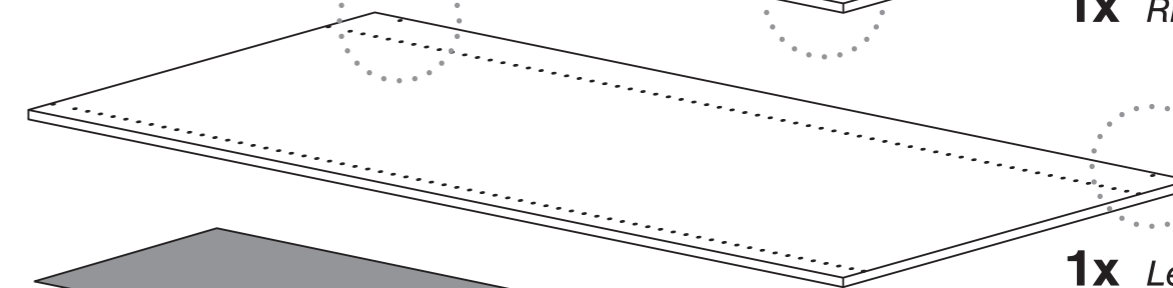

**1x** Back Panel

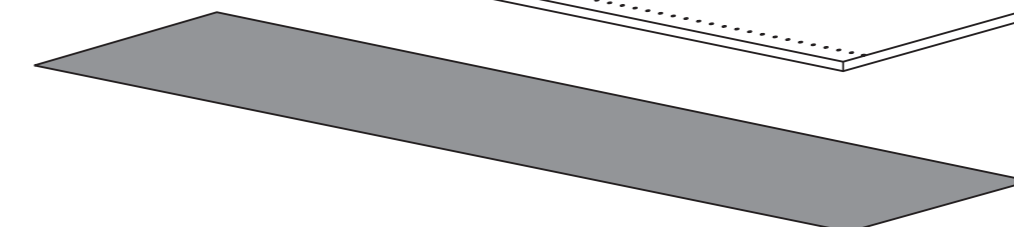

## Carpet Floors

When placing the cabinet on carpet, the carpet can prevent the bottom drawers or doors from opening. To fix this, install the optional foot mounts.



**4x**

Foot Mounts

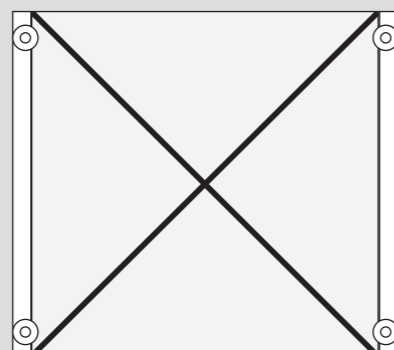

**WARNING!**  
Do not screw foot mounts to the base. Fix to cabinet sides as shown.

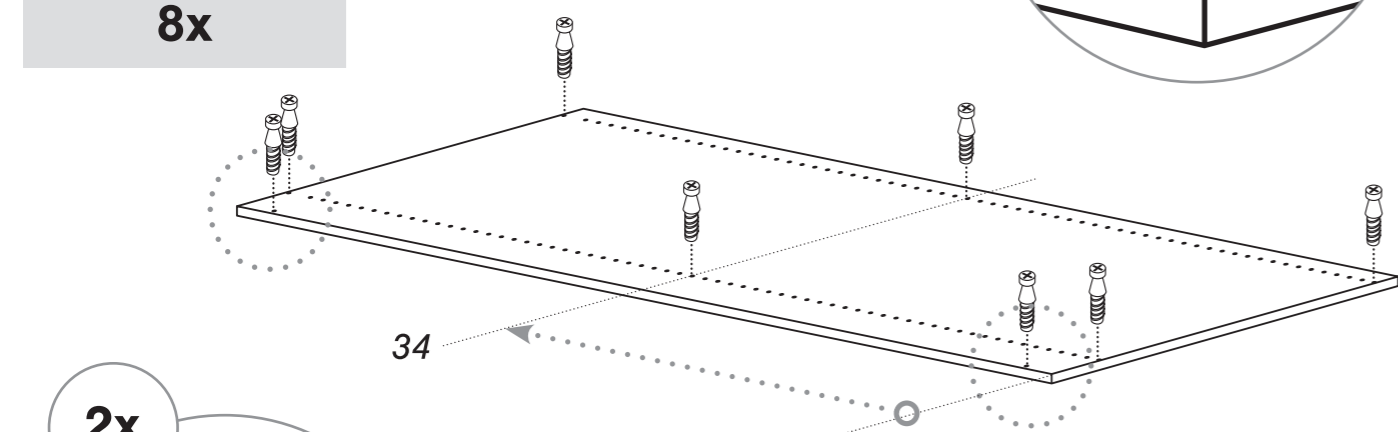
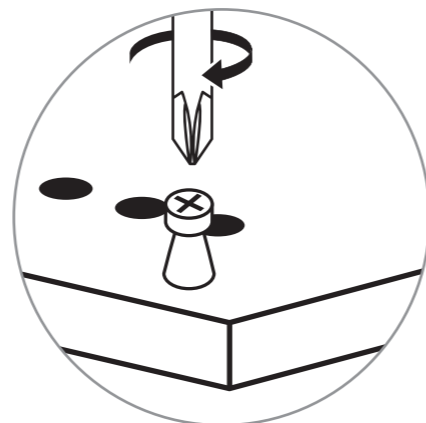
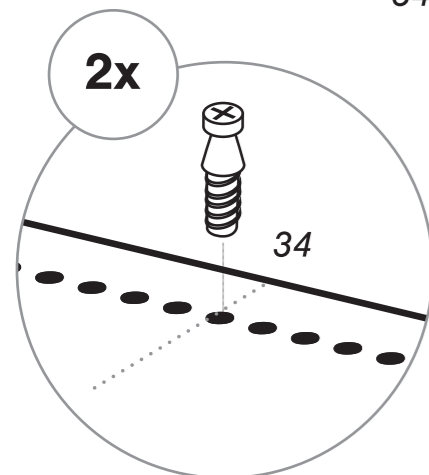
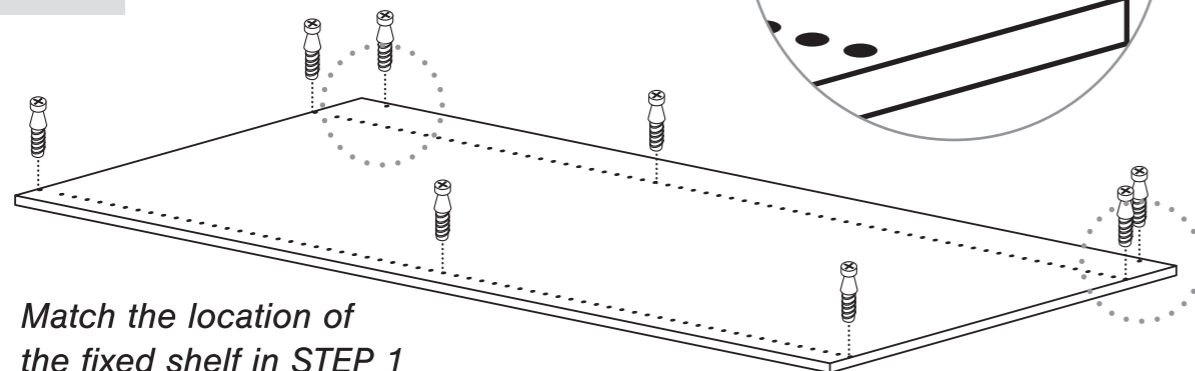
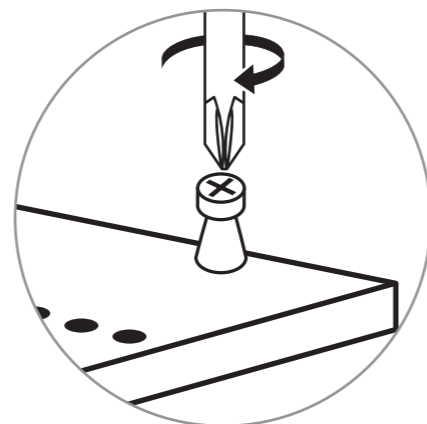
**STEP 1****1x** Right Side Panel**8x****2x****STEP 2****1x** Left Side Panel**8x**

Match the location of  
the fixed shelf in STEP 1

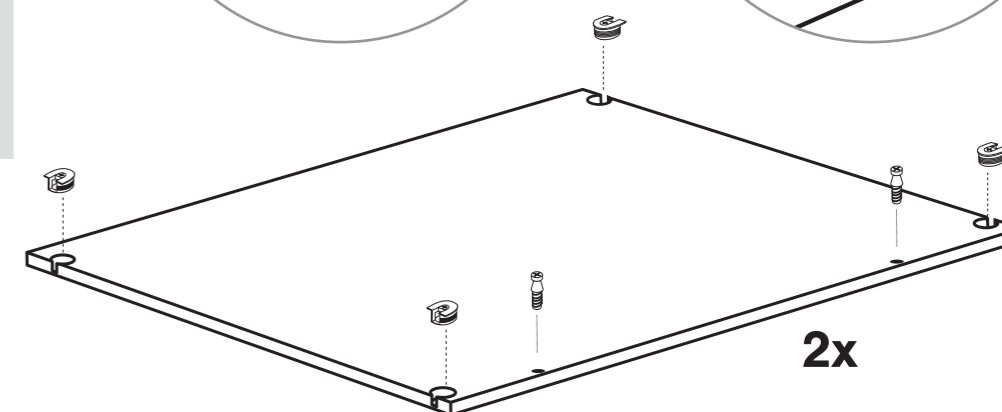
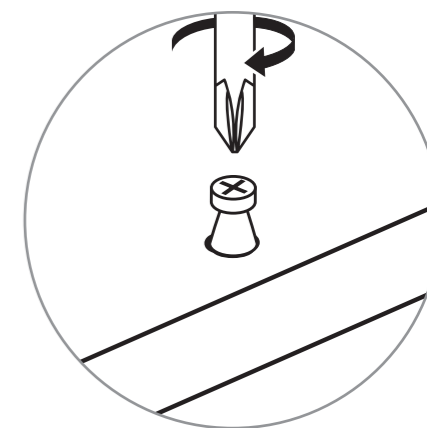
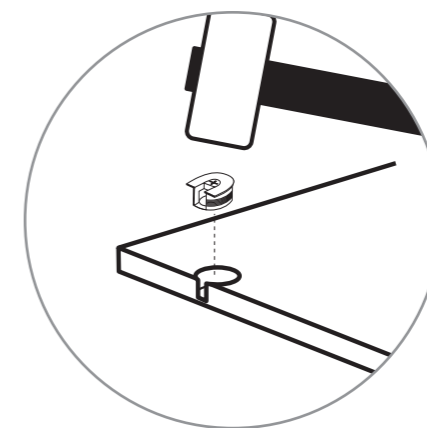
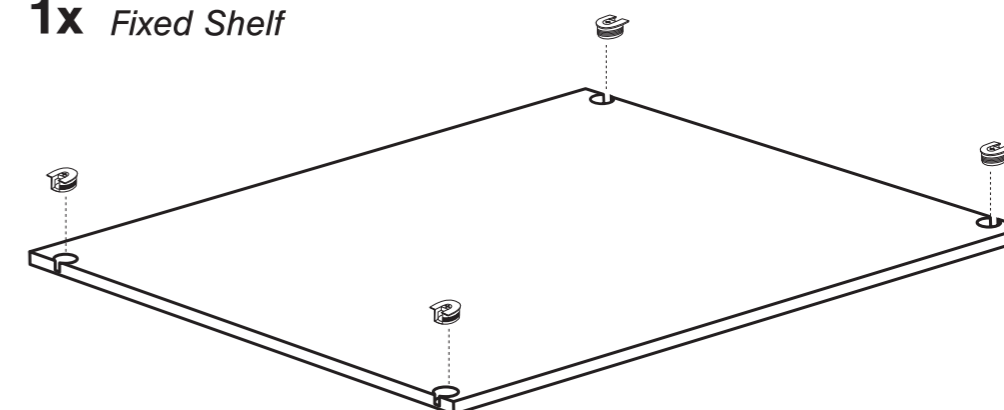
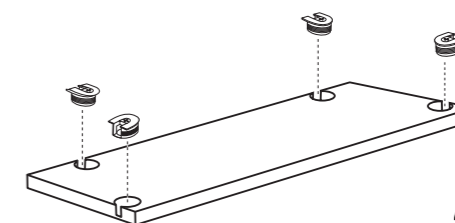
**STEP 3****2x** Top and Base**4x****8x****STEP 4****1x** Fixed Shelf**4x****STEP 5****2x** Cleats**8x****2x**

## STEP 6

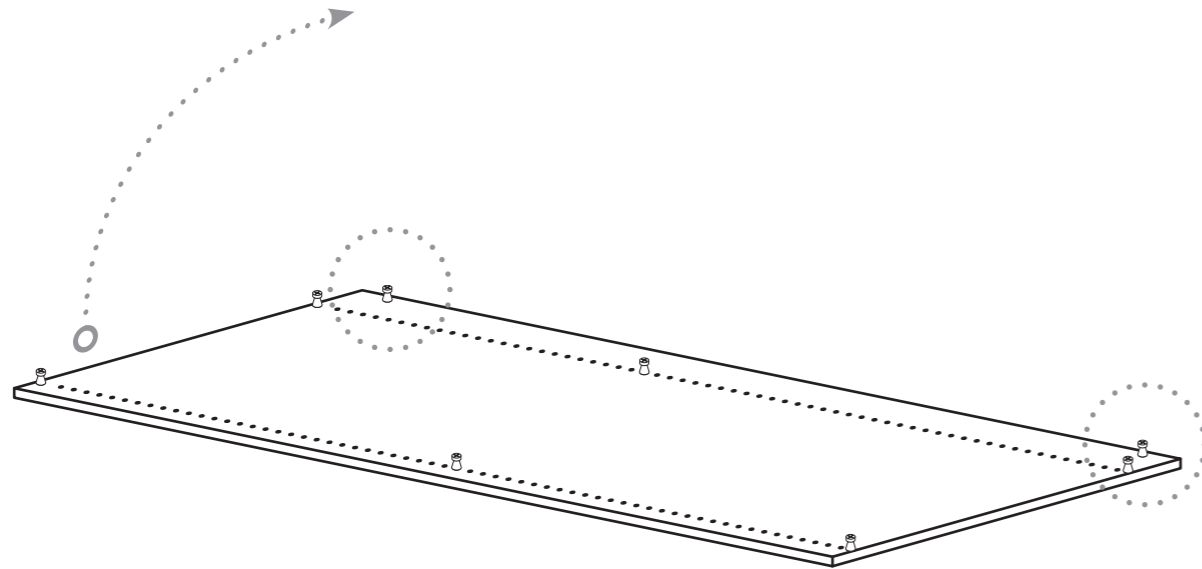

## STEP 7

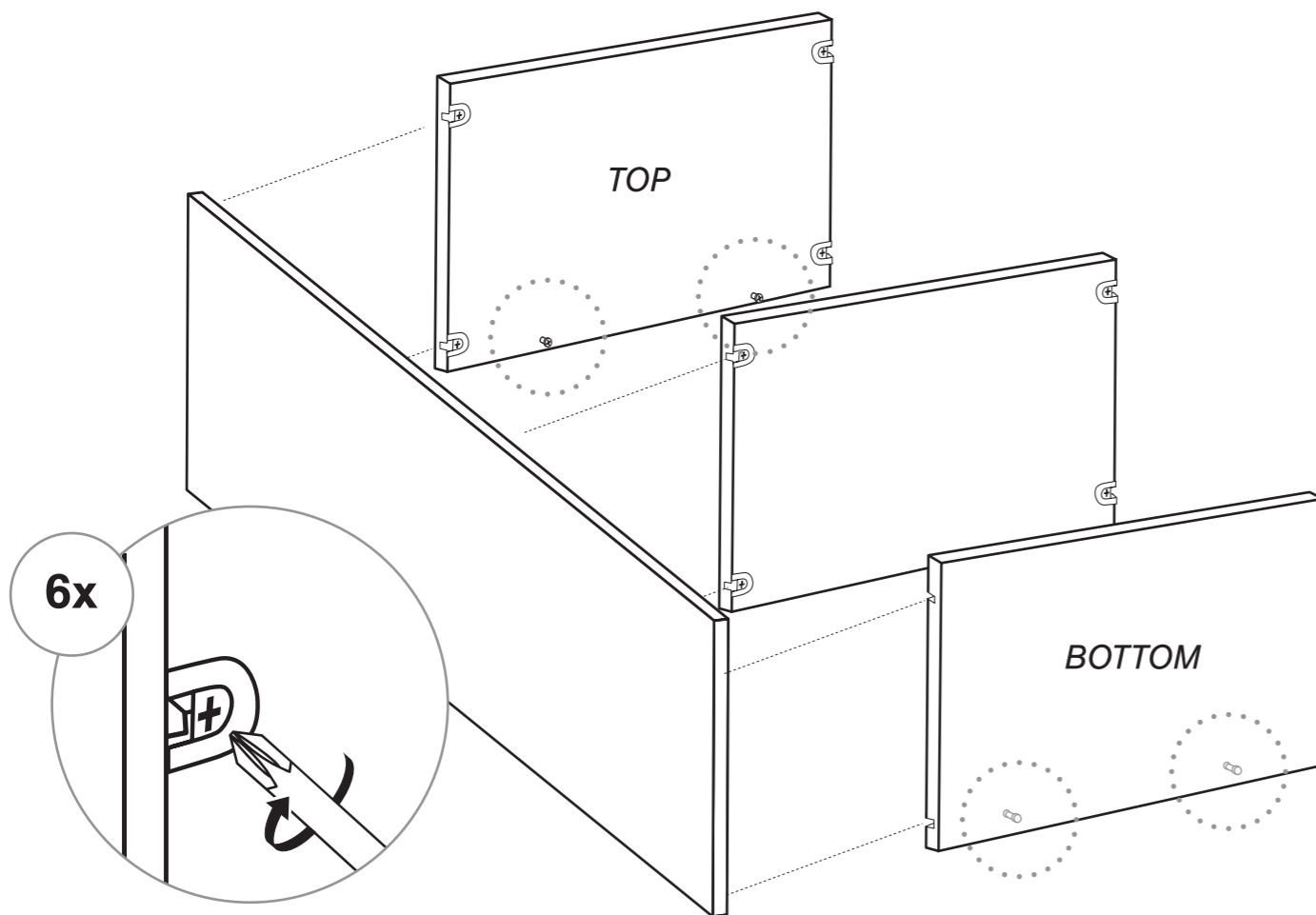

*Note – the cam lock screws on the top and bottom panels should point to the inside of the cabinet.*

## STEP 8

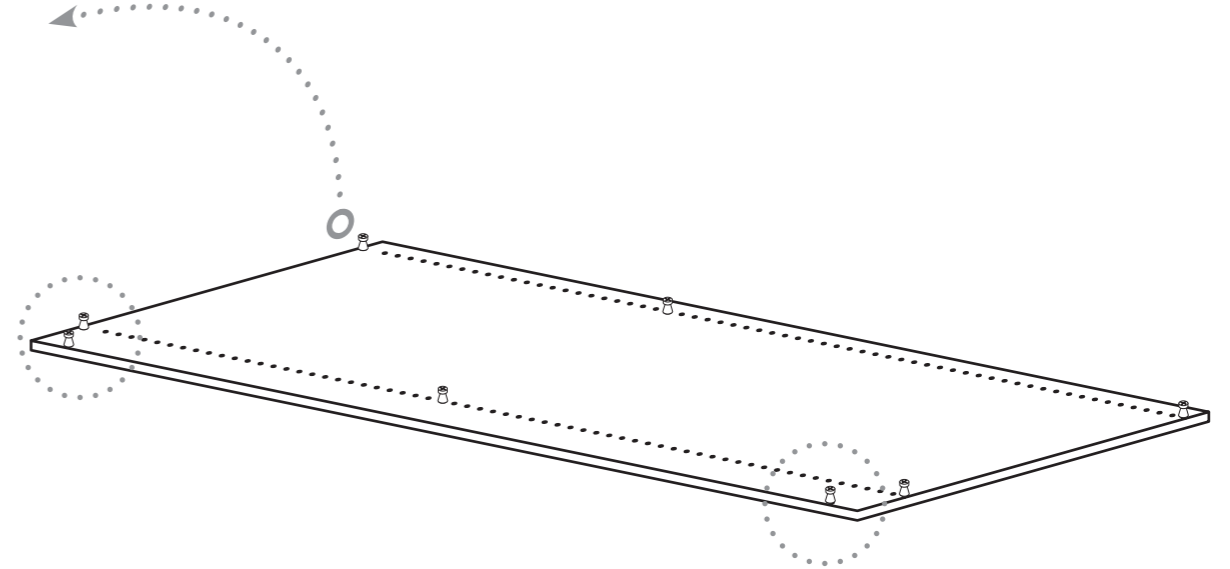

## STEP 9

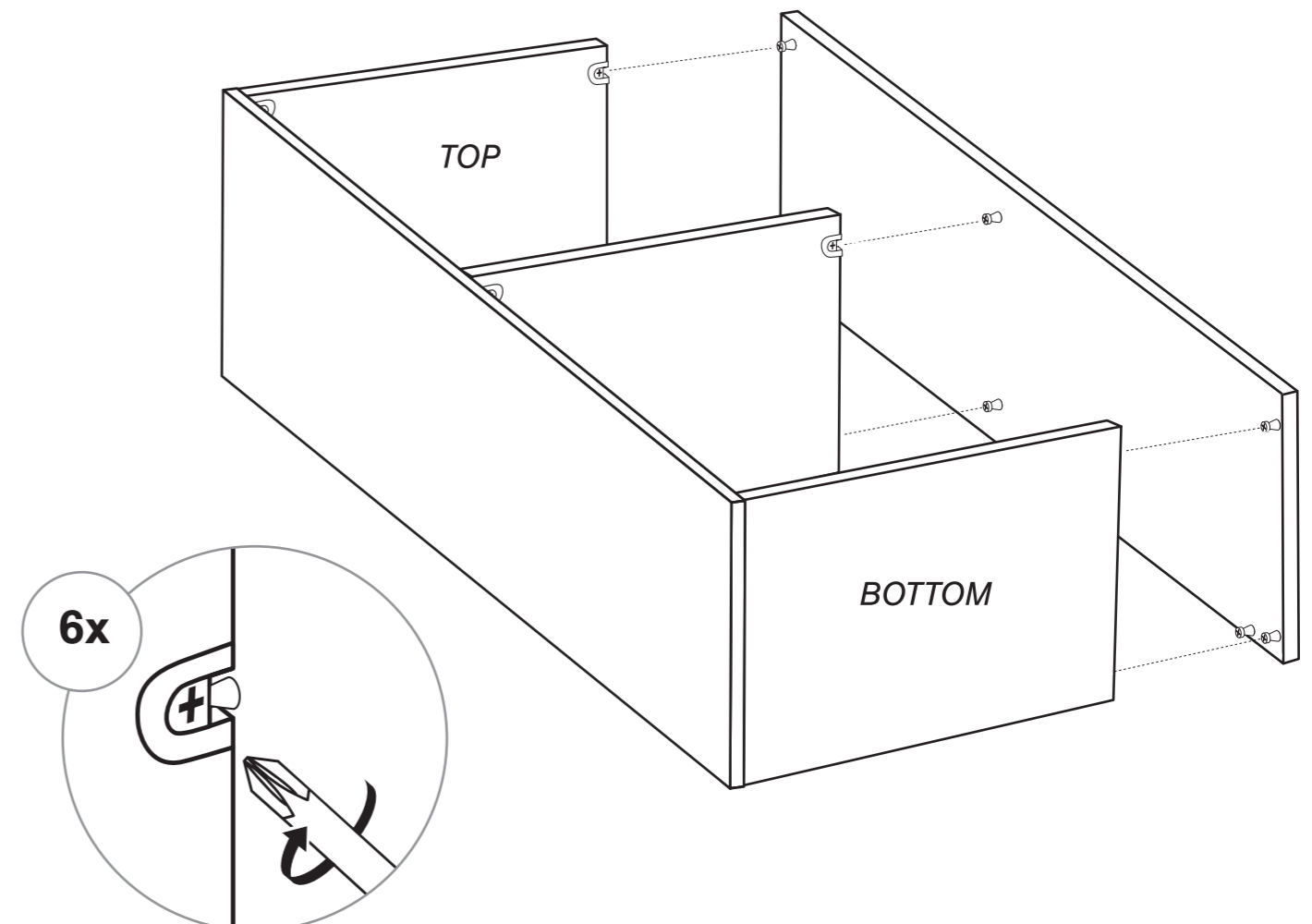

## STEP 10

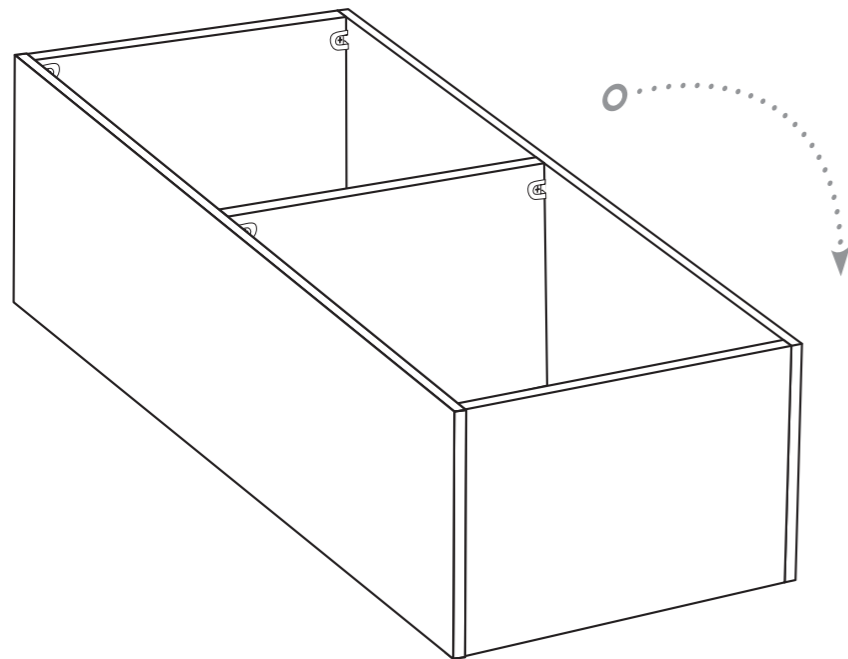

## STEP 12

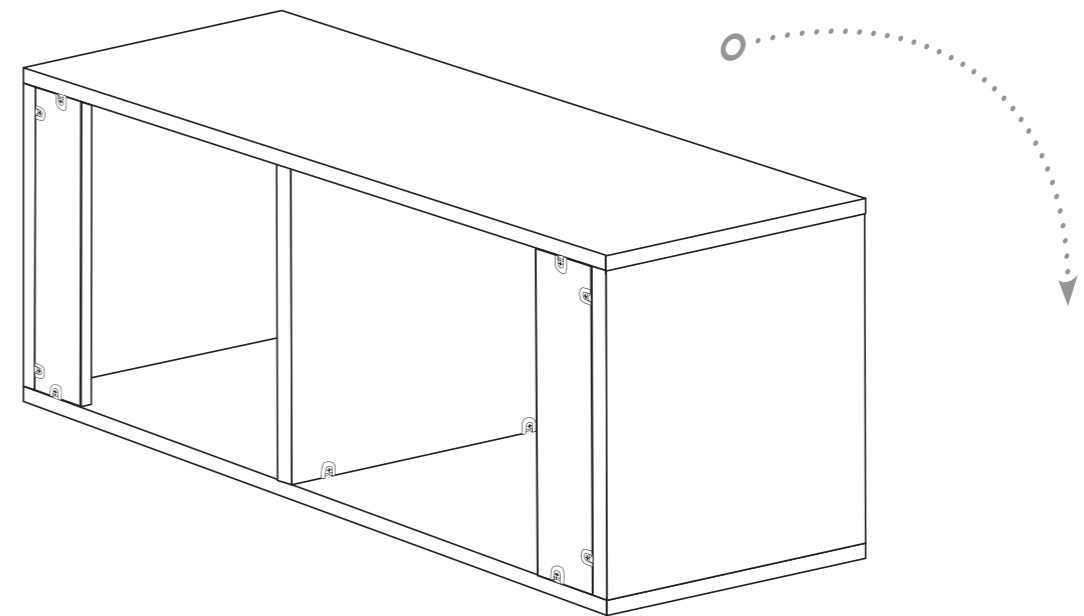

## STEP 11

**2x** Cleats

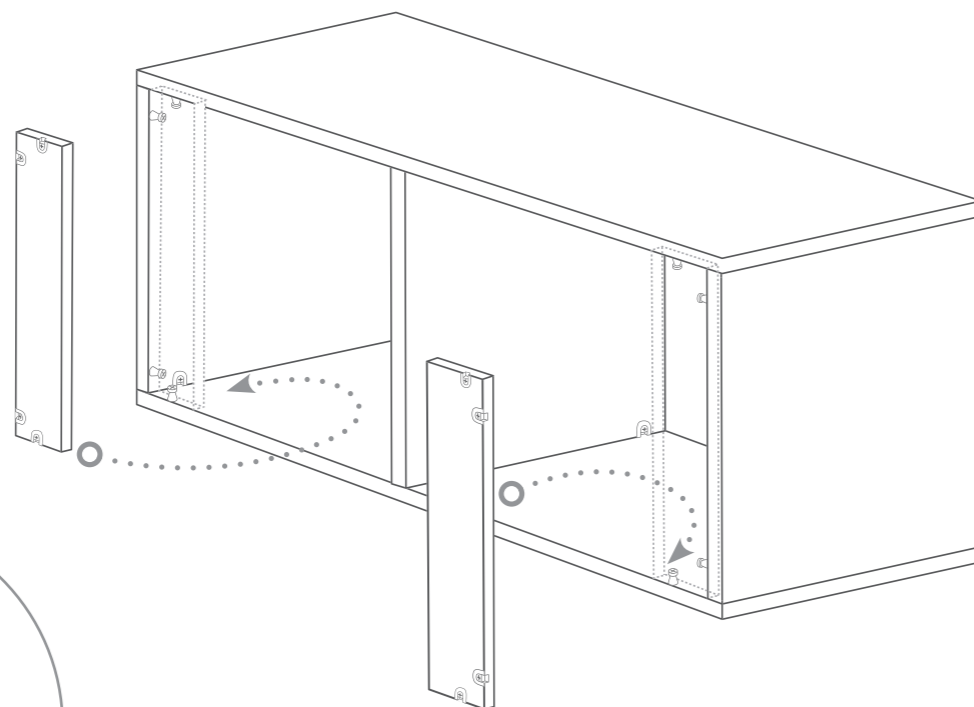

**8x**

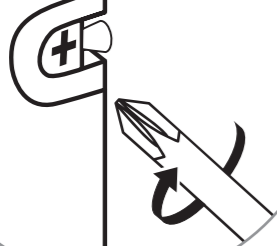

## STEP 13

*Place backing panel on to the back of the cabinet.*

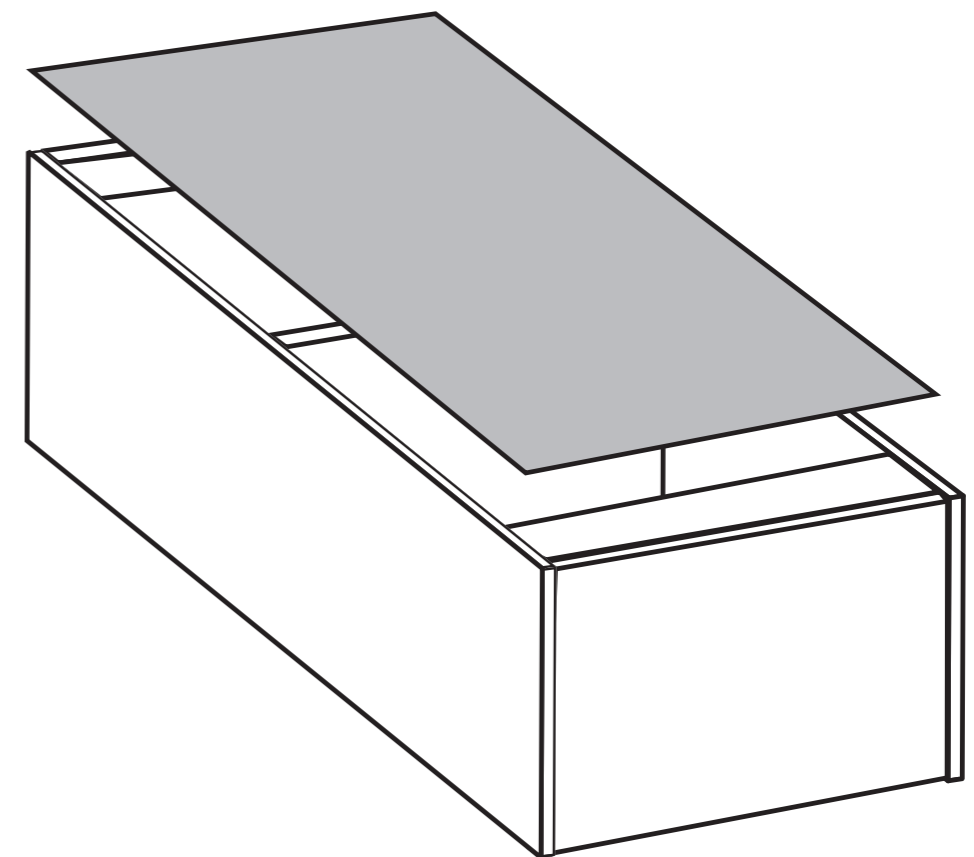

## STEP 14

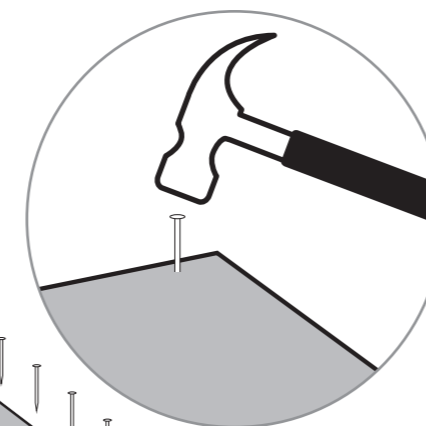
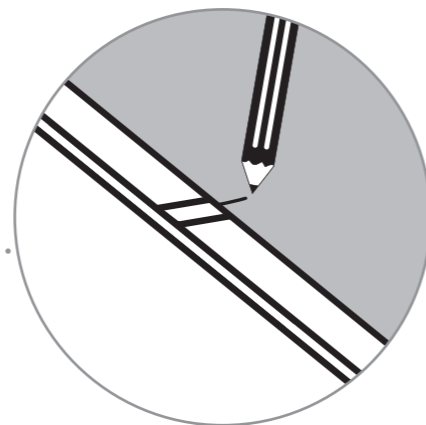
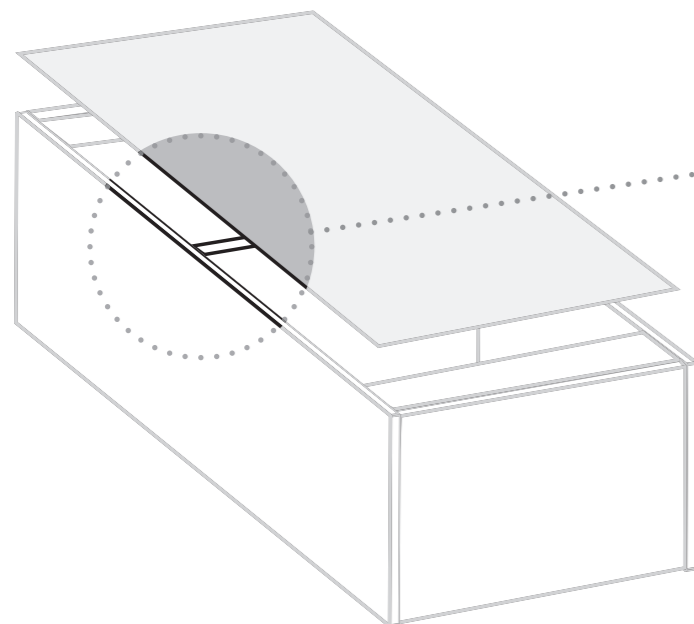

## STEP 15



75x

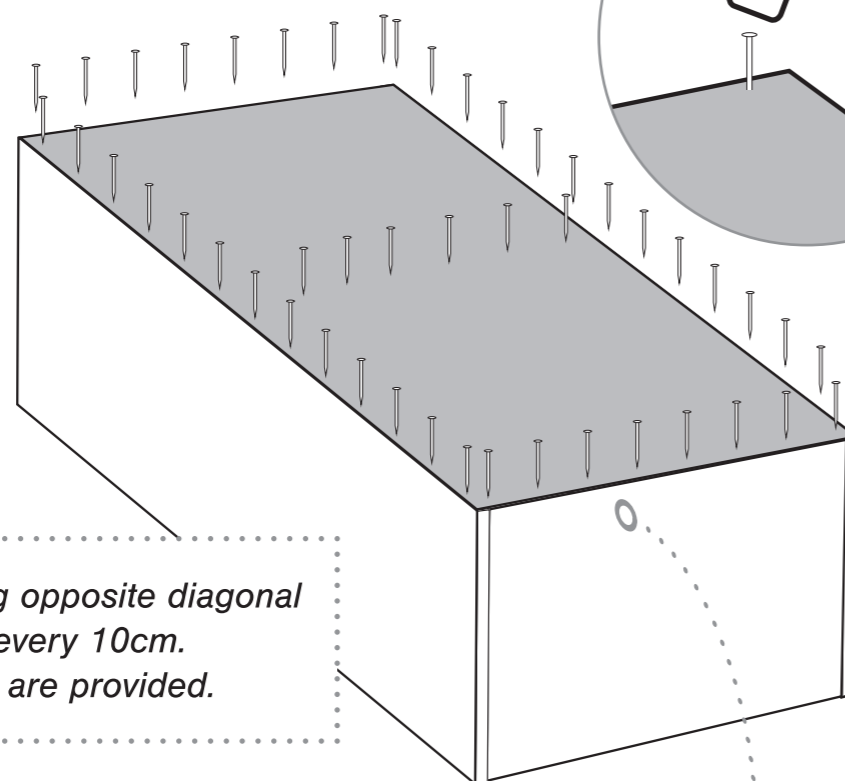

*Note – Start by nailing opposite diagonal corners. Space nails every 10cm. Additional spare nails are provided.*

## STEP 16

*Stand the cabinet upright.*



**WARNING**

**The assembled cabinet will be heavy.**  
For your safety, a minimum of two people is recommended to lift the cabinet upright. Bend your knees and lift with your legs - not your back!

## STEP 17



24x

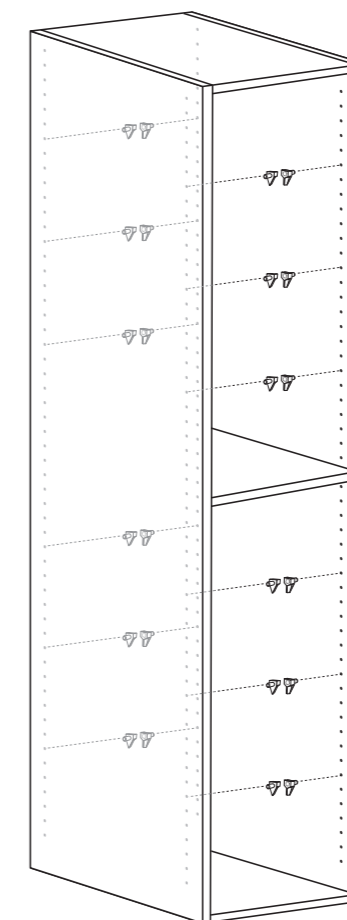

24x

*TIP! – You can use a spirit level to quickly find the corresponding holes at the same height.*

## STEP 18

**6x Adjustable Shelves**

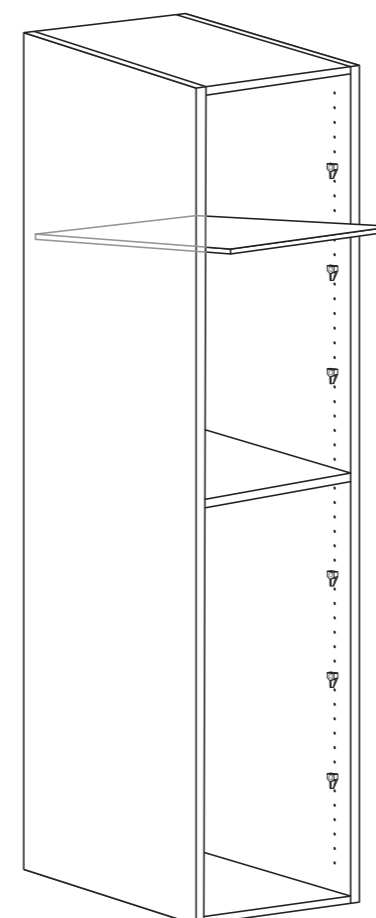

6x

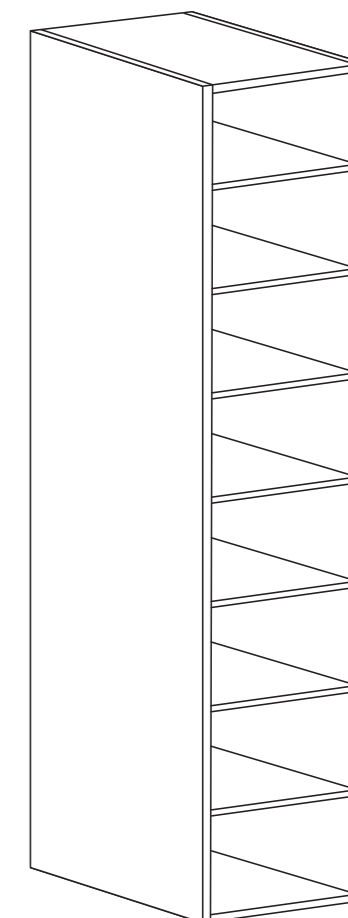

# LUGNA

FORM & FUNCTION

## CABINET CARE INSTRUCTIONS

---

### **Everyday care for your cabinets:**

*Liquid spills should be cleaned up as they occur. Liquids and other damp objects, i.e. towels, will eventually cause permanent damage should they be left unattended.*

*Everyday clean-up of cabinets can be done with a damp cloth and a dry cloth. Ensure you use a clean cloth every time when wiping down your cabinets, as foreign dirt, grease, and oils may inadvertently be transferred to the surface.*

### **Cleaning melamine products:**

*Oils, grease, and other soils that do not respond to water can be removed with a solution of mild soap and water. The surface should be rinsed immediately with a clean, damp cloth and dried thoroughly with a soft cloth to avoid streaking or moisture seeping into the seams around the edges.*

**PLEASE NOTE: Never use abrasive cleaners, ammonia, bleaching agents, scouring pads or powdered cleaners on any type of cabinetry.**

### **Cleaning cabinet hardware:**

*Brass and Silver cleaners are not recommended for cleaning handles. Some of these cleaning solutions contain harsh chemicals that may damage the finish on your handles.*

*Wash your hardware with a solution of warm water and a small amount of mild dish detergent. Dry your hardware and areas around the cleaned area immediately.*

*Hinges can be cleaned with a dry cloth or cotton-tipped swab.*