

### Basin Set



1. Assemble the T-Piece into the basin bodies. Check the hole alignments with the basin/bench top. Un-assemble and cut the T-Piece ends down to correct size if required.
2. Remove the top lock nuts and washers from the basin bodies.
3. Remove the plastic back nut and washer from the basin spout and place them loosely over the T-Piece nipple. (washer on top)
4. Position the Basin Tee assembly into the vanity basin/bench top so the top threads of the basin bodies are accessible through the top. Bottom lock nuts can be lowered to suit.
5. Place the washer and lock nuts on the installed bodies and tighten. Tighten the bottom lock nuts up to bench level.
6. Push the basin spout down with a swiveling motion, locating it into the T-Piece nipple. Once fully down be sure to centre the spout before tightening the plastic back nut.  
Note the copper T-Piece can be bent up or down (within reason) to ensure the nipple is at the correct position inside the spout base.  
**NOTE** - refer to Ceramic Disc Installation guide for alignment tips (separate page).
7. Install the basin flanges by threading them onto the spindle.
8. Install the handles by threading onto the spindle.
9. Using the Allen key provided, tighten the grub screw into the handle aligning it perpendicular to a FLAT SECTION of the spindle, thus securing the handles.
10. Connect the hot and cold water lines to the basin bodies. If using flexible connectors, the bottom nuts and nylon olive fitted to the basin bodies will not be required.
11. Remove the aerator from the basin spout. Turn on the taps to flush out any filings or debris from the pipes. Re-install the aerator. The aerator contains a water reducing flow device.
12. Check for leaks above and below bench level.

### Bath/Shower/Wall Top Assembly



1. Refer to Ceramic Disc Installation guide (separate page).
2. Install the wall flanges by threading them onto the spindle locking nuts. The centre piece of the flange can be reversed to adapt to the correct depth of the spindle body thread. Refer to figure (i).
3. Install the handles by threading them onto the spindle.
4. Using the Allen key provided, tighten the grub screw into the handle aligning it perpendicular to a FLAT SECTION of the spindle, thus securing the handles.
5. Check for leaks.
6. Bath/Shower outlets - place a generous amount of thread tape lightly around the existing 1/2" threaded nipple in the wall prior to installing the outlet.
7. Screw the outlet into position, trying not to over tighten it in order to have the outlet in the desired vertical position.
8. Do not use shower arm or spout as a lever when tightening.

### Washing Machine Set



1. Place a generous amount of thread tape lightly around the existing 1/2" threaded nipple in the wall prior to installing the washing machine cocks.
2. Place the chrome back plate over the nipple then screw the washing machine cocks into position until tight.  
Use a shifter to gently tighten the bodies into the correct vertical position.
3. Install the handles by threading them onto the spindle.
4. Using the Allen key provided, tighten the grub screw into the handle aligning it perpendicular to a FLAT SECTION of the spindle, thus securing the handles.
5. Check for leaks.

Figure (i)

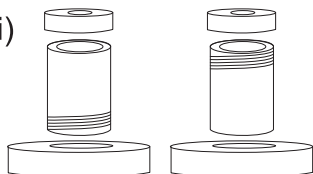

The wall flanges are a three-piece design that can be un-threaded. Reverse the centre piece to change the flange to suit the actual depth of the spindle assembly against the wall if required.

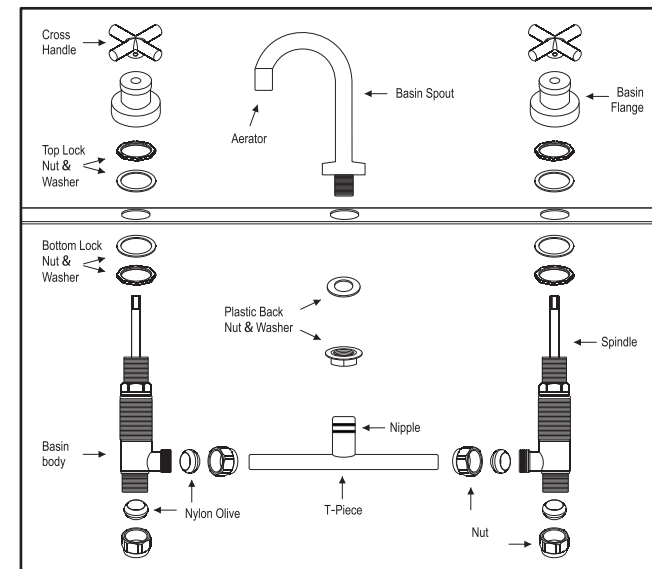

### Working Specifications:

In accordance with Australian standards requirements it is recommended that all tapware be installed by a licensed plumber. Please refer to the warranty card for service agreement.

- \* Hot and cold water inlet pressures should be equal.

Inlet pressure range: 150-1000 kPa

**NOTE** - New Regulation: - 500 kPa maximum operating pressure at any outlet within a building.  
(Ref. AS/NZS 3500.1-2003, Clause 3.3.4)

- \* All pipework must be thoroughly flushed prior to installation, as foreign materials may block the flow regulating device and reduce the flow of water. Aerator insert housing must be retightened to prevent removal by hand.
- \* This tap set has a low flow rate and may not be suitable for connection to some Instantaneous Gas Water Heaters, some Tempering Valves, some Solar Water Heaters & some Thermostatic Mixing Valves. Check with the manufacturers of these products.
- \* Not recommended for gravity feed systems, tank water systems or bore water systems.
- \* Isolating stop taps must be fitted to the hot & cold water supply connections in accordance with local authority installation codes.

### CARING FOR YOUR PRODUCT

- \* Under no circumstances should you install tapware using acetone silicones.
- \* Never use harsh detergents or abrasive cleaners, as these will scratch the surface. Using a soft dry cloth or a soft cloth with warm soapy water is recommended.
- \* Where your tapware remains dry in use, a soft cloth can be used to remove surface dust. Alternatively, a wipe over with warm soapy water is all that is required to maintain the finish in perfect condition for a lifetime of use.
- \* Use of wax based furniture cream should be avoided as these can result in a build up of deposits, which could detract from the appearance.
- \* Do not use undue pressure and wipe in one direction only.