



INSTALLATION HARRIS WOOD WPC WALL PANELS

THINGS YOU WILL NEED



RULER



UTILITY KNIFE / SCISSORS



BUILDERS PENCIL



CLEANING AGENT



CLEANING CLOTH



WARM WATER



FINE SANDPAPER

If installing tiles on painted wall



COUNTERSUNK SCREWS

For installation on timber or plywood

IMPORTANT PRE INSTALL NOTES

- Recommended Surfaces:
 - Ceramic & Glass Tiles
 - Dry concrete floors
 - Laminate/ hybrid& Vinyl
 - Timber floor substrates/plywood (requires additional fixation)
 - Mirrors
 - Painted walls & surfaces (area should be lightly sanded to improve adhesion)
 - Stainless steel
- Surfaces Not recommended for Installs:
 - Uneven brick and stone walls
 - Oil walls (use a degreaser to clean oily walls)
 - Particle board
- Never install Vinyl floor and wall tiles:
 - Over radiant heated floors
 - Over particle board
 - Where moisture is present
 - Outdoors
- This product is suitable for use in residential applications only and should never be installed in a commercial environment
- If installing tiles above a stove top, a minimum 300mm of space must be left between the tiles and the stove top. While the tiles are heat resistant they should never be exposed to open flames

1 SURFACE PREPARATION

To ensure that the tile adhesive sticks to the desired surface use a gentle cleaning agent to remove any dirt, oil and dust. Allow the surface to completely dry before continuing the installation.

Concrete/timber substrates must be free from moisture and all cracks and holes should be filled with a suitable filler.

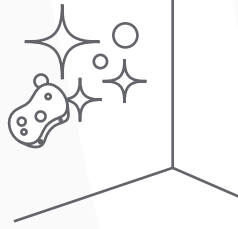

2 PLAN YOUR INSTALLATION

Measure your installation space to confirm you have the right number of sheets for your project. Plan the direction and lay out of your tiles.

All tiles should be inspected for defects prior to installation.

Please note: Installation of the wall panels confirms acceptance of quality.

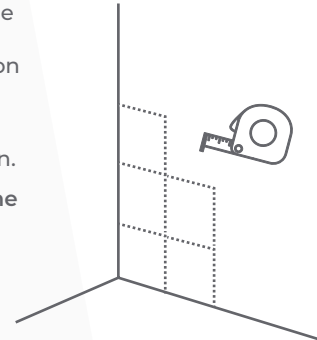

3 BEGIN INSTALLATION

Tiles should be installed left to right starting in the corner.

Gently peel back the film and place the tile sheet on the wall. Ensure you align the bottom and side of the sheet into corners for a clean line. Once applied use your hand to firmly press sheet onto the wall for optimum adhering.

Additional fixation is required for timber substrates and plywood. Countersunk screws should be used to ensure

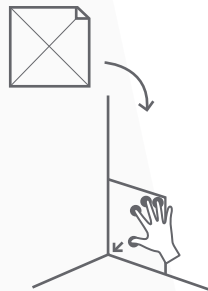

4 INSTALL SECOND TILE

Continue installing each tile sheet, matching the layout you've chosen with the grout lines for a seamless finish to complete the row.

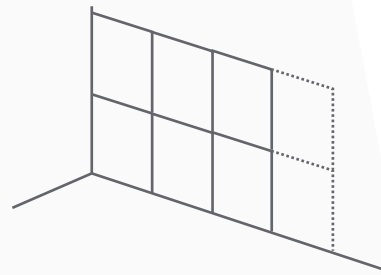

5 CUTTING YOUR TILES

Tiles may be cut using a utility knife. To fit a partial tile place a loose tile against the wall and overlapping the last placed tile, use a pencil and ruler to mark where the tile need to be cut. Cut with the utility knife and install the cut vinyl tile matching up the grout lines.

Slide the tile under mouldings and trim whenever needed.

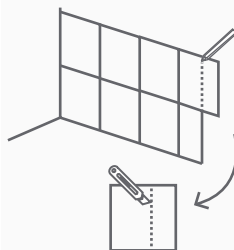

6 FINISH YOUR TILING PROJECT

Continue following the steps listed above to complete your tiling project.

CARE AND MAINTENANCE

- Remove dirt by sweeping, damp mopping or vacuuming regularly
- Avoid heavy abrasive cleaning products.
- Use furniture leg protectors
- clean with an appropriate vinyl tile cleaner as required