

# Create Your Dream Kitchen

## Kitchen Pre-Selection Form

Fill in this form with your kitchen preferences to make the most of your kitchen design consultation

Call 1800 099 999  
to book your consultation

What do you like/don't like about your current kitchen?

---

---

---

What are the 3 most important things you're looking for or need in your new kitchen?

---

---

---

Please **circle** below your kitchen preferences

Are you looking to make any structural changes to walls or move any services?

Yes or No

### Style of doors

- » Modern
- » Country
- » Alpine
- » Heritage

Door colour preference?

---

### Benchtops

- » Laminate
- » Timber
- » Bamboo
- » Stone
- » Solid Surface

### Taps

- » Wall mount
- » Bench mount

### Splashback

- » Acrylic
- » Glass
- » Tiles

### Sink

- » Single bowl
- » 1¼ bowl
- » 1¾ bowl
- » Double bowl

### Dishwasher

- » Integrated
- » Freestanding

### Oven

- » Gas or electric
- » 540mm, 600mm or 900mm
- » Built in wall, underbench or freestanding oven

Other \_\_\_\_\_

### Cooktop

- » Gas, electric or induction
- » 600mm or 900mm

Other \_\_\_\_\_

### Rangehood

- » Canopy
- » Fixed
- » Slide out
- » Undermount
- » 600mm or 900mm

### Fridge measurements

Width \_\_\_\_\_ Height \_\_\_\_\_

Depth \_\_\_\_\_

### Microwave

- » Sit on bench
- » Underbench
- » Wall mounted

### Hinges and drawer runners

- » Standard
- » Soft close
- » Push to open

### Handle Style

- » T-bar
  - » Bar
  - » Discreet grip
  - » Bow
  - » Knob
  - » Square
  - » Antique
- Other \_\_\_\_\_

### Accessories

- » Bin
- » Cutlery tray
- » Wire storage



# Measure & Plan Your Kitchen Using Our Grid.

Start by measuring your room dimensions including any new & existing doors, windows, service points for appliances or taps and any other important fixtures.

- » Floor to ceiling/bulkhead height \_\_\_\_\_ mm
- » Floor to window height \_\_\_\_\_ mm
- » Window to wall length \_\_\_\_\_ mm
- » Doorway to wall length \_\_\_\_\_ mm
- » Floor to water waste height \_\_\_\_\_ mm
- » Floor to current water source height \_\_\_\_\_ mm  
(Wall mounted taps/pipes)

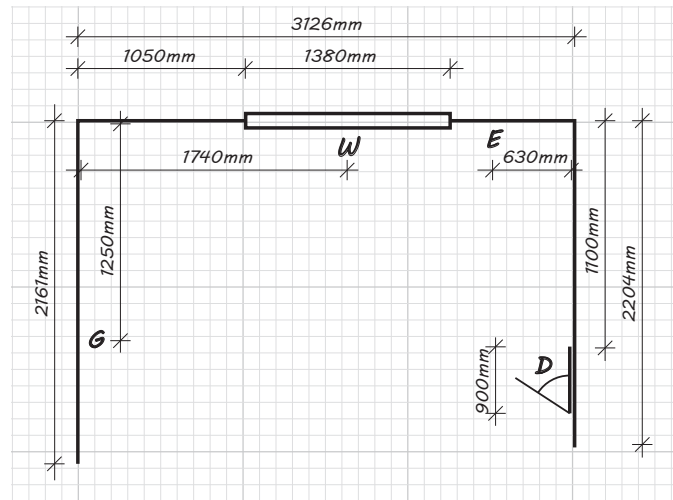

- » Mark all windows with a  » Mark existing services:  
(Measure to outside of architrave) E - Electricity
- » Mark all doorways with a - D G - Gas  
(Measure to outside of architrave) W - Water/waste water

Note: One small square represents 100mm

We can provide an In Home measure, design advice and quote from the convenience of your own home all for \$99 – which is redeemable when you purchase your new kitchen.  
**Call 1800 099 999** to book your consultation.