

INSTRUCTIONS FOR: FBTHBF-2027

Installation Instructions

1. Consult Owners Manual to determine method to lock shaft rotation. (Keyhole for interference fit or wrench to lock rotation of gear case)

2. Unscrew ENTIRE trimmer head assembly to expose threaded are. Most straight shaft trimmers are left hand rotation. (Right hand, clockwise rotation to loosen and left hand to, counter clockwise rotation to tighten)

3. For extended threads gear case, identify which adapter from the package marked "L" threads easily onto the shaft.

Note: Trimmers with threaded holes identify which male stud fits easily into hole. Follow multi fit chart for proper assembly

Note: Do not remove adapter from head if unit requires male stud with #1 adapter

4. Install correct adapter into housing as in diagram 1 and reassemble trimmer head. Tighten securely to trimmer.

Note: Some trimmers such as Stihl or Husqvarna may require a spacer between gear case and trimmer head to remove gap

Install stud by screwing in a clockwise rotation

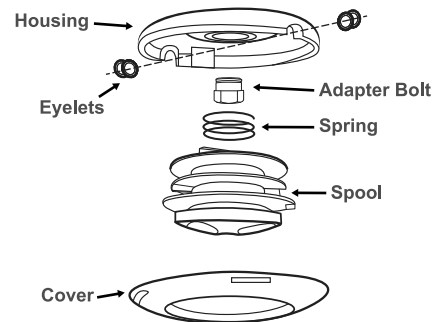
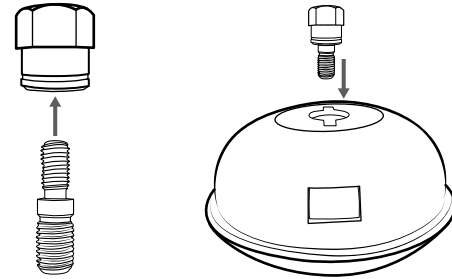

HARDWARE PACKAGE CHART

Trimmers with extended threads on gear case

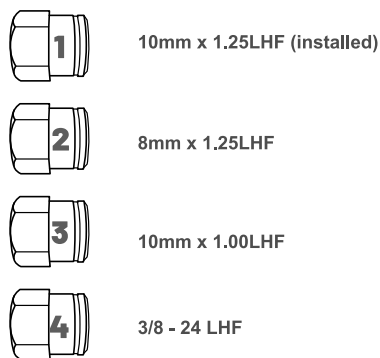

Trimmers with Female thread (holes) in gear case

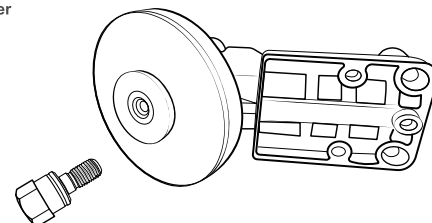
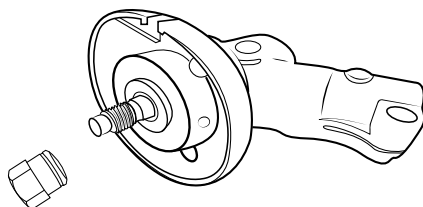
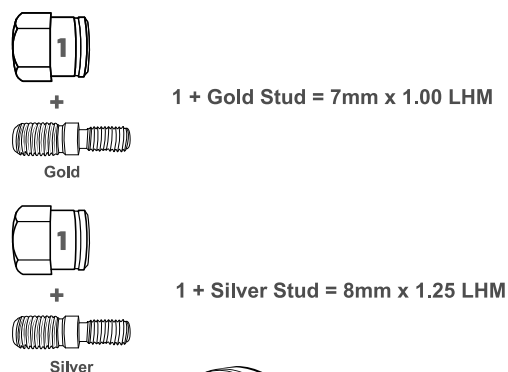

Note: Package Includes 1 gold stud (7mm) and 1 silver stud with 2 application options (8mm & 10mm)