



2L Pressure Sprayer

Item No. 3368550

Instruction Manual

Parts list

1	Pump handle
2	Fastener
3	O-Ring
4	Trigger lock
5	Trigger
6	Sprayer head
7	Bottle O-Ring
8	Pump O-Ring
9	Pump barrel
10	Pump valve
11	Inlet hose
12	Bottle
13	Strainer
14	Spring
15	Pistol bar
16	Washer
17	Nozzle lever
18	Nozzle washer
19	Nozzle tip

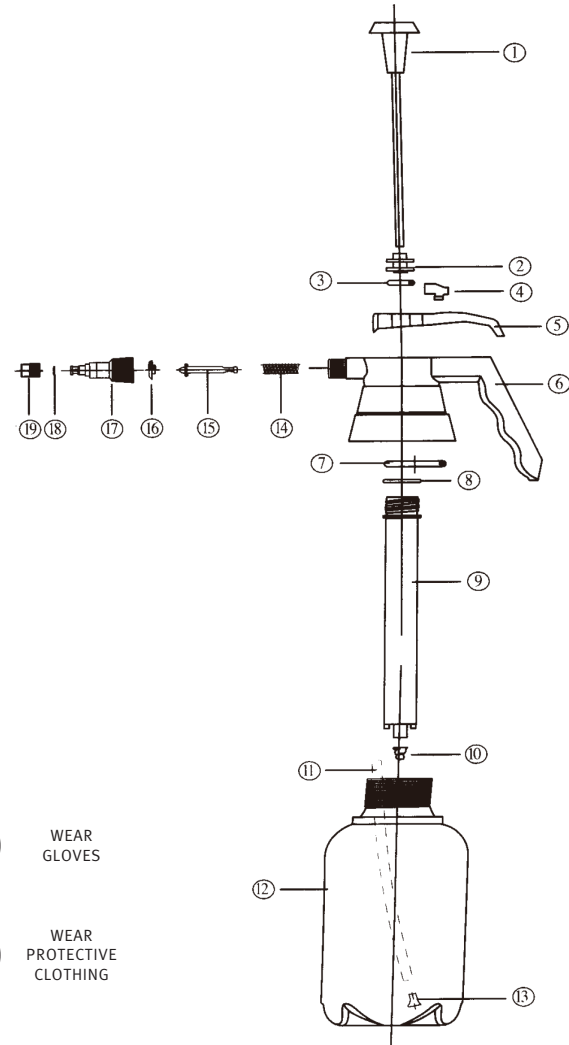

WEAR EYE PROTECTION



WEAR GLOVES



WEAR A.S APPROVED FILTER MASK



WEAR PROTECTIVE CLOTHING

PROBLEM	SOLUTION
1 When sprayer head is dripping	Check that the nozzle washer (18) is correctly in position by unscrewing the nozzle tip (19). After checking, ensure the nozzle tip is securely tightened. Refer Figure 1
2 The sprayer can not hold the pressure	Check if the O-ring (7) is correctly in position by screwing off the sprayer head (6). It should be sitting flush inside the sprayer head housing. Refer Figure 2 Check if the inlet hose (11) is correctly in position by unscrewing the sprayer head (6). Make sure the inlet hose is connected securely to the outlet. Refer Figure 3
3 The sprayer can not spray	Ensure the nozzle tip (19) is not blocked. Unscrew and clear if necessary. Also check the strainer (13) which is located at the bottom of the inlet hose. Clear any blockages. Refer Figure 4

Figure 1

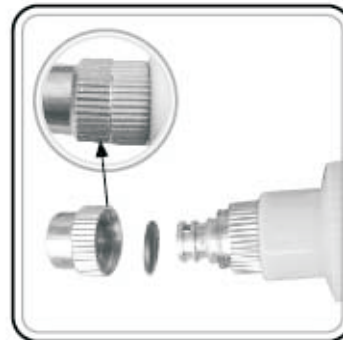

Figure 2

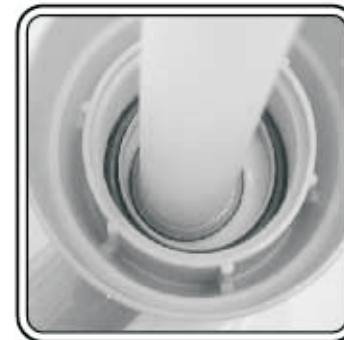

Figure 3



Figure 4



WARNINGS

- Use caution when mixing garden or household chemicals in this sprayer as gas can build up. Always read dilution instructions carefully.
- Empty completely and thoroughly rinse before storage.
- Test the sprayer with water before using chemicals.
- Before using chemicals refer to the chemical manufacturer's label and safety instructions for safe handling procedures and recommended personal protective clothing and safety equipment.
- Never use flammable liquids, caustics, acids, or hot water in this tank.
- Do not use sprayer near open flame or anything that could cause ignition of the spray.
- Spray when the air is calm to prevent drift of chemicals. Do not spray in windy conditions.
- Always inspect hose and all the hose connections before each use. A damaged hose, or loose hose connection can result in unintended exposure to the pressurised chemical, resulting in serious injury or property damage.
- Do not pressurise with any mechanical device such as an air compressor, since this can create a dangerous pressure level and bursting of parts resulting in serious injury. Only use original pump.
- Do not store chemicals in this tank.

GUARANTEE: Under Australian and New Zealand laws, we guarantee this product is acceptable quality and fit for purpose.