

Dorset granny flat show home



Dorset granny flat show home



We offer a range of expertly designed houses and granny flat plans with materials supplied by Bunnings Trade. Each house and granny flat plan has a clever use of space, is engineered for New Zealand conditions, comes packed with extra features, and uses quality products supplied by trusted brands.

## Quality materials supplied by Bunnings Trade

These homes are delivered faster and with less disruption thanks to pre-engineered portal frames that are assembled in hours, not weeks.

The system simplifies compliance and reduces risk. The result is a warmer, drier and more energy-efficient home that meets future climate and resilience standards, lowering running costs and improving comfort.

Our range of ready to build granny flats are here to help you find the right option to bring your client's new home to life, affordably and without compromise.

# BUNNINGS TRADE

## EXPLORE OUR READY TO BUILD GRANNY FLAT DESIGNS



To find out more, contact your account manager or email Steve Ellis at [sellis@bunnings.co.nz](mailto:sellis@bunnings.co.nz)

## Dorset granny flat show home



## Cleverly designed with ease in mind

Small in size but big on design, our new granny flats make the most of every metre, feeling open, functional, and impressively spacious — and all under 70m<sup>2</sup>.

### New market opportunity

The new granny flat legislation in New Zealand allows simple standalone granny flats up to 70m<sup>2</sup> to be built without a full building consent, significantly reducing red tape and unlocking demand for secondary dwellings.

### Fully prefabricated

Our granny flat designs are fully pre-engineered with Pryda via our unique Truss House™ build method, helping to reduce build complexity, standardisation of designs, on-site labour and remove the need for certain trades.

### Simplified compliance

Designs aligned with code requirement, reduced compliance complexity, clear documentation and specifications.

## DANDALL 30m<sup>2</sup>



- Open-plan design with storage.
- Compact kitchenette (connection to plumbing services optional).
- Raked gable ceiling.
- Large sliding door opens to deck perfect for outdoor living.

## ROMNEY 40m<sup>2</sup>



- Separate bedroom for added privacy.
- Raked gable ceiling.
- Ample storage throughout.
- Large sliding door opens to deck perfect for outdoor living.

## DORSET 50m<sup>2</sup>



- Separate bedroom for added privacy.
- Bathroom and separate powder room.
- Raked gable ceiling.
- Large sliding door opens to deck perfect for outdoor living.

**TRUSS HOUSE™**

Engineered With  
**pryda**

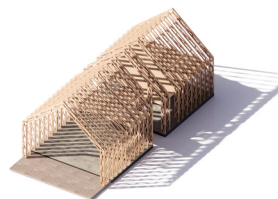

## KERRY 60m<sup>2</sup>



- Master bedroom with walk-in wardrobe.
- Second bedroom with double wardrobe.
- Bathroom and separate powder room.
- Separate laundry with washer/dryer space.
- Raked gable ceiling.
- Large sliding door opens to deck perfect for outdoor living.

## HAMPSHIRE 70m<sup>2</sup>



- Open-plan design with storage.
- Compact kitchenette.
- Raked gable ceiling.
- Large sliding door opens to deck perfect for outdoor living.

Bedrooms:	Open Plan
Living:	1
Bathroom:	N/A
Laundry:	N/A
Total house floor area:	29.6m <sup>2</sup>
Total area over frames:	40.6m <sup>2</sup>
Deck size:	5.2m <sup>2</sup>

Bedrooms:	1
Living:	1
Bathroom:	1
Laundry:	1 (Euro)
Total house floor area:	34.1m <sup>2</sup>
Total area over frames:	46.5m <sup>2</sup>
Deck size:	5.9m <sup>2</sup>

Bedrooms:	1
Living:	1 + Study nook
Bathroom:	1 + Powder room
Laundry:	1 (Euro)
Total house floor area:	43m <sup>2</sup>
Total area over frames:	72.3m <sup>2</sup>
Deck size:	5.9m <sup>2</sup>

Bedrooms:	2
Living:	1
Bathroom:	1 + Powder room
Laundry:	1
Total house floor area:	59.8m <sup>2</sup>
Total area over frames:	78.6m <sup>2</sup>
Deck size:	8.8m <sup>2</sup>

Bedrooms:	2
Living:	1
Bathroom:	1 + Powder room
Office:	1
Laundry:	1
Total house floor area:	70m <sup>2</sup>
Total area over frames:	90.3m <sup>2</sup>
Deck size:	9.7m <sup>2</sup>

## Dorset granny flat show home

