

RED POLYURETHANE CASTORS

UP TO
150kg
LOAD CAPACITY

Red Polyurethane castors are a medium duty castor fitted with precision bearings which provides minimal rolling resistance.

Ensure wheel and surfaces are free from debris prior to use as the polyurethane wheel offers some floor protection however is not recommended for decorative surfaces.

Manufactured with a mounted plate the red PU range has sufficient load rating for low overall height.



0168699



0168696



0168698

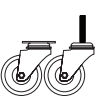
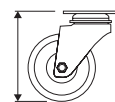
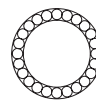
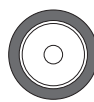
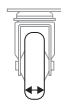
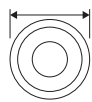
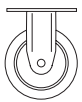

Product Code	Castor Type	Wheel Diameter (mm)	Tread Width (mm)	Wheel Material	Bearing Type	Load Capacity (kg)	Finished Height (mm)	Fitting Type
0168696	Swivel	75	32	Polyurethane	Precision	120	109	Plate Mount
0168697	Swivel + Brake	75	32	Polyurethane	Precision	120	109	Plate Mount
0168698	Swivel	100	32	Polyurethane	Precision	150	132	Plate Mount
0168699	Swivel + Brake	100	32	Pol Urethane	Precision	150	132	Plate Mount