

evekare™

Instruction manual

EVK-0998-MCE

Classic Smart Bidet Toilet Seat

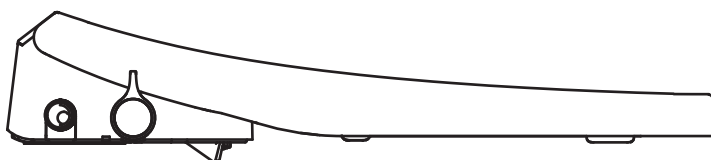

Rated voltage	220-240V~
Rated frequency	50/60Hz
Rated power	1050W
Waterproof	IPX4
Anti-electric shock TYPE	I



Aftermarket support and technical advice
E: warranty@evekare.com.au
T: (02) 9524 4515

- 
- Please read this manual thoroughly before installing & using the product.
 - Please do not hesitate to contact us if you have any questions in relation to the products installation or usage.
 - Please retain this manual for future reference.

Contents

Product contents.....	1
Specifications.....	2
Product drawing.....	3
Power and water connection.....	3
Safety precautions.....	6
Functions.....	7
Product installation.....	8
Parts identification.....	10
Usage instructions.....	11
Extended periods of non-use.....	12
Cleaning the bidet seat.....	13
Nozzle cleaning.....	14
Clean filter screen.....	14
Toilet pan and cistern surface cleaning.....	14
Troubleshooting.....	15
Spare parts.....	16

Product contents

Bidet Toilet Seat

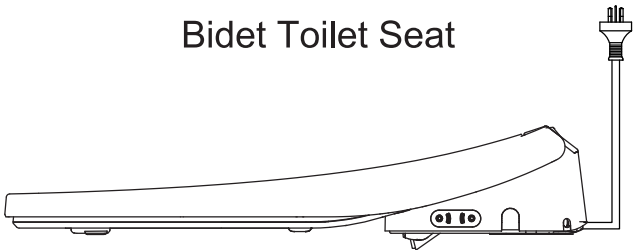

Bolt (2pcs)



Seat Adjustment
Plate (2pcs)



Seat Adjustment
Sheet (2pcs)

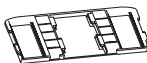

Seat Mounting Plate

Nylon Spigots
(2pcs)

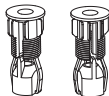

Tee

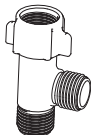

58cm Flexible Inlet Hose



Instructions



Installation Template

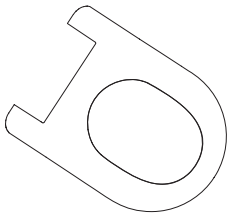

Specifications

Model: EVK-0998-MCE

Rated voltage and rated frequency		220-240V ~ 50/60Hz			
Length of cord		1.5m			
Washing functions	Water usage	Posterior cleaning	About 0.45~0.7L/min (hydraulic pressure of 0.18Mpa)		
		Feminine cleaning			
	Massage cleaning		Pulsating water jet		
	Heated water temperature range		Low Temperature: approx. 35°C, High Temperature: approx. 38°C (Subjected to the ambient temperature of install environment)		
	Safety device		A protection device to shut off the water flow in case of high water temperature.		
Seat cover and seat	Soft-close control for seat and cover		Damper device		
Cleaning	Self-cleaning nozzle		Auto self-rinsing cycle before each use		
Rated Power	1050W	Maximum power	1800W	IP Rating	IPX4
Temperature of supplied-water	5°C~35°C				
Pressure of supplied-water	Minimum water supply conditions: 0.1MPa Maximum water supply conditions: 0.50MPa				

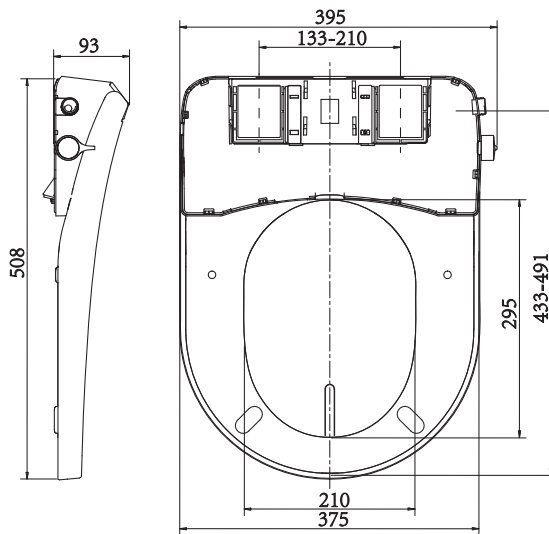

unit = mm

Power and water connection

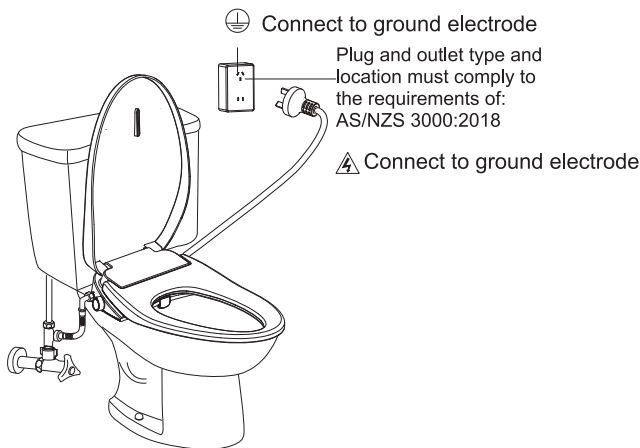

A toilet seat douche or bidet must comply with AS/NZS 3500 Part 1 Water Services Clause 12.2.3. Where a 'high hazard' reduced pressure zone (RPZ) backflow prevention device is required, it must be installed upstream of the toilet douche seat or flexible hose connection. The RPZ must be fitted before connecting the property's water service to the water meter.

REAR ENTRY SYSTEMS

Included components are suitable for bottom entry cisterns.
Rear entry cisterns may require additional components.

⚠️ WARNING: THIS TOILET DOUCHE SEAT MUST BE INSTALLED WITH APPROPRIATE BACKFLOW PROTECTION CONFORMING TO THE NATIONAL CONSTRUCTION CODE - VOLUME THREE.

NOTE: The installation of this product must comply with the requirements of AS/NZS 3500.1 and AS/NZS 3000.

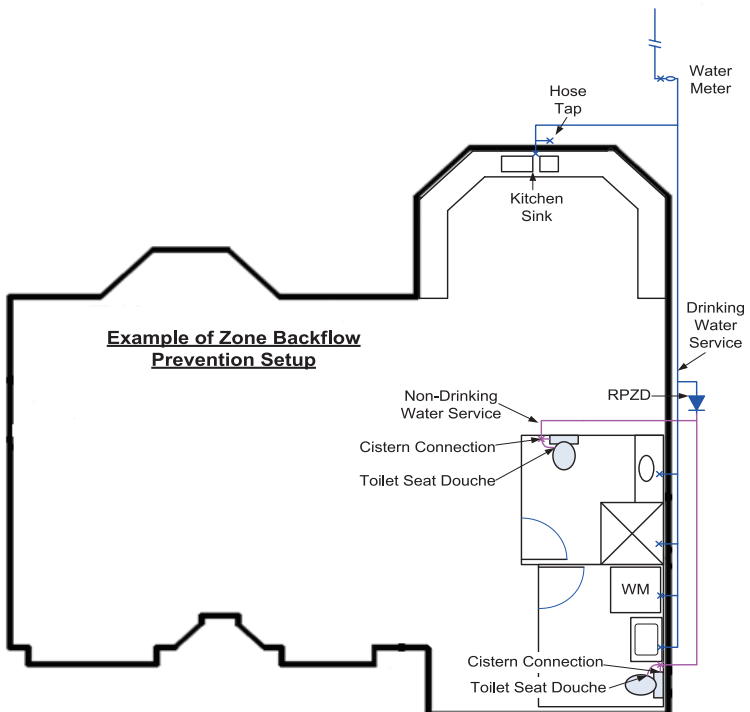
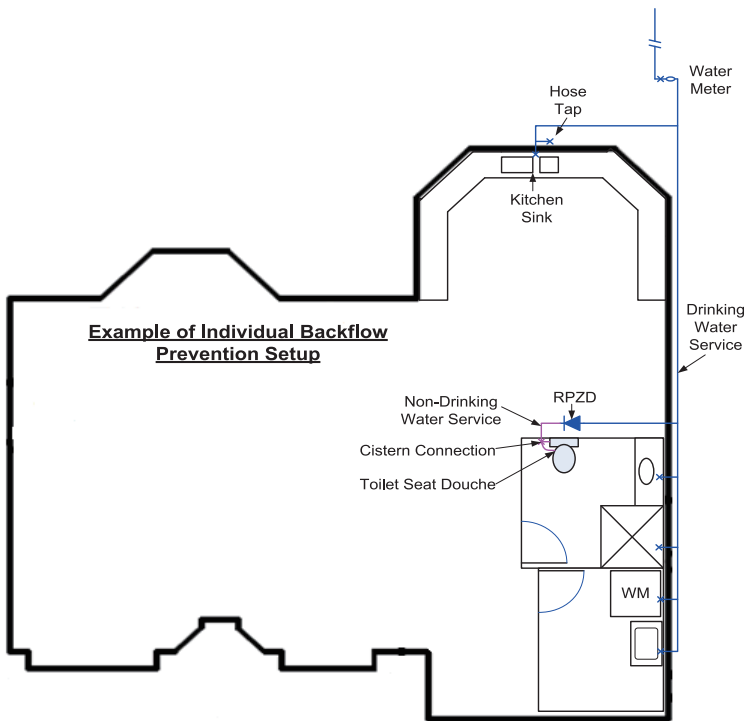

The standard for this machine: IEC60335-2-84 :2019,
/IEC 60335-1: 2010+A1:2013 +A2: 2016

Installation is subject to the requirements of the applicable regulatory authority, the National Construction Code Volume Three – Plumbing Code of Australia, associated WMTS 051 and AS/NZS 3500 series

Plumbing components:

All such components used for connection to the products must be separately WaterMark approved and selected or installed by the licensed plumber following national plumbing codes.

Where the douche outlet is, in all positions, at least 25 mm above the overflow level of the pan, backflow prevention is not required. Where the outlet, in any position, is less than 25 mm above the overflow of the pan, a high-hazard backflow prevention device, complying with AS/NZS 2845.1 or AS/NZS 2845.2, shall be installed.

The drinking water supply shall be protected from the hazard(s) by installing—

(a) individual protection at each toilet douche seat connection with a high-hazard backflow prevention device.

or



(b) zone protection with a high-hazard backflow prevention device installed on a the water supply line that serves each Toilet douche seat connection and this water supply line is separately connected to the main drinking water supply.

WARNING: THIS DOUCHE SEAT MUST BE INSTALLED WITH APPROPRIATE BACKFLOW CONFORMING TO THE NATIONAL CONSTRUCTION CODE VOLUME THREE

WARNING: Installation can only be conducted by the authorized license plumber following NCC Part Three (PCA) with appropriate high-hazard cross connection control.

Safety precautions

In order to avoid injury and property damage, please follow the below safety warnings and precautions. Read this manual carefully before installation, and install the appliance in strict accordance with the instructions. Please retain these instructions for future reference.

 WARNING	
	Do not operate this appliance if the supply cord or plug is damaged, has malfunctioned, or has been dropped or damaged in any manner. In the event of a product malfunction shut off the electrical and water supply immediately and return the appliance to an authorised service facility for examination, electrical or mechanical adjustment or repair. Do not attempt to repair the appliance yourself.
	If the external flexible cable or cord of this appliance is damaged it shall be exclusively replaced by the manufacturer or his service agent, or a similar qualified person in order to avoid a hazard.
	Never submerge bidet toilet seat in water. Do not install this appliance in a location where water might be splashed onto the main power supply, or in a location subject to excessive moisture or condensation. Ensure install location has adequate ventilation to avoid damage to electrical components due to high humidity.
	This product should be installed by a licensed plumber as per the requirements of AS/NZS 3500. Maximum operating pressure 500KPa. Pressure limiting valve should be installed where water pressure exceeds 500KPa.
	All pipe work should be thoroughly flushed prior to installation as foreign materials may block the filters.
	The water supplied to the appliance must only be potable (drinking) water, do not connect the appliance to a non potable water source (eg recycled or ground water) as doing so may lead to skin irritation or infection.
	Do not hard wire this appliance or modify the supply cord in any way, doing so will void the warranty.
	The flexible water inlet hoses must not be stretched, twisted, kinked or exposed to naked flames or corrosive agents. Doing so could lead to the failure of the hose and property damage due to flooding that will not be covered by warranty. It is recommended that the flexible water inlet hoses are replaced every 5 years.
	Do not use corrosive or abrasive cleaning products to clean the appliance as doing so will damage the unit. Clean the toilet seat using warm soapy water, unplug the appliance when cleaning and ensure that electrical components are not exposed to water.
	Do not stand or place heavy objects onto the appliance.
Unplug and drain the appliance if you do not intend on using it for an extended period of time.	
Do not connect the appliance to the power outlet until installation is complete, doing so may cause the appliance to malfunction.	

Failure to follow warnings may result in warranty being voided

Functions

Cleansing functions

Posterior cleaning	Posterior cleaning mode
Feminine cleaning	Feminine cleaning mode
Massage	Water flow pulsates between strong and soft

Comfort functions

Water temperature adjustment	Change the temperature of water for cleaning functions, between two temperature settings
Night light function	Night light for dark environments

Cleaning function

Self-cleaning nozzle	Nozzle automatically performs a self-cleaning cycle before each use
----------------------	---

Product installation

• Installation tools



Cross-head screwdriver



Wrench



Bucket and rag

• Attention

1. Water pressure range: 0.1-0.50MPa, please follow the instructions.
2. Cistern cock needs to be located near to where the product will be installed.
3. Please use the braided hose that comes with the product to prevent water leakage.
4. When installing the braided hose, take care to prevent the black gasket from falling out.

• Installation Procedure

1. Remove the old toilet seat.

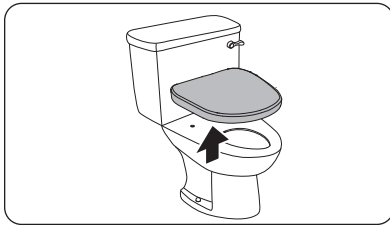

2. Place the mounting template on the ceramic bowl top as shown. Align it with the rim of the toilet.

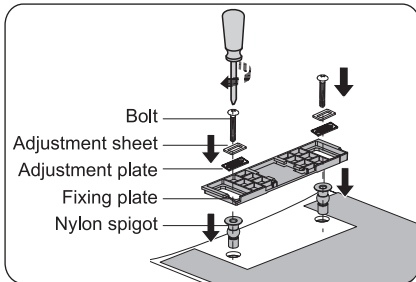
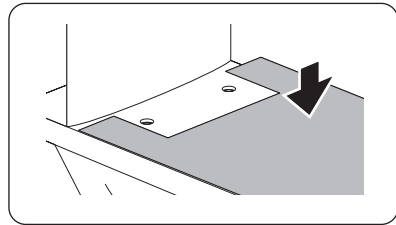

- a) Insert the nylon spigot into the ceramic hole.
- b) Place fixing plate in the cut-out part of the template.
- c) Place adjusting sheet and plate in the fixing plate.
- d) Align the bolts with the nylon spigot holes and tighten.

4. To ensure the normal use of the product, please press reset key before installation.

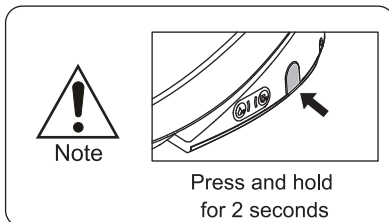

5. Slightly push the cover into fixing plate until you heard a “click” sound, indicating that cover has been installed in place.

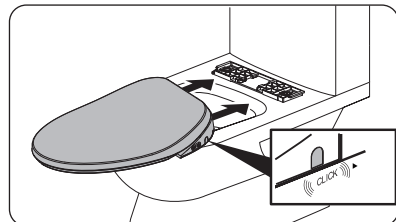

Product installation (continued)

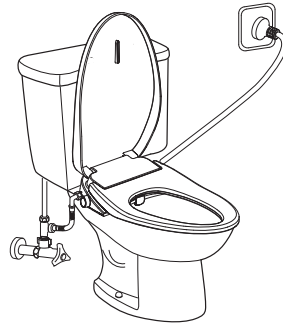
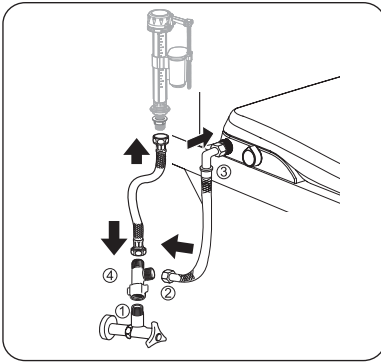

1. Turn off cistern cock.
 2. Remove flexible inlet hose from cistern cock.
 3. Connect the tee fitting to the cistern cock.
 4. Connect the long flexible hose (58cm) to the tee.
 5. Connect the long flexible hose (58cm) to the water inlet of the bidet seat.
 6. Connect the existing flexible inlet hose (supplying the toilet cistern) to the tee.
- NOTE: We recommend existing hose be inspected and replaced with a new inlet hose if required.

Note:

This appliance has been individually quality tested after manufacture, it is not uncommon for a small amount of residual test water to be left in the appliance or it's fittings.

Note:

Do not connect the power supply to the appliance until it is installed and the water supply has been connected. Doing so could lead to the appliance malfunctioning.

Parts identification

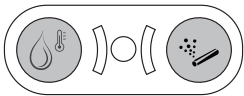
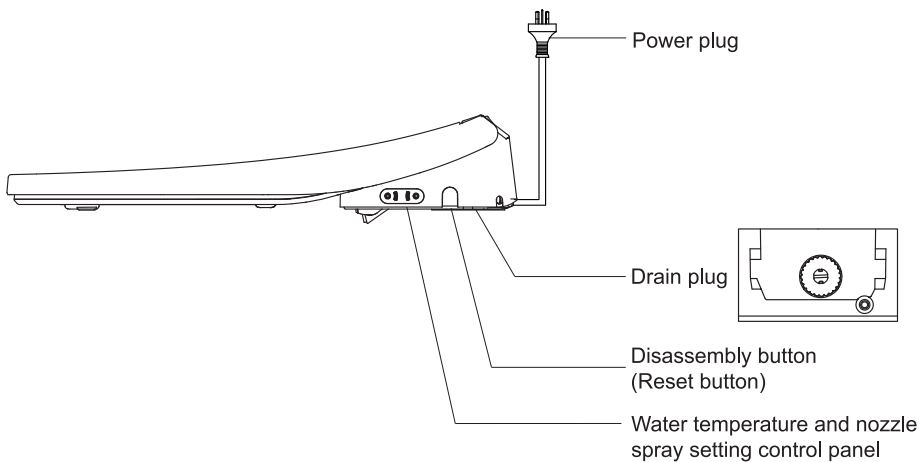
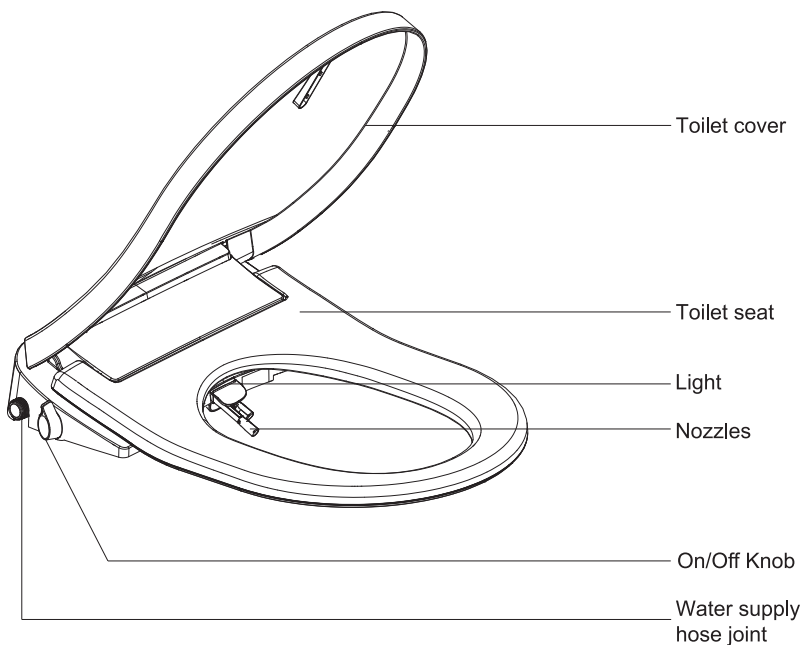

Usage instructions

• Rinsing function

1. Feminine/Posterior Rinsing

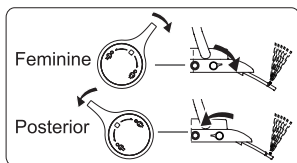

After sitting down, rotate the knob forward or backwards to start rinsing.

2. Self-cleaning



The nozzle performs a self-cleaning each time the knob is turned to a new position.

• Control panel functions

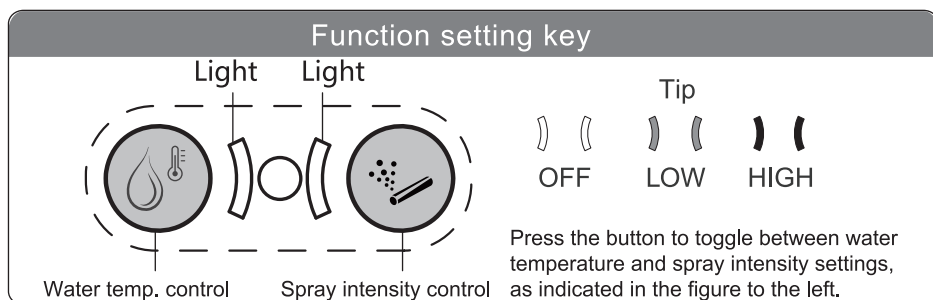

- Repeatedly press  to toggle between water temperature settings.



OFF

LOW

HIGH

- A short sound indicates toggling between temperatures, and a long sound indicates the function is turned off.
- Low Temp. approx. 35°C, High Temp. approx. 38°C

- Repeatedly press  to toggle between spray intensity settings.





OFF

LOW

HIGH

- A short sound indicates toggling between spray intensity, and a long sound indicates the function is turned off.
- OFF Setting: Normal Water Pressure Force
Low Setting: Strong Water Pressure Force
High Setting: Massage Water Pressure Function

• Light setting

Press  and  at the same time to turn the light on and off. A sound indicates when the light is turned on or off.

• Hot water temperature protection function:

1. When the water temperature exceeds 45°C, it will sound an alarm and automatically switch to self-cleaning mode.
2. To reset, the product must be reconnected to the power supply.

• Use during power failure

The water temperature cannot be adjusted when the power supply is cut off, however the washing function can be used with supplied temperature water.

Extended periods of non-use

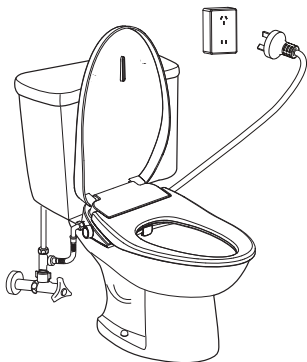

1. Turn off the power point and unplug the cord from the socket. Turn off the water supply at the cistern cock, uninstall the flexible inlet hoses (drain residual water left in hoses into a bucket).

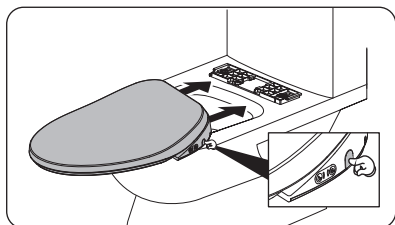

2. Press the seat release button and remove the seat from the mounting plate on the pan. Store the appliance and all components in a dry, safe place until re-installation is needed.

Note:
When re-installing the appliance please check and test the appliance before using.

Cleaning the bidet seat



Note: Please cut off the power supply before cleaning.

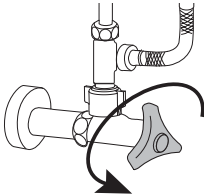

1. Turn off the water supply at the cistern cock.

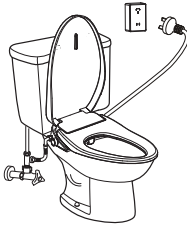

2. Turn off the power supply and unplug the cord from the power outlet.

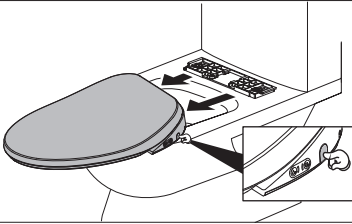

3. Press the seat release button and remove the seat from the pan.

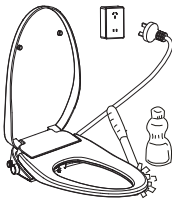

4. Using a sponge or soft cloth and warm soapy water, clean the area around the seat mounting plate. Then wipe down the seat and seat cover.

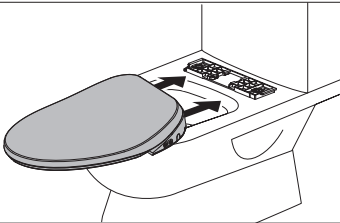

5. Re-install the seat and ensure the appliance is completely dry before re-connecting the water and power supply.

Nozzle cleaning

- Use a soft cloth, sponge or small brush with water or a neutral detergent.
- Gently pull out the nozzle and support it while wiping the spray tube and nozzle.

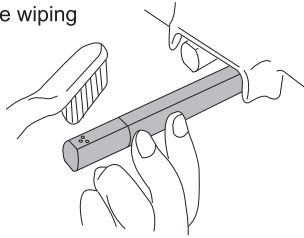

Clean filter screen

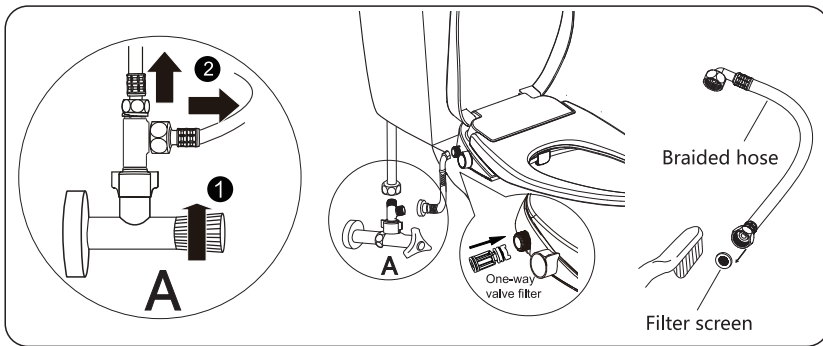

- Make sure the cistern cock is closed off and the power is off before you clean the filter screens.
- Remove braided hose completely, and remove the filter screen from the braided hose end and from the product.
- Thoroughly clean the filter screens with a small brush.
- Re-install the filter screens after cleaning, starting with the filter screen in the product.



Toilet pan and cistern cleaning

- Wipe the product surface with a sponge or soft cloth dampened with room temperature water or a neutral detergent.
- Lift the seat cover and the seat ring when cleaning the toilet bowl with cleaning agents.
- Do not put the seat ring/seat cover down until any cleaning agent that has been used on the toilet bowl has been completely washed off. Otherwise the cleaning agent may corrode the surface of the seat ring/seat cover.

Troubleshooting

Problem	Possible Cause	Solution
The appliance does not function at all.	There is no power being supplied to the appliance.	Check that the power supply is connected.
There is no water when the control knob is turned on.	The inlet hose is kinked, causing a blockage.	Close the cistern cock and reinstall the inlet hose.
After turning on the control knob, the spray rod does not extend, but water continues to flow.	The nozzle is in self-cleaning mode.	Wait a few seconds.
	Abnormal water temperature, water temperature protection mode enabled.	Pull out the plug to reset and reconnect the power after 5 seconds.
	Water vapor enters the product during use or cleaning in an environment without a dry/wet separation, resulting in a temporary short circuit.	Please leave the product in a dry environment for 1-2 days, and reconnect the electricity to restore normal use. If the problem persists, please contact the after-sales service for maintenance or replacement.
After turning on the control knob, the spray rod does not extend, and a lot of water leaks into the toilet.	Abnormal pressure, pressure relief mode enabled.	Please close the cistern cock, remove the hose, check whether there is any foreign matter in the filter screen at the inlet, reinstall the hose, and turn the control knob to the maximum setting.
Using normal water pressure input, the amount of water coming out of the nozzle is less than normal and has less pressure than normal.	The filter screen is blocked.	Please clean the filter screen of the hose and the filter screen of the product inlet according to the maintenance instructions.
Spray rod extends normally and rinses, but there is no warm water.	The product is not connected to the power supply or turned on.	Plug the product into the power in and check control panel light is on.
	The water temperature function is turned off.	Turn on the water temperature function by pressing the key.
	The water temperature protection mode is disconnected. A reset is needed.	Press the product disassembly button and hold for two seconds.
The night light is not turning on.	The night light is turned off or damaged.	Reconnect the power supply and press both the water temp. and spray intensity buttons at the same time to turn on the light. If the problem still exists contact the after-sales department for replacement.
Water leaking out from the underside.	Inlet/Supply pressure too high (over 500KPa).	Fit pressure limiting valve limiting the water pressure to below 500KPa (sold separately).

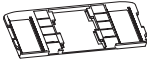
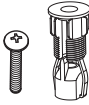
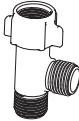
Spare parts list

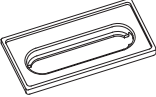
1	ESP-8029-GBL	Fixing plate	
2	ESP-8030-GBL	Seat fixing kit	
3	ESP-8031-GBL	Tee	
4	ESP-8032-GBL	58cm flexible inlet hose	
5	ESP-8033-GBL	Seat adjustment plate	
6	ESP-8034-GBL	Seat adjustment sheet	

Spare parts can be ordered from the original place of purchase.