

R18SUP10



IMPORTANT!

It is essential that you read the instructions in this manual before assembling, operating, and maintaining the product.

Subject to technical modification.

Safety, performance, and dependability have been given top priority in the design of your cordless submersible pump.

INTENDED USE

The cordless submersible pump is intended to remove clean or dirty water out of ponds, pools, or tanks. The product is also used to drain flood water or control excess rainwater during floods.

The product is intended only for home or domestic use. The product may be used indoors or outdoors.

Do not use the product for any other purpose.

GENERAL SAFETY WARNINGS

- The product is not intended for use by persons, including children, with reduced physical, sensory or mental capabilities, or lack of experience and knowledge, unless they have been given supervision or instruction concerning use of the product by a person responsible for their safety. Children should be supervised to ensure that they do not play with the product.
- Save all warnings and instructions for future reference. Refer to them frequently, and use them to instruct others who may use the product. If you loan someone the product, also loan them these instructions to prevent misuse of the product and possible injury.
- Keep the area of operation clear of all persons, particularly small children and pets.
- Inspect the product before each use. Check for loose fasteners, etc. Make sure that all guards and handles are properly and securely attached. Replace any damaged parts before use. Check for battery pack leaks.
- Do not modify the product in any way or use parts and accessories that are not recommended by the manufacturer.
- Do not operate the product while barefoot or when wearing sandals or similar lightweight

footwear. Wear protective footwear that will protect your feet and improve your footing on slippery surfaces.

- Exercise caution to avoid slipping or falling.
- Avoid inserting hands into the inlets/outlets of the product while it is turned on.
- Do not install or operate the product in an explosive environment or near flammable materials.
- Do not use the product if the switch does not turn it off. Have the switch replaced by an authorised service centre.
- Turn off the product, remove the battery pack, and allow the product to cool down. Make sure that all moving parts have come to a complete stop:
 - before servicing
 - before clearing a blockage
 - before checking, cleaning, and working on the product
 - before changing accessories
 - before leaving the product unattended
 - whenever performing maintenance
- Immediately turn off the product and remove the battery pack in the event of an accident or breakdown. Never operate the product again until it has been fully checked by an authorised service centre.

BATTERY TOOL USE AND CARE

- Remove the battery pack from the product before recharging. Recharge only with the charger specified by the manufacturer. A charger that is suitable for one type of battery pack may create a risk of fire when used with another battery pack.
- Use only battery packs intended specifically for the product. Use of any other battery packs may result in a risk of fire, electric shock, or injury to persons.
- Do not use a battery pack or product that is damaged or modified. Damaged or modified batteries may exhibit unpredictable behaviour resulting in fire, explosion, or risk of injury.
- Do not expose a battery pack or product to fire or excessive temperatures. Exposure to fire or excessive temperature above 130°C may cause explosion.
- When the battery pack is not in use, keep it away from other metal objects, like

paper clips, coins, keys, nails, screws, or other small metal objects that can make a connection from one terminal to another. Shorting the battery terminals together may cause burns or a fire.

- Under abusive conditions, liquid may be ejected from the battery. Avoid contact. If contact accidentally occurs, flush with water. If liquid contacts eyes, additionally seek medical help. Liquid ejected from the battery may cause irritation or burns.
- Remove exhausted battery packs from the product and safely dispose of them.

CORDLESS SUBMERSIBLE PUMP SAFETY WARNINGS

- Ensure that the battery pack is removed from the battery box when installing the product.
- Ensure that all connections are leak free. Use a thread seal tape or a suitable sealant on the connection thread.
- When tightening threaded connections, do not apply excessive force that may cause damage.
- Make sure to select a stable support when mounting the battery box.
- Avoid twisting the pole or bottom pump housing when extension collars are unlocked as this could bind the cable inside.
- If the product needs to be raised or lowered, connect a suitable lowering rope to the carrying handle. Do not lift the product using the hose or power cord.
- Do not use the product for corrosive, abrasive, explosive or dangerous liquids. Fluids other than water damage the product, can create a fire hazard, and could cause physical injuries to the operator.
- Do not use the product with potable water.
- Do not operate the product without liquid. Do not run the product dry.
- Do not use the product when people are in the water.
- Do not remove the hose while the product is still operating.
- Pollution of the liquid could occur due to leakage of lubricants.
- Water discharged from the product may cause the ground to become wet and

may cause slipping. Make sure to clean the discharged water after operating the product.

- Do not discharge water to areas with electrical or high voltage elements, active chemicals, or other objects or substances that might cause danger when mixed with water.
- Hold the product securely. Always wear the wrist lanyard except when the barrel hook is used. Do not leave the product unsupervised while in use. Make sure the product cannot tip over.
- Do not submerge the battery box in water.
- Do not expose the inside of the battery compartment to rain or wet conditions. The product is only water resistant when the battery compartment is closed. Water entering the product increases the risk of electric shock.

ADDITIONAL BATTERY SAFETY WARNINGS

To reduce the risk of fire, personal injury, and product damage due to a short circuit, never immerse the battery box, battery pack, or charger in fluid or allow fluid to flow inside them. Corrosive or conductive fluids, such as seawater, certain industrial chemicals, and bleach or bleach-containing products, etc., can cause a short circuit.

TRANSPORTATION AND STORAGE

- Turn off the product, remove the battery pack, and allow both to cool down before storing or transporting.
- Clean the product thoroughly before storing. Remove any excess water by fully extending the product. Store the product upright and fully extended to drain water completely. Store the product in a dry, well-ventilated area that is inaccessible to children. Keep the product away from corrosive agents, such as garden chemicals and de-icing salts.
- When transporting the product in a vehicle, secure it against movement or falling to prevent injury to persons or damage to the product.

TRANSPORTING LITHIUM BATTERIES

Transport the battery in accordance with local and national provisions and regulations.

Follow all special requirements on packaging and labelling when transporting batteries by a third party. Ensure that no batteries can come in contact with other batteries or conductive materials while in transport by protecting exposed connectors with insulating, nonconductive caps or tape. Do not transport batteries that are cracked or leaking. Check with the forwarding company for further advice.



Waste electrical products should not be disposed of with household waste. Please recycle where facilities exist. Check with your local authority or retailer for recycling advice.

MAINTENANCE

- Use only original manufacturer's replacement parts, accessories, and attachments. Failure to do so can cause possible injury, can contribute to poor performance, and may void your warranty.
- Servicing requires extreme care and knowledge and should be performed only by a qualified service technician. Have the product serviced by an authorised service centre only.
- You may make adjustments and repairs described in this manual. For other repairs, contact an authorised service centre.
- Periodically inspect the pump, hoses, and water inlet. Ensure that the hoses and water inlet are free from mud, sand, and debris.
- After each use, clean the product with a soft, dry cloth. Keep the product dry, clean, and free from oil and grease when not in use. Any part that is damaged should be properly repaired or replaced by an authorised service centre.
- Clean the filter only when there is noticeable decline of functionality.
- Bring the product to an authorised service centre to replace damaged or unreadable labels.

SYMBOLS IN THIS MANUAL



Parts or accessories sold separately



Note



Warning

SYMBOLS ON THE PRODUCT





Read and understand all instructions before operating the product. Follow all warnings and safety instructions.



Regulatory Compliance Mark (RCM). The product meets applicable regulatory requirements.

LED INDICATOR DESCRIPTIONS

LED indicator	Red LED	Green LED	Status
 Low battery	On	-	The battery pack capacity is at 25%. The LED light stays on until the battery pack is recharged.
	-	On	The product is on.
	2 quick flashes	-	The 15-minute timer is running out.
	3 quick flashes	-	The 10-minute timer is running out.
	4 quick flashes	-	The 5-minute timer is running out.
	5 quick flashes (with buzzing sound)	-	The water sensor alarm is on. The product does not detect water. Put the submersible pump under water.
 Water sensor	6 quick flashes	-	The low current alarm is on. The motor is idling. Clean the pump inlet and put the submersible pump under water.
	7 quick flashes	-	The over voltage alarm is on. Replace the battery pack.
	8 quick flashes	-	The short circuit alarm is on. Turn off the product and remove the battery pack. Bring the product to an authorised service centre.
	2 slow flashes	-	The under voltage alarm is on. The battery pack is overdischarging. Change the battery pack.
	3 slow flashes	-	The current check circuit fault alarm is on. The circuit is damaged. Turn off the product and remove the battery pack. Bring the product to an authorised service centre.



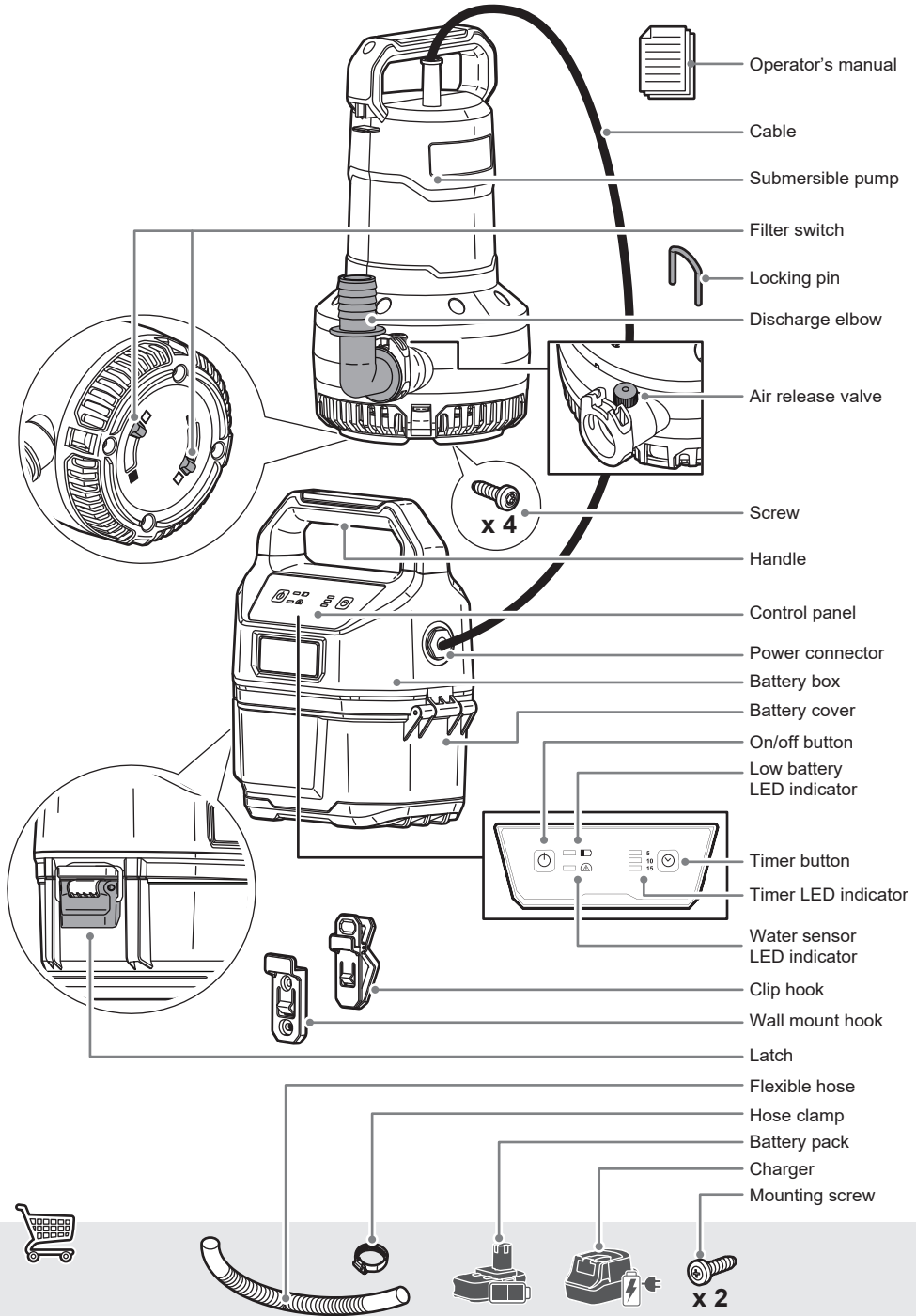

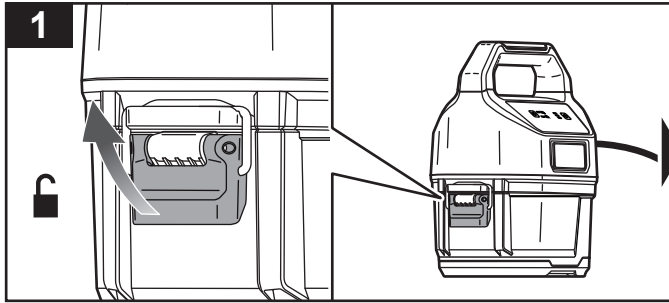

1 Flip up the latch.

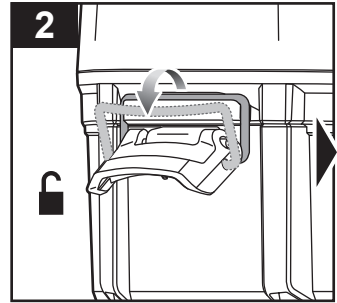

2 Remove the metal bar from the groove to unlock the battery box from the battery cover.

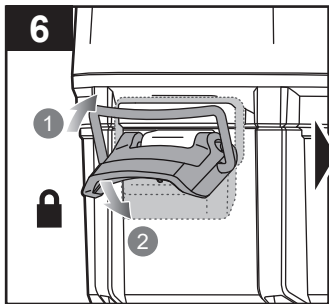

6 Hook the metal bar on the groove and flip down the latch to lock the battery box to the battery cover.

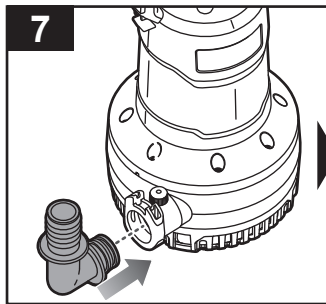

7 Install the discharge elbow into the submersible pump.

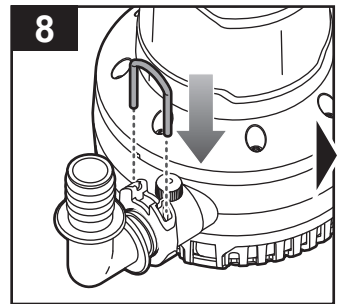

8 Insert the locking pin to secure the discharge elbow.

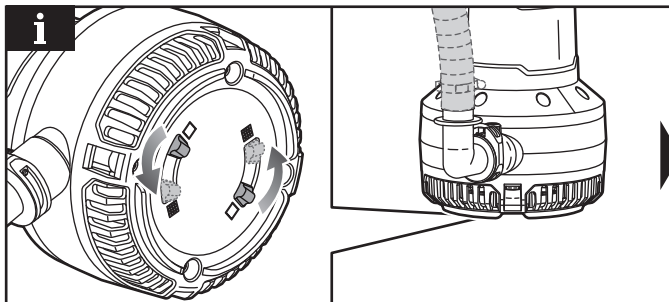

NOTE: The filter switch that toggles the filter function on or off is found below the submersible pump.

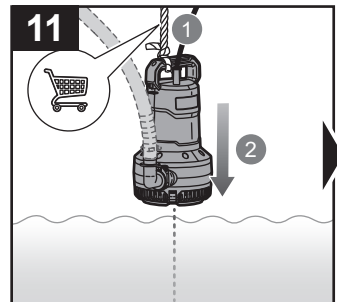

11 Tie a rope to the carrying handle of the submersible pump and lower the submersible pump into water using the rope.

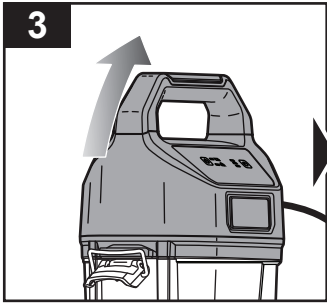

Open the battery box.

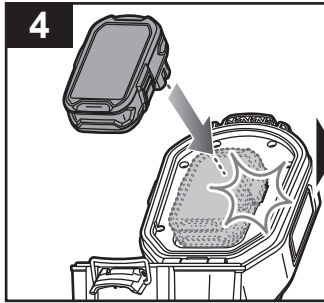

Install the battery pack. Make sure that the latches on the battery pack click into place.

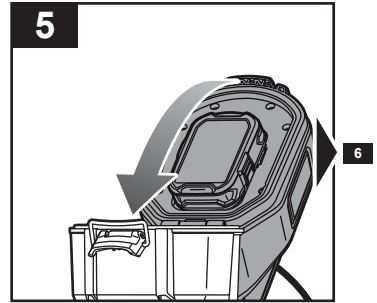

Close the battery box.

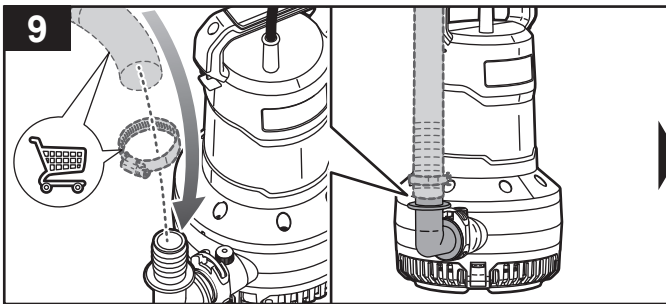

Attach the flexible hose and hose clamp to the discharge elbow. Tighten the hose clamp to secure the flexible hose.

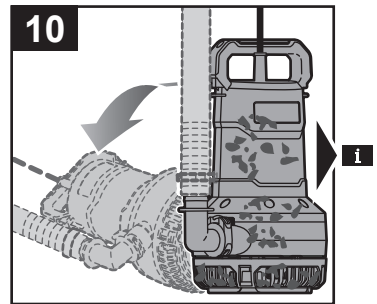

Lay the submersible pump on its side.

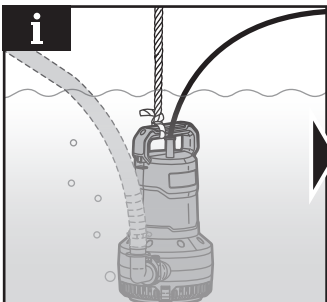

NOTE: The submersible pump can only be submerged within the specified immersion depth. Do not exceed the maximum immersion depth for the pump.

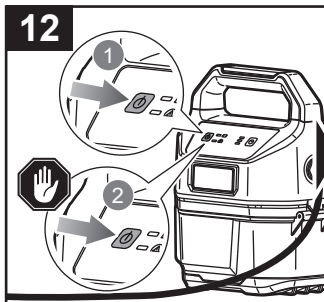

Press the on/off button on the control panel to turn on the product. Press the on/off button again to turn off the product.

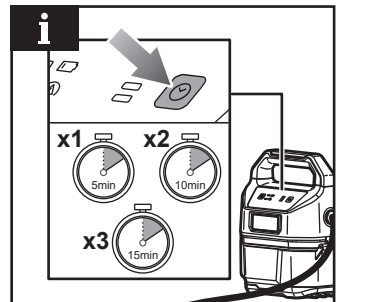

NOTE: Press the timer button to set a timer. Each press of the timer button sets the timer to 5 minutes and the succeeding press adds another 5 minutes.

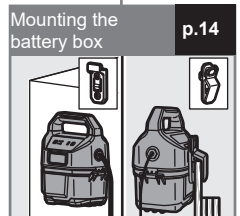
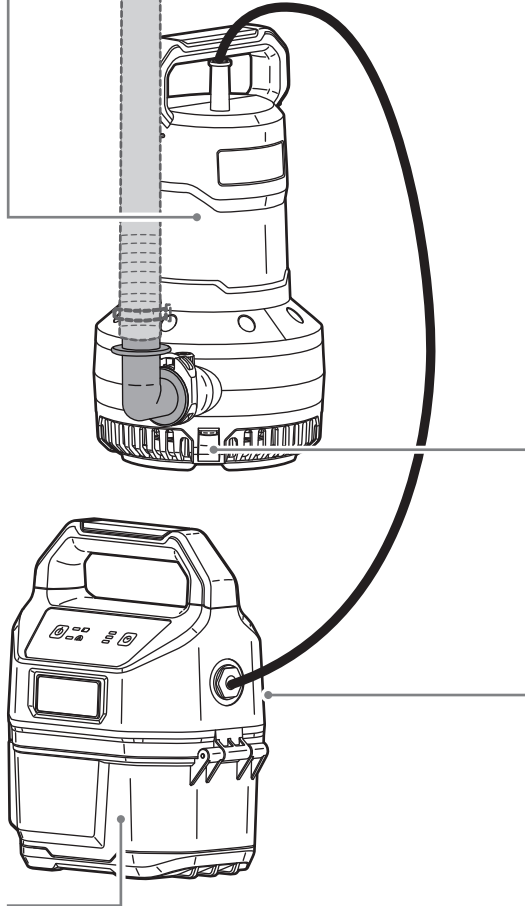
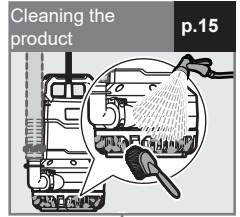
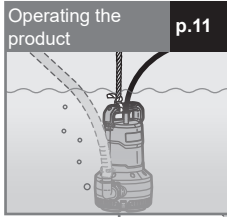

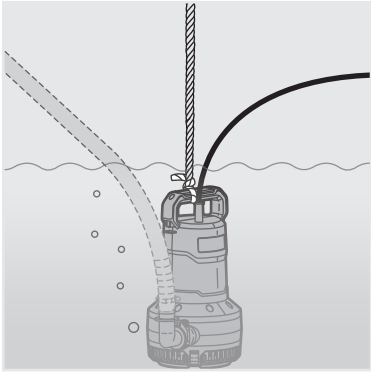

OPERATING THE PRODUCT

WARNING: Do not use the submersible pump without the filter installed.

1. Flip up the latch and remove the metal bar from the groove.
2. Open the battery box.
3. Install the battery pack. Make sure the latches on the battery pack click into place. Close the battery box.
4. Hook the metal bar on the groove and flip down the latch to lock the battery box to the battery cover.

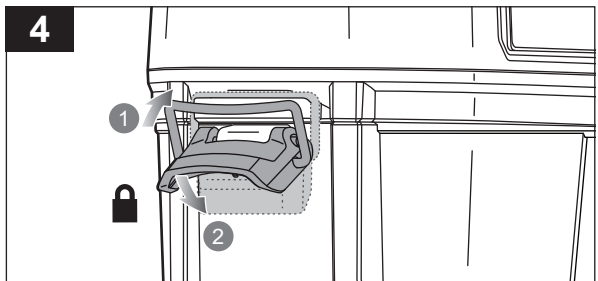
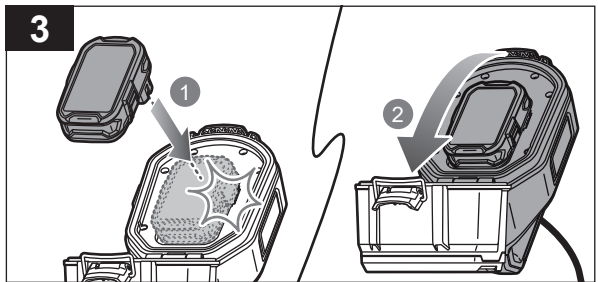
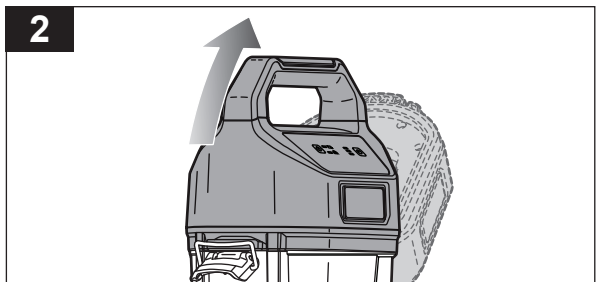
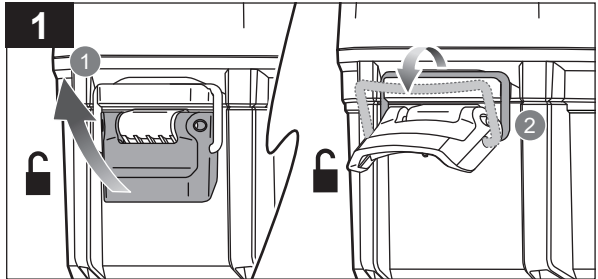
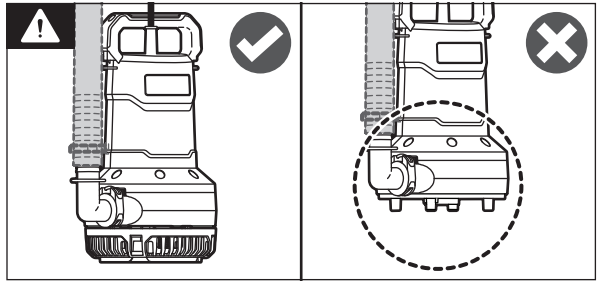

5. Tie a rope to the carrying handle of the submersible pump and lower the submersible pump into water using the rope. Do not lift or lower the submersible pump using the hose or power cord.

NOTE: The submersible pump can only be submerged within the specified immersion depth. Do not exceed the maximum immersion depth for the pump.

NOTE: The control panel contains the on/off button, low battery LED indicator, water sensor LED indicator, timer button, and timer LED indicator.

6. Press the on/off button on the control panel to turn on the product. Press the on/off button again to turn off the product.
7. Press the timer button to set a timer.

NOTE: Each press of the timer button sets the timer to 5 minutes and the succeeding press adds another 5 minutes. The timer can go up to 15 minutes only.

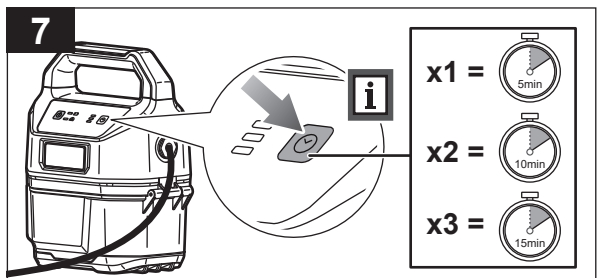
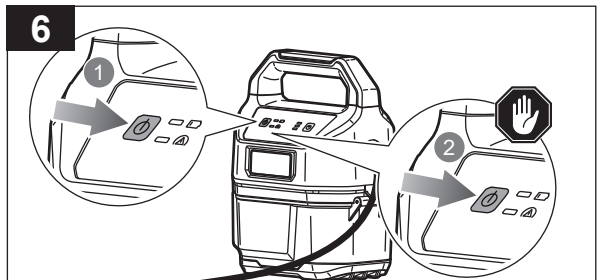
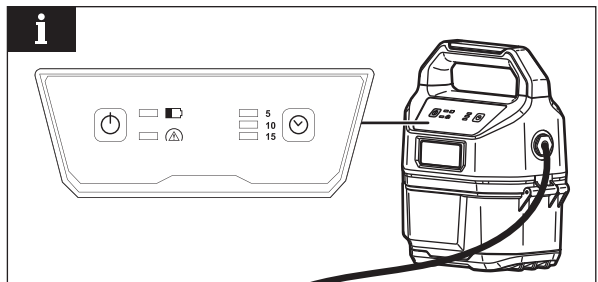
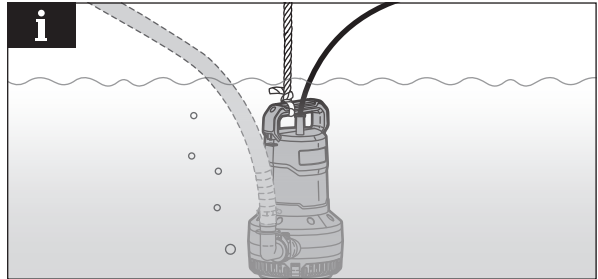
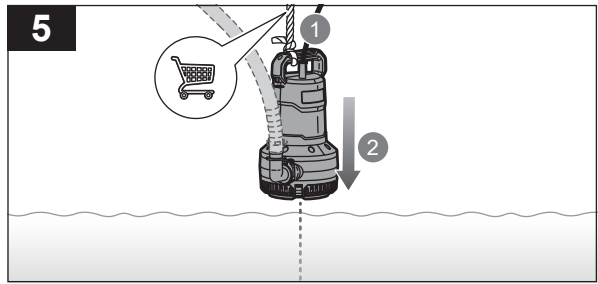

NOTE: If the topmost timer LED indicator is on, the timer is set to 5 minutes. If the middle LED indicator is on, the timer is set to 10 minutes. If the bottom LED indicator is on, the timer is set to 15 minutes.

8. Discharge water properly into drains, gutters, or other appropriate sewage areas.

WARNING: Do not discharge water to areas with electrical or high voltage elements, active chemicals, or other objects or substances that might cause danger when mixed with water.

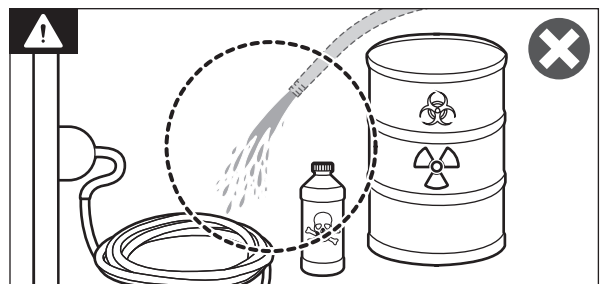
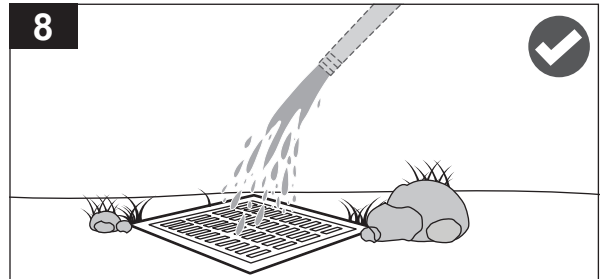
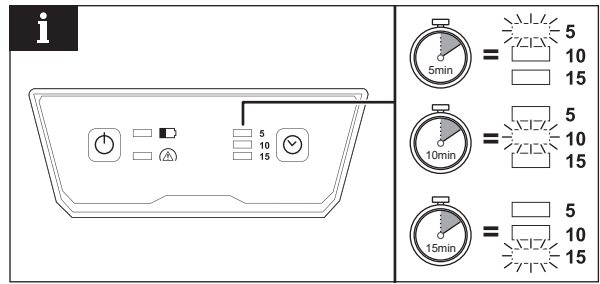

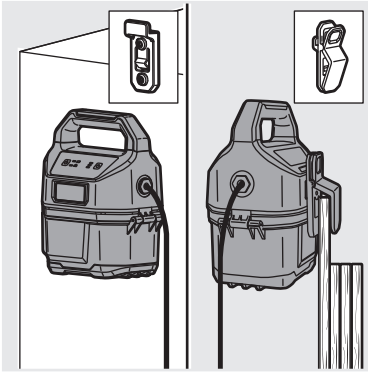

MOUNTING THE BATTERY BOX

1. Install the wall mount hook onto the wall. Turn the screws clockwise to tighten and secure the wall mount hook. Mount the battery box onto the wall mount hook.

NOTE: The battery box has a groove behind it where the wall mount hook can be hooked into.

2. Insert the clip hook into the groove behind the battery box. Press the clip hook and clip onto a stable support.

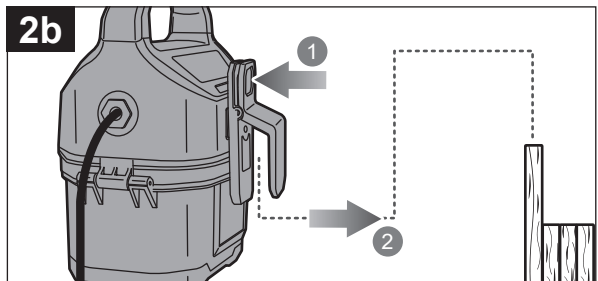
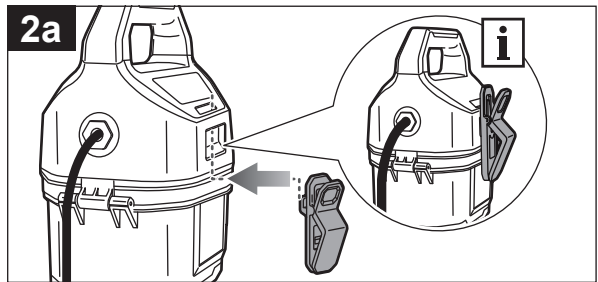
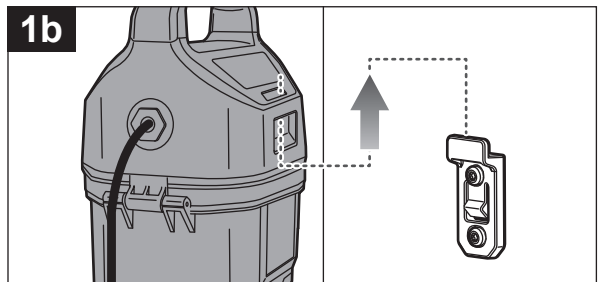
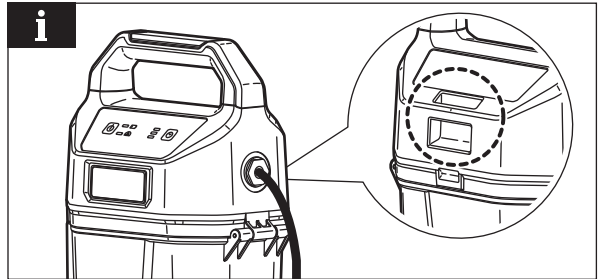
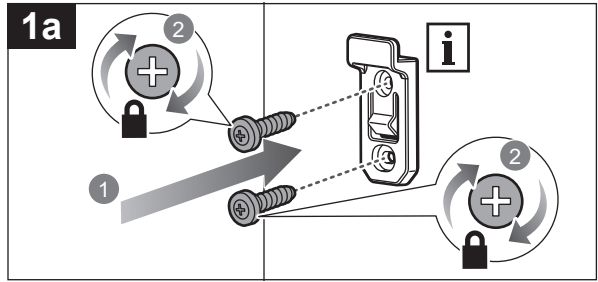

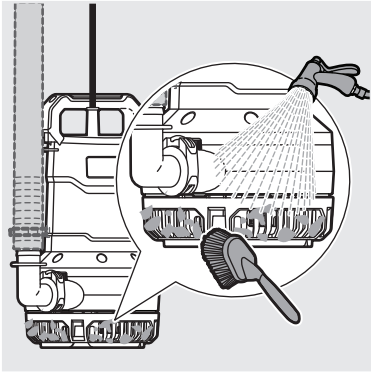

CLEANING THE PRODUCT

1. Lay the submersible pump on its side.
2. Turn the screws counterclockwise to remove them from the filter.
3. Remove the filter. Clean the filter with water and remove dirt or debris with a stiff brush.
4. Clean the body of the submersible pump with water and remove dirt or debris with a stiff brush.
5. Install the filter on the submersible pump. Lay the submersible pump on its side.

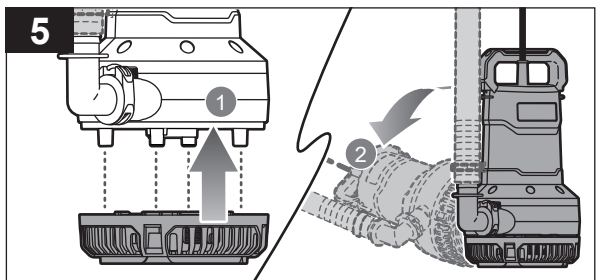
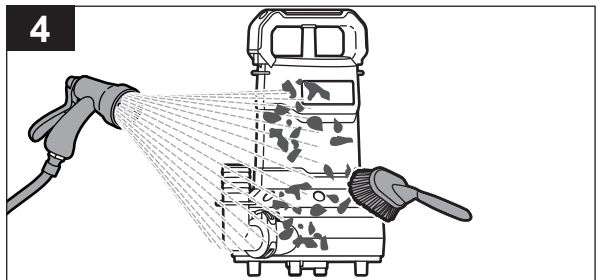
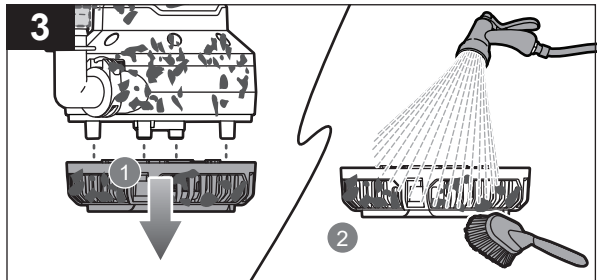
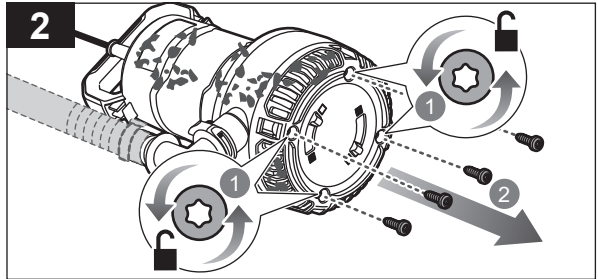
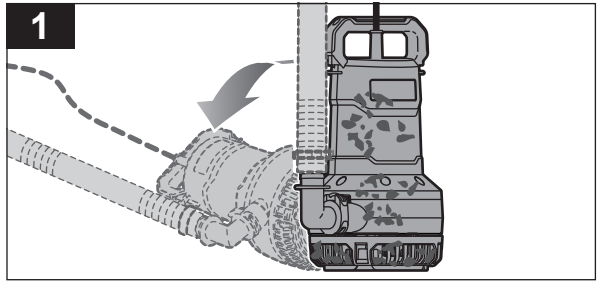

6. Install the screws into the filter and turn them clockwise to tighten and secure the filter into the submersible pump.
7. Remove dirt or debris from the battery box with a stiff brush. Do not use water to clean the battery box.

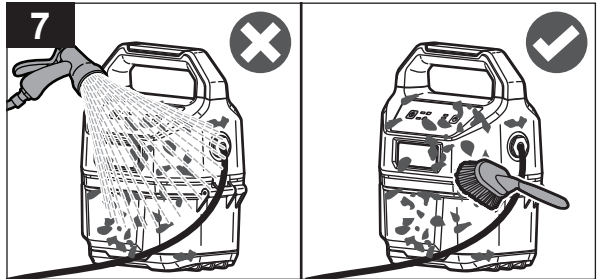
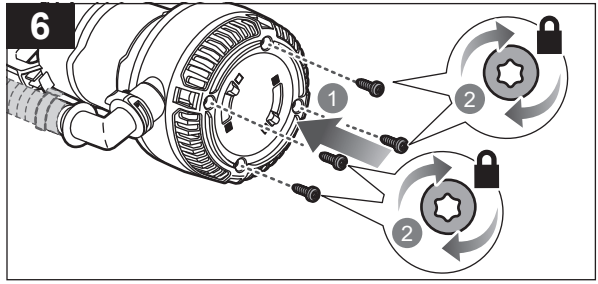



STORING THE PRODUCT

NOTE: Do not store the product while there is still dirt or debris on it. Always make sure to clean the product before storing.

WARNING: Make sure to clean any excess water from the product to avoid slipping.

1. Loosen the hose clamp to remove the flexible hose.
2. Flip up the latch and remove the metal bar from the groove to unlock the battery box from the battery cover. Open the battery box.
3. Remove the battery pack. Close the battery box.

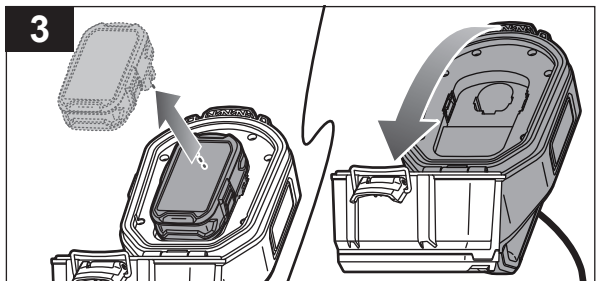
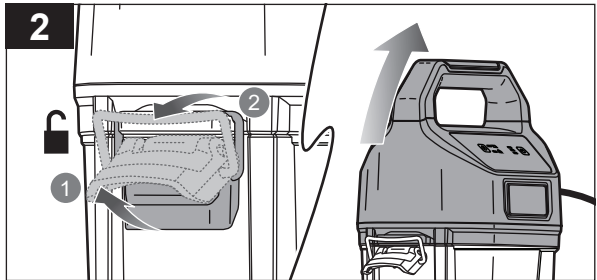
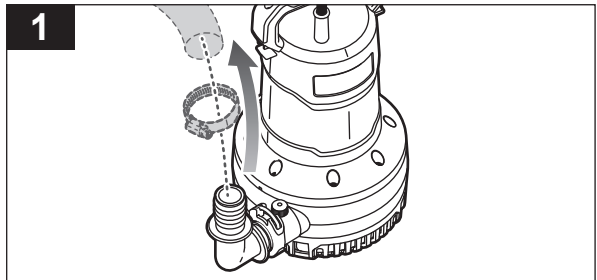
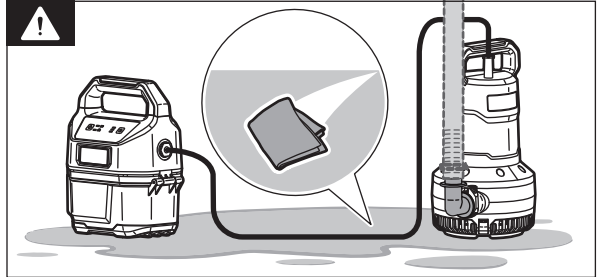
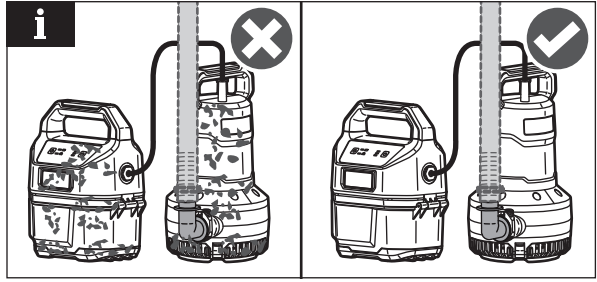

4. Hook the metal bar on the groove and flip down the latch to lock the battery box to the battery cover.
5. Store the product in a dry, well-ventilated area that is inaccessible to children. Keep the product away from corrosive agents, such as garden chemicals and de-icing salts.

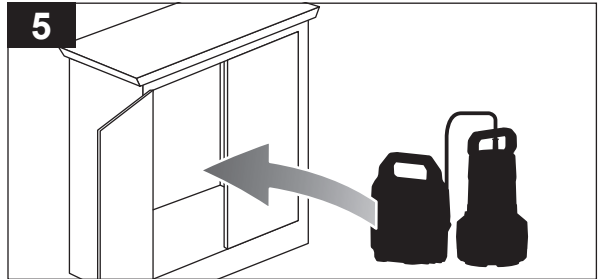
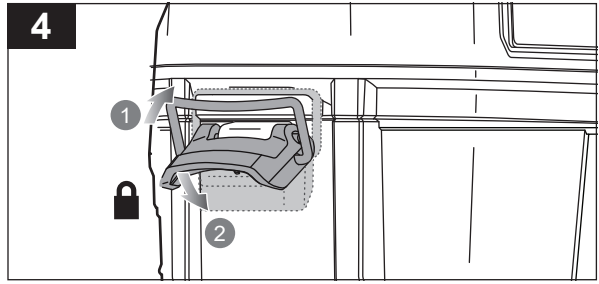

PRODUCT SPECIFICATIONS

Cordless submersible pump

Model R18SUP10

Rated voltage 18 V d.c.

Flow rate 70 L/min

Maximum head 8 m

Maximum immersion depth 5 m

Water temperature rating

Maximum 35°C

Minimum 5°C

Maximum particle size 10 mm

Water outlet size 13 mm

Minimum suction level 5 mm

Weight 4 kg

BATTERY AND CHARGER

Model R18SUP10

Compatible battery packs
RB1815C, RB1820C, RB1825C,
RB1840C, RB1840X, RB1850C,
RB1850X, RB1860X, RB18L15,
RB18L15A, RB18L15B, RB18L20,
RB18L20A, RB18L25, RB18L25A,
RB18L40, RB18L40A, RB18L50,
RB18L50A, RB18L13, RB18L60A,
RB18L90A

FLOW RATE PERFORMANCE

The flow rate of the product depends on the height of the water outlet. As the height of the product increases, the slower it discharges water.

Outlet height (m)	Flow rate (L/h)
0	4,200
2	3,500
4	2,700
6	1,800
8	900

NOTE: Visit your local special orders desk or contact RYOBI customer service for replacement parts.

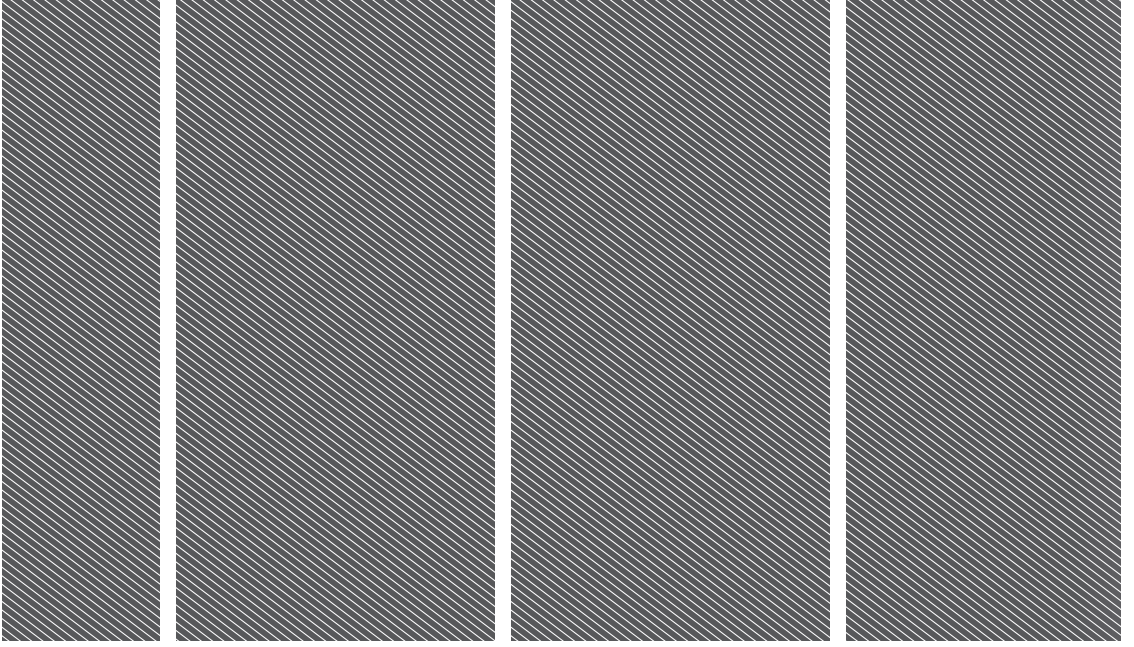

Imported by:
Techtronic Industries Australia Pty Ltd
31 Gilby Road, Mount Waverley, VIC 3149
Melbourne, Australia

Techtronic Industries N.Z. Limited
Unit C, 70 Business Parade South,
Highbrook, Auckland 2013, New Zealand

RYOBI is a trade mark of Ryobi Limited, and is used under license.

