

MAINTENANCE

WARNING! BEFORE CLEANING OR CARRYING OUT ANY MAINTENANCE PROCEDURE, ENSURE THAT THE BATTERIES HAVE BEEN REMOVED.

Cleaning

- Keep the ventilation slots of the tool clean at all times to ensure efficient operation.
- After each use, blow air through the tool housing to ensure it is free from all dust, dirt, etc. Build up of dust or dirt particles may cause the tool to overheat and shorten the life of the tool.
- If the housing of the tool requires cleaning, do not use solvents. Use of a cloth only is recommended.
- Never allow any liquid to get inside the tool, never immerse any part of the tool into liquid.

Carbon Brushes

When the carbon brushes wear out, the tool will spark and/or stop. Discontinue use as soon as this happens. They should be replaced prior to recommencing use. Carbon brushes are a wearing component of the tool therefore not covered under warranty. Continuing to use when carbon brushes need to be replaced may cause permanent damage to the tool. Take the tool to an electrician or a power tool repairer for a quick and low cost replacement. Always replace both carbon brushes at the same time.

Note: A small amount of sparking may be visible through the housing vents. This is normal and does not indicate a problem.

Storage

When not in use, the tool should be stored in a dry, frost free location, keep out of children's reach.

Note: Ozito Industries will not be responsible for any damage or injuries caused by repair of the tool by an unauthorised person or by mishandling.

DESCRIPTION OF SYMBOLS

v	Volts	mm	millimeters
/min	Revolutions per minute	m/min	metre per minute
	Direct current	n_o	No load speed
Ah	Ampere hours		Regulatory Compliance Mark (RCM)
	Warning		Wear eye, ear & breathing protection
	Read Instruction Manual		

CARING FOR THE ENVIRONMENT



Power tools that are no longer usable should not be disposed of with household waste but in an environmentally friendly way. Please recycle where facilities exist. Check with your local council authority for recycling advice.



Recycling packaging reduces the need for landfill and raw materials. Reuse of recycled material decreases pollution in the environment. Please recycle packaging where facilities exist. Check with your local council authority for recycling advice.

SPARE PARTS

Spare parts can be ordered from the Special Orders Desk at your local Bunnings Warehouse.

For further information, or any parts not listed here, visit www.ozito.com.au or contact Ozito Customer Service:

Australia 1800 069 486

New Zealand 0508 069 486

E-mail: enquiries@ozito.com.au

ELECTRICAL SAFETY

WARNING! When using electric tools basic safety precautions should always be followed to reduce the risk of fire, electric shock and personal injury.

- Read the whole manual carefully and make sure you know how to switch the tool off in an emergency, before operating the tool. Save these instructions and other documents supplied with this tool for future reference.
- This appliance is not intended for use by persons (including children) with reduced physical, sensory or mental capabilities, or lack of experience and knowledge, unless they have been given supervision or instruction concerning use of the appliance by a person responsible for their safety. Children should be supervised to ensure that they do not play with the appliance.
- This appliance is compatible and only to be used with all batteries & chargers from the Ozito

PXC range. Refer to the PXC battery and charger manuals for information regarding charging, use and storage.

- WARNING!** Always remove the battery from the tool:
 - when the batteries are to be charged,
 - when the tool is left unattended,
 - when the tool is being checked, cleaned, or having maintenance work done,
 - when the tool is to be stored,
 - or if the tool vibrates abnormally.
- Do not combine different types of batteries or new and used batteries.
- Do not use modified or damaged batteries.

GENERAL POWER TOOL SAFETY WARNINGS

WARNING! Read all safety warnings, instructions, illustrations and specifications provided with this power tool. Failure to follow all instructions listed below may result in electric shock, fire and/or serious injury.

Save all warnings and instructions for future reference.

The term "power tool" in the warnings refers to your mains-operated (corded) power tool or battery-operated (cordless) power tool.

1) Work area safety

- Keep work area clean and well lit. Cluttered or dark areas invite accidents.
- Do not operate power tools in explosive atmospheres, such as in the presence of flammable liquids, gases or dust. Power tools create sparks which may ignite the dust or fumes.
- Keep children and bystanders away while operating a power tool. Distractions can cause you to lose control.

2) Electrical safety

- Power tool plugs must match the outlet. Never modify the plug in any way. Do not use any adapter plugs with earthed (grounded) power tools. Unmodified plugs and matching outlets will reduce risk of electric shock.
- Avoid body contact with earthed or grounded surfaces, such as pipes, radiators, ranges and refrigerators. There is an increased risk of electric shock if your body is earthed or grounded.
- Do not expose power tools to rain or wet conditions. Water entering a power tool will increase the risk of electric shock.
- Do not abuse the cord. Never use the cord for carrying, pulling or unplugging the power tool. Keep cord away from heat, oil, sharp edges or moving parts. Damaged or entangled cords increase the risk of electric shock.
- When operating a power tool outdoors, use an extension cord suitable for outdoor use. Use of a cord suitable for outdoor use reduces the risk of electric shock.

If operating a power tool in a damp location is unavoidable, use a residual current device (RCD) protected supply. Use of an RCD reduces the risk of electric shock.

3) Personal safety

- Stay alert, watch what you are doing and use common sense when operating a power tool. Do not use a power tool while you are tired or under the influence of drugs, alcohol or medication. A moment of inattention while operating power tools may result in serious personal injury.
- Use personal protective equipment. Always wear eye protection. Protective equipment such as a dust mask, non-skid safety shoes, hard hat or hearing protection used for appropriate conditions will reduce personal injuries.
- Prevent unintentional starting. Ensure the switch is in the off-position before connecting to power source and/or battery pack, picking up or carrying the tool. Carrying power tools with your finger on the switch or energising power tools that have the switch on invites accidents.
- Remove any adjusting key or wrench before turning the power tool on. A wrench or a key left attached to a rotating part of the power tool may result in personal injury.
- Do not overreach. Keep proper footing and balance at all times. This enables better control of the power tool in unexpected situations.
- Dress properly. Do not wear loose clothing or jewellery. Keep your hair and clothing away from moving parts. Loose clothes, jewellery or long hair can be caught in moving parts.
- If devices are provided for the connection of dust extraction and collection facilities, ensure these are connected and properly used. Use of dust collection can reduce dust-related hazards.
- Do not let familiarity gained from frequent use of tools allow you to become complacent and

PORTABLE BANDSAW SAFETY WARNINGS

- This power tool is intended to function as portable bandsaw. Read all safety warnings, instructions, illustrations and specifications provided with this power tool. Failure to follow all instructions listed below may result in electric shock, fire and/or serious injury.
- Avoid using power tools for long periods of time without breaks. Vibration from tools can be transmitted into your hands and arms.
- Where possible, use clamps or a vice to hold the workpiece. It is safer than using your hand.
- Do not point LED at eyes of persons or animals.
- Hold power tool by insulated gripping surfaces, when performing an operation where the cutting accessory may contact hidden wiring or its own cord. Cutting accessories contacting a "live" wire may make exposed metal parts of the power tool "live" and could give the operator an electric shock.

ozito
X PXC

18V CORDLESS

PORTABLE BANDSAW

INSTRUCTION MANUAL

SPECIFICATIONS

Input: 18V
No Load Speed: 240/min
Blade Speed: 120m/min (394ft/min)
Blade: 1141x13x0.65mm (10/14TPI)
Max. Cutting Height: 115mm (4.5")
Max. Cutting Width: 127mm (5")
Weight: 5.5kg

ozito.com.au

5 YEAR
REPLACEMENT WARRANTY

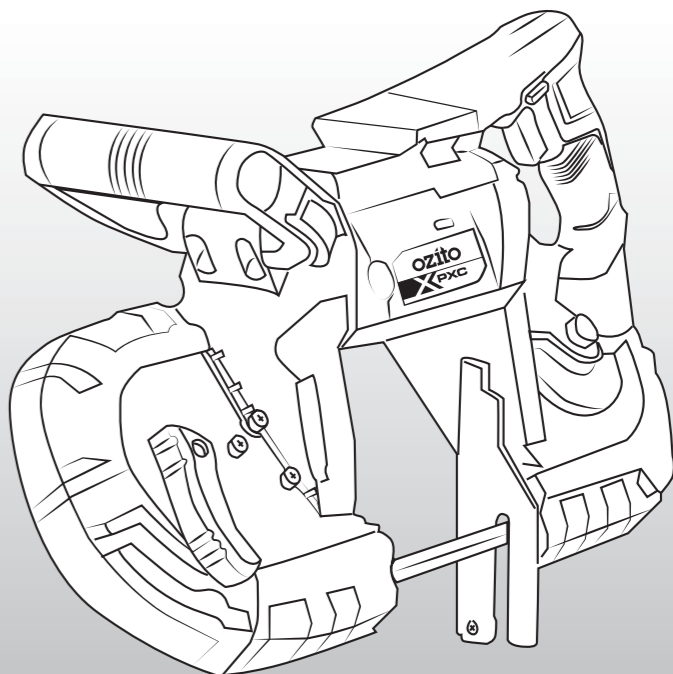

STANDARD EQUIPMENT

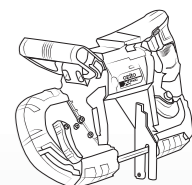

Cordless Portable Band Saw



2 x Bandsaw Blades , 2 x Hex Keys (4mm, 5mm)

XPBS-127

WARRANTY

IN ORDER TO MAKE A CLAIM UNDER THIS WARRANTY YOU MUST RETURN THE PRODUCT TO YOUR NEAREST BUNNINGS WAREHOUSE WITH YOUR BUNNINGS REGISTER RECEIPT. PRIOR TO RETURNING YOUR PRODUCT FOR WARRANTY PLEASE TELEPHONE OUR CUSTOMER SERVICE HELPLINE:

Australia 1800 069 486
New Zealand 0508 069 486

TO ENSURE A SPEEDY RESPONSE PLEASE HAVE THE MODEL NUMBER AND DATE OF PURCHASE AVAILABLE. A CUSTOMER SERVICE REPRESENTATIVE WILL TAKE YOUR CALL AND ANSWER ANY QUESTIONS YOU MAY HAVE RELATING TO THE WARRANTY POLICY OR PROCEDURE.

WARNING

The following actions will result in the warranty being void.

- If the tool has been operated on a supply voltage other than that specified on the tool.
- If the tool shows signs of damage or defects caused by or resulting from abuse, accidents or alterations.
- Failure to perform maintenance as set out within the instruction manual.
- If the tool is disassembled or tampered with in any way.

The benefits provided under this warranty are in addition to other rights and remedies which are available to you at law.

Our goods come with guarantees that cannot be excluded at law. You are entitled to a replacement or refund for a major failure and for compensation for any other reasonably foreseeable loss or damage. You are also entitled to have the goods repaired or replaced if the goods fail to be of acceptable quality and the failure does not amount to a major failure.

Generally you will be responsible for all costs associated with a claim under this warranty, however, where you have suffered any additional direct loss as a result of a defective product you may be able to claim such expenses by contacting our customer service helpline above.

5 YEAR REPLACEMENT WARRANTY

Your Product is guaranteed for a period of 60 months from the original date of purchase and is intended for DIY (Do It Yourself) use only. If a product is defective it will be replaced in accordance with the terms of this warranty. **Lithium Ion batteries and chargers are covered by a 36 month warranty** and are excluded from the warranty extension. Warranty excludes consumable parts.

KNOW YOUR PRODUCT

CORDLESS PORTABLE BANDSAW

- | | |
|------------------------------|-----------------------|
| 1. Adjustable Handle | 9. Blade Guard |
| 2. Clamping lever for handle | 10. Clamp Lever |
| 3. Battery Seating | 11. Worklight LED |
| 4. Safety lock-off | 12. Upper Blade Guard |
| 5. On/Off Switch | 13. Blade Pulleys |
| 6. Sure Grip Comfort | 14. Rubber Tyres |
| 7. Blade (not fitted) | 15. Guide Rollers |
| 8. Workpiece stop | |

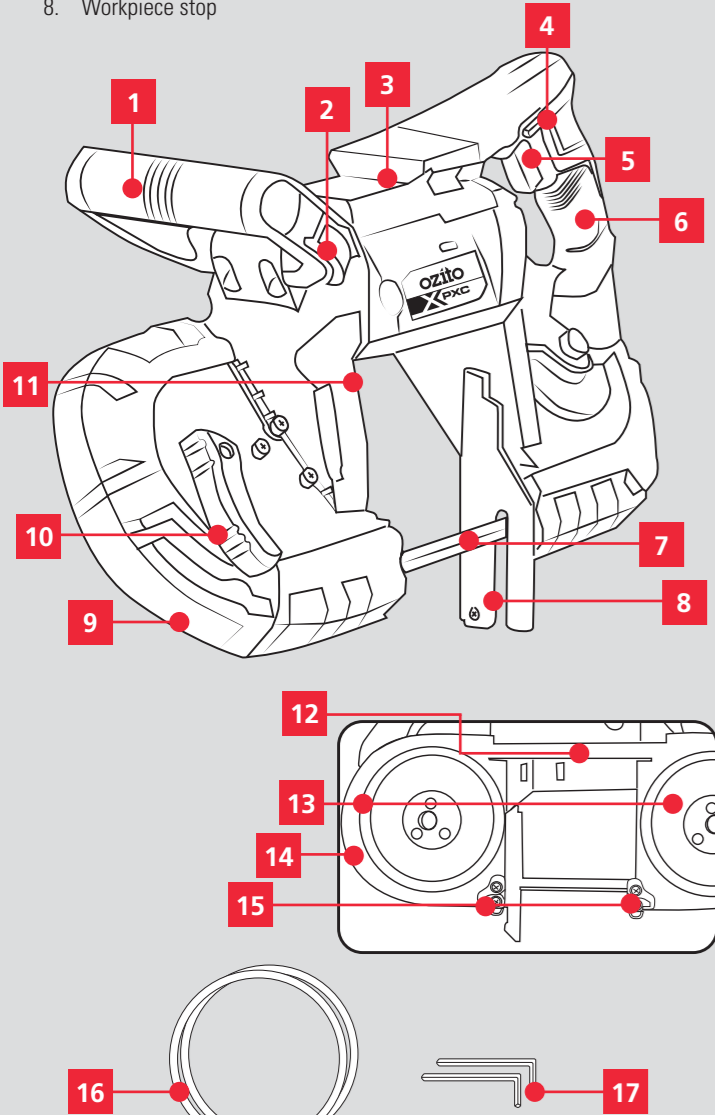

ACCESSORIES

- 16. 2 x Bandsaw Blades
- 17. 2 x Hex Keys (4mm, 5mm)

BATTERY & CHARGER

This tool is compatible with all batteries & chargers from the Ozito PXC range.

ONLINE MANUAL

Scan this QR Code with your mobile device to take you to the online manual.



SETUP & PREPARATION

1. FITTING THE BATTERY

Installing The Battery Pack

- Slide the battery into the tool base until it clicks into place.

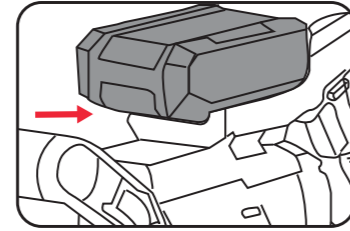

Removing The Battery Pack

- Hold down the battery release button (a) and then slide the battery out (b).

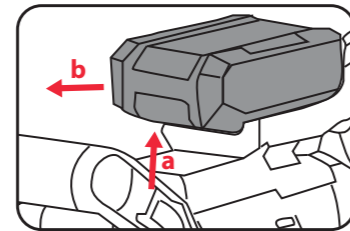

2. ASSEMBLY

WARNING! ENSURE THE TOOL IS SWITCHED OFF AND THE BATTERY IS REMOVED BEFORE PERFORMING ANY OF THE FOLLOWING TASKS.

WARNING! WEAR WORK GLOVES TO PREVENT INJURY WHEN CHANGING THE BLADE.

WARNING! THE DAMAGED RUBBER TYRE MUST BE REPLACED IMMEDIATELY.

Removing The Blade Guard

- Unscrew the two screws counter clock-wise and gently take the blade guards off.

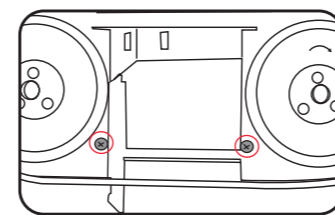

Fitting The Blade Guard

- Make sure to snap the guards onto the groove and secure it with the screws again by tightening it clockwise.

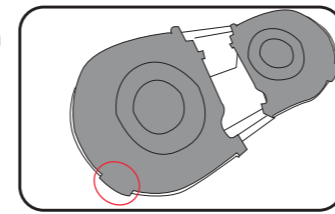

Fitting The Blade

- Loose the blade pulleys by turning the clamping lever clockwise.

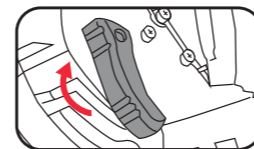

- Clean the roller guides, rubber tyres and the two blade pulleys before mounting a new blade on the band saw.

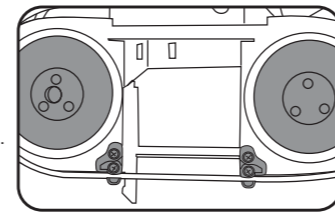

Note: Make sure it is free of chips.

- Mount the new blade in reverse order beginning at the guide rollers, then continue around the blade pulleys and finish at upper blade guard.

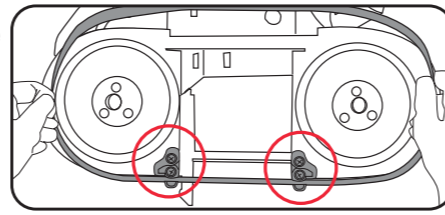

Note: Make sure the blade teeth are facing down

Note: Pay attention to the running direction. The cutting angle of the teeth must point in running direction, i.e. towards the workpiece stop. See the arrow on the two blade pulleys.

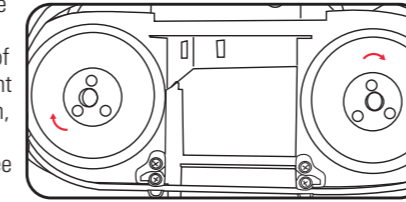

Note: Make sure that the new blade runs freely in the guide rollers and in the upper blade guard

- Tension the blade by turning the clamping lever counter-clockwise.

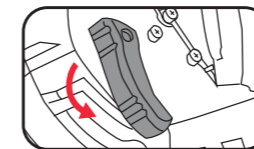

Note: The width of the new blade must be at least as large as stipulated in the Technical data. The teeth of the blade must project beyond the guide rollers. If the new blade is too narrow, the teeth will be damaged and the blade will become blunt.

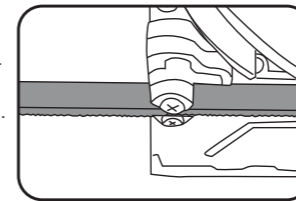

- Put back the blade guard on as explained in the Fitting the Blade Guard Section.

WARNING! WHEN THE BLADE IS BEING REMOVED, THE TENSION MIGHT BE RELEASED WITH A JERK CAUSING THE BLADE TO JUMP OFF THE BLADE PULLEYS.

Removing The Blade

- Remove the blade guard.
- Loosen the blade pulleys by turning the clamping lever clockwise.

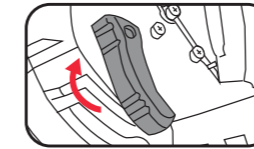

- To remove the blade: start at the top part of the upper blade guard.

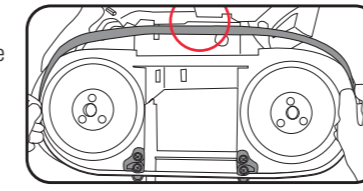

- Then continue around the blade pulleys and finish at the guide roller.

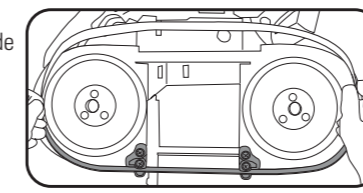

OPERATION

3. CONTROLS

Adjusting The Handle

- Release the clamp lever.
- Place the adjustable handle in the required position and lock the setting by refastening the clamping lever.
- The pretension of the clamp lever can be adjusted by holding the released clamp lever firmly and adjusting the nut on the opposite side (clockwise: higher tension). Check the setting by closing the clamping lever again. Keep repeating until you have the required tension.

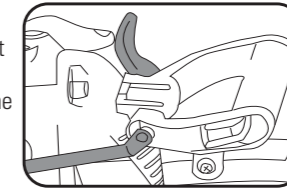
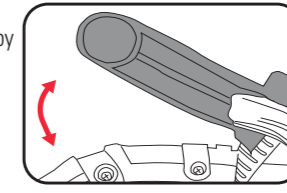
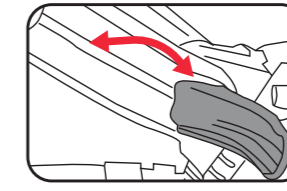

Adjusting The Workpiece Stop

The workpiece stop is set at the factory to the top position. It can be adjusted by using hex keys.

Note: The two hex keys are stored in the adjustable handle

- Loosen the two socket head screws with the hex key in order to be able to push the workpiece stop to the required position. Then retighten the two socket head screws.

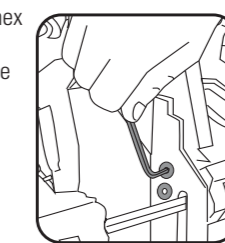
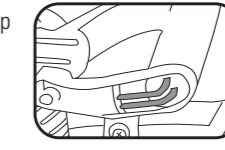

CAUTION! SET THE WORKPIECE STOP TO THE LOWEST POSITION AS THIS WILL INCREASE THE SIZE OF THE GUIDE FACE. SET THE WORKPIECE STOP TO A HIGHER POSITION ONLY IN EXCEPTIONAL CASES.

On/Off Switch

- Press the safety lock-off first in order to release the On/Off switch.



- Press the On/Off switch
- Note:** The Worklight LED lits up when the tool is switched on and in use for illuminating the cutting area..

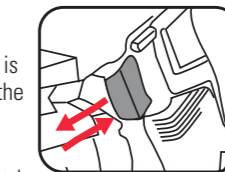

- To switch off the saw, let go of the On/Off switch again.

4. USAGE

WARNING! WEAR WORK GLOVES, EAR, BREATHING AND EYE PROTECTION TO PREVENT INJURY WHEN USING THIS TOOL.

WARNING! BLADE GUARD MUST BE ATTACHED PROPERLY WHEN MAKING CUTS.

Making Cuts Using the Bandsaw in Hand Guided Mode

- Secure the material to be cut by a clamp for steady operations.

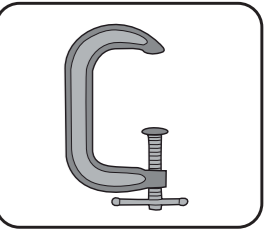

- Hold the machine firmly with both hands; use the one hand on the handle and the other hand on the adjustable handle.

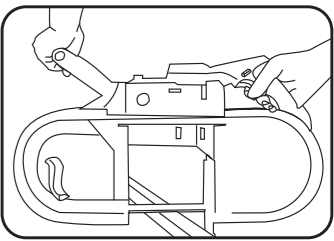

Note: Take care to maintain a steady foothold.

- Let the motor build up to maximum speed. Gently place the workpiece stop against the workpiece and align the blade with the cutting plane. Guide the bandsaw with a firm grip to the workpieces and cut into it carefully.

- Upon completion of the operation, remove the bandsaw from the workpiece and then turn off.

Note: Do not exert excessive pressure on the blade. This way you will obtain the straightest possible cut while also prolonging the life of the blade.

Note: Do not cut any cross-sections larger than those described in specifications.

WARNING! ALWAYS CUT THROUGH THE WORKPIECE IN A SINGLE PASS TO PREVENT BLADE GETTING JAMMED AND CAUSING KICKBACK.