

# ozito

## HIGH PRESSURE WASHER

### 2000W 2320PSI

#### INSTRUCTION MANUAL

#### SPECIFICATIONS

Mains Voltage:	220-240V ~ 50Hz
Input Power:	2000W
Max Permissible pressure:	16MPa (2320psi)
Rated Pressure:	11MPa (1595psi)
Rated Flow:	5.6 L/min
Max. Flow:	8.0 L/min
Water Inlet Pressure:	1.2MPa (174psi) max.
Water Inlet Temp.:	50°C max.
Noise Rating:	95db
Weight:	9.5kg

ozito.com.au

**3 YEAR**  
REPLACEMENT  
WARRANTY\*

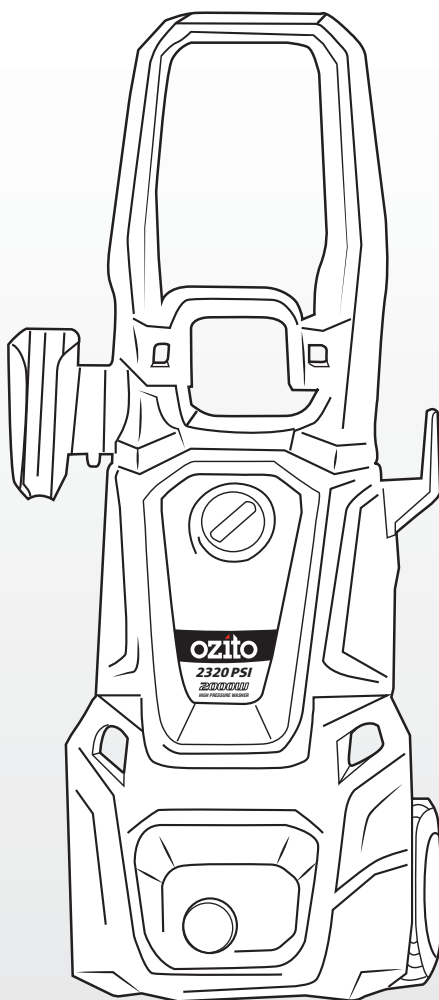

#### STANDARD EQUIPMENT



High Pressure Washer

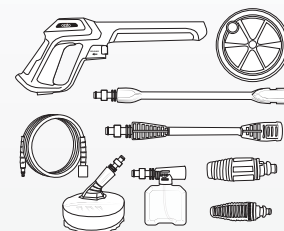

Spray Gun, High Pressure Hose, Lance, Extension Lance, Hose Reel, Turbo Nozzle, Adjustable Spray Nozzle, Patio Cleaner & Foam Bottle

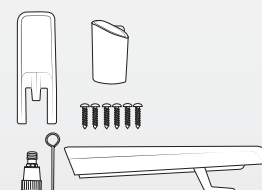

2 x Wheels, Hose Reel, Handle, 6 x Screws, Accessory Holder, Cable Hook, Cleaning Needle & Water Coupling with Filter

**HPW-2320K**

## WARRANTY

IN ORDER TO MAKE A CLAIM UNDER THIS WARRANTY YOU MUST RETURN THE PRODUCT TO YOUR NEAREST BUNNINGS WAREHOUSE WITH YOUR BUNNINGS REGISTER RECEIPT. PRIOR TO RETURNING YOUR PRODUCT FOR WARRANTY PLEASE TELEPHONE OUR CUSTOMER SERVICE HELPLINE:

**Australia: 1800 069 486**

**New Zealand: 0508 069 486**

TO ENSURE A SPEEDY RESPONSE PLEASE HAVE THE MODEL NUMBER AND DATE OF PURCHASE AVAILABLE. A CUSTOMER SERVICE REPRESENTATIVE WILL TAKE YOUR CALL AND ANSWER ANY QUESTIONS YOU MAY HAVE RELATING TO THE WARRANTY POLICY OR PROCEDURE.

The benefits provided under this warranty are in addition to other rights and remedies which are available to you at law.

Our goods come with guarantees that cannot be excluded at law. You are entitled to a replacement or refund for a major failure and for compensation for any other reasonably foreseeable loss or damage. You are also entitled to have the goods repaired or replaced if the goods fail to be of acceptable quality and the failure does not amount to a major failure.

Generally you will be responsible for all costs associated with a claim under this warranty, however, where you have suffered any additional direct loss as a result of a defective product you may be able to claim such expenses by contacting our customer service helpline above.

#### 3 YEAR REPLACEMENT WARRANTY\*

Your product is guaranteed for a period of **36 months from the original date of purchase**. If a product is defective it will be replaced in accordance with the terms of this warranty. Warranty excludes consumable parts, for example: valve adapters and accessories.

\*This product is intended for DIY use only and replacement warranty covers domestic use.

#### WARNING

**The following actions will result in the warranty being void.**

- If the tool has been operated on a supply voltage other than that specified on the tool.
- If the tool shows signs of damage or defects caused by or resulting from abuse, accidents or alterations.
- Failure to perform maintenance as set out within the instruction manual.
- If the tool is disassembled or tampered with in any way.
- Professional, industrial or high frequency use.

# KNOW YOUR PRODUCT

## HIGH PRESSURE WASHER

1. Transport Handle
2. Power Cord Hook
3. Adaptor Holder
4. Foam Bottle Holder
5. Spray Gun Holder
6. On/Off Dial
7. Water Inlet Port
8. Transport Wheels

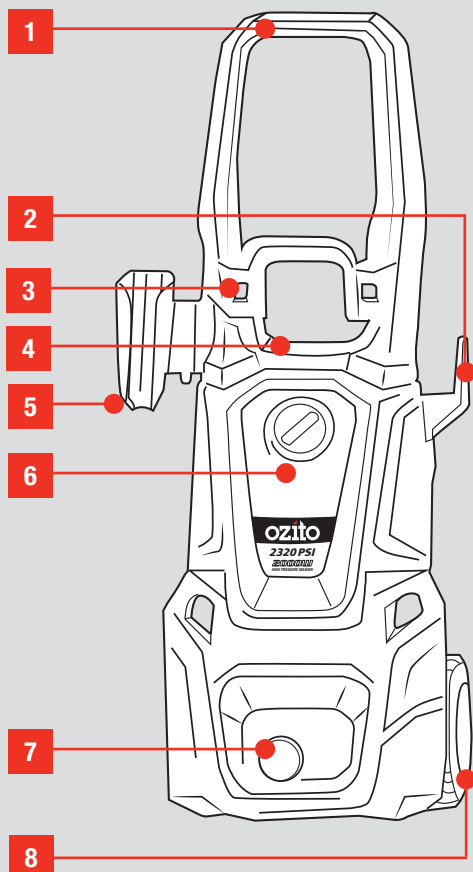

## ACCESSORIES

9. Spray Gun
  - A) Hose Release Trigger
  - B) Spray Trigger
  - C) Trigger Lock
10. High Pressure Hose
11. Patio Cleaner
12. Foam Bottle
13. Water Coupling
14. Turbo Nozzle
15. Adjustable Spray Nozzle
16. Lance
17. Extension Lance
18. Hose Reel

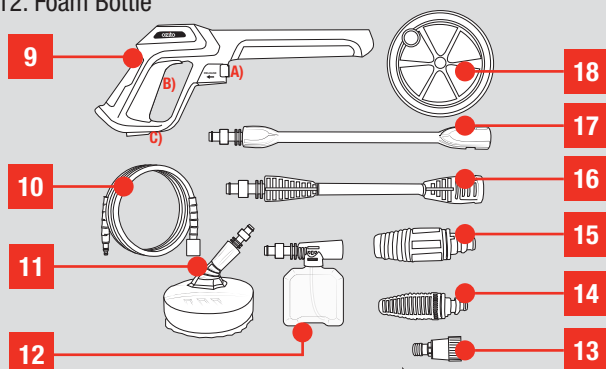

## ONLINE MANUAL

Scan this QR Code with your mobile device to take you to the online manual.

**3 YEAR REPLACEMENT WARRANTY\***



# SETUP & PREPARATION

## 1. ASSEMBLY



**WARNING!** ENSURE THE TOOL IS TURNED OFF AND DISCONNECTED FROM THE POWER SUPPLY BEFORE PERFORMING ANY OF THE FOLLOWING OPERATIONS.

### Attaching The Transport Handle

1. Slide the base of the transport handle into the tabs on the top of the unit.
2. Insert the two screws (supplied) through the tabs and into the handle.
3. Using a phillips head screwdriver, tighten the screws into place.

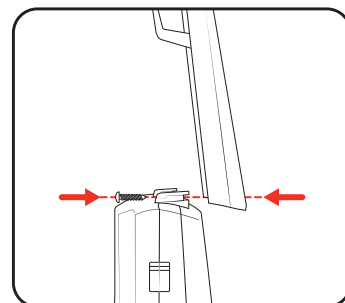

### Attaching The Spray Gun Holder & Power Cord Hook

1. Slide the spray gun holder onto the slots on one side of the unit until it clicks into place.
2. Slide the power cord hook onto the slot on the other side of the unit until it too clicks into place.

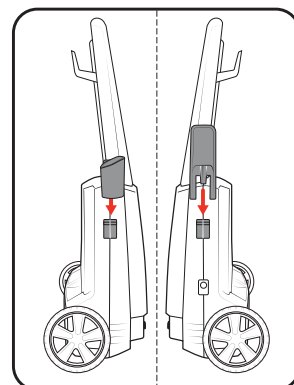

### Attaching The Hose Reel

1. Install the high pressure hose reel to the pack of the appliance with four screws.

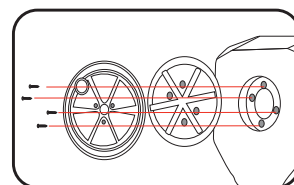

## 2. ACCESSORIES

**WARNING!** ENSURE THE TOOL IS TURNED OFF AND DISCONNECTED FROM THE POWER SUPPLY BEFORE PERFORMING ANY OF THE FOLLOWING OPERATIONS.

**WARNING!** THIS PRODUCT MUST NOT BE CONNECTED TO THE POTABLE WATER MAINS WITHOUT BACKFLOW PREVENTION. CHECK LOCAL AND NATIONAL PLUMBING REGULATIONS BEFORE CONNECTING THE MACHINE TO THE POTABLE WATER MAINS.

### Connecting The Water Supply

This pressure washer requires a pressurised water source with a maximum pressure of 1MPa (145psi). It is recommended that a reinforced garden hose (with minimum diameter of 12mm) is used for the inlet connection. It cannot be used with a bucket and siphon.

**WARNING!** RUN WATER THROUGH THE GARDEN HOSE BEFORE ATTACHING IT TO THE PRESSURE WASHER TO PREVENT ANY SAND OR DIRT FROM ENTERING THE UNIT.

1. Place the mesh inlet filter into the water coupling and then screw this onto the water inlet port located on the front of the machine.

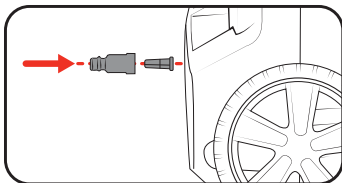

**Note:** The mesh inlet filter must be in place to prevent impurities in the water source from entering the unit and damaging the pump.

**WARNING!** ENSURE THE GARDEN HOSE IS ADEQUATELY RATED AND SUFFICIENTLY LONG FOR THE INTENDED APPLICATION.

2. Push the standard quick coupling adaptor on the end of the garden hose onto the hose adaptor on the pressure washer until it clicks into place.

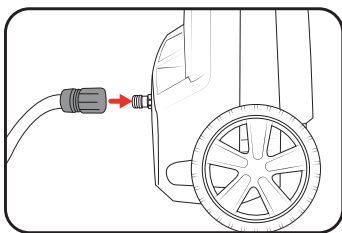

**Note:** The standard 12mm quick coupling adaptor should be used.

3. Pull gently on the hose to ensure the connection is secure.

### Connecting The Pressure Hose

1. Push the flat end of the high pressure hose into the water outlet port and screw it clockwise into place.

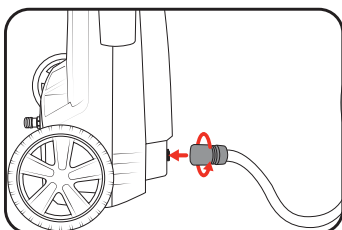

### Attaching The Spray Gun & Accessories

1. Push the desired accessory into the spray gun lance and twist clockwise to lock it into place.

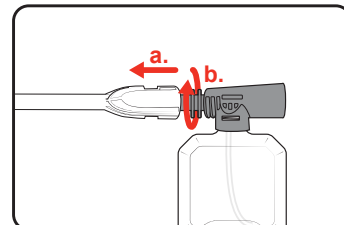

**Note:** If a longer reach is required, connect the extension lance to the spray gun lance, and attach the desired accessory to the free end of the extension lance.

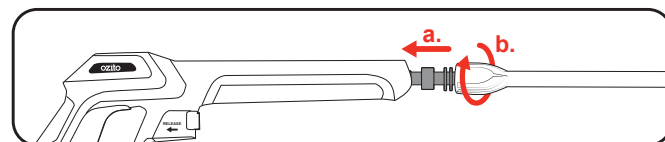

2. Push the patio cleaner into the extension lance and twist clockwise to lock it into place.

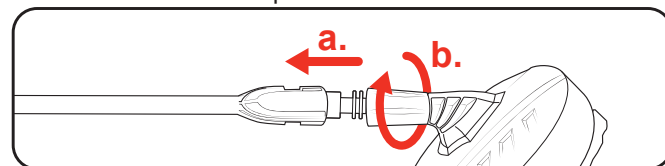

3. To disconnect the accessory, push the accessory towards the spray gun, twist the accessory counter clockwise and pull it.

3. Push the end of the pressure hose into the inlet port on the spray gun until it clicks into place.

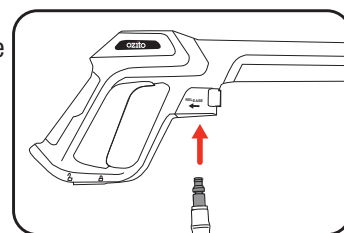

4. Tug gently on the pressure hose to check that it is inserted correctly.

**WARNING!** PRESSURISED WATER. SHUT OFF WATER SUPPLY, TURN OFF UNIT AND SQUEEZE THE SPRAY GUN TRIGGER TO RELIEVE THE PRESSURE BEFORE DISCONNECTING THE HIGH PRESSURE HOSE.

5. To disconnect the spray gun, press and hold down the quick release tab and pull out the pressure hose.

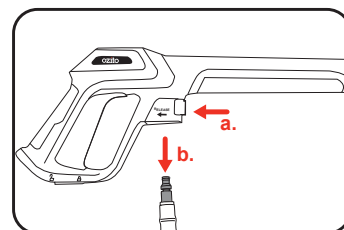

# OPERATION

## 3. CONTROLS



**WARNING!** NEVER RUN BLEACH OR DETERGENTS NOT DESIGNED FOR PRESSURE WASHERS IN THE UNIT TO PREVENT DAMAGING THE PUMP.

### Using The Foam Bottle

Pour detergent directly into the foam bottle and attach it to the lance. Follow the detergent manufacturers' directions for use.

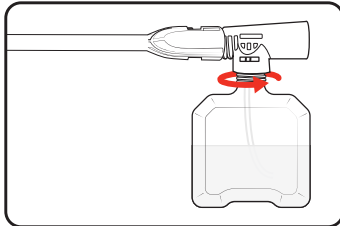

### Using the Adjustable Spray Nozzle

The water jet output can be controlled when using the adjustable spray nozzle.

1. Press the quick release button on the lance.

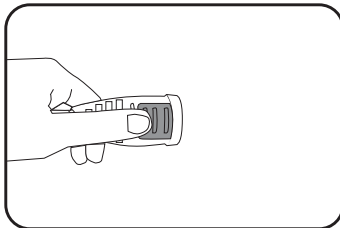

2. Push the adjustable spray nozzle into the lance until it fits firmly.

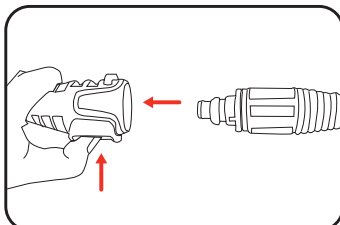

3. Turn the nozzle clockwise for a wide, fan jet to clean larger areas faster.

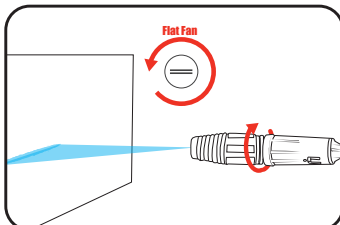

4. Turn the nozzle anti-clockwise for a narrow jet over a small area for concentrated cleaning.

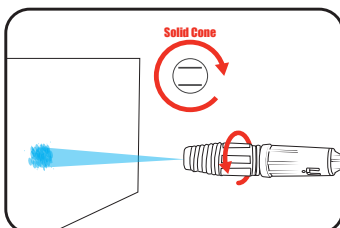

**Note:** Follow the same process to connect the turbo nozzle.

**Note:** The turbo nozzle does not have point 3 and point 4 features



**WARNING!** THE POWER SUPPLY FOR THIS PRODUCT MUST BE PROTECTED BY A RESIDUAL CURRENT DEVICE (RATED AT 30mA OR LESS).

The high pressure washer is designed to force water at high pressure via a pump through a concentrating nozzle.

It is intended for washing dirt, mud and dust from cars, garden equipment, outdoor furniture, clean grime from barbecue hot plates and grills, wash down driveways, patios, decks and brick walls.

### Starting & Stopping The Unit

1. Rotate the on/off dial to the 'ON I' position to turn the unit on.

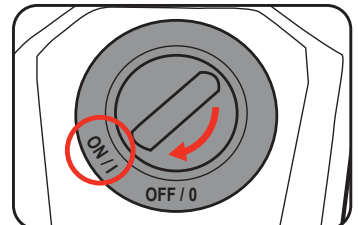

2. Unlock the spray gun by pressing the back end of the trigger lock.

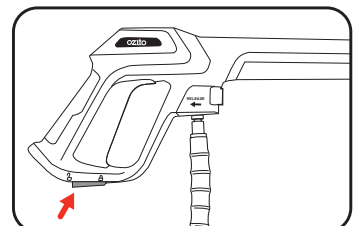

3. Squeeze the spray gun trigger to start spraying.

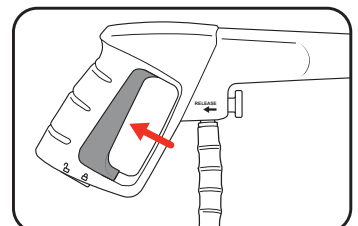

4. Release the trigger to stop spraying.



**WARNING!** LOCK THE SPRAY GUN TRIGGER WHEN NOT IN USE TO PREVENT ACCIDENTAL STARTING.

5. Rotate the dial to the 'OFF 0' position to switch the unit off.

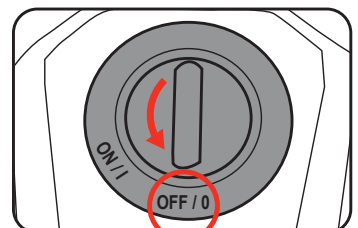

**WARNING!** DO NOT LEAVE THE UNIT IDLING IN THE 'ON' POSITION FOR MORE THAN 5 MINUTES WITHOUT ACTIVATING THE SPRAY GUN. DOING SO MAY DAMAGE THE PUMP IN THE UNIT.

### Overload Protection

The tool is equipped with an overload protection feature. If an overload occurs, the tool will automatically shut off to protect the tool.

1. In the event of an overload turn the on/off dial to the 'OFF 0' position, allow the tool to cool down and remove the power plug from the mains socket.

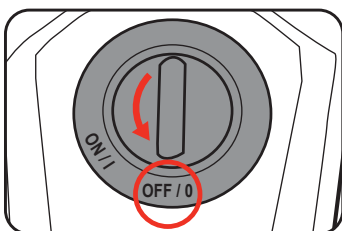

2. Shut off the water supply completely and squeeze the spray gun trigger several times to release any built up pressure and water in the system, then disconnect the garden hose from the water inlet port.

3. Unscrew the hose adaptor from the water inlet port and inspect the mesh filter for any blockages.

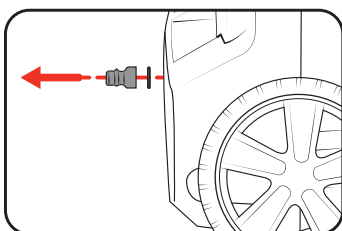

4. Clean the filter as necessary and reinstall it when done.

5. Once the unit has cooled sufficiently, restart the unit and use as normal.

**WARNING!** DO NOT CONTINUE USING THE UNIT IF THE OVERLOAD SWITCH TRIPS AGAIN IMMEDIATELY AFTER THE RESET.

**WARNING!** WHEN INSPECTING EQUIPMENT FOR FAULTS, ENSURE THE UNIT IS SWITCHED OFF AND THE POWER CABLE IS DISCONNECTED BEFORE CARRYING OUT INSPECTION.

### Shutting Down The Pressure Washer

**WARNING!** PRESSURISED WATER. SHUT OFF WATER SUPPLY, TURN OFF UNIT AND SQUEEZE THE SPRAY GUN TRIGGER TO RELIEVE THE PRESSURE BEFORE DISCONNECTING THE HIGH PRESSURE HOSE.

1. Twist the on/off dial to the off position and disconnect the power plug.

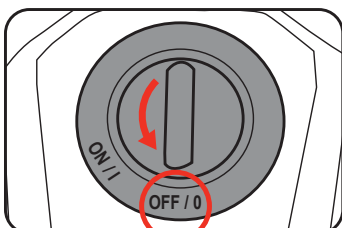

2. Shut off the water supply completely and squeeze the spray gun trigger several times to release any built up pressure and water in the system.

## 4. USAGE

**WARNING!** DO NOT POINT THE SPRAY JET AT ANY PART OF YOUR BODY, OTHER PEOPLE, PETS OR ANIMALS. THE PRESSURISED WATER STREAM CAN CAUSE SERIOUS CUTS AND INJURIES.

**WARNING!** ALWAYS WEAR SAFETY BOOTS, SAFETY GLOVES, SAFETY HELMET WITH VISOR AND HEARING PROTECTION WHILE OPERATING THE EQUIPMENT.

**WARNING!** ENSURE THAT THE SPRAY JET IS NOT DIRECTED AT POWER LINES, ELECTRICAL OUTLETS OR ELECTRONICS.

**WARNING!** HIGH PRESSURE HOSES, FITTINGS & COUPLINGS ARE IMPORTANT FOR THE SAFETY OF THE USER. USE ONLY HOSES, FITTING & COUPLINGS SUPPLIED.

**WARNING!** USE THE PRODUCT FOR DOMESTIC CLEANING ONLY. DO NOT USE THE PRODUCT FOR OTHER TASKS.

### Quick Start Procedure

1. With the adjustable spray nozzle attached, adjust it to the widest spray setting.

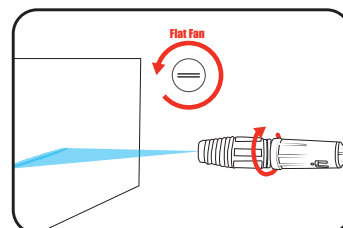

2. Attach the garden hose to the water inlet port and turn on the water at the tap.

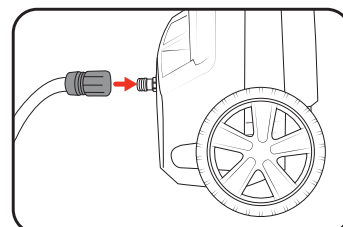

3. Squeeze the spray gun trigger to prime the pump and purge any air from the system.

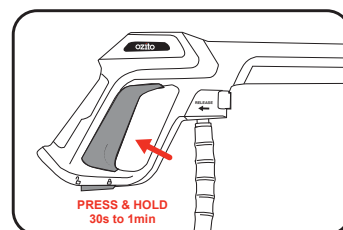

4. Plug the power cord into mains power.

5. Turn the unit on using the on/off dial to start washing.

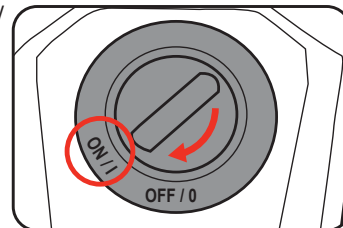

**WARNING!** ENSURE THE PRESSURE WASHER IS PLACED ON A FLAT, HARD SURFACE. ALWAYS HAVE THE PRESSURE WASHER IN AN UPRIGHT POSITION DURING USE.