

AEG

ABG5520

Original instructions

Important!

It is essential that you read the instructions in this manual before operating this machine.

Subject to technical modifications.

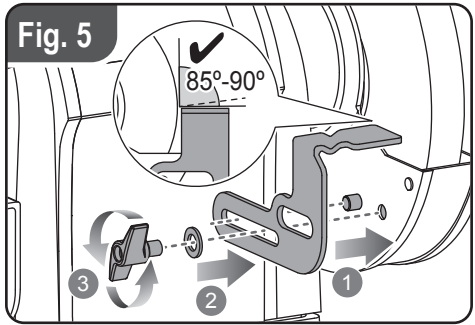
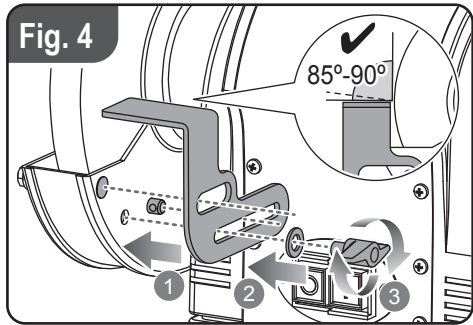
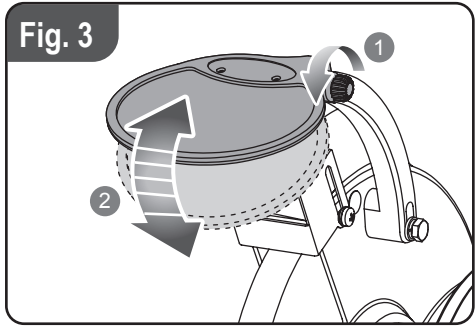
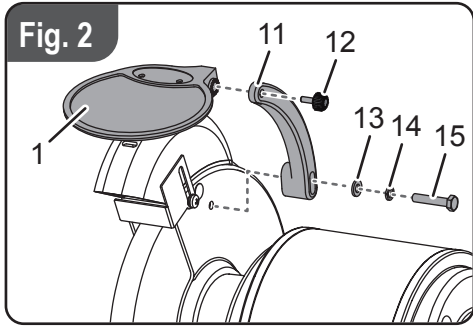
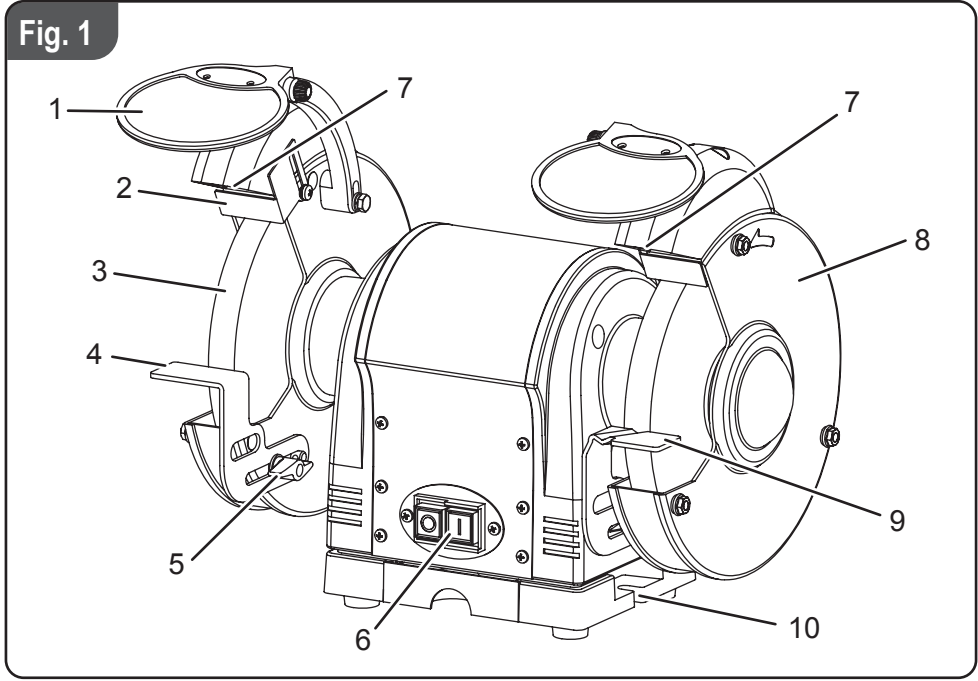

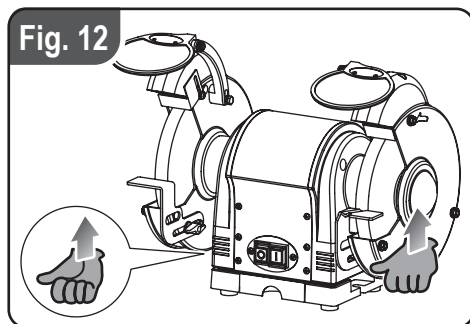
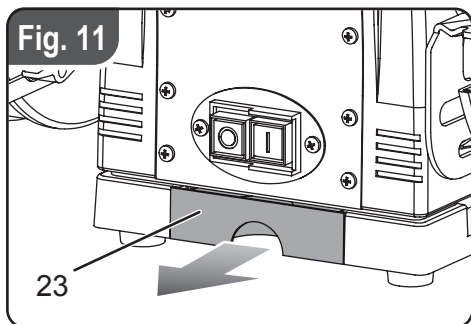
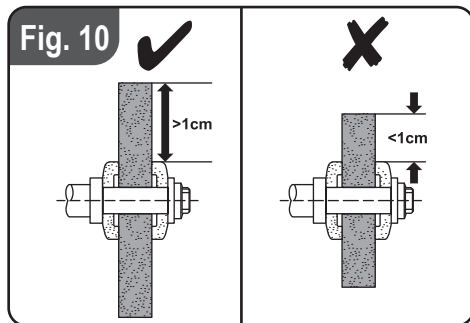
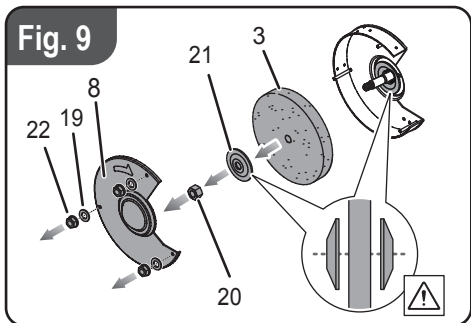
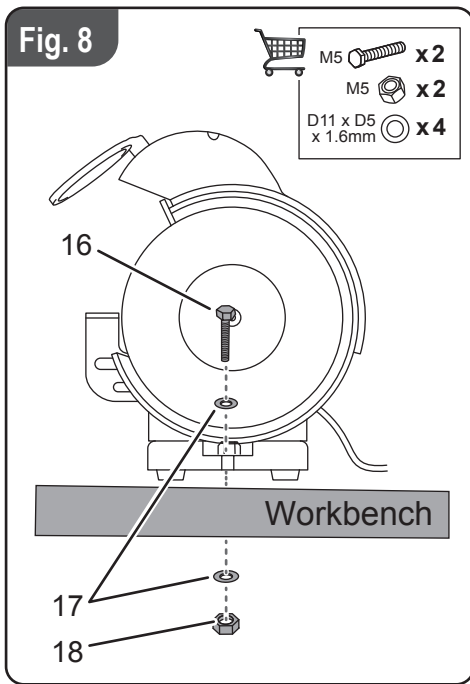
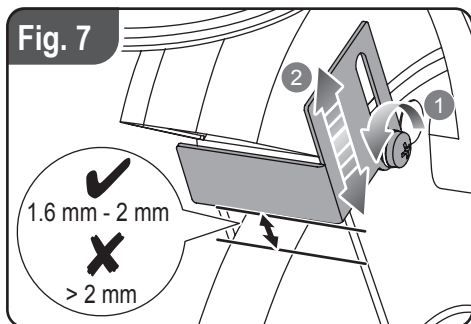
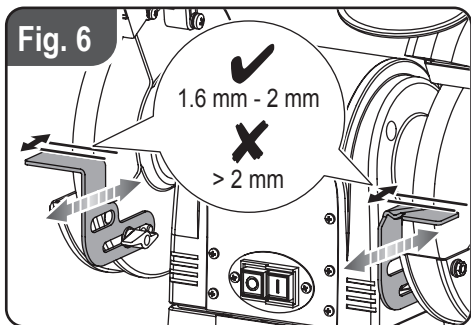



GENERAL POWER TOOL SAFETY WARNINGS

WARNING!

Read all safety warnings, instructions, illustrations and specifications provided with this power tool. Failure to follow all instructions listed below may result in electric shock, fire and/or serious injury.

Save all warnings and instructions for future reference.

The term "power tool" in the warnings refers to your mains-operated (corded) power tool or battery-operated (cordless) power tool.

WORK AREA SAFETY

Keep work area clean and well lit. Cluttered or dark areas invite accidents.

Do not operate power tools in explosive atmospheres, such as in the presence of flammable liquids, gases or dust. Power tools create sparks which may ignite the dust or fumes.

Keep children and bystanders away while operating a power tool. Distractions can cause you to lose control.

ELECTRICAL SAFETY

Power tool plugs must match the outlet. Never modify the plug in any way. Do not use any adapter plugs with earthed (grounded) power tools. Unmodified plugs and matching outlets will reduce risk of electric shock.

Avoid body contact with earthed or grounded surfaces, such as pipes, radiators, ranges and refrigerators. There is an increased risk of electric shock if your body is earthed or grounded.

Do not expose power tools to rain or wet conditions. Water entering a power tool will increase the risk of electric shock.

Do not abuse the cord. Never use the cord for carrying, pulling or unplugging the power tool. Keep cord away from heat, oil, sharp edges or moving parts. Damaged or entangled cords increase the risk of electric shock.

When operating a power tool outdoors, use an extension cord suitable for outdoor use. Use of a cord suitable for outdoor use reduces the risk of electric shock.

If operating a power tool in a damp location is unavoidable, use a residual current device (RCD) protected supply. Use of an RCD reduces the risk of electric shock.

PERSONAL SAFETY

Stay alert, watch what you are doing and use common sense when operating a power tool. Do not use a power tool while you are tired or under the influence of drugs, alcohol or medication. A moment of inattention while operating power tools may result in serious personal injury.

Use personal protective equipment. Always wear eye protection. Protective equipment such as dust mask, non-skid safety shoes, hard hat or hearing protection used for appropriate conditions will reduce personal injuries.

Prevent unintentional starting. Ensure the switch is in the off-position before connecting to power source and/or battery pack, picking up or carrying the tool. Carrying power tools with your finger on the switch or energising power tools that have the switch on invites accidents.

Remove any adjusting key or wrench before turning the power tool on. A wrench or a key left attached to a rotating part of the power tool may result in personal injury.

Do not overreach. Keep proper footing and balance at all times. This enables better control of the power tool in

unexpected situations.

Dress properly. Do not wear loose clothing or jewellery. Keep your hair and clothing away from moving parts. Loose clothes, jewellery or long hair can be caught in moving parts.

If devices are provided for the connection of dust extraction and collection facilities, ensure these are connected and properly used. Use of dust collection can reduce dust-related hazards.

Do not let familiarity gained from frequent use of tools allow you to become complacent and ignore tool safety principles. A careless action can cause severe injury within a fraction of a second.

POWER TOOL USE AND CARE

Do not force the power tool. Use the correct power tool for your application. The correct power tool will do the job better and safer at the rate for which it was designed.

Do not use the power tool if the switch does not turn it on and off. Any power tool that cannot be controlled with the switch is dangerous and must be repaired.

Disconnect the plug from the power source and/or remove the battery pack, if detachable, from the power tool before making any adjustments, changing accessories, or storing power tools. Such preventive safety measures reduce the risk of starting the power tool accidentally.

Store idle power tools out of the reach of children and do not allow persons unfamiliar with the power tool or these instructions to operate the power tool. Power tools are dangerous in the hands of untrained users.

Maintain power tools and accessories. Check for misalignment or binding of moving parts, breakage of parts and any other condition that may affect the power tool's operation. If damaged, have the power tool repaired before use. Many accidents are caused by poorly maintained power tools.

Keep cutting tools sharp and clean. Properly maintained cutting tools with sharp cutting edges are less likely to bind and are easier to control.

Use the power tool, accessories and tool bits etc. in accordance with these instructions, taking into account the working conditions and the work to be performed. Use of the power tool for operations different from those intended could result in a hazardous situation.

Keep handles and grasping surfaces dry, clean and free from oil and grease. Slippery handles and grasping surfaces do not allow for safe handling and control of the tool in unexpected situations.

SERVICE

Have your power tool serviced by a qualified repair person using only identical replacement parts. This will ensure that the safety of the power tool is maintained.

BENCH GRINDER SAFETY WARNINGS

- **Do not use a damaged accessory. Before each use, inspect the accessory such as abrasive wheels for chips and cracks. After inspecting and installing an accessory, position yourself and bystanders away from the plane of the rotating accessory and run the power tool at maximum no-load speed for one minute.** Damaged accessories will normally break apart during this test time.
- **The rated speed of the accessory must be at least equal to the maximum speed marked on the power tool.**



Accessories running faster than their rated speed can break and fly apart.

- **Never grind on the sides of a grinding wheel.** Grinding on the side can cause the wheel to break and fly apart.

ADDITIONAL SAFETY WARNINGS

- Always wear safety goggles and a dust mask.
- Wear ear protectors. Exposure to noise can cause hearing loss.
- The product is not suitable for wet grinding.
- Always use the product with accessories on both spindles in order to limit the risk of contact with the rotating spindle.
- Always use the guard, work rest, transparent screen and spark arrestor as required for the accessory.
- Replace damaged or deeply grooved wheels.
- Always adjust the work rest so that the angle between the work rest and the tangent of the accessory is always greater than 85°.
- Mount the bench grinder firmly to the workbench, grinding stand or other rigid frame before operation. An unsecured bench grinder is unstable and may move during operation. This may result in damage or injury.
- Provide adequate general or localised lighting to prevent stroboscopic effect and hazards.
- Prior to operation, inspect the components and any accessories of the bench grinder to ensure there are no conditions that may affect proper operation. Tighten grinding wheel lock nuts, securing bolts and all clamps and guards.
- Prior to each start up, inspect the grinding wheel for damage. Do not use damaged or unshaped wheels. Replace any damaged grinding wheel according to the instructions.
- Check that the wheel rotates freely prior to each start up. With the bench grinder unplugged and the switch turned to OFF, carefully spin the wheel by hand. The wheel should not contact any components of the bench grinder, and there should be no binding or other conditions that may affect proper operation.
- During each start-up, stand to one side of the grinder and switch it ON. Let the grinder operate at full speed for one minute so that any undetected flaws or cracks of the wheel will become apparent. Do not contact the wheel with the work piece until the bench grinder has reached full speed.
- Do not force the product. Use the correct product for your application. The correct product will do the job better and safer at the rate for which it was designed.
- Always hold the workpiece firmly when grinding.
- To minimise the risk of tipping the product, always support long workpieces.
- Never grind more than one workpiece at a time. Do not stack more than one workpiece on the work rest at a time.
- Do not reach into the product while it is running.
- Avoid awkward operations and hand positions where a sudden slip could cause your hand to move into the grinding wheel.
- Avoid kickback by grinding in accordance with directional arrows.
- Never stand or have any part of your body in line with the path of the workpiece.
- Chips and splinters must not be removed while the product is running.
- Keep hands and body parts clear of grinding wheels. Contacting the rotating wheel may cause injury.
- Always use guards and transparent screens. Keep all guards in place and in working order. Operating the bench grinder without guards or with damaged guards may result in injury.
- Avoid burns. Grinding may cause items and the grinding wheel to become hot. Do not touch the grinding wheel or items that may be hot.
- Do not use the grinder to work on small items or items which cannot be held properly. The item may be thrown and result in injury.
- Never grind on the side of the wheel. The wheel will shatter. Grind on the face of the wheel only.
- Never leave a running tool unattended. Turn the power switch to OFF. The grinding wheels continue to rotate after the tool is switched off. Do not leave the tool until it has come to a complete stop.
- Never reach behind or beneath the grinding wheels.
- Use ear protection, such as plugs or muffs, during extended periods of operation.
- Remove the plug before carrying out any adjustment, servicing or maintenance. The power cord must remain unplugged whenever you are maintaining your bench grinder.
- Adjust the work rests and spark arrestors frequently so as to compensate for wear of the grinding wheel.
- Adjust the work rests whenever necessary to keep the distance between the work rests and the grinding wheels as small as possible. This distance should be less than or equal to 2 mm. As the diameter of the grinding wheel decreases with use, maintain the maximum work rest distance by adjusting it.
- Adjust spark arrestors whenever necessary to keep the distance between the spark arrestors and the grinding wheels as small as possible. This distance should be less than or equal to 2 mm. As the diameter of the grinding wheel decreases with use, maintain the maximum spark arrestor distance by adjusting it.
- Replace the worn wheel when the distance of 2 mm between the spark arrestor/work rest and the wheel are no longer able to be maintained.
- If the work rest becomes worn or damaged, replace it with an identical replacement from the authorised service centre.
- When fitting a new grinding wheel, always check that the stated maximum RPM meets or exceeds that stated on the grinder. Ensure the wheel diameter and arbor size meet that stated on the specifications. Also check the new wheel for damage, such as flaws or cracks.
- If the supply cord is damaged, it must be replaced by an authorised service centre in order to avoid a safety hazard.
- It is recommended that the product always be supplied via a residual current device having a rated residual current of 30mA or less.

GRINDING WHEEL SAFETY INSTRUCTIONS

WARNING

To reduce the risk of injury, user must read and comply with instructions, warnings and operator's manual before starting to use this grinding wheel. Failure to heed these warnings can result in wheel breakage and serious personal injury. Save these instructions.

- The use of any wheel other than the one recommended in the machine instruction manual may present a risk of personal injury. Use only grinding wheels which have marked speed equal or greater to that marked on the machine.
- Never use grinding wheel that is too thick to allow outer flange to engage with the flats on the spindle. Larger wheels will come in contact with the wheel guards, while thicker wheels will prevent the bolt from securing the wheel on the spindle. Either of these situations could result in a serious accident and can cause serious personal injury.
- This wheel is for grinding and shaping metal. Do not attempt to do cut-off operation.
- This grinding wheel is only suitable for dry grinding.
- Do not use damaged grinding wheels, do not use wheels that are chipped, cracked or otherwise defective.
- Ensure that the abrasive grinding wheel is correctly fitted and tightened before use.
- Machine should never be connected to power supply when you are installing or removing grinding wheels.
- Store your spare grinding wheel carefully.
 - Keep the wheel inside the original package if possible.
 - Store the wheel in a dry area at room temperature.
 - Wheels may be stored vertically on a shelf.
 - Do not allow the wheels to fall or suffer any impact.

Information available on the grinding wheel label

The information on the wheel label is important. Read and check it carefully to ensure you are selecting the correct type of wheel.

1. Manufacturer, supplier, importer or trade mark.
2. Nominal dimensions of grinding wheel, in particular the diameter of the bore.
3. Abrasive type, grain size, grade or hardness, type of bond and use of reinforcement.
4. Maximum operation speed in metres per second.
5. Maximum permissible speed of rotation in 1/min .
6. For declaration of conformity, the abrasive products shall be marked with EN 12413.
7. Restriction of use and safety warning symbols.
8. Traceability code, eg. A production/batch number, expiry date or series number.

INTENDED USE

- This bench grinder is intended for grinding and shaping metal. It can be used to sharpen metal hand tools (e.g. chisels, axes, knives) or drill bits, remove burrs or sharp edges.
- Never use the bench grinder for cut-off operations.

RESIDUAL RISK

Even when the machine is used as prescribed, it is still impossible to completely eliminate certain residual risk factors. The following hazards may arise in use and the operator should pay special attention to avoid the following:

- Risk of contact with unguarded parts of the rotating wheel.
- Burn hazard from contact with hot wheel or work piece.
- Damage to respiratory system if effective dust mask is not worn.
- Damage to hearing if effective hearing protection is not worn.

ENVIRONMENTAL PROTECTION



Recycle raw materials instead of disposing of as waste. The machine, accessories and packaging should be sorted for environmental-friendly recycling.

SYMBOLS



Safety alert

V

Volts

Hz

Hertz

~

Alternating current

W

Watts

n_0

No-load speed

min⁻¹

Revolutions or reciprocations per minute



Regulatory Compliance Mark (RCM). This product meets applicable regulatory requirements.



Please read the instructions carefully before starting the machine.



Wear ear protection



Wear eye protection



Not for wet grinding or cutting



Do not use chipped, cracked or defective grinding wheel



Wear safety gloves.



Wheel rotation direction (shown on wheel label)



Wheel rotation direction (shown on wheel guard)



Visible radiation, instructional safeguard



Waste electrical products should not be disposed of with household waste. Please recycle where facilities exist. Check with your Local Authority or retailer for recycling advice.

PRODUCT SPECIFICATIONS

Motor type	Induction
Horsepower	3/4 HP, 550W
Motor ratings	230 - 240 V ~ 50 Hz
No-load speed	3000 min ⁻¹
Wheel diameter	8" (200 mm)
Wheel width	1" (25.4 mm)
Arbor hole	5/8" (15.88 mm)
Abrasive wheels supplied	Coarse (36 grit) left wheel Fine (60 grit) right wheel
Lamp power (type)	12V.10W (Incandescent)
Net weight	17.6 kg
Minimum workpiece dimensions	2 mm x 2 mm x 30 mm
Measured sound values determined according to EN 62841:	
A-weighted sound pressure level	81.0 dB (A)
Uncertainty K	3 dB (A)
A-weighted sound power level	87.0 dB (A)
Uncertainty K	3 dB (A)
Wear ear protectors.	

Replacement parts

Wheel (36 grit)	089056004006
Wheel (60 grit)	089056004055
Left work rest	089056004028
Right work rest	089056004053
Light bulb	089056004066
Transparent screen assembly (left)	089056004022
Transparent screen assembly (right)	089056006005

⚠ WARNING!

The declared noise emission value(s) have been measured in accordance with a standard test method of EN 62841-1 and EN 62841-3-4, and may be used for comparing one tool with another. The declared noise emission value(s) may also be used in a preliminary assessment of exposure.

The noise emissions during actual use of the power tool can differ from the declared values depending on the ways in which the tool is used especially what kind of workpiece is processed.

Identify safety measures to protect the operator that are based on an estimation of exposure in the actual conditions of use (taking account of all parts of the operating cycle such as the times when the tool is switched off and when it is running idle in addition to the trigger time).

Wear ear protectors. Exposure to noise can cause hearing loss.

DESCRIPTION

1. Transparent screen x 2
2. Spark arrester x 2
3. Grinding wheel x 2
4. Work rest (left)
5. Work rest lock knob x 2
6. On/Off switch
7. Lamp
8. Wheel guard cover x 2
9. Work rest (right)
10. Base – bolt-down area
11. Transparent screen mounting rod
12. Transparent screen fixing knob
13. Flat washer
14. Spring washer
15. Hex bolt
16. Mounting hex bolt (not supplied)
17. Mounting flat washer (not supplied)
18. Mounting nut (not supplied)
19. Flat washer
20. Wheel nut
21. Outer flange
22. Hex flange nut
23. Coolant tray

KNOW YOUR GRINDER

See figure 1.

The safe use of this product requires an understanding of

the information on the tool and in this operator's manual as well as a knowledge of the project you are attempting. Before use of this product, familiarize yourself with all operating features and safety rules.

ASSEMBLY

UNPACKING

- Carefully remove the tool and any accessories from the box. Make sure that all items listed in the packing list are included.
- Inspect the tool carefully to make sure no breakage or damage occurred during shipping.
- Do not discard the packing material until you have carefully inspected and satisfactorily operated the tool.

PACKING LIST

Work rest (left/right)	2
Transparent screen	2
Transparent screen fixing knob	2
Transparent screen mounting rod (left/right)	2
Transparent screen assembly mounting bolt	2
Transparent screen assembly mounting washer	2
Transparent screen assembly mounting locking washer	2
Hex nut	4
Washer	4

⚠ WARNING

If any parts are damaged or missing do not operate this product until the parts are replaced. Use of this product with damaged or missing parts could result in serious personal injury.

⚠ WARNING

Do not attempt to modify this tool or create accessories not recommended for use with this tool. Any such alteration or modification is misuse and could result in a hazardous condition leading to possible serious personal injury.

INSTALLING AND ADJUSTING TRANSPARENT SCREENS

See figures 2 - 3.

Transparent screens must be installed before operating the grinder.

1. Using hex bolts, mount the transparent screen mounting rods to the inner left and right side of the wheel guard covers.
2. Slide the transparent screens into the mounting rods.
3. Tighten the transparent screen fixing knobs, but leave them loose enough to allow the transparent screens to be

raised and lowered easily.

INSTALLING AND ADJUSTING WORK RESTS

See figure 4- 6.

1. Attach the left work rest to the left wheel guard. Make sure the pin on the wheel guard sits in the lower slot of the work rest.
2. Slide the work rest in or out to adjust the distance gap. **NOTE:** The distance between the work rest and wheel must be between 1.6 mm and 2 mm.
3. Lock the work rest in place with a flat washer and lock knob.
4. Repeat the steps above to install the right work rest on the other side.

ADJUSTING SPARK ARRESTORS

See figure 7.

1. Loosen the spark arrestor locking screw.
2. Adjust the spark arrestor so that the distance to the grinding wheel is between 1.6 mm and 2 mm.

MOUNTING THE GRINDER

See figure 8.

Before using the grinder, it must be properly and securely mounted on a sturdy workbench or grinding stand.

1. Position the grinder on the workbench.
2. Mark on the workbench through the two mounting holes located at the grinder base.
3. Drill holes on the marks of the workbench.
4. Using two M5 bolts, washers, lock-washers and nuts (not supplied), secure the grinder to the workbench.

⚠ WARNING

Bench grinders vibrate. Grinder movement during high-speed rotation may cause damage or injury to the workpiece or operator.

OPERATION

⚠ WARNING

Do not allow familiarity with tools to make you careless. Remember that a careless fraction of a second is sufficient to inflict severe injury.

⚠ WARNING

Always wear safety goggles or safety glasses with side shields when operating tools. Failure to do so could result in objects being thrown into your eyes resulting in possible serious injury.

⚠ WARNING

Disconnect the tool before leaving the work area, moving the tool to another location, or handing the tool to another person. Failure to do so could result in serious personal injury.

SWITCHING ON/OFF

See figure 1.

Push the On/Off switch to turn the grinder on or off.

GRINDING

- Adjust the work rest to accommodate large or unusually-shaped workpieces.
- Always keep the workpiece moving across the face of the grinding wheel. Grinding continuously on the same spot of the wheel will cause grooves to be worn into the wheel. The wheel may be easily cracked or damaged, and grinding of other objects will be difficult.
- If the workpiece becomes hot, dip it into the water or oil.
- Always grind on the face of the wheel (around the diameter), NEVER on the sides. Side pressure on grinding wheels can cause cracking and damage.
- Use the left work rest for grinding general workpieces. Use the groove on the right work rest for grinding drill bits.

REPLACING GRINDING WHEEL

See figure 9 - 10.

These are some reasons the wheel may require to be changed:

- If the face of the grinding wheel is worn unevenly, becomes grooved, or is no longer smooth and flat.
- If the diameter of the grinding wheel is no longer round.
- If the surface of the wheel becomes loaded and dull with workpiece material.
- If there is any sign of damage.
- If it becomes difficult to work with.
- If the work rest / spark arrestor cannot be adjusted to max 2 mm distance from surface.
- Replace grinding wheel when its diameter wear value is more than 8 mm.
- If ≤ 1 cm of disc protrudes from flange. See figure 10.

⚠ WARNING

Turn the power off and remove the plug before changing the grinding wheels.

1. Use a wrench to remove the hex flange nut, then remove the wheel guard cover.
2. Fit an appropriately-sized wrench on the spindle hex nut.
3. Loosen the wheel nut in a clockwise direction for the left side and a counter-clockwise direction for the right side.
4. Remove the outer flange and grinding wheel. To remove the hex nut, turn the wrench and nut until the wrench is resting on the workbench behind the tool.
5. Inspect the new wheel carefully to ensure there are no cracks, chips or other damage. Use the ring method to test for cracks. If the wheel has a crack, it will not ring when it is tapped with a hard object.

⚠ WARNING

Do not install or use a damaged grinding wheel. The force of rotation may cause a damaged wheel to fly apart, injuring operators or bystanders.

6. Wipe the flange surfaces clean, then install the new wheel, flange and spindle hex nut.

⚠ WARNING

Do not over-tighten the spindle hex nut, because this may cause the wheel to crack.

7. Ensure the grinding wheel and outer flange are properly seated on the spindle shaft.
8. Replace the wheel guard cover.
9. Re-position and re-adjust the work rest, spark arrestor and transparent screens after installation of the new wheel.

⚠ WARNING

When turning the grinder on with a newly-installed wheel, **DO NOT STAND IN FRONT OF THE GRINDER.** Stand to the side and allow the grinder to run for at least one minute before proceeding to use it.

MAINTENANCE

⚠ WARNING

For greater safety and reliability, all repairs should be performed by an authorised service centre.

⚠ WARNING

When servicing, use only identical replacement parts. Use of any other parts may create a hazard or cause product damage.

⚠ WARNING

Servicing beyond recommended maintenance should only be performed by an authorized qualified technician.

GENERAL MAINTENANCE

Check power cord	Before each use
Check wheels for cracks	Before each use
Check moving parts for alignment and binding issues	Before each use
Replace grinding wheels	As needed
Clean and vacuum dust from the motor housing and other grinder parts	As needed
Replace work-light bulb	As needed

Avoid using solvents when cleaning plastic parts. Most plastics are susceptible to damage from various types of commercial solvents and may be damaged by their use. Use clean cloths to remove dirt, dust, oil, grease, etc.

WARNING

Do not at any time let brake fluids, gasoline, petroleum-based products, penetrating oils, etc., come in contact with plastic parts. Chemicals can damage, weaken or destroy plastic which may result in serious personal injury.

- We recommend using the original package for storage to protect the product against dust.

LUBRICATION

No lubrication required as bearings are greased for life.

COOLANT TRAY

See figure 11.

When grinding, metal objects become heated quickly. It is important to keep moving the object back and forth across the face of the grinding wheel, and to cool the object frequently using the coolant tray.

REPLACING WORK-LIGHT BULB

Contact dealer or retailer for replacement bulbs.

1. When the light bulb is worn out and will no longer work, unfasten the screws that hold the lamp cover, then gently remove the bulb from the holder by pushing 'in' and turning counter-clockwise.
2. To replace, gently push the new light bulb into the socket and turn clockwise.
3. Re-attach the lamp cover.

Use only AEG accessories and spare parts. Should components need to be replaced which have not been described, please contact one of our AEG service agents (see our list of guarantee/service addresses).

If needed, an exploded view of the product can be ordered. Please state the Article No. as well as the machine type printed on the label and order the drawing at your local service agents or directly at:

Techtronic Industries Australia Pty Ltd

PO Box 1065
Mount Waverley VIC 3149
Tel. no. 1300 234 797
Australia

Techtronic Industries N.Z. Limited

PO Box 12-806
Penrose AUCKLAND 1642
Tel no. 0800 234 797
New Zealand



TRANSPORTATION AND STORAGE

See figure 12.

- When storing the product, disconnect the power cord.
- Clean the product using a brush and vacuum cleaner.
- Always carry and lift the product according to the instruction in this user manual.
- Protect the product from any heavy impact or strong vibrations which may occur during transportation in vehicles.
- Secure the product to prevent it from slipping or falling over.
- Store the product and its accessories in a dry, safe place which is not accessible to children.



AEG



www.aegpowertools.com.au
www.aegpowertools.co.nz

Techtronic Industries Australia Pty Ltd

31 Gilby Road, Mount Waverley
VIC, 3149, Australia

Techtronic Industries N.Z. Limited

Unit C, 70 Business Parade South
Highbrook, Auckland 2013, New Zealand

20200528v4b

*AEG is a registered trademark used under
license from AB Electrolux (publ).
© 2016-20 Techtronic Cordless GP.*

