

# BARACUDA®

THE TRUSTED NAME IN POOL CARE

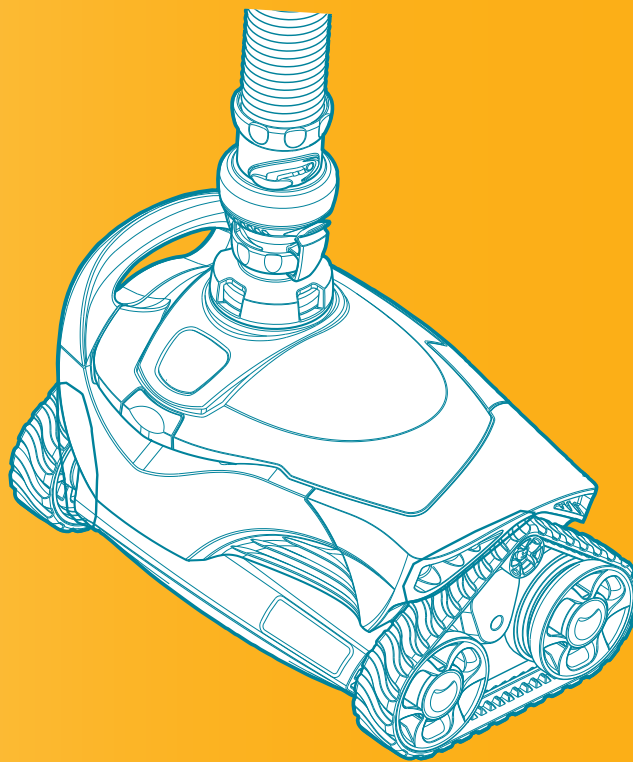

tracker™

## Owner's Manual

## Important Information

**Notice for Vinyl Liner Pools:** Before installing your pool cleaner, examine the interior of your pool carefully. If the vinyl liner is brittle or has stones, wrinkles, roots or metal corrosion in contact with the underside of the liner, or has damage to the base material or supporting walls, do not install the cleaner before having a qualified professional perform the necessary repairs or liner replacement. **Zodiac Group Australia Pty Ltd (Zodiac) will not be responsible for liner damage caused by a cleaner which is in disrepair, pattern removal from a vinyl liner, or a cleaner used in a pool having an aged or deteriorated liner.** Please see Limited Warranty.

- Clean the skimmer basket, pump basket and pool filter before installing the cleaner and on a regular basis thereafter.
- Always disconnect the cleaner from the pool wall or skimmer before cleaning or backwashing the pool filter. After cleaning or backwashing, let the filtration system run for at least five (5) minutes before re-connecting the cleaner.
- Remove the cleaner from the pool before chemical or shock treatments. Wait a minimum of four (4) hours after super chlorination before re-installing the cleaner.



Read owner's manual completely before operating the cleaner.



Remove cleaner before entering the pool.



Do not operate outside of the pool.



Do not let children play with cleaner.

## Exceptional After Sales Support

We have a trained team on hand to help walk you through how to set up your cleaner and equipment. For installation and troubleshooting questions, please directly contact BARACUDA® After Sales.

And don't forget to register your product online for warranty (see Warranty Card inside the pack).

Happy Swimming!

For more information visit [www.baracuda.com.au](http://www.baracuda.com.au)  
or call **1300 784 423**

# Introduction

Congratulations on the purchase of your new BARACUDA® Tracker™ automatic pool cleaner. Your Tracker is designed and manufactured for easy installation, and years of carefree operation. Before installing the cleaner, please take a few moments to become familiar with its components and to review the items listed under Important Information.

Like most mechanical devices, the Tracker requires periodic adjustments, routine maintenance, and the replacement of certain hardworking parts.

Always insist on genuine Baracuda replacement parts. Non-Baracuda parts are not made to our specifications. They may have an adverse effect on the operation of your Tracker, or may even damage it.

## Complete Cleaner Parts in the Pack

1. Cleaner Body
2. AD Flow Valve & Connector
3. Universal Weir Cuff
4. Flow Regulator Valve
5. Twist-Lock Hose Section (x 9)
6. Leader Hose with Float
7. 90 Degree Elbow

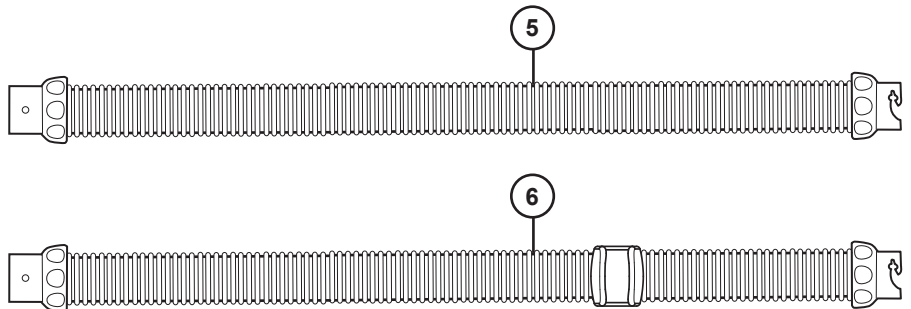
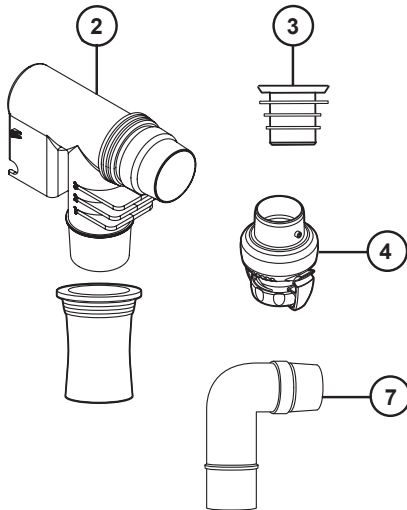
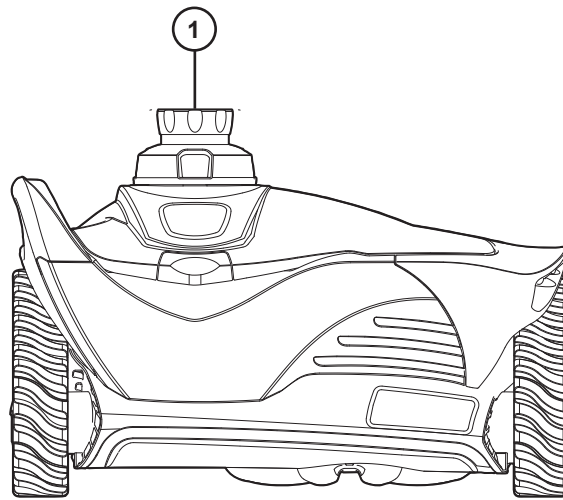

# Installation

## 1. Before You Start

For best cleaner performance, you will need to follow the following steps of the installation.

- 1.1 Following manufacturer's instructions, clean the filter and empty the skimmer and the pump strainer basket.
- 1.2 If your main drain is connected to the skimmer box, block off access.
- 1.3 Manually vacuum the pool.
- 1.4 Ensure circulation system is operating at maximum water flow, or you will need to re-adjust when it comes to clean the filter baskets.
- 1.5 Adjust water flow, from all return inlets:
  - a) Downward and toward each other OR
  - b) Downward and toward the centre of the pool.

If return inlet directional fittings can't be directed far enough down to prevent water flow affecting the natural movement of the hose, you will need to install return line diverters.

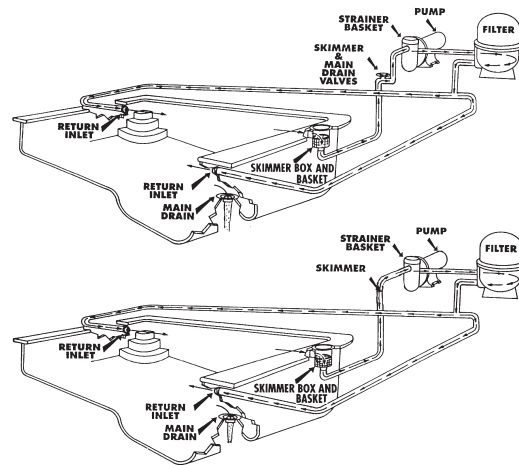

## 2. AD Flow Valve

The AD Flow valve works by regulating the flow through the pool cleaner to the pump. As the filter collects debris, the valve will automatically maintain the correct flow.

The installation of the AD Flow valve will depend upon the type of skimmer box and Vac plate you have. It is either installed straight in from the top of the Vac plate or from the bottom of the Vac plate.

See the 4 different cases below.

**1st case:** with Waterco® Skimmer Box/Vac Plate

Screw in the AD Flow valve connector into the top of the Vac plate



**2nd case:** with Poolrite Skimmer Box/Vac Plate

Screw in the AD Flow valve connector into the bottom of the Vac plate.



**3rd case:** with Speed Regulator/Skimtrol Vac Plate

Simply connect the 90 Degree Elbow into the top of the Vac Plate.

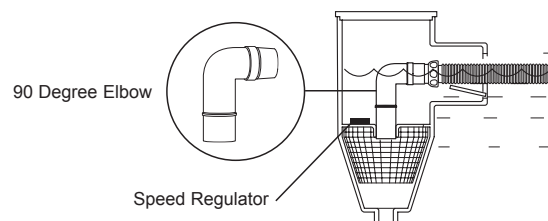

## 4th case: with any other type of Skimmer Box and Vac plate

Simply insert the AD Flow valve directly into the universal weir cuff which will then fit into the top of the Vac plate.

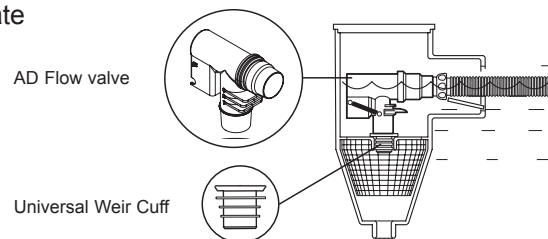

**NOTE:** The AD Flow valve has three settings: High (3), Medium (2) and Low (1). To deliver the maximum pool cleaning efficiency, the AD Flow valve comes preset at a factory setting of 2. You will need to adjust the AD Flow valve when and if a problem occurs.

## 3. Assemble the hose sections



### WARNING

To avoid any serious injury, turn off the pool pump before proceeding to this step.

Start to connect one of the standard hose to the skimmer box Vac plate. Then continue adding lengths of standard hose sections until you reach the furthest point of the pool, opposite to the skimmer box. THEN add the leader hose section.

See below examples.

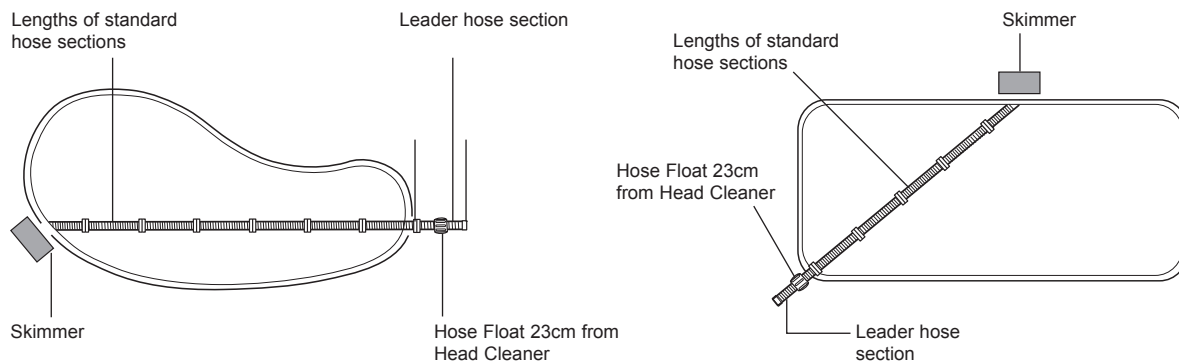

# Installation

## 4. Connecting Cleaner Head to Flow Regulator Valve

- 4.1 Remove orange sticker off leader hose.
- 4.2 Attach the flow regulator valve to the leader hose and connect the cleaner head to the flow regulator valve.

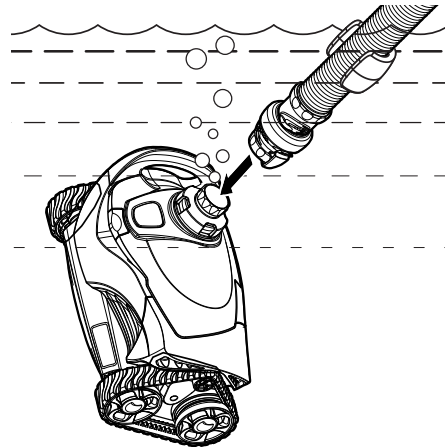
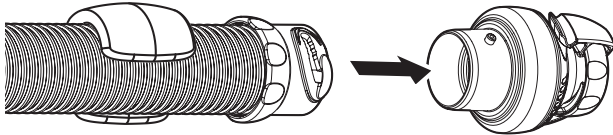



## 5. Re-Connecting to Skimmer Box

- 5.1 Temporarily disconnect hose from skimmer, turn on pool filter pump.
- 5.2 Flood the hose with water, turn off pool filter pump, reconnect hose to skimmer box, then turn pool filter pump back on.

## 6. Check Cleaner Flow

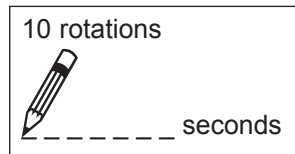
- 6.1 Watch the orange wheel marker, use a stopwatch to time ten (10) wheel rotations.



IF	Time is ...	Result ...	Adjust Flow ...
	26-50	Poor Performance	Increase Flow <b>+</b>
	20-25		
	10-19	Possible Damage	Decrease Flow <b>-</b>

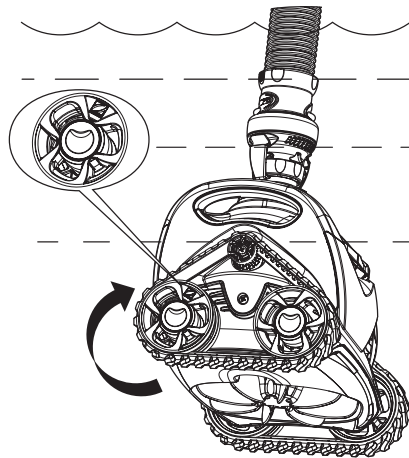

## 7. Adjust Flow if Necessary, using the AD Flow Valve

- 7.1 The AD Flow Valve has three settings: (1) Low, (2) Medium, and (3) High. The valve comes with a factory setting of (2).
  - + Adjust the AD Flow Valve to setting (3) to increase flow.
  - Adjust the AD Flow Valve to setting (1) decrease flow.

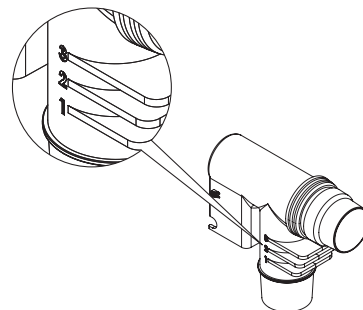

The Tracker™ pool cleaner cycles on/off with the pool filtration pump, vacuuming and cleaning all surfaces randomly throughout the pool. The climbing ability of the cleaner is dependent on the pool's shape and available water flow. If your Tracker is not climbing the pool walls, ensure the flow is correct by counting wheel speed. Also, ensure the pool's surface is not covered in algae as this slippery surface will affect the cleaner's traction.

During each coverage pattern cycle, the Tracker cleaner moves forward and pivots to the left. The power scrubbers underneath the cleaner create down force for climbing and stability as well as directing debris into the cleaner mouth.

### **Removing the cleaner out of your pool**

It is most important to disconnect the head of the cleaner from the leader hose section when you take the cleaner out of the pool.

### **Backwashing the Pool Filter**

Always disconnect the Tracker from the pool wall before cleaning or backwashing the pool filter. After cleaning or backwashing, let the filtration system run for at least three (3) minutes to flush out the suction lines before re-connecting the cleaner.

### **Adding Chemicals to the Pool**

Remove the cleaner from the pool for at least four (4) hours when adding chemicals.

### **Storage and Winterizing**

Never store the Tracker in direct sunlight. When storing for the winter, drain out all the water (freeze damage is not covered by the warranty). Remove all connectors and adapters from the dedicated suction line or skimmer. When storing the cleaner, even for short times, do not coil the hose as the hose may develop memory which can affect cleaner performance. Disassemble the hoses and layout flat to store.

# Care and Maintenance

## Removing Debris from the Engine



### WARNING

To avoid serious injury, make sure that the cleaner is disconnected from the hose and the pool suction pump is turned off prior to starting this operation.

1. Push the latch release button on the top of the cleaner.
2. Rotate the top lid assembly back until it clicks into an upward position.
3. Look into engine and remove debris that is present.
4. If needed, slowly push engine paddles forward and/or backwards to move stuck debris to an accessible position then remove it. When moving the engine paddles, make sure the cleaner tracks are allowed to move freely as they will turn as the engine paddles rotate.
5. Close engine top and ensure the latch clicks in place.
6. Turn cleaner over and check for debris in scrubber and inlet.

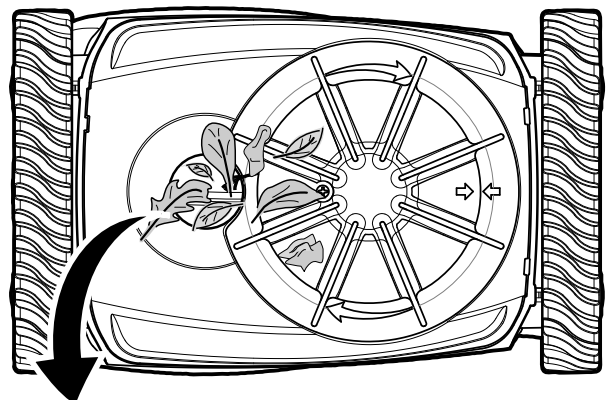
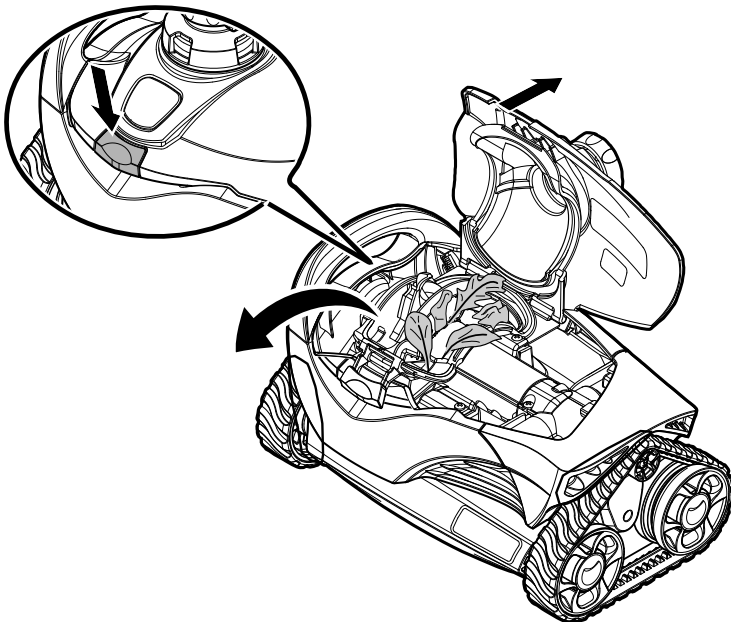



# Troubleshooting

If you experience a problem with your Tracker™, please follow the troubleshooting steps below to restore performance. If further assistance is required, contact BARACUDA® After Sales Support Department at 1300 784 423. Please have your serial number and date of purchase available when you call.

<b>Problem</b>	<b>Solution</b>
Cleaner does not move or moves slowly (+25 seconds for 10 wheel revolutions)	<ul style="list-style-type: none"><li>• Confirm that the main drain is closed.</li><li>• Check for debris jammed in engine. Backwash filter and empty pump basket.</li><li>• Check for air in system. If water level in pump basket drops or you see excessive air bubbles in the pump basket or coming from the return lines, there is air in the system. Tighten all fittings at pump.</li></ul>
Cleaner patterns, does not cover entire pool.	<ul style="list-style-type: none"><li>• Count Wheel Revolutions, flow may need to be adjusted via AD Valve/Skimtrol plate.</li><li>• Ensure return fittings are directed down. Add a return diverter if necessary.</li><li>• Make sure hose is not kinked or coiled. Lay in sun to straighten if necessary.</li><li>• Verify correct hose float positioning on the leader hose.</li><li>• Observe the cleaner for more than five (5) minutes and ensure that the drive track is going forwards smoothly. If it is not, contact your dealer or service center for help.</li><li>• Confirm proper hose length.</li></ul>
Cleaner gets stuck at steps.	<ul style="list-style-type: none"><li>• Observe the cleaner for more than five (5) minutes and ensure that the drive track is going forwards smoothly. If it is not, contact your dealer or service center for help.</li><li>• Ensure the swivel on top of the cleaner rotates freely.</li><li>• Count Wheel Revolutions, flow may need to be adjusted via AD Valve/Skimtrol plate.</li><li>• Confirm proper hose length. Shorten if necessary.</li></ul>
Cleaner won't climb walls.	<ul style="list-style-type: none"><li>• Count Wheel Revolutions, flow may need to be adjusted via AD Valve/Skimtrol plate.</li><li>• Verify correct hose float positioning on the leader hose.</li></ul>
Cleaner climbs too much (-18 seconds for 10 wheel revolutions)	<ul style="list-style-type: none"><li>• Count Wheel Revolutions, flow may need to be adjusted via AD Valve/Skimtrol plate.</li><li>• Verify correct hose float positioning on the leader hose.</li></ul>

# BARACUDA®

THE TRUSTED NAME IN POOL CARE

Baracuda is a registered trademark of  
**Zodiac Group Australia Pty Ltd**  
ABN 87 002 641 965  
219 Woodpark Rd, Smithfield, NSW 2164 Australia  
Tel: 1800 688 552 [www.zodiac.com.au](http://www.zodiac.com.au)

© Copyright Zodiac Australia Ltd 2015