

INSTALLATION GUIDE HINGED GRAB RAIL

IMPORTANT

- In order to achieve the specified weight capacity, this product must be fixed to the internal wall stud or a solid framing structure.
- The included fixings are for use with solid walls only. It is the installer's responsibility to ensure that the correct fixings are used to suit the wall type and that the product is mounted to a structure capable of supporting the specified weight capacity.

INSTALLATION

1. Place the grab rail in the desired position and mark the holes for drilling. All fixing holes must be used.
2. Using an appropriate drill bit (e.g. masonry bit for tiles), drill holes to suit the wall plugs.
3. Insert wall plugs.
4. Line up the grab rail with the drilled holes and install the screws.

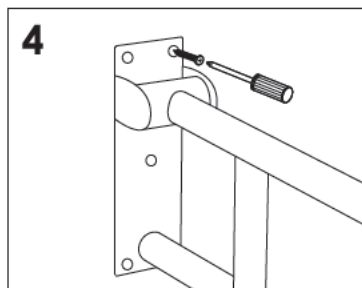
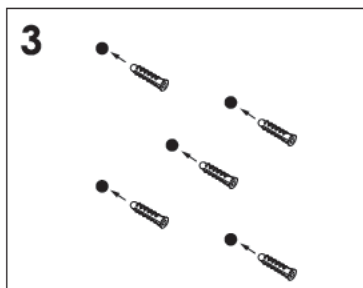
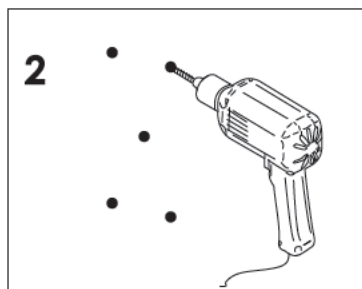
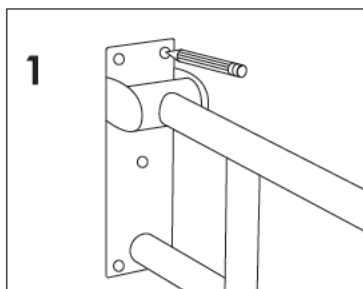

CARE AND MAINTENANCE

- Clean with a soft cloth and warm soapy water.
- Do not use harsh detergents, corrosive chemicals, or abrasive cleaners.

NOTES

This product is manufactured to comply with the following national standards:
AS 1428.1-2009, NZS 4121:2001.