

1. Firmly tighten the flexible hoses into the inlet tails at the base of the body, being careful to avoid damage to the O-ring seals. If the hoses have red and blue indicators make sure they are connected to the correct inlet port in the mixer.

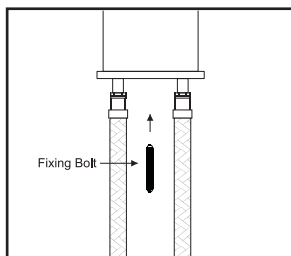

2. Screw the fixing bolt into the mixer base (remove fixing nut if installed).

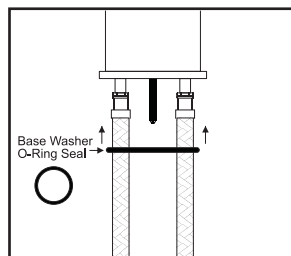

3. Place the base washer O-ring over the end of the hoses and insert into the base of the mixer.

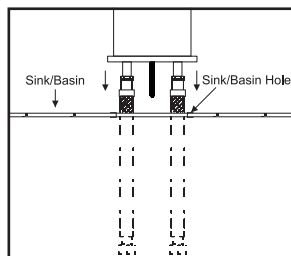

4. Feed the hoses through the sink/ basin hole, each end alternatively, and position the base washer between the sink/basin and the mixer base.

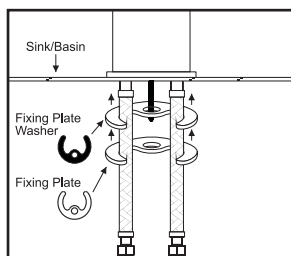

5. Position the fixing plate washer and fixing plate onto the bolt. The flexible hoses should be positioned towards the front of the sink/basin with the lever handle pointing towards the user. Fixing bolt positioned at the back.

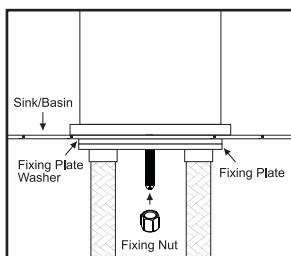

6. Lock the mixer onto the sink / basin by tightening the fixing nut onto the fixing plate.  
**NOTE:** Handle not to be used to align mixer in centre position after tightening of fixing bolt. Fixing bolt must be loosened to centre mixer with handle function and sink/basin.

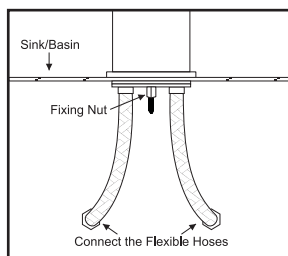

7. Connect the flexible hoses to the supply line, making sure the hot water is connected to the hot water hose.  
**Ensure the flexible hoses are not stretched, kinked or subject to abrasion. Do not expose the flexible hoses to naked flames or corrosive agents of any kind.**

8. **NOTE:** Warranty claims **WILL NOT** be honoured where the ceramic cartridge has malfunctioned due to the presence in the water supply of:  
copper tube pieces  
sand, dirt or stones  
thread tape  
other objects not normally present in potable water supplies.  
Refer to warranty card for warranty guidelines.

9. Prior to introducing the mains water supply, open the lever handle in the mixer position, midway between full hot and full cold. Remove the aerator from the end of the outlet, then introduce the mains water to thoroughly flush the supply lines and mixer.

10. Reinstall the aerator.

11. Check all joints for leaks.

### WORKING SPECIFICATIONS

In accordance with Australian standards requirements it is recommended that all tapware be installed by a licensed plumber. Please refer to the warranty card for service agreement.

• Hot and cold water inlet pressures should be equal.

Inlet pressure range: 150-500 kPa.

Pressure limiting valves should be installed where water pressure exceeds 500 kPa.

**NOTE:** As per AS/NZS 3500.1-2015 (Clause 3.3.4) on new installations the maximum operating pressure at any outlet within a building must not exceed 500 kPa.

• All pipework must be thoroughly flushed prior to installation, as foreign materials may block the flow regulating device and reduce the flow of water. Aerator insert housing must be re-tightened to prevent removal by hand.

• This mixer has a low flow rate and may not be suitable for connection to some Instantaneous Gas Water Heaters, some Tempering Valves, some Solar Water Heaters & some Thermostatic Mixing Valves. Check with the manufacturer of these products.

• Not recommended for gravity feed systems, tank water systems or bore water systems.

• Isolating stop taps must be fitted to the hot and cold water supply connections in accordance with local authority installation codes.

### CARING FOR YOUR PRODUCT

• Under no circumstances should you install tapware using acetone silicones.

• Never use harsh detergents or abrasive cleaners, as these will scratch the surface. Using a soft dry cloth or a soft cloth with warm soapy water is recommended.

• Where your tapware remains dry in use, a soft cloth can be used to remove surface dust. Alternatively, a wipe over with warm soapy water is all that is required to maintain the finish in perfect condition for a lifetime of use.

• Use of wax based furniture cream should be avoided as these can result in a build up of deposits, which could detract from the appearance.

• Do not use undue pressure and wipe in one direction only.

• Flexible hoses may become damaged if exposed to caustic or corrosive substances/environments during installation or cleaning, such damage will not be covered by warranty. We recommend that flexible hoses are replaced every 5 years.

### IMPORTANT SCOPE OF USE

• Thoroughly inspect all parts for defects or damage prior to installation. Warranty claims will be void if product is installed with pre-existing defects.

• This product has been designed to operate as an indoor mixer and has been manufactured and certified to the requirements of AS/NZS 3718 and AS/NZS 6400.

• This product should be installed by a licensed plumber in accordance with AS/NZS 3500 and any other local, state and national building codes and regulations. Check these regulations before attempting any DIY work.

• This product may not be suitable for gravity fed water systems, tank water systems or bore water systems.

• This product has a low flow rate and may not be suitable for connection to some of the following products: instantaneous gas water heaters, tempering valves, solar water heaters and thermostatic mixing valves. Check with the manufacturer of these products.

• This product has been designed for a 1/2" BSP inlet connection to both hot and cold water supply.

• The mixer may contain or be made from brass, stainless steel, plastic, ceramic and rubber components.

• Operating specifications — High pressure: min 150 kPa – max 500 kPa, Temperature: min 2 °C – max 60 °C (kitchen application), min 2 °C – max 50 °C (All other areas).