



Anker Innovations Limited. All rights reserved. eufy Security and eufy Security Logo are trademarks of Anker Innovations Limited, registered in the United States and other countries. All other trademarks are the property of their respective owners.

51005002322 V01



# QUICK START GUIDE

EUFYCAM 2C PRO  
WIRE-FREE 2K SECURITY CAMERA SET

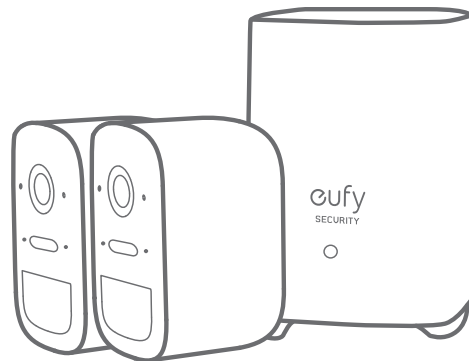

# TABLE OF CONTENTS

Getting Started	<b>01</b>	<b>05</b>	Mounting the Camera
Product Overview	<b>02</b>	<b>09</b>	Charging eufyCam 2C Pro
Connecting the HomeBase 2	<b>03</b>	<b>10</b>	Safety Statement
Setting Up the System	<b>04</b>		

# 1 / GETTING STARTED

## For HomeBase 2 installation



HomeBase 2  
(T8010)

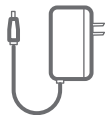

Power Adapter  
for HomeBase 2

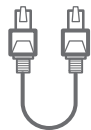

Ethernet  
Cable



Metal Pin  
for Resetting

## For eufyCam 2C Pro installation



eufyCam 2C Pro  
(T8142)



Micro-USB  
Charging Cable



Mounting  
Bracket



Mounting Screws  
and Anchors

1. Camera quantity and accessories vary by bundle package.  
2. HomeBase 2 power adapter varies by region.

# 2 / PRODUCT OVERVIEW

## HomeBase 2

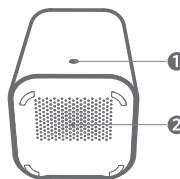

- 1. Status LED
- 2. Speaker
- 3. Power port
- 4. USB port

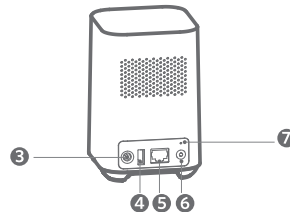

- 5. Ethernet port
- 6. SYNC/ALARM OFF button
- 7. Reset button

## eufyCam 2C Pro

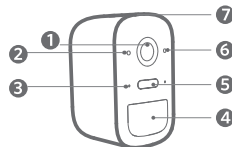

- 1. Lens
- 2. Light sensor
- 3. Microphone
- 4. Motion sensor
- 5. Spotlight
- 6. Status LED
- 7. SYNC button
- 8. Mounting hole

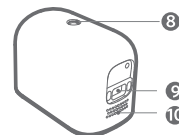

- 9. Charging port
- 10. Speaker

# 3 / CONNECTING THE HOMEBASE 2

## Connect the HomeBase 2 to the Internet

1. Power on the HomeBase 2, then use the ethernet cable provided to connect the HomeBase 2 to your home router.

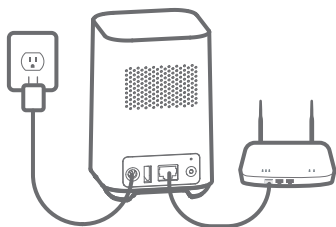

2. The LED indicator turns blue (this may take up to 1min) when HomeBase 2 is ready for setup.

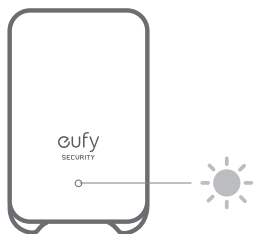

# 4 / SETTING UP THE SYSTEM

## Download the App and Set up the System

Download the eufy Security app from the App Store (iOS devices) or Google Play (Android devices).



Sign up for a eufy Security account, then follow the onscreen instructions to complete the setup.

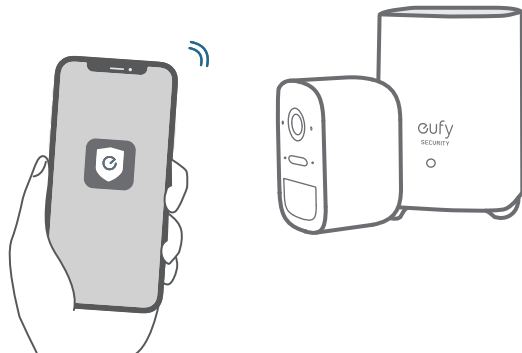

# 5 / MOUNTING THE CAMERA

## Find a Good Mounting Spot

To find a spot to mount eufyCam 2C Pro, you need to test wireless signal strength.

- ① Open the eufy Security app, go to Camera Settings > Mounting Guide.
- ② To test the wireless signal strength, take your camera and phone to the location where you want to mount the camera.
- ③ Move the camera as close to the HomeBase 2 as possible if the wireless signal strength is poor.

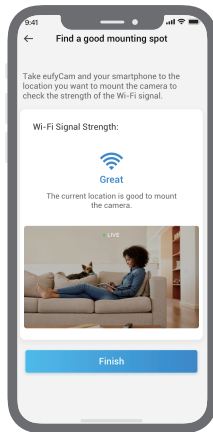

## Select Height and Location

Hang eufyCam 2C Pro 7-10 ft (2-3 m) above the ground. This height maximizes the detection range of the motion sensor of eufyCam 2C Pro. Avoid placing eufyCam 2C Pro under direct sunlight.

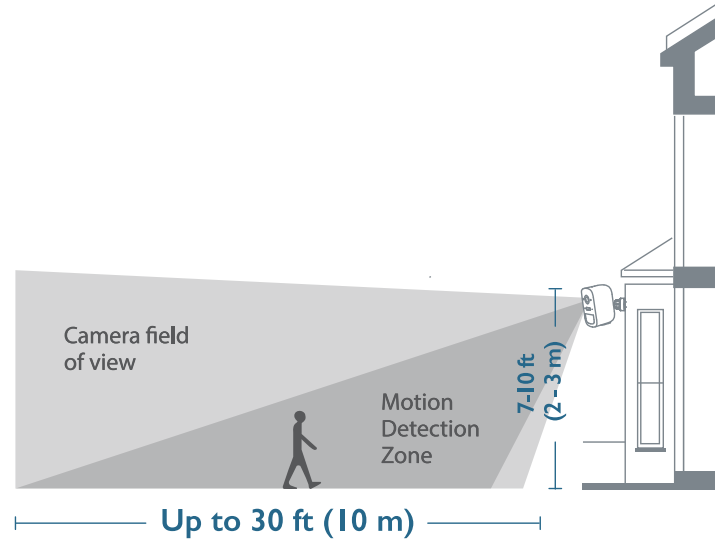

## Mount the camera

The camera can be mounted both indoors and outdoors.

1. Turn the knob of the mounting bracket clockwise to loosen and disassemble it.

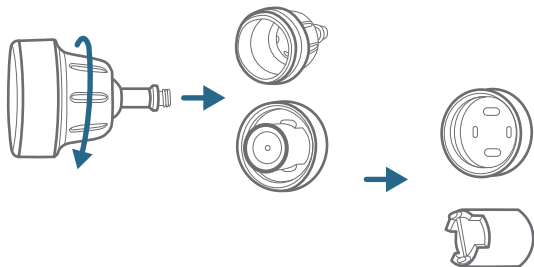

2. Drill holes with a 15/64 inch (5.95mm) drill bit, then insert the anchors into the holes; anchors are necessary for walls that are made out of hard materials such as concrete, brick, or stucco.

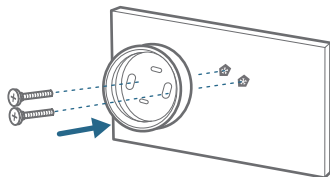

## Mount the camera

3.

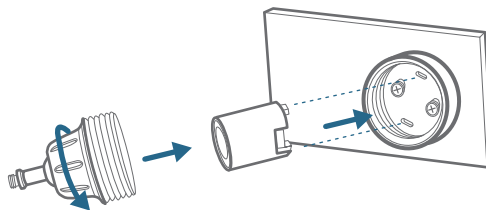

4. Tighten eufyCam 2C Pro to the mounting bracket and adjust the viewing angle by checking the live stream feed in the eufy Security app.

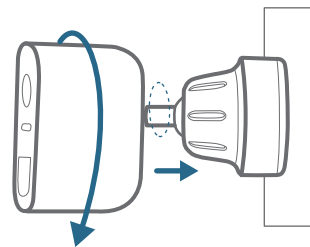

### Tips:

1. The Homebase 2 pairs up to 16 cameras, you can repeat the steps mentioned above to add more eufyCam 2C Pro cameras to meet different needs of use.
2. For troubleshooting, check Help on the eufy Security App.

# 6 / CHARGING EUFYCAM 2C PRO

## Charge eufyCam 2C Pro

### Method 1

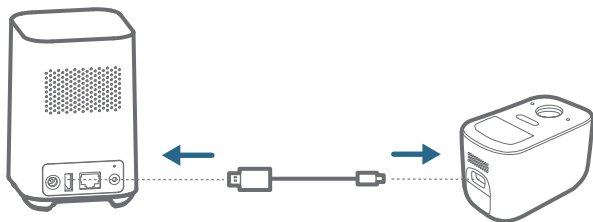

### Method 2

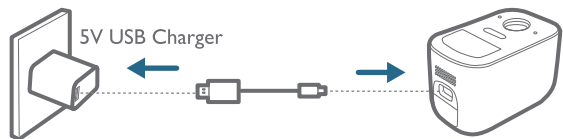

LED indication	Charging: Steady blue
	Fully charged: Off
Charging time	5 hours

# 7 / NOTICE

### FCC Statement

This device complies with Part 15 of the FCC Rules. Operation is subject to the following two conditions: (1) this device may not cause harmful interference, and (2) this device must accept any interference received, including interference that may cause undesired operation.

**Warning:** Changes or modifications not expressly approved by the party responsible for compliance could void the user's authority to operate the equipment.

**Note:** This equipment has been tested and found to comply with the limits for a Class B digital device, pursuant to Part 15 of the FCC Rules. These limits are designed to provide reasonable protection against harmful interference in a residential installation.

This equipment generates uses and can radiate radio frequency energy and, if not installed and used in accordance with the instructions, may cause harmful interference to radio communications. However, there is no guarantee that interference will not occur in a particular installation. If this equipment does cause harmful interference to radio or television reception, which can be determined by turning the equipment off and on, the user is encouraged to try to correct the interference by one or more of the following measures: (1) Reorient or relocate the receiving antenna. (2) Increase the separation between the equipment and receiver. (3) Connect the equipment into an outlet on a circuit different from that to which the receiver is connected. (4) Consult the

dealer or an experienced radio/TV technician for help.

### FCC Radio Frequency Exposure Statement

The device has been evaluated to meet general RF exposure requirements. The device can be used in fixed/mobile exposure condition. The min separation distance is 20cm.

### Notice: Shielded cables

All connections to other computing devices must be made using shielded cables to maintain compliance with FCC regulations.

The following importer is the responsible party  
Company Name: POWER MOBILE LIFE, LLC  
Address: 400 108th Ave NE Ste 400, Bellevue, WA 98004-5541  
Telephone: 1-800-988-7973



This product complies with the radio interference requirements of the European Community.

### Declaration of Conformity

Hereby, Anker Innovations Limited declares that this device is in compliance with the essential requirements and other relevant provisions of Directive 2014/53/EU. For the declaration of conformity, visit the Web site [www.eufylife.com](http://www.eufylife.com). Due to the used enclosure material, the product shall only be connected to a USB Interface of version 2.0 or higher. The adapter shall be installed near the equipment and shall be easily accessible. Do not use the Device in the environment at too high or too low temperature, never expose

the Device under strong sunshine or too wet environment.

The suitable temperature for HomeBase 2 and accessories is -10°C-45°C.

The suitable temperature for eufyCam 2C Pro and accessories is -20°C-50°C.

When charging, please place the device in an environment that has a normal room temperature and good ventilation.

It is recommended to charge the device in an environment with a temperature that ranges from 5°C-25°C.

Please ensure to use only the charger offered by the manufacturer; Using unauthorized charger may cause danger and violate the authorization of the device and the guarantee article.

This charger is for indoor use only

The charger type is ASSA67WV-120200, output voltage/current is 12Vdc/2A. The plug considered as disconnect device of adapter; RF exposure information: The Maximum Permissible Exposure (MPE) level has been calculated based on a distance of d=20 cm between the device and the human body. To maintain compliance with RF exposure requirement, use product that maintain a 20cm distance between the device and human body.

**CAUTION RISK OF EXPLOSION IF BATTERY IS REPLACED BY AN INCORRECT TYPE. DISPOSE OF USED BATTERIES ACCORDING TO THE INSTRUCTIONS.**

Wi-Fi Operating Frequency Range: 2412~2472MHz ;

Wi-Fi Max Output Power: 17.13 dBm (ERIP for T810), 17.9 dBm (ERIP for T8142)

SUB-1G Frequency range: 866~866.8MHz; SUB-1G Output Power: 5.492 dBm (ERIP for T8142)

The following importer is the responsible party (contact for EU matters only)

Importer: Anker Technology (UK) Ltd

Importer Address: Suite B, Fairgate House, 205 Kings Road, Tyseley, Birmingham, B11 2AA, United Kingdom



This product is designed and manufactured with high quality materials and components, which can be recycled and reused.



This symbol means the product must not be discarded as household waste, and should be delivered to an appropriate collection facility for recycling. Proper disposal and recycling helps protect natural resources, human health and the environment. For more information on disposal and recycling of this product, contact your local municipality, disposal service, or the shop where you bought this product.

### IC Statement

This device complies with Industry Canada licence-exempt RSS standard(s). Operation is subject to the following two conditions:

- (1) this device may not cause interference, and
- (2) this device must accept any interference, including interference that may cause undesired operation of the device."

Le présent appareil est conforme aux CNR d'Industrie Canada applicables aux appareils radio exempts de licence. L'exploitation est autorisée aux deux conditions suivantes:

- (1) l'appareil ne doit pas produire de brouillage, et
- (2) l'utilisateur de l'appareil doit accepter tout brouillage radioélectrique subi, même si le brouillage est susceptible d'en compromettre le fonctionnement."

This Class B digital apparatus complies with Canadian ICES-003.

Cet appareil numérique de la classe B est conforme à la norme NMB-003 du Canada.

### IC RF Statement:

When using the product, maintain a distance of 20cm from the body to ensure compliance with RF exposure requirements.

Lors de l'utilisation du produit, maintenez une distance de 20 cm du corps afin de vous conformer aux exigences en matière d'exposition RF.

# 8 / LEGAL NOTICE

Use of the Works with Apple HomeKit badge means that an electronic accessory has been designed to connect specifically to iPod touch, iPhone, or iPad, respectively, and has been certified by the developer to meet Apple performance standards. Apple is not responsible for the operation of this device or its compliance with safety and regulatory standards.

## Customer Service

### Warranty

12-month limited warranty

### Call Us

United States	+1 (800) 988 7973	Mon-Fri 9AM-5PM (PT)
United Kingdom	+44 (0) 1604 936 200	Mon-Fri 6AM-11AM (GMT)
Germany	+49 (0) 69 9579 7960	Mon-Fri 6:00-11:00

### Email Us

Customer Support: [support@eufylife.com](mailto:support@eufylife.com)

Anker Innovations Limited

Room 1318-19, Hollywood Plaza, 610 Nathan Road, Mongkok, Kowloon, Hong Kong



@EufyOfficial



@EufyOfficial



@EufyOfficial