

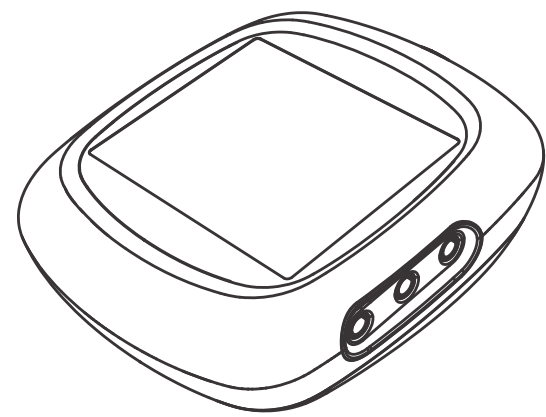

## User manual

### SMART WIRELESS BBQ THERMOMETER

**MAT15 / 0281535**



Contact us via email: matador@mayohardware.com.au

EN

### Get to Know the Device

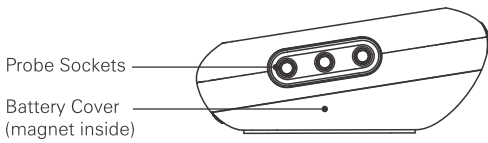
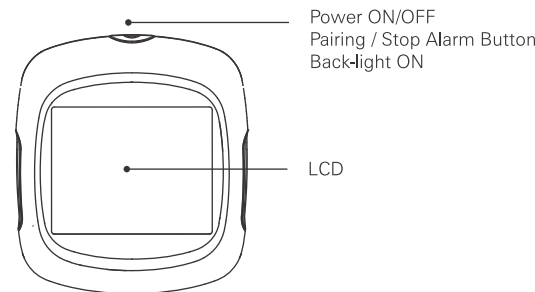

The Matador Smart Thermometer has 6 sockets, allowing you to monitor up to 6 different meats at the same time. Additional probes can be purchased for your unit. (I/N: 0281537)

1

### Screen Introduction

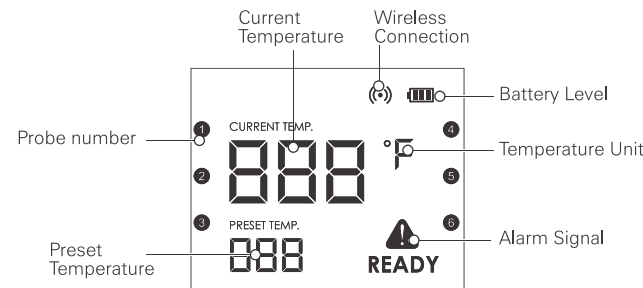

### Inserting Batteries

2 x AA batteries included.

① Push the tab on the battery cover inward to release the cover.

② Insert batteries, noticing the icons which show directions.

③ Replace the battery cover and the Thermometer should automatically turn on.

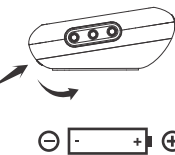

### Install the Probes

The device will keep scanning the sockets when its power is switched on. The Probe icons on LCD will display one by one from 1 to 6 where probes are plugged in.

Insert the probes into the food and make sure the front tip of the probe is in the center of the food to get an accurate temperature.

2

### Download the APP

Search the keyword 'Matador' in App store or Google Play, or scan the following QR code with your phone. Download and install it for free.

Make sure your phone meets the requirements:

iPhone 4S, and later models;  
iPod touch 5th, iPad 3rd generations and later models;  
all iPad mini;  
Android Bluetooth devices running version 4.3 or later, with blue-tooth 4.0 module.



### Power ON/OFF

- Press and hold the power button (located on top of the Thermometer) for more than 3 seconds to power on. The LCD screen will light up and 'ON' will be displayed on the screen.
- If you press the ON/OFF button while the Thermometer is ON, it will turn the device off.

### Matador APP Home Page Overview

Choose food type and preference for the food where each probe is inserted, the app and the device will display its current and target temperature.

When the food is ready, the app and the device will alarm.

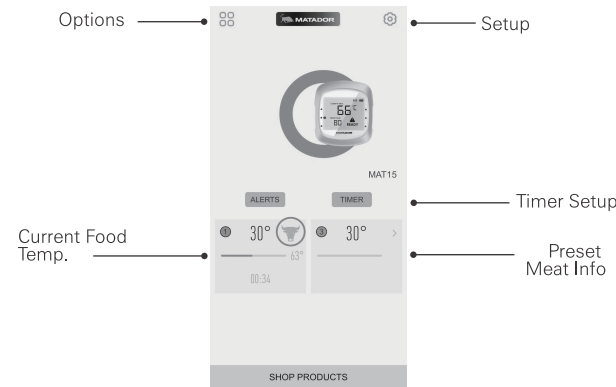

3

### Setting Your Meat Probes

① Insert probes into the Thermometer sockets and the below screen will display on your phone.

② To cook using preset or customised meat temperature settings, tap on the icon.

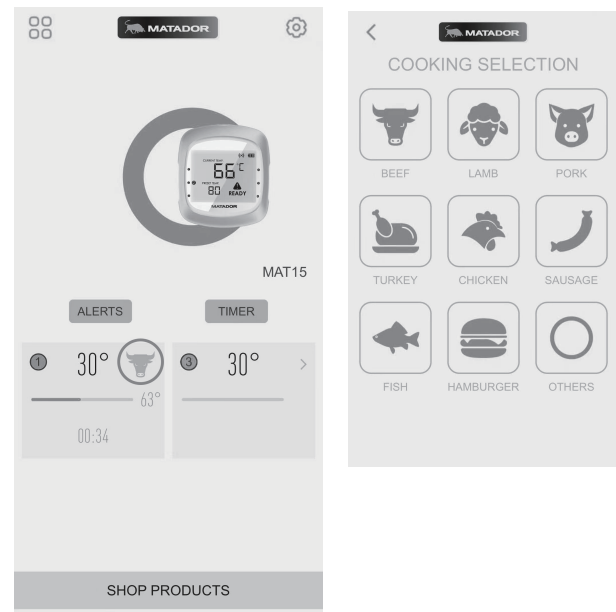

③ The menu selection screen will then display.

4

④ Tap on the desired icon to select the type of meat you would like to cook. The Set-up page will open so you can select your preferred doneness setting. Press 'START COOK' to commence cooking.

⑤ Repeat previous steps for all probes which will be used for the cook. Once completed your HOME screen will display a summary of all your settings.

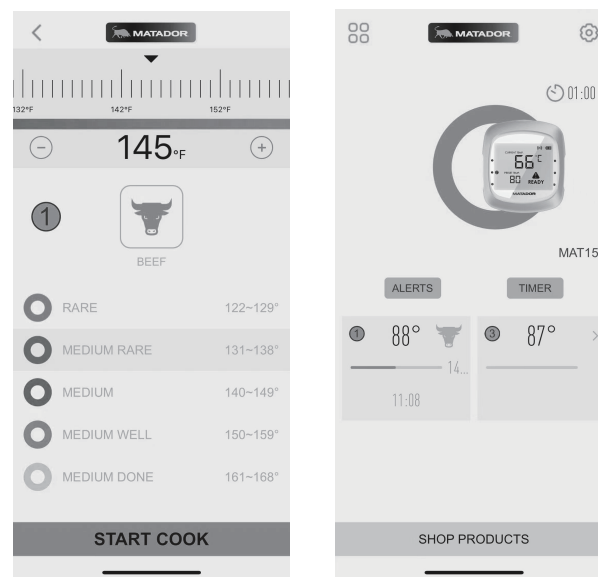

5

⑥ To monitor your cooking progress, tap on a desired probe to access more details.



6

### Reviewing Menu Options

① From your home page,

tap on the icon in the top left-hand corner to open the menu side bar and the menu screen will display.

② Select 'Settings' option to:

- Set temperature unit F/C°
- Set an alarm ring tone, vibration alert or alarm interval.
- Toggle push notifications

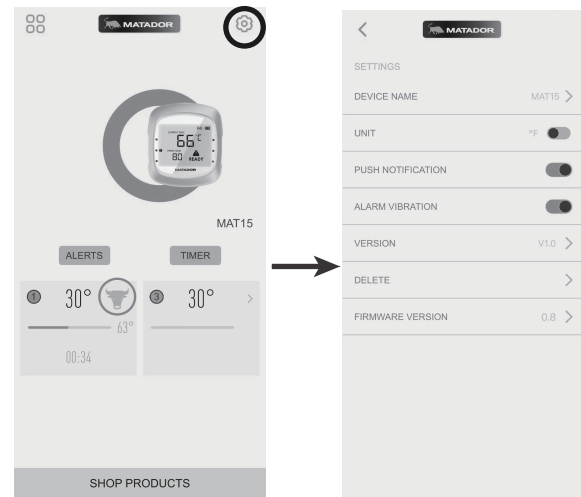

**Disclaimer:** This app undergoes regular maintenance and updates. As a result, its function and appearance may change without notice, potentially differing from the instructions provided. For technical support or inquiries, please refer to the support email listed at the front of this booklet.

7

### WARNING

The heat resistance varies in different components of the probe. **DO NOT** put the probes directly over flame or fire. **DO NOT** put the ABS Storage Wrap directly over flame or fire, or it will melt! This part is intended for probe storage only. Probes **ARE NOT** dishwasher safe.

**Sensor**  
Withstands heat up to 380°C/716°F

**Silicone handle**  
Withstands heat up to 250°C/482°F

**Teflon cable with stainless steel mesh**  
Withstands heat up to 380°C/716°F

**ABS Storage Wrap**  
80°C/176°F

Disclaimer: Products depicted within this manual are intended for reference purposes only. Actual product may vary in colour or appearance.



8

### Maintenance and Care Instructions

To maintain and prolong the life of your Matador Smart Wireless Thermometer please note the following care instructions:

- Designed for BBQ or oven use ONLY. Do not place the Thermometer or probes into a microwave.
- Probes feature a silicone colour-coded handle for easy identification. The probes will become hot during cooking. Always use barbecue gloves when handling probes to prevent accidental burns.
- DO NOT** place the main plastic thermometer body directly on a cooking surface, inside the hood of the barbecue or inside an oven as heat may cause it to melt or damage internal circuitry.
- DO NOT** expose the thermometer or any components to open flames.
- DO NOT** submerge the thermometer or any components in water.
- Not suitable for dishwashers.
- If the unit does not work check that the battery is fully charged.

### FCC Caution

This device complies with part 15 of the FCC Rules. Operation is subject to the following two conditions: (1) This device may not cause harmful interference, and (2) this device must accept any interference received, including interference that may cause undesired operation.

### 15.21 Information to User

Any changes or modifications not expressly approved by the party responsible for compliance could void the user's authority to operate the equipment.

### 15.105 Information to the User

**Note:** This equipment has been tested and found to comply with the limits for a Class B digital device, pursuant to part 15 of the FCC Rules. These limits are designed to provide reasonable protection against harmful interference in a residential installation. This equipment generates uses and can radiate radio frequency energy and, if not installed and used in accordance with the instructions, may cause harmful interference to radio communications. However, there is no guarantee that interference will not occur in a particular installation. If this equipment does cause harmful interference to radio or television reception, which can be determined by turning the equipment off and on, the user is encouraged to try to correct the interference by one or more of the following measures:

- Reorient or relocate the receiving antenna.
  - Increase the separation between the equipment and receiver.
  - Connect the equipment into an outlet on a circuit different from that to which the receiver is connected.
  - Consult the dealer or an experienced radio/TV technician for help.
- This equipment complies with FCC radiation exposure limits set forth for an uncontrolled environment. This equipment should be installed and operated with minimum distance 20cm between the radiator and your body.

9