

RYOBI®

VC30ARG / VC30HDARG / VC60HDARG

WET & DRY VACUUM CLEANER OWNER'S OPERATING MANUAL

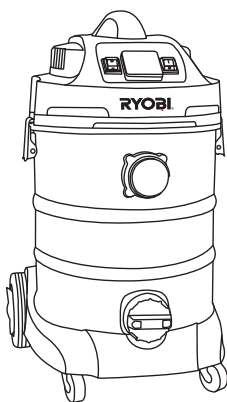

VC30HDARG

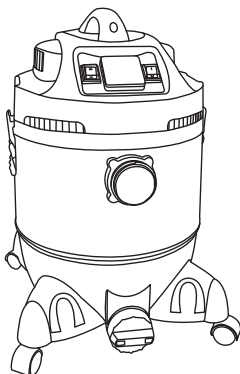

VC30ARG

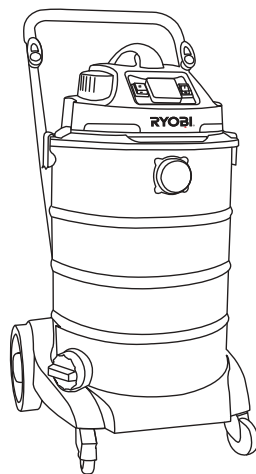

VC60HDARG

This appliance is equipped with a card having an earth or grounding wire for use with an earth or grounding plug. The plug must be inserted into an outlet that is properly earthed / grounded and installed



N197

DESCRIPTION

VC30ARG

- | | |
|-----------------------|-------------------------------------|
| 1. 2 Piece wand | 13. Dust bag |
| 2. Floor tool | 14. Cartridge filter cap |
| 3. Crevice tool | 15. Cartridge filter (non washable) |
| 4. Round brush | 16. Function switch |
| 5. Hose set | 17. Connection for the vacuum hose |
| 6. Wheels (x4) | 18. Outlet-socket |
| 7. Power tool adaptor | 19. ON/OFF switch |
| 8. Foam filter | 20. Clamps (x2) |
| 9. Screws | 21. Tank |
| 10. Blowing port | 22. Drain outlet |
| 11. Float switch | |
| 12. Filter basket | |

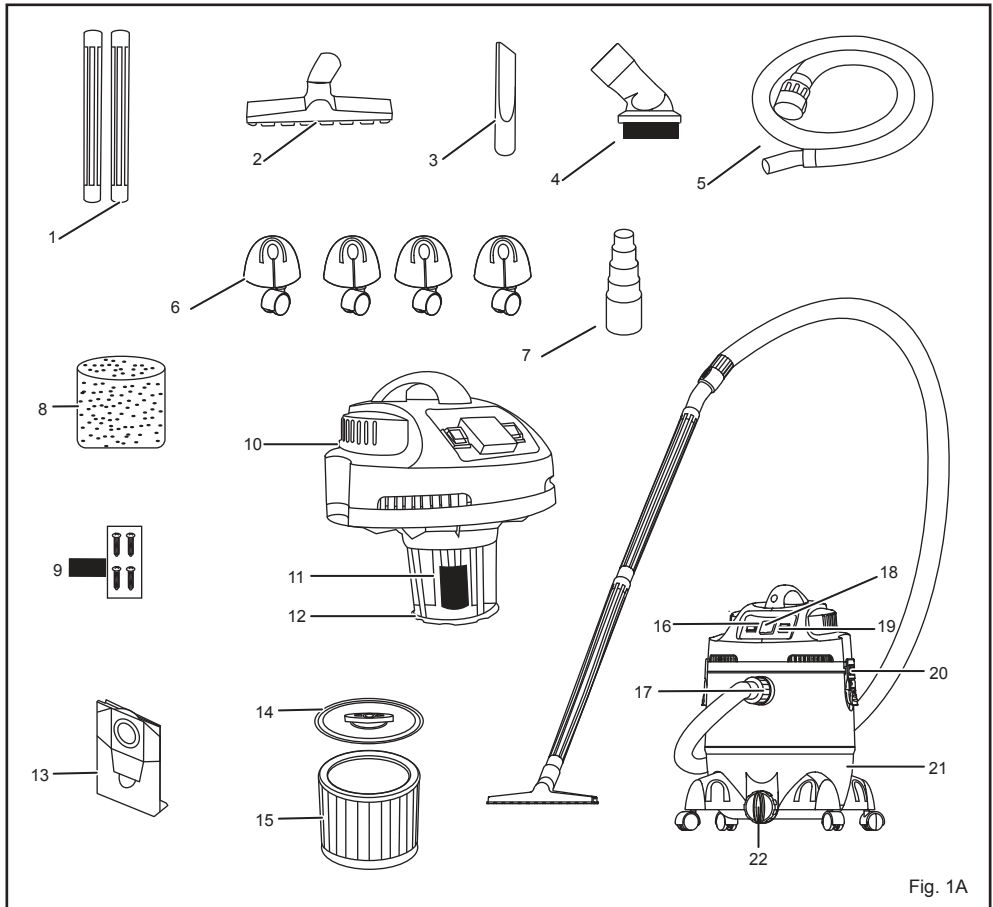

VC30HDARG

1. 2 Piece wand
2. Floor tool
3. Crevice tool
4. Round brush
5. Hose set
6. Cloth pre-filter
7. Wheels (x4)
8. Foam filter
9. Lock pins (x2)
10. Dust bag
11. Float switch
12. Filter basket
13. Cartridge filter cap
14. Washable cartridge filter
15. Function switch
16. Connection for the vacuum hose
17. Outlet-socket
18. ON/OFF switch
19. Clamps (x2)
20. Tank
21. Drain outlet
22. Washers (x2)
23. Axle
24. Hub cap
25. Power tool adaptor

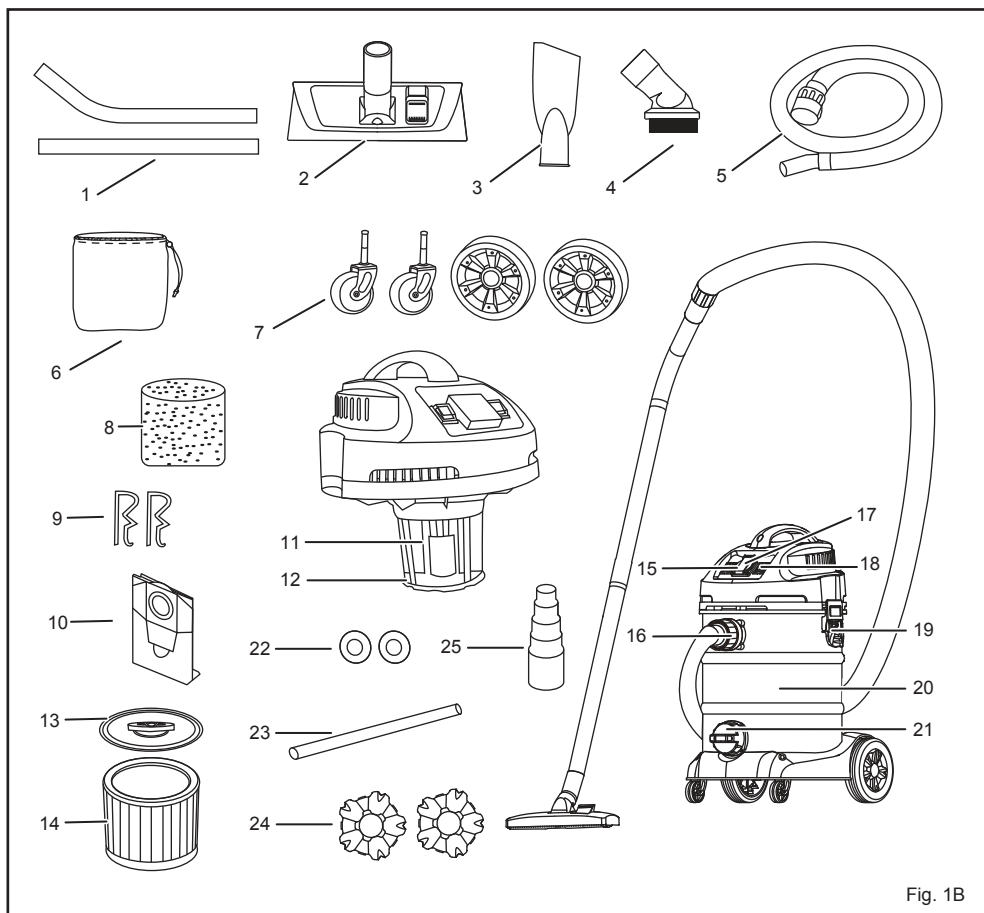

Fig. 1B

VC60HDARG

1. 2 Piece wand
2. Floor tool
3. Crevice tool
4. Round brush
5. Hose set
6. Cloth filter
7. Wheels (x4)
8. Power tool adaptor
9. Foam filter
10. Lock pins (x2)
11. Dust bag
12. Accessory bag
13. Float switch
14. Filter basket
15. Cartridge filter cap
16. Washable cartridge filter
17. Function switch
18. Connection for the vacuum hose
19. Drain outlet
20. Outlet-socket
21. ON/OFF switch
22. Clamps (x2)
23. Tank
24. Washers (x2)
25. Axle
26. Hub cap
27. Screws

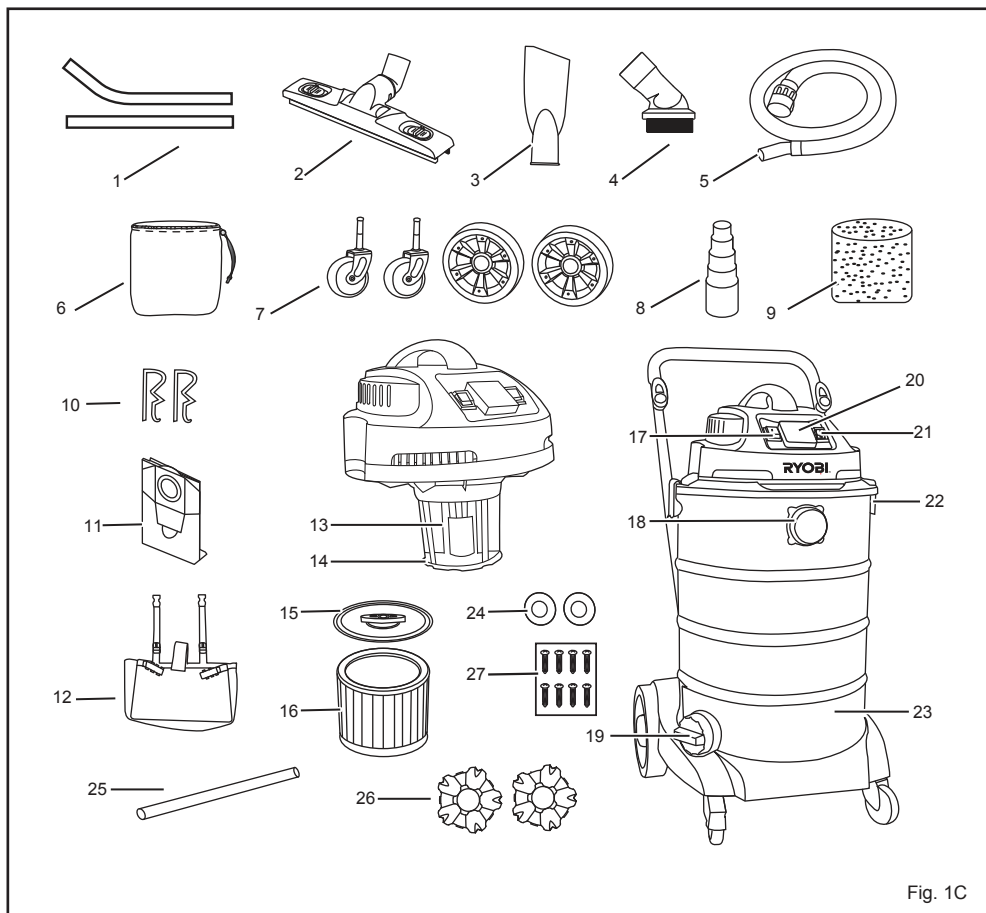
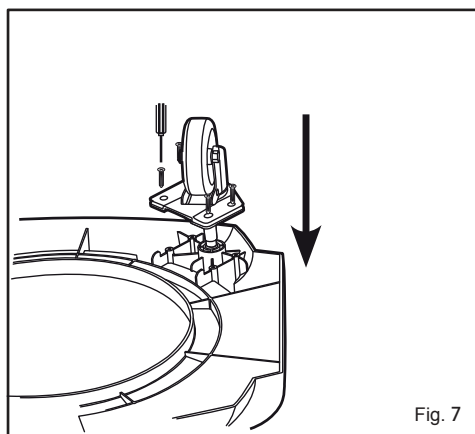
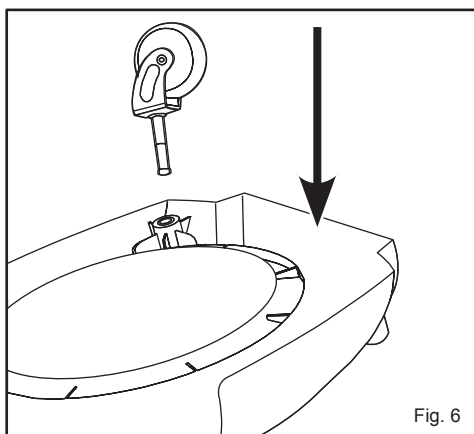
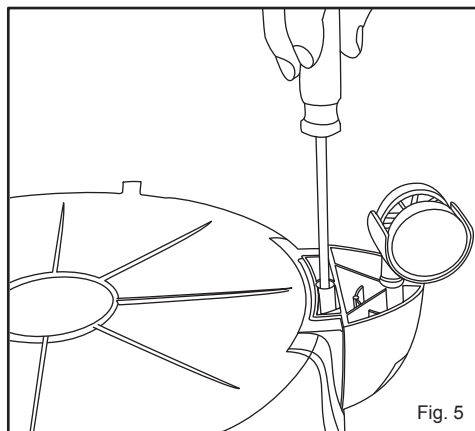
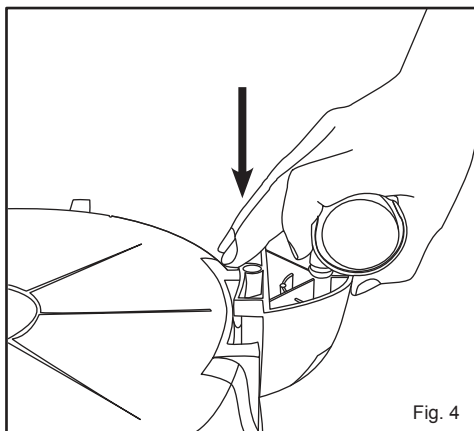
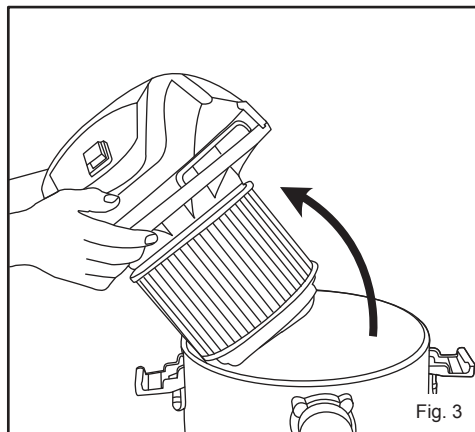
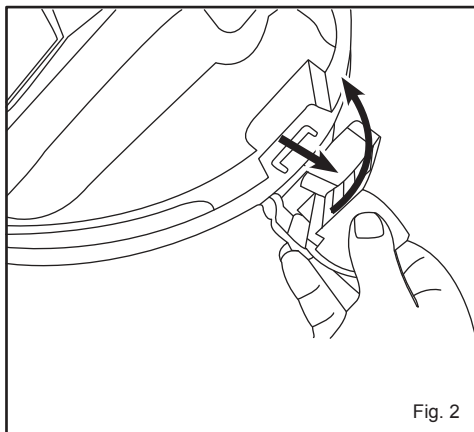
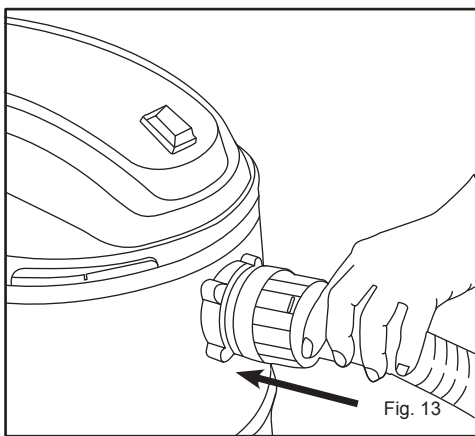
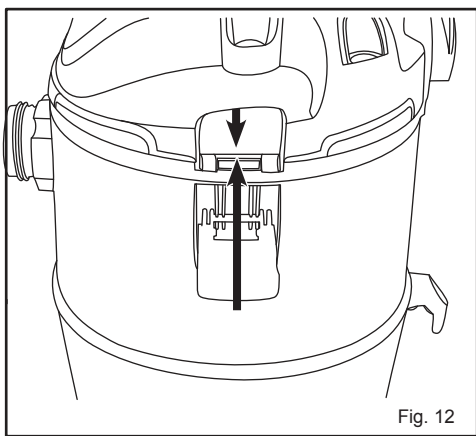
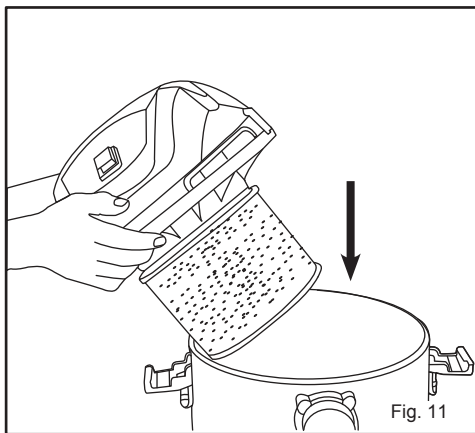
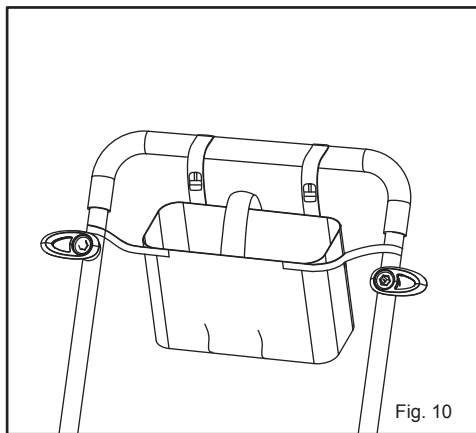
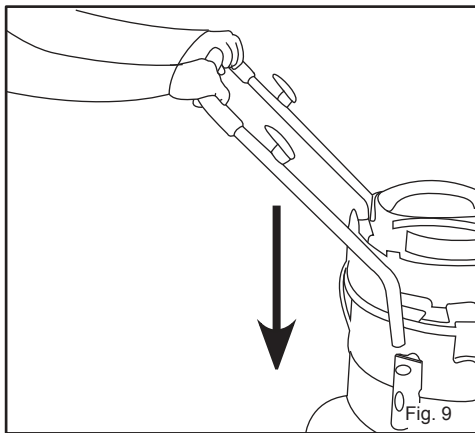
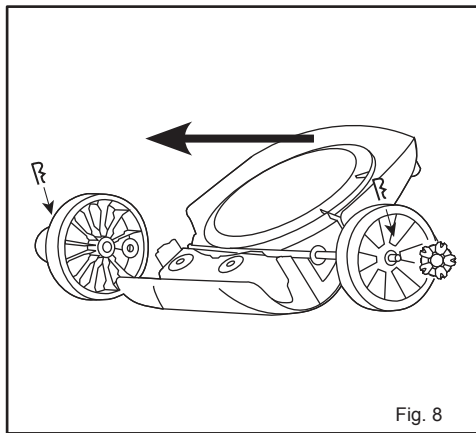

Fig. 1C





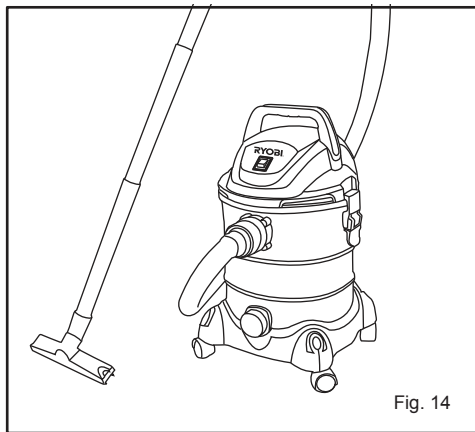

Fig. 14

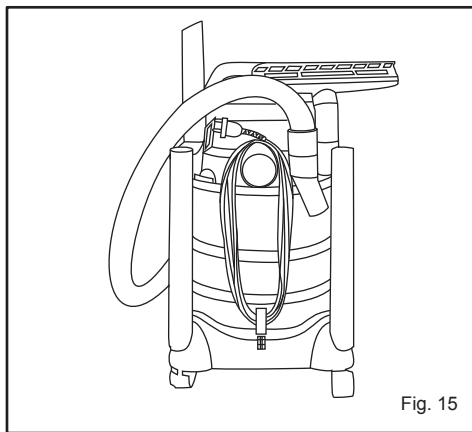

Fig. 15

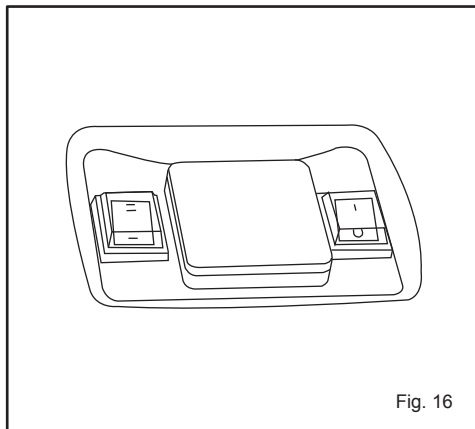

Fig. 16

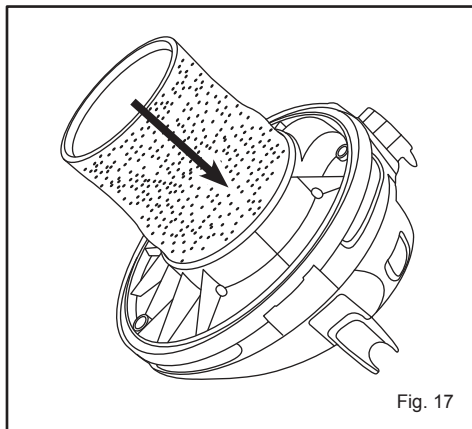

Fig. 17

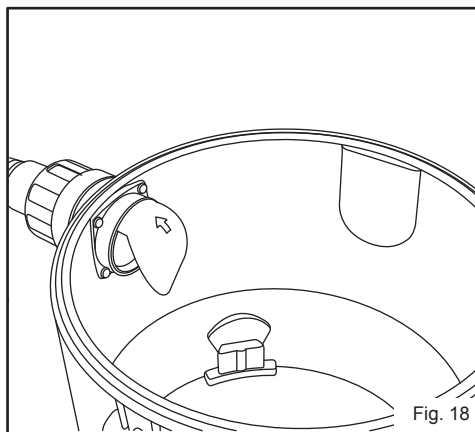

Fig. 18

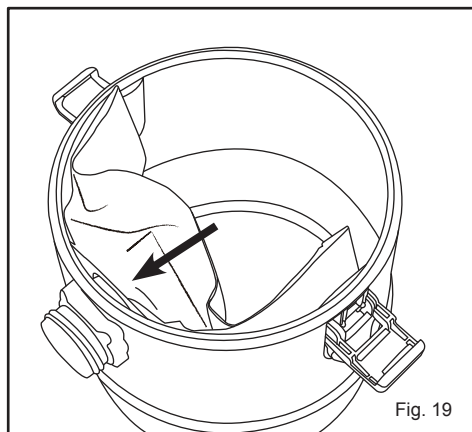
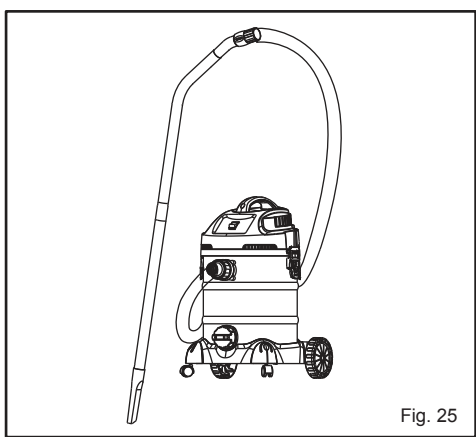
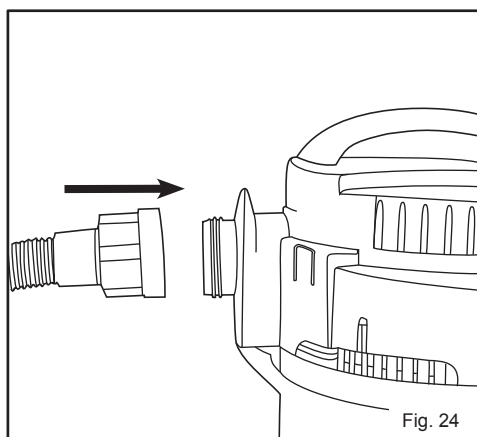
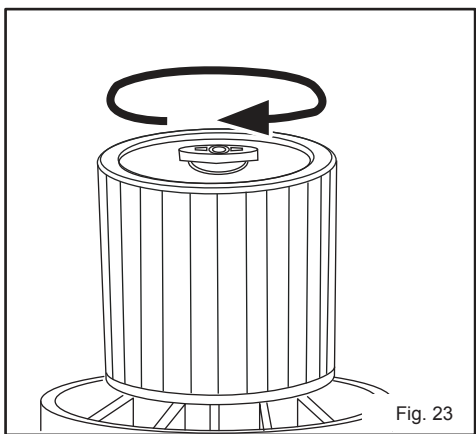
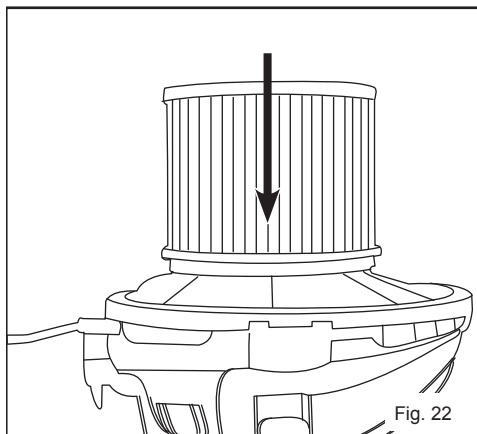
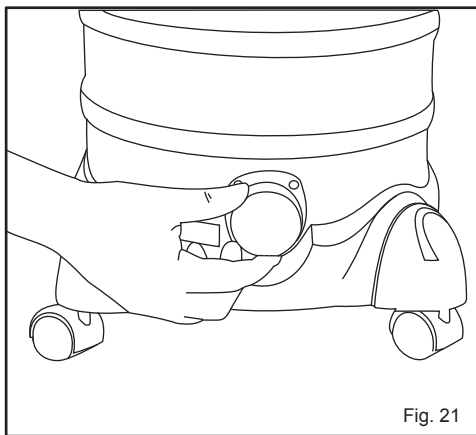
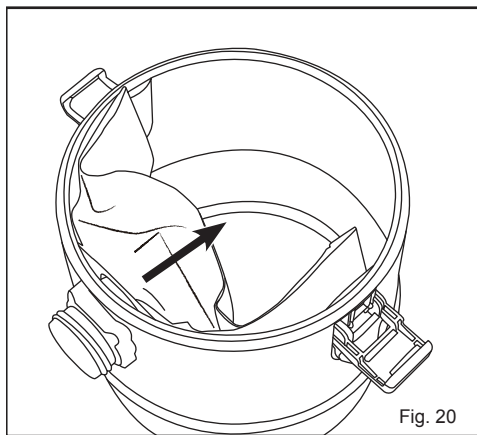
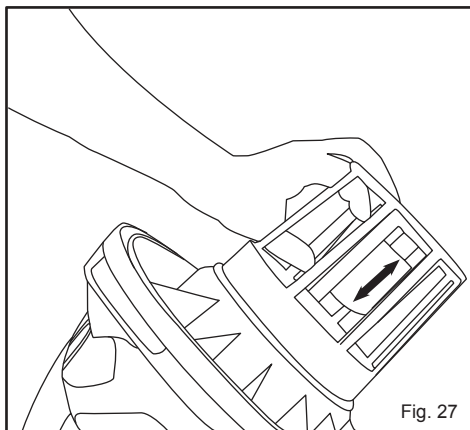
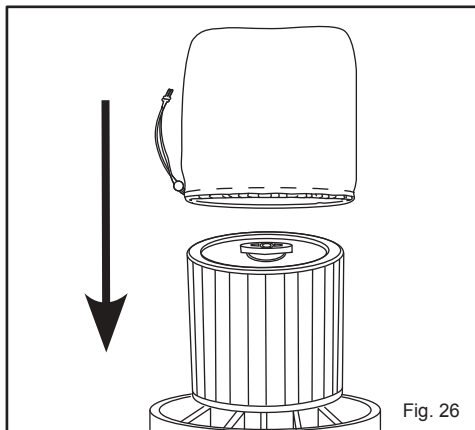

Fig. 19





Important!

It is essential that you read the instructions in this manual before operating this machine.

Subject to technical modifications.

GENERAL POWER TOOL SAFETY WARNINGS

WARNING

This appliance complies with the compulsory safety regulations for electric equipment. However, improper use can be harmful to people and property. Please read these operating instructions carefully and completely before switching the appliance on. Keep the operating instructions, the guarantee certificate, the receipt, as well as the packaging and packaging material if at all possible.

- This appliance is designed solely for use in the private sector and for the designated purpose. The appliance is not suitable for commercial use. Don't use the appliance outdoors (unless it has been specifically designed for use outdoors). Don't subject the appliance to heat, direct sunshine or very high moisture (e.g. rain).
- Never immerse the appliance in liquids and be aware of sharp edges that may damage it. Never use the appliance with wet or damp hands. Unplug it immediately if the appliance becomes wet or damp when it is running. Don't immerse the appliance in water.
- This wet/dry vacuum cleaner may only be used and kept in a private home.
- The appliance is designed to vacuum up materials that are not hazardous to your health and that are not flammable.
- Never hold the connectors in front of your face (especially your eyes, ears, etc.) Never direct the nozzle towards persons or animals.
- Only use the appliance for its designated purpose. Any other types of use are at your own risk and are possibly dangerous.
- Other uses and unattended operation are not allowed.
- The manufacturer cannot be made responsible for damages that are caused by improper use or incorrect operation.
- Wear protective clothing and gloves.
- Connect the appliance only to a 240V alternating current receptacle.
- Make sure that the correct dust bag has been inserted securely in its holder before using the appliance. The wrong dust bag or incorrectly installed dust bags can cause damage to the appliance and cause the guarantee to become void.
- If the power cord is damaged, it must be completely replaced along with the cable protector by an authorised service centre or other qualified service organisation.
- Do not vacuum up ashes, hot coals and the like, large fragments of glass and sharp objects.
- Don't vacuum up any toner dust, which is used in printers and copiers for example, because it is electrically conductive. In addition, it is possible that it will not be completely filtered out by the filter system of the wet/dry vacuum cleaner and can be released into the air via the exhaust fan.
- Never vacuum flammable or poisonous liquids like petrol, oil, acids, or other volatile substances.
- Don't vacuum up liquids that are hotter than 60° or any poisonous or flammable dusts.
- Never lay the appliance on its side. Pay particular attention to a horizontal position and adequate stability on stairs.
- Always unplug the appliance after use and before cleaning or changing the filters or accessories.
- Only trained specialists may make repairs on electric equipment. Improper repairs could result in considerable danger to the user.
- Do not store the appliance directly beside a hot oven or radiator.
- Children, disabled persons, and the aged are often not aware of the dangers that can result from handling electric appliances. The above mentioned persons and untrained persons must never work with this electrical appliance.
- When cleaning or removing the appliance, always switch it off. Pull the plug out of the receptacle, if you are not going to use the appliance for an extended period of time. Never pull on the cable to unplug the appliance, rather pull on the plug itself. Also, remove any special accessories from the appliance.
- Always keep the appliance clean. Don't use any solvents or cleaners that may damage or be harmful to the appliance or user.
- Never leave the appliance switched on unattended. If you leave the work area, switch the appliance off or unplug it from the receptacle (don't pull the cord, but use the plug).
- In order to protect children from electric household appliances, make sure that the cable can't cause children to stumble and don't give children access to the appliance.
- Never use the appliance when you are under the influence of medication, alcohol or drugs, if you are currently under medical care, or if you are tired.
- Check the appliance and the power cord regularly for any possible damage. Don't use damaged appliances.
- Don't try to repair the appliance yourself. Always use an authorised technician for repairs. Always have faulty power cords replaced immediately by the manufacturer or a qualified service organisation. Use the same type of cable in order to prevent any danger of electric shock and injury.
- Only use original spare parts and accessories. Non approved parts or third-party accessories may be a possible source of danger and cause the guarantee

to become void.

- Check the float often for free movement.
- If you notice liquid leaking from your appliance, switch it off immediately and unplug it.
- Do not submerge the appliance in water. Make sure that water is not spilled on the appliance.
- When disposing of the wastewater, make sure that you observe any legal regulations.
- Only store the appliance in a safe and dry location outside the reach of children.
- Please also pay particular attention to the following "Special Safety Rules".
- This appliance is not intended for use by persons (including children) with reduced physical, sensory or mental capabilities, or lack of experience and knowledge, unless they have been given supervision or instruction concerning use of the appliance by a person responsible for their safety.
- Children should be supervised to ensure that they do not play with the appliance.
- If the supply cord is damaged, it must be replaced by the manufacturer, its service agent or similarly qualified persons in order to avoid a hazard.

SPECIAL SAFETY RULES

- Never vacuum up hot ashes, pointed or sharp objects.
- Never use the appliance in damp rooms.
- Don't use the appliance without a dust bag (an exception is wet vacuuming or with the cartridge filter). Make sure that the dust bag is inserted into the appliance correctly.
- When using the appliance, make sure that no hair, clothing, or members are drawn in.
- Keep the vacuum cleaner away from heat sources such as radiant heaters, ovens, and so on.

DISPOSAL INFORMATION

- The appliance contains electric and electronic components and may not be disposed of as household garbage.
- The local and currently applicable legislation must be observed unconditionally.

SYMBOL



Safety Alert

V Volts

Hz Hertz

~ Alternating Current

W Watts

min⁻¹ Revolutions or reciprocations per minute



Conformity



Please read the instructions carefully before starting the product.



Waste electrical products should not be disposed of with household waste. Please recycle where facilities exist. Check with your Local Authority or retailer for recycling advice.



Recycle raw materials instead of disposing of as waste. The machine, accessories and packaging should be sorted for environmental-friendly recycling.

SPECIFICATIONS

VC30ARG

Supply voltage	240 V ~ 50Hz
Max. power	1400 W
Psum	2400 W
Tank volume	30 L Plastic
Hose system	35 mm Ø
Filter - dry	paper bag
Filter - wet	foam filter

VC30HDARG

Supply voltage	240 V ~ 50Hz
Max. power	1400 W
Psum	2400 W
Tank volume	30 L Inox
Hose system	38 mm Ø
Filter - dry	paper bag
Filter - wet	foam filter

VC60HDARG

Supply voltage	240 V ~ 50Hz
Max. power	1400 W
Psum	2400 W
Tank volume	60 L Inox
Hose system	38 mm Ø
Filter - dry	paper bag
Filter - wet	foam filter

PACKAGING CONTENT

See Figure 1-3.

- Carefully unpack the contents of the box.
- Hold the two clamps, which hold the upper section in its position and fold them upwards.
- Loosen the clamps, remove the upper section, and remove the contents from the tank.
- Please check the parts using the components list to make sure they are complete and that there has been no damage in transport.
- If any parts are missing or damaged, then please contact your dealer immediately

ASSEMBLY

- Make sure that the connector is not plugged in.
- Hold the two clamps, which hold the upper section in its position and fold them upwards. See figure 2.
- Loosen the clamps and lift the upper section up and out. See figure 3.
- Remove the contents from the tank and turn the tank over.

ROLLER ASSEMBLY

VC30ARG

- Put the four rollers in the guides on the bottom of the tank. See figure 4.
- Check that the rollers have been pushed completely into the guides.
- Fasten the rollers with four accompanying screws. See figure 5.

VC30HDARG, VC60HDARG

- Insert the two small rollers into front roller guides, ensuring they are pushed all the way in. See figure 6.
- Insert the rear axle into the rear support bracket. Slide washer and wheel on the shaft. Insert the lock pin into the hole on the end of the shaft to lock the wheel. Snap the hub cap onto the wheel. Repeat the same steps at the other end of the shaft. See figure 7.

REAR HANDLE ASSEMBLY: VC60HDARG

- Insert the rear handle into handle guides located in tank side. See figure 8.
- Hook the accessory bag onto rear handle. See figure 9.

FILTER ASSEMBLY

- Insert the foam filter that has been supplied for wet vacuuming. See the "WET VACUUM CLEANING" section.
- Insert the dust bag that has been supplied for dry vacuuming. See the "DRY VACUUM CLEANING"





section.

- Replace the upper section on the tank. See figure 10.
- Align the upper section with the clamps. See figure 11.
- Hook the clamps into the upper section and let them snap into place by pressing the clamps downwards.
- Place the large end of the hose on the front air intake stub on the tank. See figure 12.
- Select a nozzle or the wand and slide it over the vacuum hose. See figure 13.
- After using and cleaning the appliance, store the accessories by attaching them to the corresponding holders on the vacuum cleaner. See figure 14.

OPERATION

SWITCHING ON/OFF

See Figure 15.

- Connect the mains plug.
- Switch on the vacuum cleaner: Press  and .
- Switch on the electrical appliance and vacuum cleaner: Press  and .
- Maximum rating power limit to electrical socket outlet of the appliances: 1000W
- Switching on the electrical appliance automatically switches on the vacuum cleaner. Once the electrical appliance has been switched off, the vacuum cleaner switches off following a time lapse.
- Switch off the vacuum cleaner: Press .

DRY VACUUM CLEANING

WARNING

It is absolutely necessary for you to read, understand, and observe the section entitled "Safety Information and Warnings".

- Never vacuum up hazardous materials. If an incorrect dust bag is used, then the guarantee becomes void.
- Make sure that the appliance is not plugged into the power mains.
- Make sure that the foam filter is clean and dry and installed over the filter basket. See figure 16.
- Slide the dust bag over the hose connection in the tank. Press it until it snaps firmly into place. In the process, make sure that the dust bag is not damaged. See figures 17 - 18.
- Place the upper section on the tank once again and close the clamps. See figures 10 - 11.
- Place the large end of the hose on the front air intake stub on the tank. See figure 12.
- Select a nozzle or the wand and slide it over the

vacuum hose. See figure 13.

- Make sure that the ON/OFF switch on the appliance is in the "OFF" position (position "0") before you plug the power plug into the receptacle.
- Plug the power plug into the receptacle.
- Switch the motor on (ON/OFF switch in position "I").
- When you have finished vacuuming, switch the motor off by putting the ON/OFF switch into the "OFF" position (position "O").
- Unplug the power plug.
- Check the dust bag regularly and change it when it is 2/3 full. The bag is designed such that only air, and no dust, can pass through the paper. Therefore a used dust bag may not be reused again.

NOTE: Don't use the dust bag for vacuuming up objects with sharp edges or wet objects.

CARTRIDGE FILTER

- When using the cartridge filter, no dust bag is necessary.
- Place the cartridge filter on the filter basket from the top, turn on the cartridge filter cap. See figures 21 - 22.
- After extended use, it can be cleaned by tapping out or brushing out.

REINFORCE THE DUSTPROOF EFFECT

VC30HDARG, VC60HDARG

- Covering the cartridge filter with the orange cloth pre-filter bag will reinforce the dustproof effect. See figure 25. The cloth pre-filter bag can't be used singly.

WET VACUUM CLEANING

WARNING

It is absolutely necessary for you to read, understand, and observe the section entitled "Safety Information and Warnings".

NOTE: Never vacuum up hazardous materials.

- Make sure that the appliance is not plugged into the power mains.
- Check to make sure that the tank is free of dust and dirt.
- Remove the dust bag and only leave the foam filter over the filter basket. See figure 19.
- Place the upper section on the tank once again and close the clamps. See figures 10 - 11.
- Place the large end of the hose on the front air intake stub on the tank. See figure 12.
- Select a nozzle or the wand and slide it over the vacuum hose. See figure 13.
- Make sure that the ON/OFF switch on the appliance is in the "OFF" position (position "0") before you plug the

power plug into the receptacle.

- Plug the power plug into the receptacle.
- Switch the motor on (ON/OFF switch in position "I").
- When you have finished wet vacuuming, switch the motor off by putting the ON/OFF switch into the "OFF" position (position "O").
- Unplug the power plug.
- After use, empty and dry the tank.
- Tip: If you want to vacuum up a large quantity of liquid from a sink or a tank, please don't put the entire suction nozzle in the liquid; rather leave a little space so that some air can also be drawn in along with the liquid.
- The appliance is equipped with a float switch that will stop the vacuuming when the tank is full. You will notice that suction has stopped by the motor now running faster. In this event, switch the appliance off and unplug it.
- Be aware that the full tank can be very heavy. In this event, place the appliance over a drain and carefully open the outlet screw. See figure 20. The contents of the tank can now drain out to a great extent.
- Remove the upper section from the tank and pour the rest of the liquid into a suitable tank or drain. Then, you can continue vacuuming after you have replaced the upper section and drain outlet.
- After wet vacuuming, switch off the appliance and unplug it. Empty the container and clean/dry it inside and outside before putting it away.

WARNING

After wet vacuuming, please proceed as described in the section entitled "Dry Vacuuming" before you dry vacuum again.

BLOWING: VC30A

WARNING

Keep bystanders clear from blowing debris.

WARNING

Wear a dust mask if blowing creates dust that might be inhaled.

- Make sure the container is empty before using as a blower.
- Remove hose from the vacuum port.
- Screw on the large end of hose into the blowing port on the back side of the power head. See figure 23.
- Fit the desired extension wand and / or nozzle to the vacuum hose. See figure 24.
- Verify that the switch is in the 'O' OFF position before plugging the power cord into the outlet.

- Before turning on the motor, firmly hold loose end of the hose. Turn the motor on by flipping the switch to the "I"ON position.
- Make sure that the appliance is not plugged into the power mains.
- Remove the suction hose from the tank.
- Loosen the clamps and separate the upper section from the tank.
- Remove all the dirt and residue from the tank and the hose.
- Clean the foam filter by washing it with a mild detergent.
- Check the hoses and connections and check the power cord for any damage.
- When the foam filter is removed, check the float. To do this, take the upper section by the handle and tip it carefully so that the filter basket is facing upwards. The float should move freely up and down. See figure 26.

Techtronic Industries (Australia) Pty. Ltd.
31 Gilby Road,
Mt. Waverley, VIC 3149, Australia

Techtronic Industries New Zealand Ltd.
2 Landing Drive, Auckland Airport,
Mangere, New Zealand 2022