

WIRELESS SUN AND WIND SENSOR INSTRUCTIONS



Wind Sensitivity



Sun Sensitivity



Operates up to
20 blinds/awnings

Features

Adjustable Wind Sensitivity

Adjustable Sun Sensitivity

Operates up to 20 blinds/awnings

ALL WINDOWARE FOLDING ARM AWNINGS ARE SUPPLIED WITH THE LIMITS SET FROM FACTORY AND THE REMOTE PRE-PROGRAMMED. PLEASE FOLLOW THESE INSTRUCTIONS TO PAIR THE WIND SENSOR.

1. SUN AND WIND SENSOR BUTTONS

Sun/Wind Sensor Button Specifications

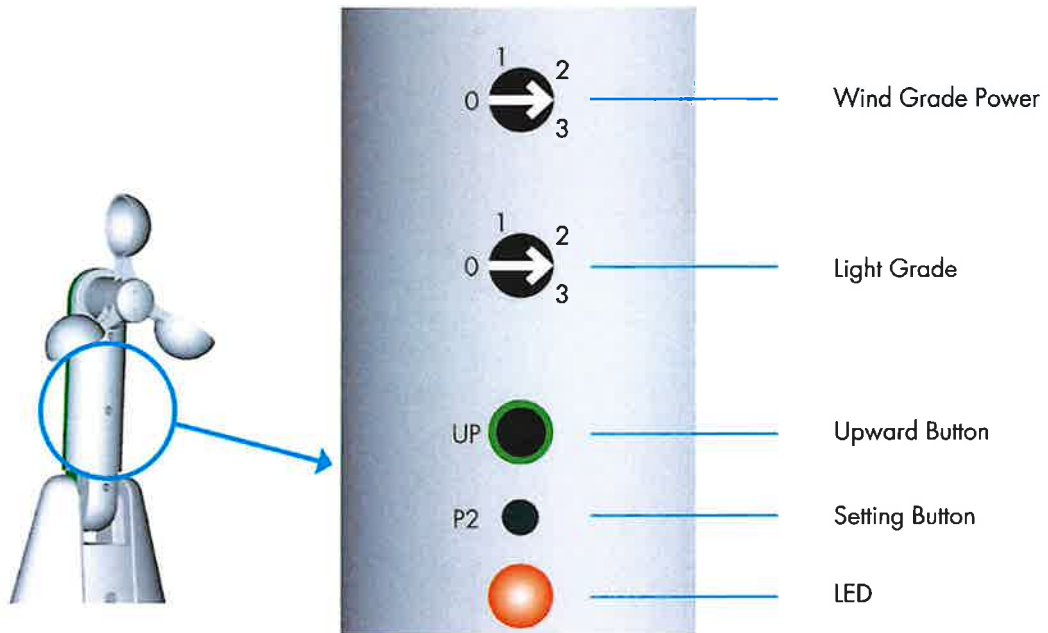

2. SUN AND WIND SENSOR INSTALLATION

Recommend Installation Areas

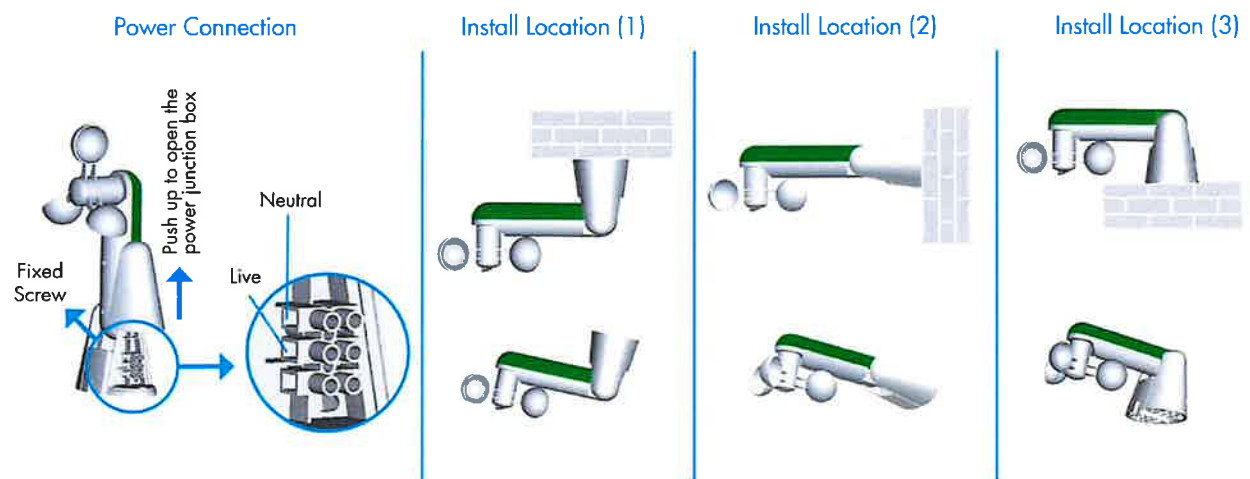

IMPORTANT

If you wish to change installation areas, ensure there is power access.

3. WIND SETTINGS

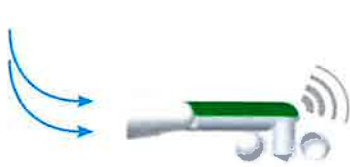

When breeze is blowing the awning remains open



When wind is blowing the awning starts to close up

When a gale is blowing the awning closes up to avoid damage



WIND GRADE REFERENCE	
0/1 Grade	15km/h
2 Grade	30km/h
3 Grade	45km/h

IMPORTANT

When the wind power is more than the setting value for 3 seconds, then sensor will automatically close the awning.

Wind Grade Reference

1. When the wind grade is "0/1" and the wind reaches over 15km/h, the awning will automatically retract.
2. When the wind grade is "2" and the wind reaches over 30km/h, the awning will automatically retract.
3. When the wind grade is "3" and the wind reaches over 45km/h, the awning will automatically retract.

WE STRONGLY RECOMMEND SETTING THE WIND SENSOR TO "2"

4. SUN SETTINGS



At sunrise (early morning) the awning is closed



During the hottest part of the day (mid morning to mid afternoon) the awning will open automatically



At dusk/sunset (mid afternoon to evening) the awning will close up automatically

LIGHT GRADE REFERENCE	
0 Grade	CLOSE
1 Grade	15km/h
2 Grade	30km/h
3 Grade	45km/h
4 Grade	60km/h



IMPORTANT

When the light level is more than the setting value for 2 minutes the sensor will automatically open the awning. When the light level doesn't reach the setting value for 15 minutes the sensor will automatically close the awning.

Sun Grade Reference

1. When the sensor is set to "0" the sun sensor is off
2. When the sensor is set to "1" the light reaches over 15 LUX, the awning will automatically open
3. When the sensor is set to "2" the light reaches over 30 LUX, the awning will automatically open
4. When the sensor is set to "3" the light reaches over 45 LUX, the awning will automatically open
5. When the sensor is set to "4" the light reaches over 60 LUX, the awning will automatically open

WE RECOMMEND SETTING THE SUN SETTING TO "0" UNLESS CUSTOMER REQUESTS OTHERWISE

5. PAIR THE SENSOR TO THE MOTOR & REMOTE

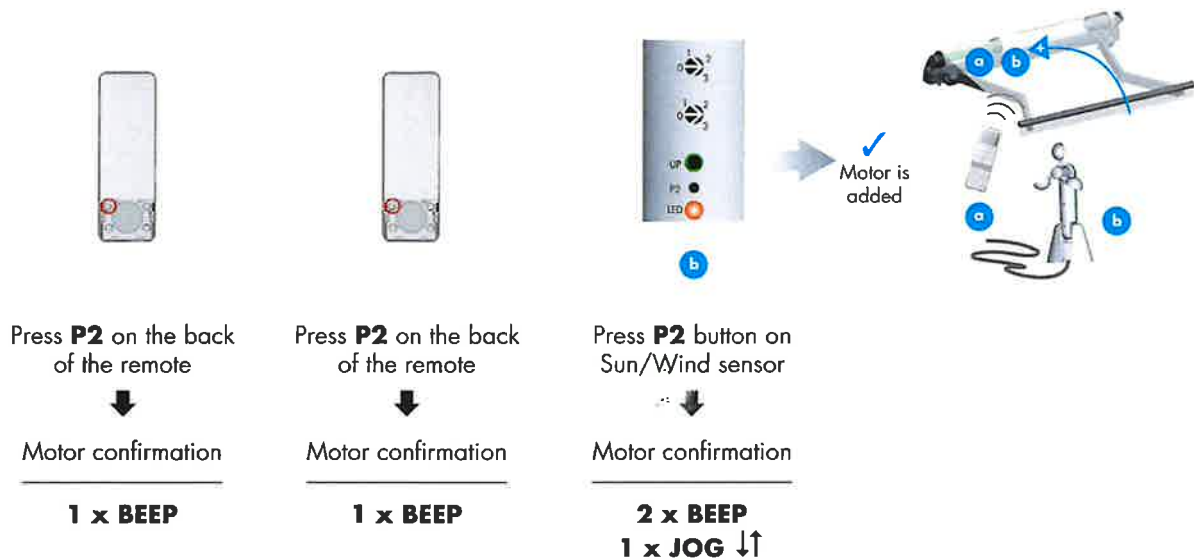

6. TEST THE SENSOR TO ENSURE CORRECT OPERATION

After completing the pairing process please follow the below steps to ensure it's proper operation.

1. Extend the awning slightly
2. Press the large **UP** button on the sensor
3. The awnings should close, this shows the sensor is correctly paired.

See the trouble shooting section if your awning does not react as above.

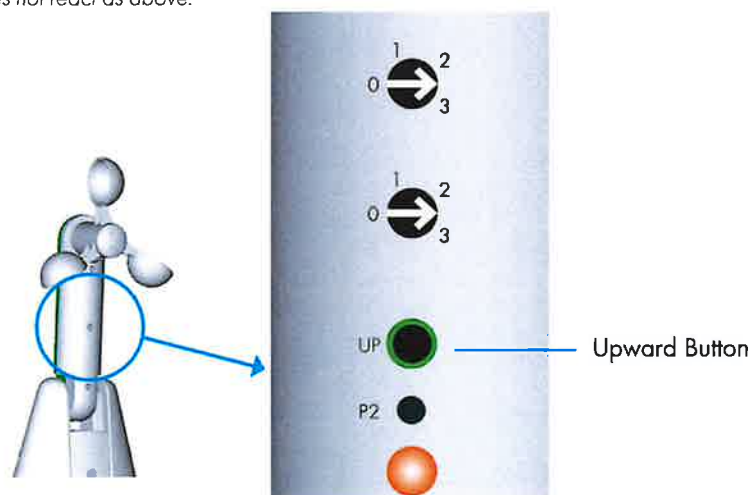

7. TROUBLE SHOOTING

PROBLEM	CAUSE	REMEDY
Motor extends when pressing "UP" test button	Motor direction is incorrect	Read the motor instructions and reverse motor direction.
Motor is not responding	Radio interference/shielding	Ensure transmitter is positioned away from metal objects and the motor aerial/receiver is kept straight and away from metal also.
	Sensor distance to far away from Sensor	Move the sensor closer to the motor.
	Power failure	Check the power supply to both the motor and the sensor.
	Incorrect wiring	Check if wiring is connected correctly
	Pairing error	Press the large "UP" button on the sensor to confirm pairing is correct.
Motor extends then constantly retracts unexpectedly	Wind set to low	Increase the threshold reduce sensitivity
	Light Setting	Light sensor set too low or high - adjust sensitivity according to requirements
	Extended awnings is covering or shading the sensor.	Check & reposition sensor if necessary
Motor does not react to wind or light setting	Wind sensitivity is too high or too low	Adjust sensitivity
	Time interval of strong wind is less than 3 minutes	The wind triggering time length must be over 3 minutes
	Time interval of light status change is less than 15 minutes	The light triggering time length must be over 15 minutes