

#### IMPORTANT INFORMATION

Unsuitable for gravity fed water systems.

Fitting of isolation stop taps to inlet connection is recommended.

Flush all pipework thoroughly before installation to remove foreign material, such as sand or dirt, which may block the flow regulator and reduce water flow.

#### INSTALLATION INSTRUCTIONS

1. Thread Base Plate Seal (2) over Flexible Pull Hose (12) and push firmly into the base of the mixer (1).
2. Attach Flexible Tails (13 & 14) to the Mixer (1), connecting the blue marked hose to the cold 'blue' inlet hole and red labelled hose to the hot 'H' inlet hole. Screw in and tighten both hoses firmly.
3. Screw Treaded Inlet Rod (6) into base of Mixer (1) and tighten firmly.
4. Position mixer over tap hole. Push through Flexible Tails (13 & 14) one at a time. When completed push Retractable Pull Hose (12) through tap hole.
5. From under bench, slide Rubber Horseshoe Seal (4) onto the Threaded Inlet Rod (6) followed by the Metal Horseshoe Plate (5). If fitting onto stainless steel sink, fit Support Plate (3) first.
6. From above, align mixer into final position. From under bench, screw Fixing Nut (7) onto Threaded Inlet Rod (6) and tighten until Mixer (1) is firm.
7. Screw Dual Non-Return Adaptor (9) firmly to the end of the Threaded Inlet Rod (6) ensuring the Sealing Washer (8) is in place.
8. Screw Retractable Pull Hose (12) onto Dual Non-Return Adaptor (9) ensuring Sealing Washer (10) is in place and tighten firmly.
9. Unscrew the two screws from Pull Hose Counterweight (11). From under bench with Retractable Pull Hose (12) in fully retracted position, tighten the two screws around Retractable Pull Hose (12). Check Retractable Pull Hose by pulling in and out to ensure smooth operation. Positioning the Counterweight correctly is critical to the performance of the Retractable Pull Hose. The Counterweight needs to be unobstructed and able to move up and down freely.
10. Connect mixer tails (13) & (14) to the corresponding hot and cold isolation stops until watertight seal is achieved.
11. Turn on water supply and check for leaks.

#### PRESSURE & TEMPERATURE REQUIREMENTS

- Inlet pressure for hot and cold water should be equal
- Inlet pressure range: 150-1500kPa
- Regulation: 500kPa is the maximum operating pressure allowed at any outlet within a building. (Ref. AS/NZS 3500. 1-2003, clause 3.3.4)
- Maximum hot water temperature: 80C

#### DECK REQUIREMENTS

- Deck thickness: 45mm maximum
- Tap body holes (in deck): 32-35mm

Disclaimer: Products in this specification manual must be installed by a licensed and registered trade person. The manufacturer/distributor reserves the right to vary specifications without prior notification. Dimensions and set-outs listed are correct at time of publication.

All diagrams for illustration purposes only.

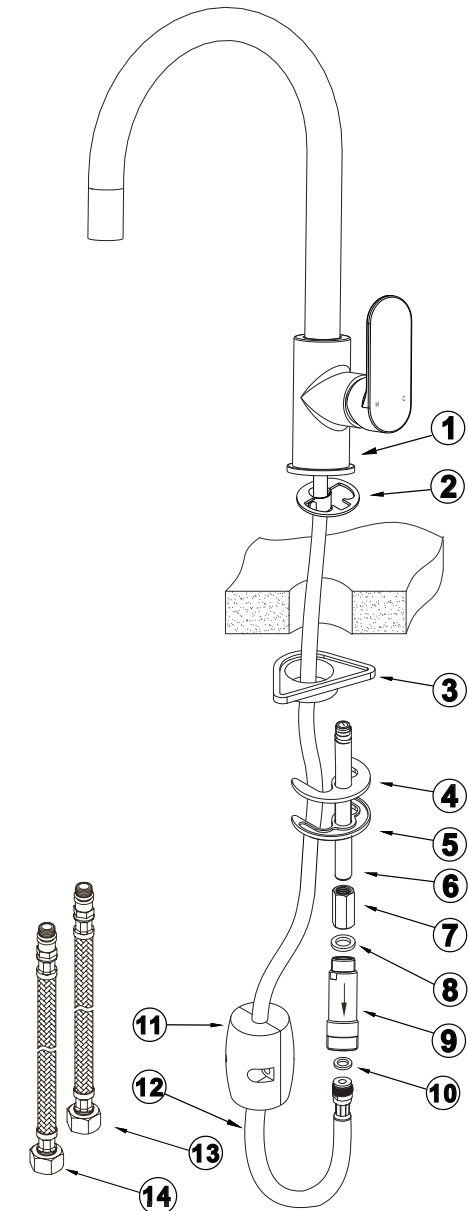

## CARING FOR YOUR PRODUCT

- Under no circumstances should you install tapware using acetone silicones.
- Never use harsh detergents or abrasive cleaners, as these will scratch the surface. Using a soft dry cloth or a soft cloth with warm soap water is recommended.
- Where your tapware remains dry in use, a soft cloth can be used to remove surface dust. Alternatively, a wipe over with warm soapy water is all that is required to maintain the finish in perfect condition for a lifetime of use.
- Use of wax based furniture cream should be avoided as these can result in a build up of deposits, which could detract from the appearance.
- Do not use undue pressure and wipe in one direction only.
- Flexible hoses may become damaged if exposed to caustic or corrosive substances/environments during installation or cleaning, such damage will not be covered by warranty. We recommend that flexible hoses are replaced every 5 years.

## IMPORTANT SCOPE OF USE

- Thoroughly inspect all parts for defects or damage prior installation. Warranty claims will be void if product is installed with pre-existing defects.
- This product has been designed to operate as an indoor mixer and has been manufactured and certified to the requirements of AS/NZS 3718 and AS/NZS 6400.
- This product should be installed by a licensed plumber in accordance with AS/NZS 3500 and any other local, state and national building codes and regulations. Check these regulations before attempting any DIY work.
- This product may not be suitable for gravity fed water systems, tank water systems or bore water systems.
- This product has a low flow rate and may not be suitable for connection to some of the following products: instantaneous gas water heaters, tempering valves, solar water heaters and thermostatic mixing valves. Check with the manufacturer of these products.
- This product has been designed for a 1/2" BSP inlet connection to both hot and cold water supply.
- The mixer may contain or be made from brass, stainless steel, plastic, ceramic, and rubber components.
- Operating specifications - High pressure: min 150kPa - max 500 kPa.
- Temperature: min 2°C - max 60°C (kitchen application), min 2°C - max 50°C (all other areas).