

Buildashed Specifications

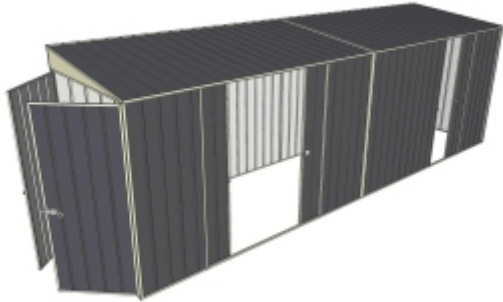

Color	Colorbond Equivalent*	Bunnings I/N
Grey	Monument	0378295
Green	Pale Eucalypt	3317653
Cream	Paperbark	3317654
Zinc	Galvanized Steel	3317655

Equivalent color names listed are Trademarks of Bluescope Steel Limited and are only used for comparison. The use of color names indicates no more than color equivalency.

Model	S15H260S22S17
Roof type	Skillion
Exterior dimension	1510mm x 5980mm
Interior dimension	1440mm x 5940mm
Height @ wall	1900mm
Height @ ridge	2100mm
Primary door type	Double Hinged
Primary door height	1845mm
Primary door opening	1430mm
Secondary door type	Double + Single Sliding
Secondary door height	1870mm
Secondary door opening	1440 + 720mm
Area	9.03sq mt
Slab size	1635mm x 6105mm x 100mm

Floor Plan

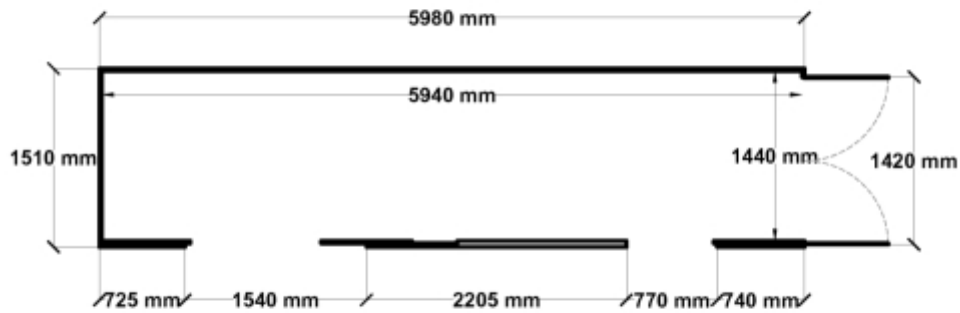

Features

- 1.9m wall height for more head room
- All holes pre-drilled for easy assembly
- Mid-wall frame for extra strength
- Your shed will arrive in 9 boxes, with no box greater than 25kg
- Easy to follow video enhanced instructions.

Anchor brackets and masonry bolts are supplied with this shed.

Heavy duty door channel protector ramps are supplied with this shed.

All measurements listed have a tolerance of +/- 10mm

