

# Mondella

## ROBE HOOK

### Installation Instructions

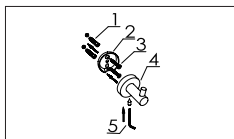

1. Item List - (1) Wall Plugs x 2,  
(2) Wall Bracket x 1, (3) Screws x 2,  
(4) Robe Hook x 1,  
(5) Allen Key x 1.

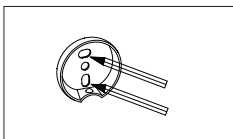

2. Place the Wall Bracket (2) in the desired position and mark the two hole positions for drilling.

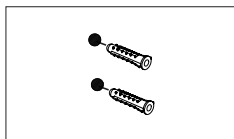

3. Using the appropriate drill bit (ie-masonry bit for tiles) drill holes to suit the Wall Plugs (1) provided. Insert Wall Plugs (1) into position.

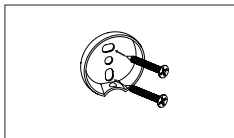

4. Place Wall Bracket (2) into correct position, ensuring the flat side sits against the wall. Install Screws (3).

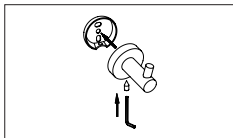

5. Position the Robe Hook (4) over the Wall Bracket (2) and tighten the grub screw on the underside of the body with the Allen Key (5) provided.