

ozito

MINI CHAIN SHARPENER

12V DC

INSTRUCTION MANUAL

SPECIFICATIONS

Voltage: 12V DC
Power: 50W
No Load Speed: 21,000/min
Collet Size: Ø3.2mm
Weight: 0.32kg

ozito.com.au

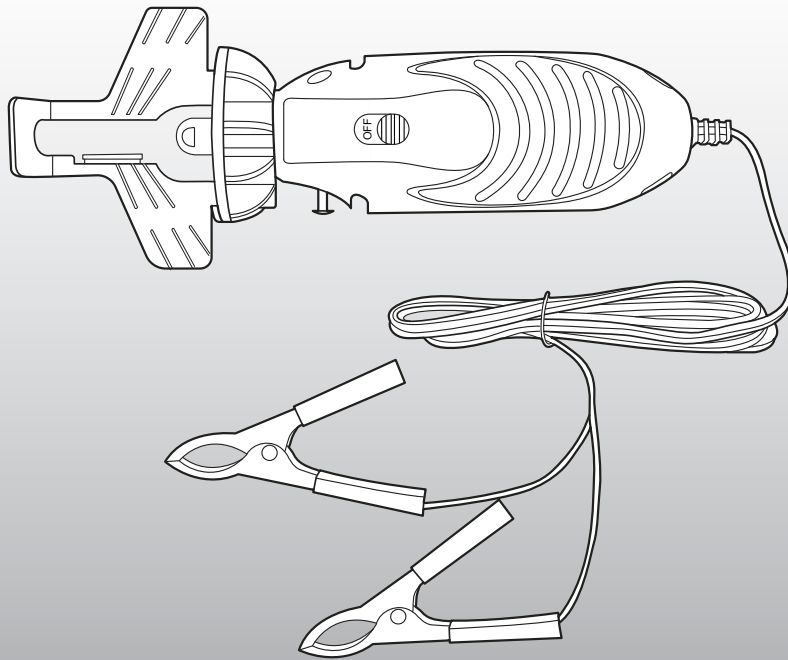

STANDARD EQUIPMENT

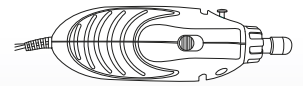

Mini Chain Sharpener



Chainsaw Sharpening Guide

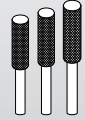

Diamond Bits x 3

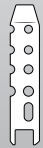

Wrench

3 YEAR REPLACEMENT WARRANTY

OMCS-012

WARRANTY

IN ORDER TO MAKE A CLAIM UNDER THIS WARRANTY YOU MUST RETURN THE PRODUCT TO YOUR NEAREST BUNNINGS WAREHOUSE WITH YOUR BUNNINGS REGISTER RECEIPT. PRIOR TO RETURNING YOUR PRODUCT FOR WARRANTY PLEASE TELEPHONE OUR CUSTOMER SERVICE HELPLINE:

Australia 1800 069 486
New Zealand 0508 069 486

TO ENSURE A SPEEDY RESPONSE PLEASE HAVE THE MODEL NUMBER AND DATE OF PURCHASE AVAILABLE. A CUSTOMER SERVICE REPRESENTATIVE WILL TAKE YOUR CALL AND ANSWER ANY QUESTIONS YOU MAY HAVE RELATING TO THE WARRANTY POLICY OR PROCEDURE.

The benefits provided under this warranty are in addition to other rights and remedies which are available to you at law.

Our goods come with guarantees that cannot be excluded at law. You are entitled to a replacement or refund for a major failure and for compensation for any other reasonably foreseeable loss or damage. You are also entitled to have the goods repaired or replaced if the goods fail to be of acceptable quality and the failure does not amount to a major failure.

Generally you will be responsible for all costs associated with a claim under this warranty, however, where you have suffered any additional direct loss as a result of a defective product you may be able to claim such expenses by contacting our customer service helpline above.

3 YEAR REPLACEMENT WARRANTY

Your product is guaranteed for a period of **36 months from the original date of purchase** and is intended for DIY (Do It Yourself) use only. If a product is defective it will be replaced in accordance with the terms of this warranty. Warranty excludes consumable parts, for example: included accessories.

WARNING

The following actions will result in the warranty being void.

- If the tool has been operated on a supply voltage other than that specified on the tool.
- If the tool shows signs of damage or defects caused by or resulting from abuse, accidents or alterations.
- Failure to perform maintenance as set out within the instruction manual.
- If the tool is disassembled or tampered with in any way.
- Professional, industrial or high frequency use.

KNOW YOUR PRODUCT

MINI CHAIN SHARPENER

- 1. Collet Nut
- 2. Shaft Collar
- 3. Spindle Lock Button
- 4. On/Off Switch
- 5. Positive RED (+) Clamp
- 6. Negative BLACK (-) Clamp

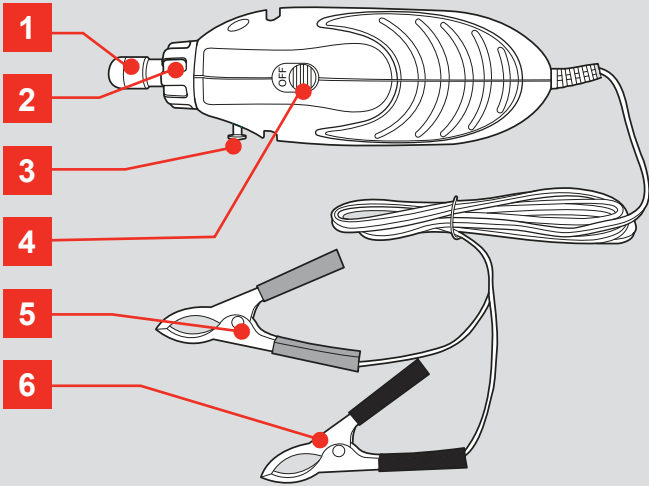

ACCESSORIES

- 7. Chainsaw Sharpening Guide
- 8. Diamond Sharpening Bits x 3
- 9. Wrench

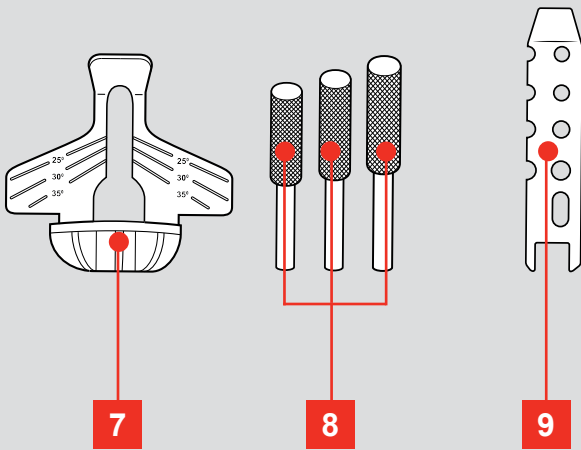

ONLINE MANUAL

Scan this QR Code with your mobile device to take you to the online manual.



SETUP & PREPARATION

1. CHANGING DIAMOND BITS



WARNING! ENSURE THE TOOL IS SWITCHED OFF AND DISCONNECTED FROM THE POWER SOURCE BEFORE PERFORMING ANY OF THE FOLLOWING OPERATIONS.

1. Select the diamond sharpening bit that is slightly smaller than the gullet on the leading edge.

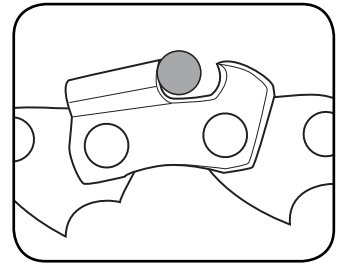

Always refer to the chainsaw owner's manual for correct sharpening specifications. The size and pitch of the chain is often printed on the chainsaw's bar.

Diamond Bits	Recommended for
Ø 4.0mm	1/4" pitch & 3/8" low profile
Ø 4.8mm	.325" pitch
Ø 5.5mm	3/8" pitch

You can identify the size of each diamond bit by sizing it with the wrench included.

2. Press and hold the spindle lock button.

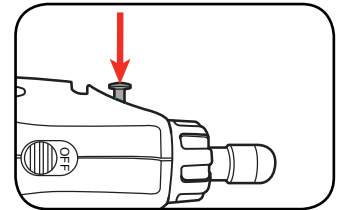

3. Using the supplied wrench, slightly loosen the collet nut.

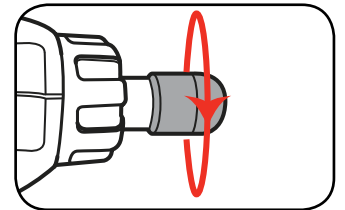

4. Insert shaft of diamond bit fully into the collet.

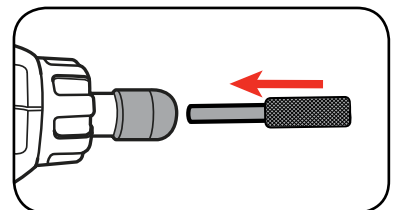

5. Press and hold the spindle lock button while tightening the collet nut using supplied wrench.

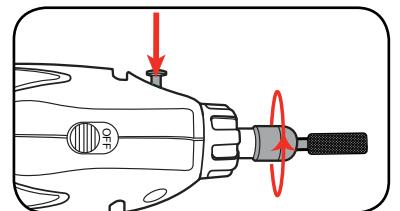

3 YEAR REPLACEMENT WARRANTY

2. SHARPENING GUIDE

Fitting Chainsaw Sharpening Guide

Before fitting the sharpening guide, you must attach the desired diamond bit and secure by tightening the collet nut.

1. Remove shaft collar by rotating anti-clockwise.

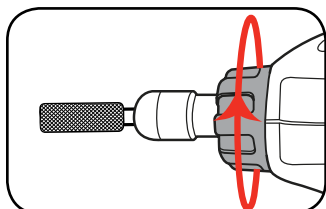

2. Fit the chainsaw sharpening guide by rotating it clockwise.

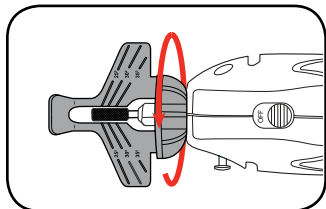
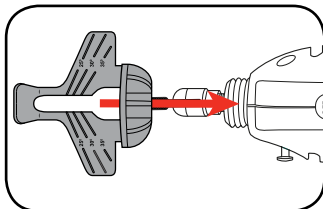

3. CONTROLS AND CLAMPS

On/Off Switch

1. To turn on, slide the on/off switch forward.

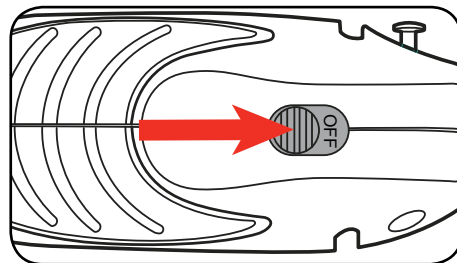

2. To turn off, slide the on/off switch backward.

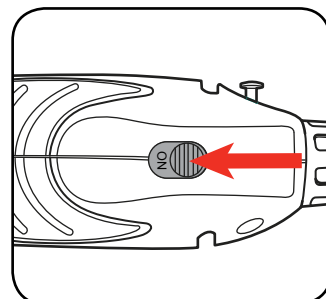

Alligator Clamps

Suitable for use with most 12V lead acid type car batteries.



WARNING! ONLY USE WITH INSULATED ALLIGATOR CLAMP. DO NOT USE IF INSULATION IS MISSING.

Only connect the positive (+, RED) alligator clamp to the positive battery terminal. Connect only the negative (-, BLACK) alligator clamp to the negative battery terminal.

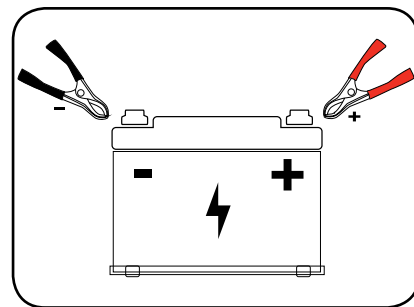

WARNING! ONLY USE WITH A 12V BATTERY.

OPERATION

4. ADJUSTING ATTACHMENT

Chainsaw Sharpening Guide

Before using the chainsaw sharpening guide, the adjustable height must be repositioned so the correct amount of stone diameter will be exposed. to correctly contact the sharpening edge.

1. Using the wrench, loosen the adjustable height screw on the chainsaw sharpening guide.

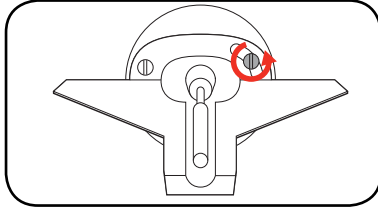

2. Align the mini chain sharpener accessory with the gap in the first chainsaw tooth. Adjust the angle of the sharpener to match the angle of the cutting edge on the tooth.

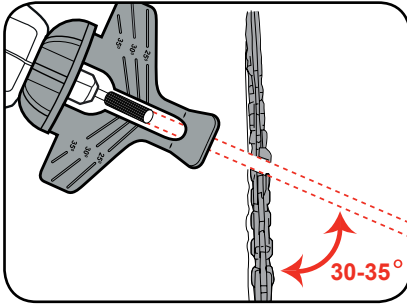

Note: The most common chain angles are between 30-35°.

3. Position sharpening bit as shown. Adjust the height of the guide so that the diamond bit is aligned to the top of the chain tooth.

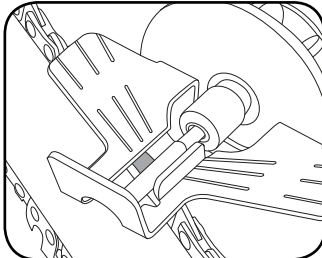
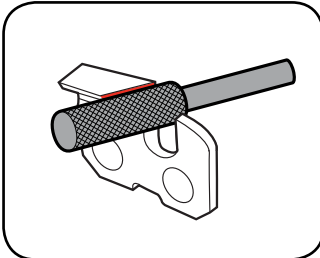
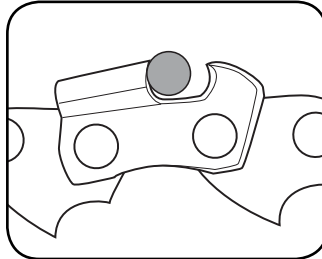

4. Tighten the adjustable height screw to secure in the correct position.

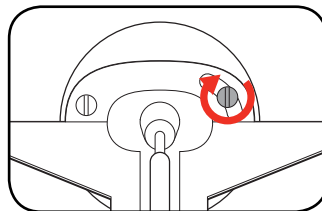

5. SHARPENING CHAINSAW CHAIN



WARNING! NEVER SHARPEN WITH THE CHAINSAW ENGINE RUNNING OR CONNECTED TO POWER SOURCE.

1. Ensure that the chainsaw sharpening guide and the correct sized sharpening bit is fitted securely.
2. Mark one of the chainsaw teeth with a marker to help identify the starting position.

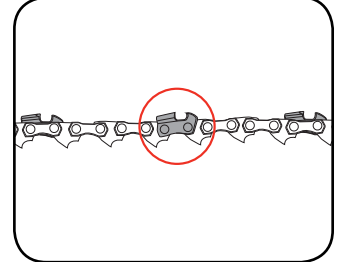
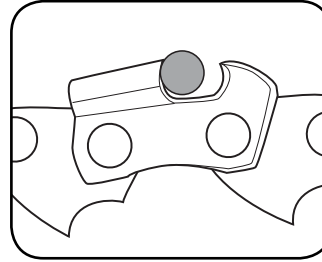

3. Align the mini chain sharpener accessory with the gap in the first chainsaw tooth.

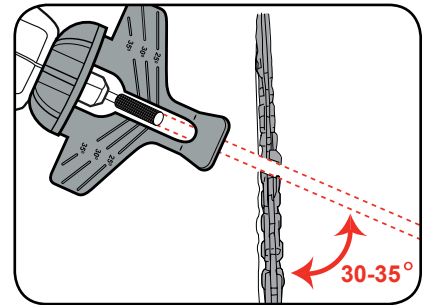

4. To begin operation hold the tool away from the surface of the chainsaw chain and then switch the tool on.

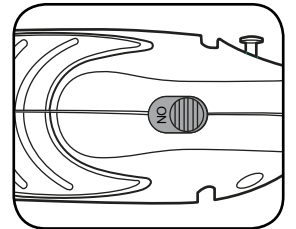

5. Slide the tool in and out against the cutting edge of the chain tooth.

Note: 1 or 2 light passes should be enough to sharpen the edge. Let the sharpener and bit do the work

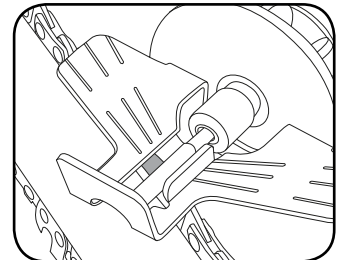
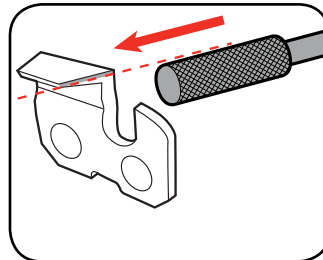

6. Rotate the chain and repeat steps 3-5 for all chainsaw teeth until you get back to the starting position.

Note: Make sure to complete the same number of passes on each tooth to remove a consistent amount of material when sharpening.

DESCRIPTION OF SYMBOLS

V	Volts	Hz	Hertz
~	Alternating current	W	Watts
/min	Revolutions or reciprocation per minute	n_0	No load speed
mm	Millimetres	∅	Diameter
Ah	Amp hour		Warning
	Regulator compliance mark		Wear eye and ear protection
	Read instruction manual		Wear gloves

SPARE PARTS

Spare parts can be ordered from the Special Orders Desk at your local Bunnings Warehouse.

For further information, or any parts not listed here, visit www.ozito.com.au or contact Ozito Customer Service:

Australia 1800 069 486

New Zealand 0508 069 486

E-mail: enquiries@ozito.com.au

CARING FOR THE ENVIRONMENT



Power tools that are no longer usable should not be disposed of with household waste but in an environmentally friendly way. Please recycle where facilities exist. Check with your local council authority for recycling advice.



Recycling packaging reduces the need for landfill and raw materials. Reuse of recycled material decreases pollution in the environment. Please recycle packaging where facilities exist. Check with your local council authority for recycling advice.

ACCESSORY GUIDE

TYPE		QTY / SIZES INCLUDED	APPLICATIONS
Diamond Sharpening Bits		Diamond Bits ∅4.0mm x 1 ∅4.8mm x 1 ∅5.5mm x 1	Suitable for sharpening chainsaw chains. Available in a variety of sizes to suit different chainsaw blades.
Wrench		x 1	Used to fasten accessories to the spindle.



GENERAL POWER TOOL SAFETY WARNINGS - PERSONAL SAFETY



WARNING! Read all safety warnings and all instructions. Failure to follow the warnings and instructions may result in electric shock, fire and/or serious injury.

Save all warnings and instructions for future reference. The term "power tool" in the warnings refers to your mains-operated (corded) power tool or battery-operated (cordless) power tool.

1. Work area safety

- a. **Keep work area clean and well lit.** Cluttered or dark areas invite accidents.
- b. **Do not operate power tools in explosive atmospheres, such as in the presence of flammable liquids, gases or dust.** Power tools create sparks which may ignite the dust or fumes.
- c. **Keep children and bystanders away while operating a power tool.** Distractions can cause you to lose control.

2. Electrical safety

- a. **Power tool plugs must match the outlet. Never modify the plug in any way. Do not use any adapter plugs with earthed (grounded) power tools.** Unmodified plugs and matching outlets will reduce risk of electric shock.
- b. **Avoid body contact with earthed or grounded surfaces, such as pipes, radiators, ranges and refrigerators.** There is an increased risk of electric shock if your body is earthed or grounded.
- c. **Do not expose power tools to rain or wet conditions.** Water entering a power tool will increase the risk of electric shock.
- d. **Do not abuse the cord. Never use the cord for carrying, pulling or unplugging the power tool. Keep cord away from heat, oil, sharp edges or moving parts.** Damaged or entangled cords increase the risk of electric shock.
- e. **When operating a power tool outdoors, use an extension cord suitable for outdoor use.** Use of a cord suitable for outdoor use reduces the risk of electric shock.
- f. **If operating a power tool in a damp location is unavoidable, use a residual current device (RCD) protected supply.** Use of an RCD reduces the risk of electric shock.

3. Personal safety

- a. **Stay alert, watch what you are doing and use common sense when operating a power tool. Do not use a power tool while you are tired or under the influence of drugs, alcohol or medication.** A moment of inattention while operating power tools may result in serious personal injury.
- b. **Use personal protective equipment. Always wear eye protection.** Protective equipment such as dust mask, non-skid safety shoes, hard hat, or hearing protection used for appropriate conditions will reduce personal injuries.

- c. **Prevent unintentional starting. Ensure the switch is in the off-position before connecting to power source and/or battery pack, picking up or carrying the tool.** Carrying power tools with your finger on the switch or energising power tools that have the switch on invites accidents.
 - d. **Remove any adjusting key or wrench before turning the power tool on.** A wrench or a key left attached to a rotating part of the power tool may result in personal injury.
 - e. **Do not overreach. Keep proper footing and balance at all times.** This enables better control of the power tool in unexpected situations.
 - f. **Dress properly. Do not wear loose clothing or jewellery. Keep your hair, clothing and gloves away from moving parts.** Loose clothes, jewellery or long hair can be caught in moving parts.
 - g. **If devices are provided for the connection of dust extraction and collection facilities, ensure these are connected and properly used.** Use of dust collection can reduce dust-related hazards.
- ## 4. Power tool use and care
- a. **Do not force the power tool. Use the correct power tool for your application.** The correct power tool will do the job better and safer at the rate for which it was designed.
 - b. **Do not use the power tool if the switch does not turn it on and off.** Any power tool that cannot be controlled with the switch is dangerous and must be repaired.
 - c. **Disconnect the plug from the power source and/or the battery pack from the power tool before making any adjustments, changing accessories, or storing power tools.** Such preventive safety measures reduce the risk of starting the power tool accidentally.
 - d. **Store idle power tools out of the reach of children and do not allow persons unfamiliar with the power tool or these instructions to operate the power tool.** Power tools are dangerous in the hands of untrained users.
 - e. **Maintain power tools. Check for misalignment or binding of moving parts, breakage of parts and any other condition that may affect the power tool's operation. If damaged, have the power tool repaired before use.** Many accidents are caused by poorly maintained power tools.
 - f. **Keep cutting tools sharp and clean.** Properly maintained cutting tools with sharp cutting edges are less likely to bind and are easier to control.
 - g. **Use the power tool, accessories and tool bits etc. in accordance with these instructions, taking into account the working conditions and the work to be performed.** Use of the power tool for operations different from those intended could result in a hazardous situation.
- ## 5. Service
- a. **Have your power tool serviced by a qualified repair person using only identical replacement parts.** This will ensure that the safety of the power tool is maintained.



PORTABLE CHAINSAW SHARPENER SAFETY WARNINGS

This appliance is not intended for use by young or infirm persons unless supervised by a responsible person to ensure that they can use the appliance safely. Young children should be supervised to ensure that they do not play with the appliance.



WARNING!

- a) **This power tool is intended to function as a chainsaw chain sharpener. Read all safety warnings, instructions, illustrations and specifications provided with this power tool.** Failure to follow all instructions listed below may result in electric shock, fire and/or serious injury.
- b) **Do not use accessories which are not specifically designed and recommended by the tool manufacturer.** Just because the accessory can be attached to your power tool, it does not assure safe operation.
- c) **The rated speed of the accessory must be at least equal to the maximum speed marked on the power tool.** Accessories running faster than their rated speed can break and fly apart.
- d) **The outside diameter and the thickness of your accessory must be within the capacity rating of your power tool.** Incorrectly sized accessories cannot be adequately guarded or controlled.
- f) **Do not use a damaged accessory. Before each use inspect the accessory for cracks, tear or excess wear. If power tool or accessory is dropped, inspect for damage or install an undamaged accessory. After inspecting and installing an accessory, position yourself and bystanders away from the plane of the rotating accessory and run the power tool at maximum no-load speed for one minute.** Damaged accessories will normally break apart during this test time.
- g) **Wear personal protective equipment. Depending on application, use face shield, safety goggles or safety glasses. As appropriate, wear dust mask, hearing protectors, gloves and workshop apron capable of stopping small abrasive or workpiece fragments.** The eye protection must be capable of stopping flying debris generated by various operations. The dust mask or respirator must be capable of filtering particles generated by your operation. Prolonged exposure to high intensity noise may cause hearing loss.
- h) **Keep bystanders a safe distance away from work area. Anyone entering the work area must wear personal protective equipment.** Fragments of workpiece or of a broken accessory may fly away and cause injury beyond immediate area of operation.
- i) **Never lay the power tool down until the accessory has come to a complete stop.** The spinning accessory may grab the surface and pull the power tool out of your control.
- j) **Do not run the power tool while carrying it at your side.** Accidental contact with the spinning accessory could snag your clothing, pulling the accessory into your body.
- k) **Regularly clean the power tool's air vents.** The motor's fan will draw the dust inside the housing and excessive accumulation of powdered metal may cause electrical hazards.
- l) **Do not operate the power tool near flammable materials, liquids, gasses or dust.** Sparks could ignite these materials.
- m) **Do not use accessories that require liquid coolants.** Using water or other liquid coolants may result in electrocution or shock.

Additional Safety Warnings

- Do not use if insulation is missing.
- Ensure tool is disconnected from power source when changing accessories.
- Do not leave tool running unattended.
- Do not use sharpening bit if damaged.
- Make sure switch is in the off position before attaching power supply.
- Only use standard 12V power supply.
- Never exceed manufacturer's recommended depth gauge setting for your chain.
- Double check collet nut before use.

Kickback and Related Warnings

Kickback is a sudden reaction to a pinched or snagged rotating wheel, backing pad, brush or any other accessory. Pinching or snagging causes rapid stalling of the rotating accessory which in turn causes the uncontrolled power tool to be forced in the direction opposite of the accessory's rotation at the point of the binding.

For example, if an abrasive wheel is snagged or pinched by the workpiece, the edge of the wheel that is entering into the pinch point can dig into the surface of the material causing the wheel to climb out or kick out. The wheel may either jump toward or away from the operator, depending on direction of the wheel's movement at the point of pinching. Abrasive wheels may also break under these conditions.

Kickback is the result of power tool misuse and/or incorrect operating procedures or conditions and can be avoided by taking proper precautions as given below.

- a) **Maintain a firm grip on the power tool and position your body and arm to allow you to resist kickback forces. Always use auxiliary handle, if provided, for maximum control over kickback or torque reaction during start-up.** The operator can control torque reactions or kickback forces, if proper precautions are taken.
- b) **Never place your hand near the rotating accessory.** Accessory may kickback over your hand.
- c) **Do not position your body in the area where power tool will move if kickback occurs.** Kickback will propel the tool in direction opposite to the wheel's movement at the point of snagging.
- d) **Use special care when working corners, sharp edges etc. Avoid bouncing and snagging the accessory.** Corners, sharp edges or bouncing have a tendency to snag the rotating accessory and cause loss of control or kickback.
- e) **Do not attach a saw chain woodcarving blade or toothed saw blade.** Such blades create frequent kickback and loss of control.

Additional Safety Warnings Specific for Diamond Sharpening Operation:

- a) **Do not "jam" the diamond sharpening bit or apply excessive pressure. Do not attempt to make an excessive depth of cut.** Over stressing the wheel increases the loading and susceptibility to twisting or binding of the wheel in the cut and the possibility of kickback or wheel breakage.
- c) **When sharpening bit is binding or when interrupting a cut for any reason, switch off the power tool and hold the power tool motionless until the bit comes to a complete stop. Never attempt to remove the sharpening bit from the cut while the wheel is in motion otherwise kickback may occur.** Investigate and take corrective action to eliminate the cause of sharpening bit binding.
- d) **Do not restart the cutting operation in the workpiece. Let the wheel reach full speed and carefully re-enter the cut.** The bit may bind, walk up or kickback if the power tool is restarted in the workpiece.