



CORE DRILL STAND

- ***SUITS FBDCD-22150***
- ***Ø60MM COLLAR***
- ***640MM CLEARANCE
LENGTH***
- ***460MM LENGTH OF
STROKE***



INSTRUCTION MANUAL



WARNING: Read all safety warnings and all instructions. Failure to follow the warnings and instructions may result in electric shock, fire and/or serious injury. Save all warnings and instructions for future reference.

SPECIFICATIONS - MODEL NO. FBDCDS-640

Height:	935mm
Length of stroke:	460mm
Clearance length:	640mm
Collar:	Ø60mm
Weight (tool only):	10.2 kg

KNOW YOUR PRODUCT

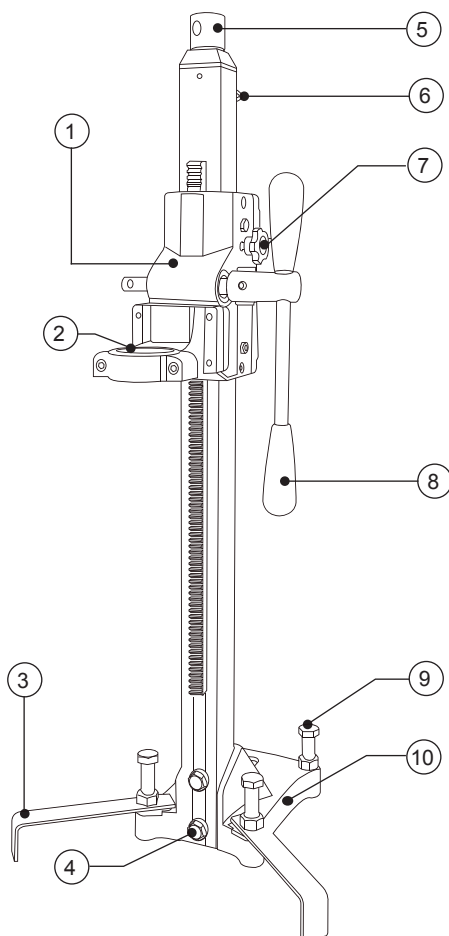

KNOW YOUR PRODUCT (cont.)

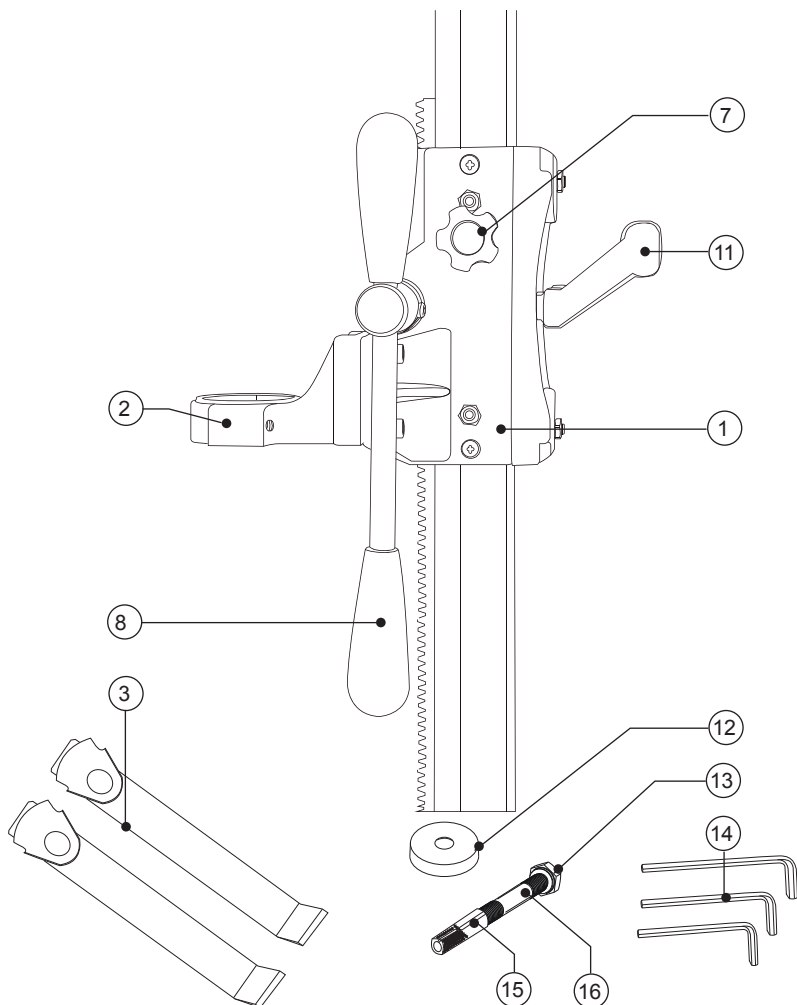

- | | | |
|-----------------------|-----------------------|--------------------------|
| 1. Carriage | 7. Carriage lock | 13. Clamping nut M12 |
| 2. Collar | 8. Feed handle | 14. Hex keys x 3 |
| 3. Balance prongs x 2 | 9. Levelling bolt x 4 | 15. Anchor sleeve M12x50 |
| 4. Column bolts x 2 | 10. Base | 16. Anchor bolt M12 |
| 5. Tie down | 11. Auxiliary handle | |
| 6. Eye bolt | 12. Large washer | |

TABLE OF CONTENTS

SPECIFICATIONS.....	Page 02
KNOW YOUR PRODUCT.....	Page 02
INTRODUCTION.....	Page 05
SAFETY INSTRUCTIONS.....	Page 05
ASSEMBLY.....	Page 06
SET-UP & PREPARATION.....	Page 07
OPERATION.....	Page 09
MAINTENANCE.....	Page 10
DESCRIPTION OF SYMBOLS.....	Page 10
CONTENTS.....	Page 11
WARRANTY.....	Page 12

INTRODUCTION

Congratulations on purchasing a Full Boar Core Drill Stand. Your Full Boar Core Drill Stand FBDCDS-640 is ideal for use with the FBDCD-22150 Core Drill to ensure straight holes are drilled in a safe manner by the user.

The anchor set will secure the stand to the work surface to allow efficient drilling in a controlled operation.

Read and understand the Owner's Manual before operating the Core Drill Stand. Failure to do so could result in personal injury or equipment damage.

SAFETY INSTRUCTIONS



WARNING! Read all safety warnings and all instructions with the core drill stand and the power tool to be mounted. Failure to follow the warnings and instructions may result in fire, electric shock, personal injury and material damage.

Read and understand the manual prior to operating this tool.

Save these instructions and other documents supplied with this tool for future reference.

The manufacturer cannot accept any liability for damage or accidents which arise due to a failure to follow these instructions and the safety information.

CORE DRILL STAND SAFETY WARNINGS

- **Properly assemble the core drill stand before mounting the power tool.** Proper assembly is important to prevent risk of collapse.
- **Securely fasten the power tool to the core drill stand before use.** Power tool shifting on the core drill stand can cause loss of control.
- **Place the core drill stand on a solid, flat and level surface.** When the core drill stand can shift or rock, the power tool or workpiece cannot be steadily and safely controlled.

ASSEMBLY



WARNING! Properly assemble the core drill stand before mounting the power tool. Proper assembly is important to prevent risk of collapse.

Fitting the feed handle

The feed handle (8) can be fitted on either side of the core drill stand.

1. Fit the feed handle onto the carriage (1) (fig. 1).

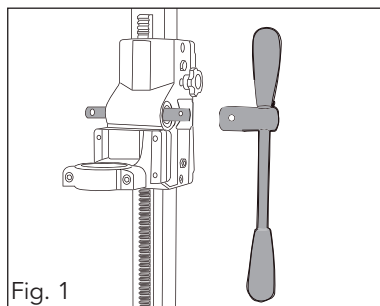

2. Securely tighten with supplied hex key (13) (fig. 2)

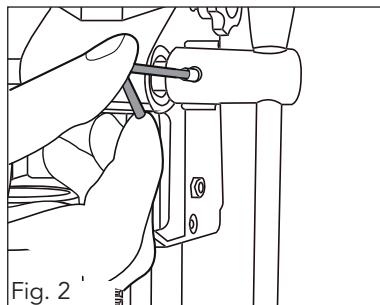

SET-UP & PREPARATION

Fastening the base (fig. 3)



WARNING! It is essential to secure the base (10) to the work surface to reduce the risk of injury and to protect the core drill from damage. An unsecured core drill and stand could rotate during drilling, cause the core bit to chatter against the work surface or bind in the hole, which can fracture the diamond segments

Place the core drill stand on a solid, flat and level surface before mounting the core drill. When the core drill stand can shift or rock, the power tool or workpiece cannot be steadily and safely controlled.

The supplied anchor sleeve (15) is usually suitable for fastening core drilling equipment to uncracked concrete. Under certain conditions it may be necessary to use an alternative fastening method.

1. To set the anchor sleeve (15), use an 16mm drill bit (not supplied) suitable for concrete to drill the pilot hole. Drill the pilot hole 50mm deep at a distance of 240mm from the centre of the hole to be drilled.
2. Clear out as much concrete dust as possible and fit the anchor sleeve (15) inside the pilot hole.
3. Screw the anchor bolt (16) into the anchor sleeve (15).
4. Place the slot in the base (10) over the anchor bolt (16) and align the core drill stand.
5. Always be sure to level the base (10) using the levelling bolts (9) at each corner of the base (10) so that the core drill bit contacts the work-piece squarely and cuts straight.
6. Place the large washer (12) and screw the clamping nut (13) onto the anchor bolt (16).
7. Use a suitable open-end spanner (not included) to tighten the clamping nut (13) firmly. Take care to ensure that the levelling bolts (9) make firm contact with the underlying surface.

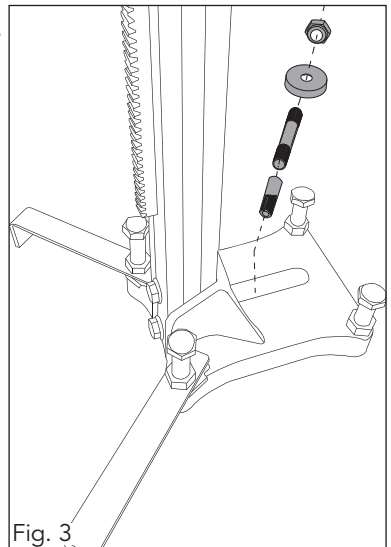

SET-UP & PREPARATION (cont.)

Mounting the core drill



WARNING! Please read these mounting instructions in conjunction with the instruction manual for the Core Drill.



WARNING! Ensure the power tool has been switched off and disconnected from the power supply and completely stopped before performing any of the following operations.



WARNING! Securely fasten the power tool to the core drill stand before use. Power tool shifting on the core drill stand can cause loss of control.

1. Remove the side handle on the core drill.
2. Tighten the carriage lock (7) to prevent the carriage (1) from moving when installing the core drill (fig. 4).
3. Using a hex key (13) remove part of the collar (2) (fig. 4).

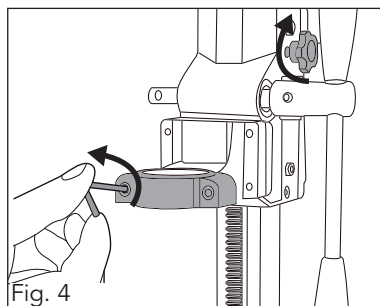

Fig. 4

4. Mount the core drill onto the drill stand, re-attach the removed part of the collar (2) around the core drill gear housing and tighten using the hex key (13) (fig. 5).

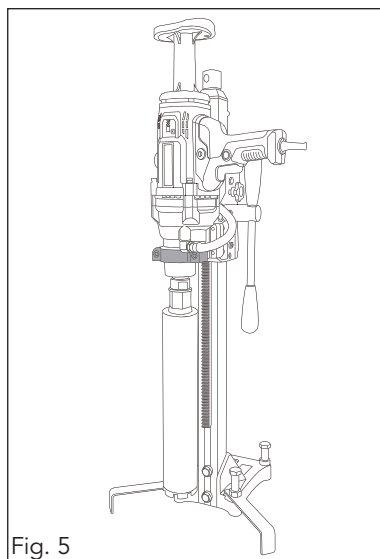

Fig. 5

OPERATION

1. Before drilling, do a test run without load to ensure the position is correct.
2. Loosen the carriage lock (7) and lower the core drill by turning the feed handle (8).
3. Rotate the feed handle (8) in the opposite direction to raise the core drill.
4. If the position is correct, then operate the core drill as per the core drill manual.

Removing the core drill



WARNING! Ensure the power tool has been switched off and disconnected from the power supply and completely stopped before performing any of the following operations.

1. Close the water supply tap and disconnect the water supply from the core drill.
2. Tighten the carriage lock (7) to prevent the carriage (1) from moving when removing the core drill.
3. Using a hex key (13) remove part of the collar (2) and remove the core drill.
4. Re-attach the removed part of the collar (2) for safe storage.

MAINTENANCE

- After each use remove any dirt or debris by wiping down with a damp cloth and allow to dry.
- Reapply grease on the gear rack as necessary.

Note: Ozito Industries will not be responsible for any damage or injuries caused by the repair of the core drill stand by an unauthorised person or by mishandling of the core drill stand.

Spare Parts

Limited spare parts are available subject to availability. Please contact your local Bunnings Special Orders Desk to order the required spare parts.

DESCRIPTION OF SYMBOLS

	Warning			Read Instruction Manual
---	---------	---	---	-------------------------

CARING FOR THE ENVIRONMENT



Power tools that are no longer usable should not be disposed of with household waste but in an environmentally friendly way. Please recycle where facilities exist. Check with your local council authority for recycling advice.



Recycling packaging reduces the need for landfill and raw materials. Reuse of recycled material decreases pollution in the environment. Please recycle packaging where facilities exist. Check with your local council authority for recycling advice.

CONTENTS

- 1 x Core drill stand
- 2 x Balance prongs
- 1 x Large washer
- 1 x Clamping nut M12
- 1 x Anchor sleeve M12 x 50mm
- 1 x Anchor bolt M12
- 3 x Hex keys
- 1 Instruction manual

Note: The manufacturer's liability shall be deemed void if the tool is modified in any way and the manufacturer shall therefore accept no liability for any damages arising as a result of modifications.

Distributed by:
Ozito Industries Pty Ltd

AUSTRALIA (Head Office)

1-23 Letcon Drive, Bangholme Victoria, Australia, 3175
Telephone: 1800 069 486

WARRANTY

YOUR WARRANTY FORM SHOULD BE RETAINED BY YOU AT ALL TIMES. IN ORDER TO MAKE A CLAIM UNDER THIS WARRANTY YOU MUST RETURN THE PRODUCT TO YOUR NEAREST BUNNINGS WAREHOUSE (see www.bunnings.com.au or www.bunnings.co.nz for store locations) WITH YOUR BUNNINGS REGISTER RECEIPT. PRIOR TO RETURNING YOUR PRODUCT FOR WARRANTY PLEASE TELEPHONE OUR CUSTOMER SERVICE HELPLINE:

**Australia 1800 069 486
New Zealand 0508 069 486**

TO ENSURE A SPEEDY RESPONSE PLEASE HAVE THE MODEL NUMBER AND DATE OF PURCHASE AVAILABLE. A CUSTOMER SERVICE REPRESENTATIVE WILL TAKE YOUR CALL AND ANSWER ANY QUESTIONS YOU MAY HAVE RELATING TO THE WARRANTY POLICY OR PROCEDURE.

1 YEAR WARRANTY

Your product is guaranteed for a period of **12 months from the original date of purchase**. If a product is defective it will be repaired in accordance with the terms of this warranty. Warranty excludes consumable parts, for example: wheels, bearings.

The benefits provided under this warranty are in addition to other rights and remedies which are available to you under law. The warranty covers manufacturer defects in materials, workmanship and finish under normal use.

Our goods come with guarantees that cannot be excluded under Australian Consumer law & Consumer Guarantees Act 1993 (NZ). You are entitled to a replacement or refund for a major failure and to compensation for other reasonably foreseeable loss or damage. You are also entitled to have the goods repaired and replaced if the goods fail to be of acceptable quality and the failure does not amount to a major failure.

WARRANTY EXCLUSIONS

The following actions will result in the warranty being void.

- If the tool has been operated on a supply voltage other than that specified on the tool.
- If the tool shows signs of damage or defects caused by or resulting from abuse, accidents or alterations.
- Failure to perform maintenance as set out within the instruction manual.
- If the tool is disassembled or tampered with in any way.
- The warranty excludes damage resulting from product misuse or product neglect.

This warranty is given by Ozito Industries Pty Ltd.

ABN: 17 050 731 756

Ph.1800 069 486

Australia/New Zealand (Head Office)
1-23 Letcon Drive, Bangholme, Victoria, Australia 3175