

For use with Chamberlain multi-frequency Garage Door Openers. The code between the remote control and the receiver changes with each use, randomly accessing over a billion new codes. Refer to your product manual for the location of the learn button.

NOTE: Your product may look than the products illustrated in this manual.

Single Button Remote Control
Model E940C



2-Button Remote Control
Model E950C

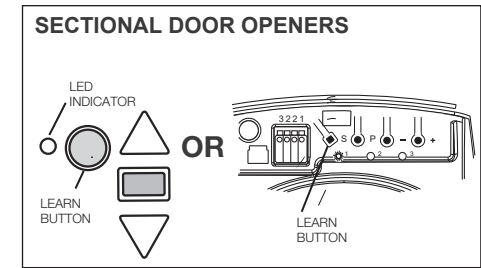
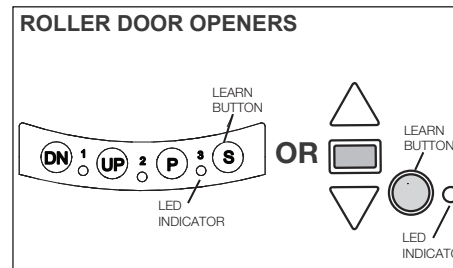

⚠ WARNING

To prevent possible **SERIOUS INJURY** or **DEATH** from a moving garage door.

- ALWAYS keep remote controls out of reach of children. NEVER permit children to operate or play with remote controls.
- Activate the garage door ONLY when it can be seen clearly, is properly adjusted, and there are no obstructions to affect door travel.
- ALWAYS keep the garage door in sight until it is completely closed. NEVER permit anyone to cross the path of a moving garage door.

PROGRAMMING THE REMOTE USING THE GARAGE DOOR OPENER

- 1 Locate the learn button.
- 2 Press and hold the button on the remote control or wireless wall control you wish to use. The LED indicator on the transmitter will flash continuously.
- 3 Press and immediately release the Learn button.
- 4 The opener light will flash or 2 clicks will be sounded when it has learnt the code.

ERASING ALL CODES FROM MEMORY

When deactivating any unwanted remote control code, all previous codes will be erased.

- 1 Press and hold the Learn button on the garage door opener until the learn LED goes out (approximately 6 seconds). All previous codes are now erased. Reprogram each remote control you wish to use.

THE REMOTE CONTROL BATTERY

Lithium batteries should operate for up to 5 years. If the battery is low, the LED on the remote control will not flash when the button is pressed. To replace the battery:

- 1** Pry open the case first in the middle (1), then at each side (2 and 3) with the visor clip.

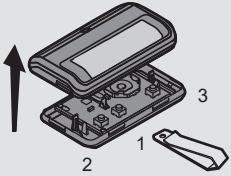

- 2** Remove the old battery. Dispose of old batteries properly.

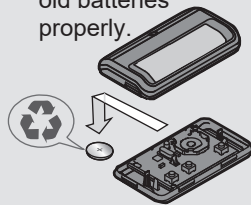

- 3** Insert replacement batteries positive side up. Replace the batteries with only CR2032 batteries.

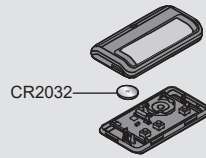

- 4** Replace the cover.

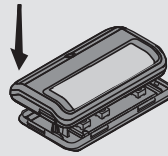

- 1** Use a screwdriver to open the case as shown

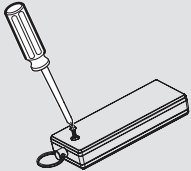

- 2** Remove the old battery. Dispose of old batteries properly.

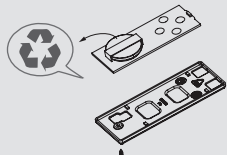

- 3** Insert replacement batteries positive side up. Replace the batteries with only CR2032 batteries.

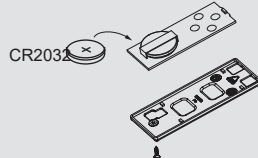

- 4** Replace the cover.

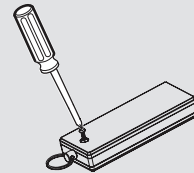

! WARNING

WARNING! This product contains a button/coin cell battery.

- The battery is hazardous.
- Keep new and used batteries away from children.
- Do not ingest battery. Chemical burn hazard.
- If the coin cell battery is swallowed or placed inside any part of the body, it can cause severe or fatal injuries in 2 hours or less.
- If the battery compartment does not close securely, stop using the product and keep away from children.
- If you think batteries might have been swallowed or placed inside any part of the body, call the 24-hour Poisons Information Centre on 13 11 26 in Australia, or the 24-hour National Poisons Centre on 0800 764 766 in New Zealand, or seek immediate medical attention.
- Dispose of used coin/button cell batteries immediately and safely. Flat batteries can still be dangerous.



HOW TO USE THE REMOTE CONTROL

Press and hold the button down until the door or gate starts to move. The remote control will operate from up to 3 car lengths away on typical installations. Installations and conditions vary.

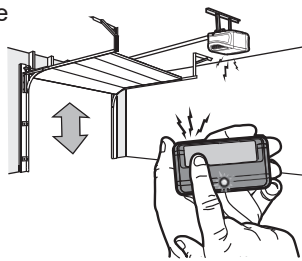

ONE YEAR LIMITED WARRANTY

Chamberlain Australia Pty Limited / Chamberlain New Zealand (Chamberlain), the manufacturer of Chamberlain® automatic garage door openers, warrants to the original consumer purchaser of this product that it is free from defect in materials and/or workmanship for a period of 1 year from the date of purchase.

Chamberlain is committed to manufacturing and supplying high quality goods. As part of this commitment, we seek to provide reliable service and support for our goods and are pleased to provide you, the original purchaser, with this Chamberlain Limited Warranty.

The benefits given to you under this Chamberlain Limited Warranty are in addition to any rights and remedies that you may have under Australian or New Zealand consumer protection laws. Our goods come with guarantees that cannot be excluded under the Australian Consumer Law, or New Zealand Consumer Guarantees Act 1993. You are entitled to a replacement or refund for a major failure and for compensation for any other reasonably foreseeable loss or damage. You are also entitled to have the goods repaired or replaced if the goods fail to be of acceptable quality and the failure does not amount to a major failure.

Customer Service :

Australia : PH - 1800 665 438 Website - www.chamberlaindiy.com.au

New Zealand : PH - 0800 653 667 Website - www.chamberlaindiy.co.nz