

# HEAVY DUTY GREY RUBBER CASTORS

UP TO  
**140kg**  
LOAD CAPACITY

Grey rubber heavy duty castors are ideal for heavy duty use on decorative flooring due to the non-marking rubber.

These castor come in both bolt hole and plate mounted versions to suit your application needs.

Manufactured with high quality precision bearings which provides minimal rolling resistance, the castor features wheel guards to extend the life time of the castor.

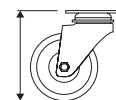
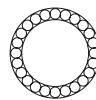
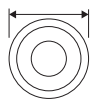
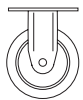

Product Code	Castor Type	Wheel Diameter (mm)	Tread Width (mm)	Wheel Material	Bearing Type	Load Capacity (kg)	Finished Height (mm)	Fitting Type
0177933	Swivel	100	30	Grey Rubber	Precision	100	128	Plate Mount
0177934	Swivel + Brake	100	30	Grey Rubber	Precision	100	128	Plate Mount
0177935	Fixed	100	30	Grey Rubber	Precision	100	128	Plate Mount
0177937	Swivel	125	31	Grey Rubber	Precision	100	155	Plate Mount
0177938	Swivel + Brake	125	31	Grey Rubber	Precision	100	155	Plate Mount
0177939	Fixed	125	31	Grey Rubber	Precision	100	155	Plate Mount
0177940	Expander Kit	100	32	Grey Rubber	Precision	120	135	Bolt Hole
0177942	Expander Kit	100	32	Grey Rubber	Precision	120	135	Bolt Hole
0186343	Expander Kit	125	32	Grey Rubber	Precision	140	162	Bolt Hole
0186344	Expander Kit	125	32	Grey Rubber	Precision	140	162	Bolt Hole