

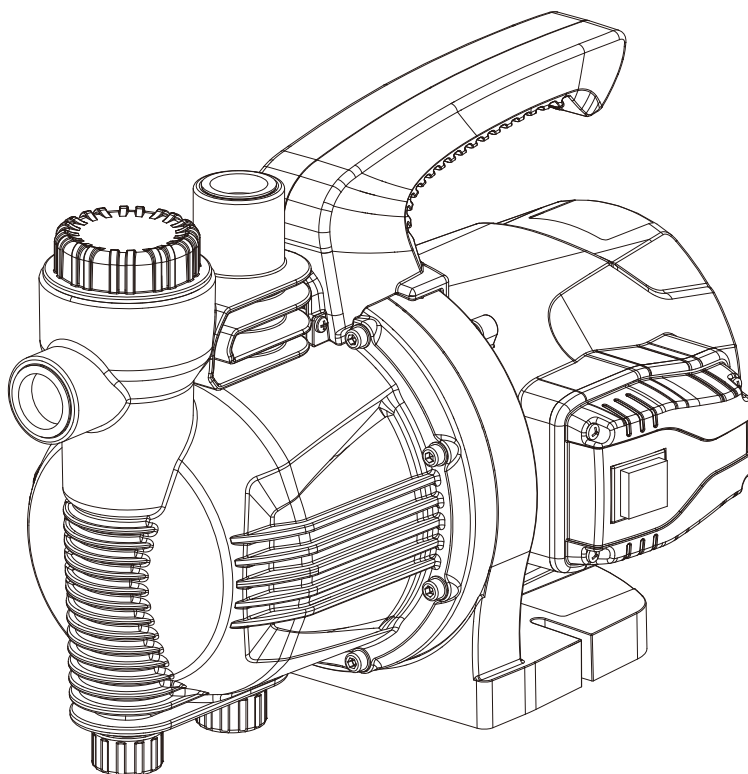

RTP900

TRANSFER PUMP OWNER'S OPERATING MANUAL



Components List

1. 25mm Water inlet
2. Pre-Filter
3. 25mm Water outlet
4. Drain plug
5. Pump Head
6. On/Off switch
7. Carry Handle
8. 900W Induction motor with thermal overload
9. Spanner
10. Thread seal tape

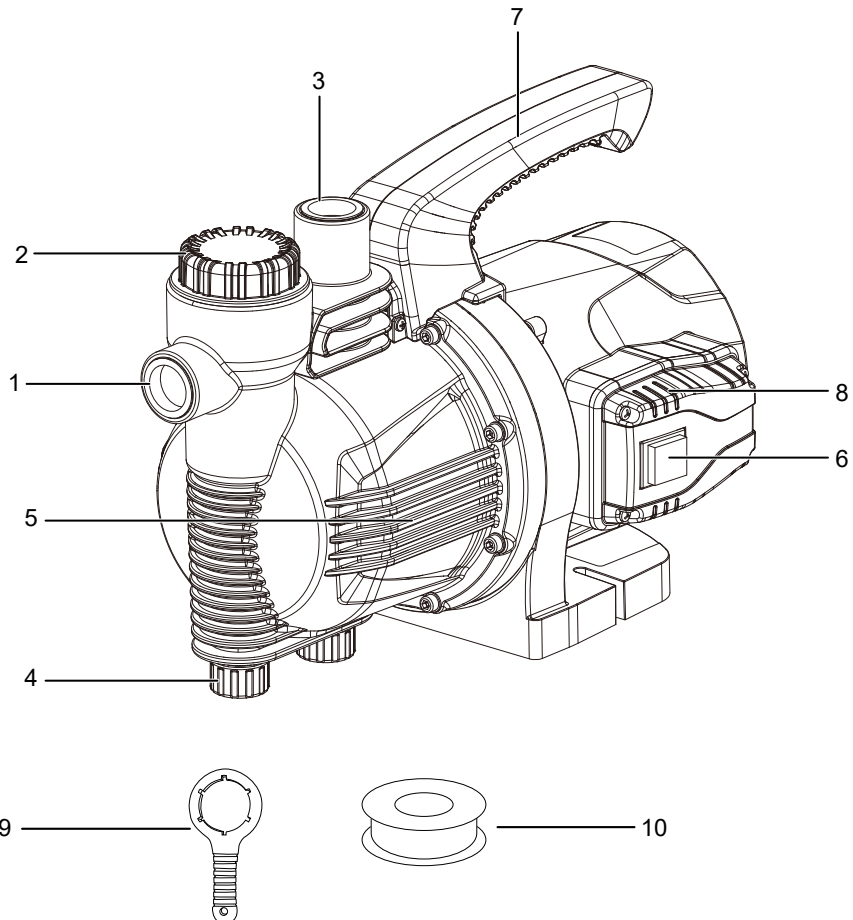

DESCRIPTION

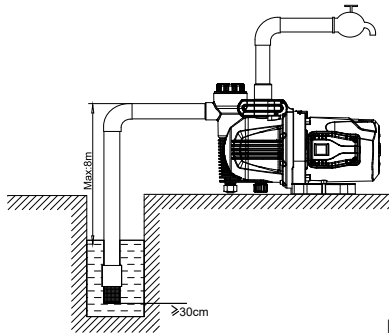

Fig. 1

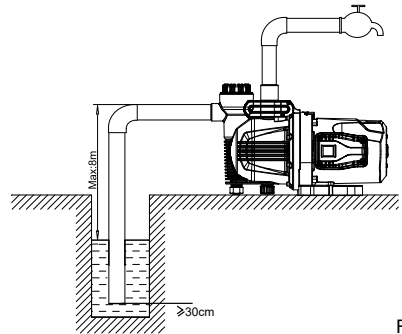

Fig. 2

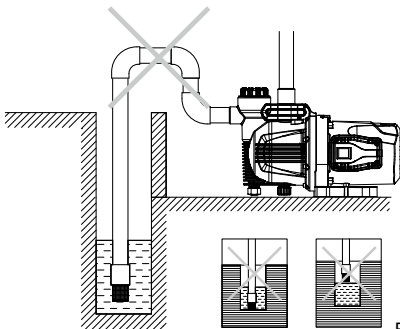

Fig. 3

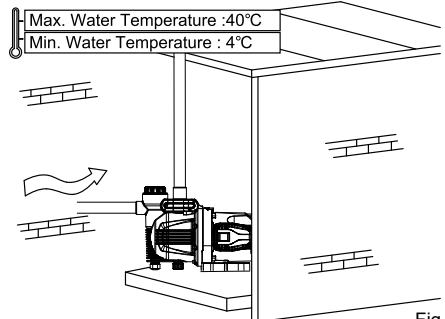

Fig. 4

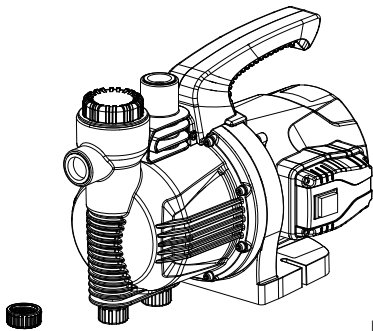

Fig. 5

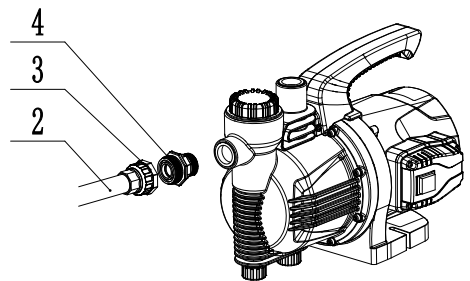

Fig. 6

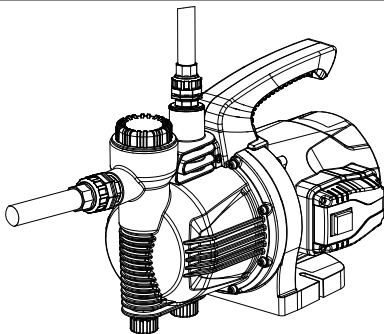

Fig. 7

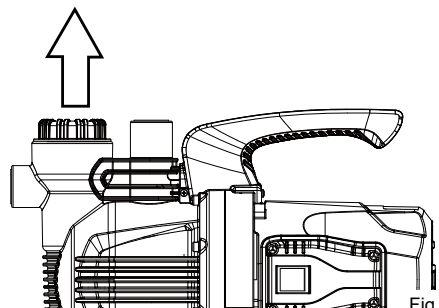
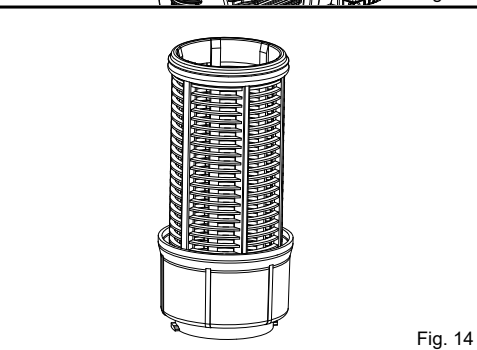
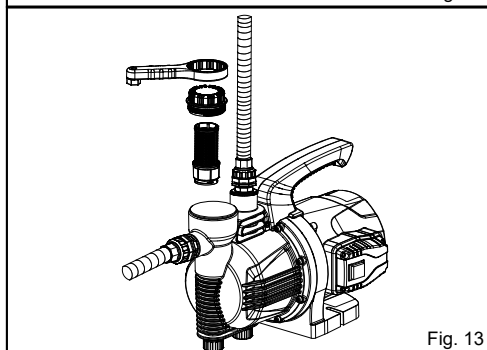
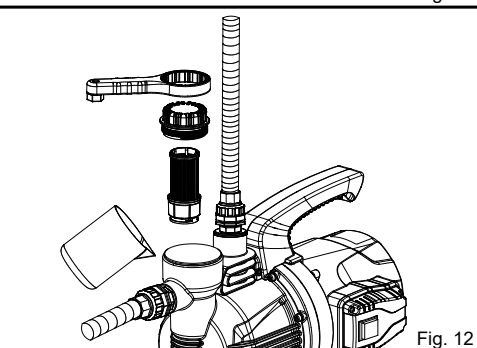
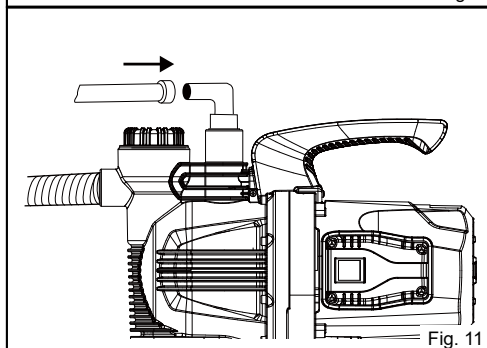
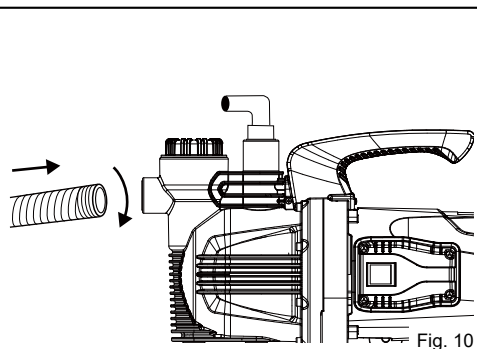
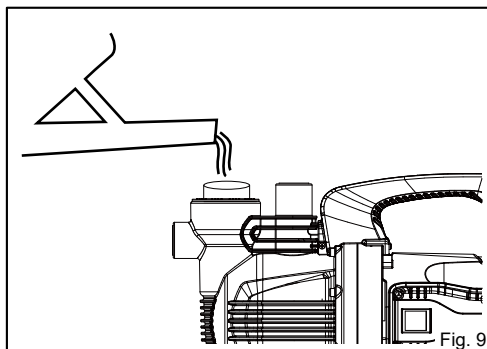

Fig. 8

DESCRIPTION



Important!

It is essential that you read the instructions in this manual before assembling, operating and maintaining the product.

Subject to technical modification.

GENERAL SAFETY WARNINGS

- **Read all safety warnings and all instructions.** Failure to follow the warnings and instructions may result in electric shock, fire and/or serious injury. Save all warnings and instructions for future reference.
- **Know your product. Read operator's manual carefully.** Learn its applications and limitations, as well as the specific potential hazards related to the product. Following the rule will reduce the risk of electric shock, fire, or serious injury.
- **Do not let familiarity gained from frequent use of tools allow you to become complacent and ignore tool safety principals.** A careless action can cause severe injury within a fraction of a second.
- **Follow appliance manufacturer's instructions regarding operation and power.** Use of the appliance different from those intended could result in a hazardous situation.
- **Use the correct product for the application.**
- **Do not allow children to operate the product or play with the product as a toy.** Close attention is necessary when used near children.
- **To reduce the risk of personal injury and electric shock, the product should not be played with or placed where small children can reach it.**
- **The product is intended for household use only.**
- **Use the product only for its intended use as described in this manual.**
- **If the product is not working properly, has been dropped, damaged, left outdoors or dropped into water, return it to your nearest service centre.**
- **Only use attachments and accessories specified by the manufacturer.**
- **Do not put any objects in ventilation openings.** Do not use the product with any opening blocked. Keep openings free of dust, lint, hair and anything that may reduce air flow.
- **Stay alert, watch what you are doing and use common sense when operating the product.** Do not use while you are tired or under the influence of drugs, alcohol or medication. A moment of inattention may result in serious personal injury.
- **Do not place product near any heat sources such as radiators, heat registers, stoves, or other products (including amplifiers) that produce heat.**
- **Do not place the product near fire or heat; it may explode.**
- **Do not place the product in closed bookcases or racks without proper ventilation.** Allow a minimum distance of 5cm from any foreign object.
- **Risk of uncontrolled situations when used in ambient temperatures below 0°C (32°F) or above 40 °C (104°F).**
- **Keep the product dry, clean and free from oil and grease.** Always use a clean cloth when cleaning.

- **Keep handles and grasping surfaces dry, clean and free from oil and grease.** Slippery handles and grasping surfaces do not allow for safe handling and control of the tool in unexpected situations.
- **Do not overreach. Keep proper footing and balance at all times.** This enables better control of the product in unexpected situations.
- **When servicing the product, use only manufacturer's replacement parts, accessories and attachments.** Follow instructions in the Maintenance section of the manual. Use of unauthorised parts or failure to follow maintenance instructions may create a risk of shock or injury.
- **Save these instructions.** Refer to them frequently and use them to instruct others who may use this tool. If you loan someone this tool, loan them these instructions also **TRANSFER PUMP SAFETY WARNINGS**
- **Do not let the pump run dry.**
- **Do not remove hose while pump is still operating.**
- **Do not allow the product to run unattended.**
- **Do not lift the pump by the hoses.**
- **Periodically inspect the pump, hoses and intake filter.** Ensure hoses and intake filter are free from mud, sand and debris. Remove the battery before inspecting.
- **If the replacement of the supply cord is necessary, this has to be done by the manufacturer or his agent in order to avoid a safety hazard; The pump is to be supplied through a residual current device (RCD) having a rated residual operating current not exceeding 30mA**

RESIDUAL RISKS

WARNING

This product is intended for pumping water in a Home Domestic application. Do not use it for corrosive, abrasive, explosive or dangerous liquids. Fluids other than water will damage the water pump and/or create a fire hazard. Failure to follow all instructions listed below may result in electric shock, fire and/or serious injury.

WARNING

This product is not suitable for use with drinking (potable) water.

This appliance is not intended for use by person (including children) with reduced physical, sensory or mental capabilities, or lack of experience and knowledge, unless they have been given supervision or instruction concerning use of the appliance by a person responsible for their safety. Children should be supervised to ensure that they do not play with the appliance.

- Ensure the water pump is disconnected from mains power when installing.

- Do not install or operate the water pump in an explosive environment or near flammable material.
- Do not operate the water pump without liquid.
- Do not run the water pump dry.

WARNING

The water pump together with associated pipework operate under pressure. Do not disconnect water pump or pipework until internal pressure has been released. Failure to do this could result in personal injury and damage to property.

- Avoid inserting hands into the inlets/outlets of the water pump while it is connected to power.
- Before using the water pump, always inspect it visually. Do not use the pump if it is cracked and/or damaged.
- The water pump has a built-in thermal protection overload switch. The water pump stops if an overload occurs. The motor restarts automatically after it has cooled down.
- The pump must not be used when people are in the water.
- Never work or perform maintenance on the pump without first making sure it has been disconnected from the mains power.
- Pollution of the liquid could occur due to leakage of lubricants.

Important: Avoid inserting hands into the mouth of the pump if it is connected to the mains. The electrical connection must always be made in a dry area. Make sure that electrical connections are protected from inundations.

Protect the plug and the power cable from heat, oil or sharp edges.

MAINTENANCE

WARNING

Make sure the pump is disconnected from electric power supply before performing maintenance procedures.

CLEANING THE PUMP HOUSING

Use a damp cloth to wipe down the pump housing. Allow to dry thoroughly before storing in a dry location that is protected from bad weather conditions.

CLEANING THE PREFILTER

The pump is fitted with a pre-filter which will need cleaning at regular intervals or replacing if necessary.

1. Remove the pre-filter using the supplied filter wrench to loosen the screw by turning in a anti-clockwise direction.
2. Tap the filter on a flat surface gently. For stubborn dirt, simply rinse with water.

NOTE: Do not use abrasive cleaning agents to clean the filter.

1. Once clean re-assemble the pre-filter.
2. Screw the pre-filter onto the pump and tighten with the supplied filter wrench.

SYMBOLS DEFINITION ON THE PRODUCT



Safety alert



Volts



Hertz



Alternating current



Watts



Connect to the power supply.



Disconnect from the power supply.



Parts or accessories sold separately



Regulatory Compliance Mark (RCM). Product meets applicable regulatory requirements.



Please read the instructions carefully before starting the machine.



Waste electrical products should not be disposed of with household waste. Please recycle where facilities exist. Check with your local authority or retailer for recycling advice.

INTENDED USE

The transfer pump is intended to be used only by adults who have read and understood the instructions and warnings in this manual, and can be considered responsible for their actions.

The product is intended for drawing water for domestic use, water from wells, increase pressure for pipelines or draining/removing water from flooded areas, clogged sinks, water basins etc.

BEFORE INSTALLATION

WARNING

The product should be installed and maintained by personnel who are familiar with instruction manual and have professional qualification certificate; installation and operation must conform to local laws and practical standard; install pipeline properly according to instruction manual and anti-freezing measures are taken to pipeline.

Installation precautions of inlet water pipes (Fig. 1,2)

1. Do not use a soft rubber hose as it may collapse during the operation of the electric pump.
2. Bottom valve must be vertical and 30cm above bottom to avoid debris being picked up.

3. All water pipe joints must be sealed with minimal elbow connections for best performance.
4. Monitor water level decline when using, and bottom valve should remain submerged.
5. Ensure that the water inlet pipe matches the electric pump inlet pipe diameter.
6. For additional protection it is recommended to install in line filters

Installation precautions of outlet water pipes (Fig. 3)

Diameter of outlet water pipes should be at least the same as that of water outlet to minimize pressure, high flow rate and noise.

Choice of installation location (Fig. 4)

When installing pumps, inlet pipelines should be as short as possible and elbows should be as few as possible. Pumps should be placed in the well-ventilated environment. Pumps may be installed outdoor, but they must be covered to prevent rain damage and frost.

INSTRUCTIONS

Examine screw plug for water drainage (Fig. 5)

Before use ensure that the screw plug for water drainage has been installed correctly.

Set inlet water pipes (Fig. 6)

Water pumps are connected with circuits:
Steel wire hose or corrugated pipe (2);
Removable connection nut (3);
Water inlet (4);
Correct operations are as follows: Connect (3) to (2) (Fig. 6) prior to connecting (3) to (4) (Fig. 6). Ensure that all connections are sealed correctly.

Set outlet water pipes (Fig. 7)

Installation of outlet water pipes is shown as Fig.16, the same as installation of water inlet pipes; pay attention to sealing of pipelines.

Pump operation

1. Fill the suction hose with water. Unscrew the filter cap (2), (Fig. 8) then fill the body of the water pump slowly (2-3 liters) until the water comes out through the water inlet (1). (Fig. 9)
2. Connect the suction hose to the water inlet (1). (Fig. 10)
3. Connect the discharge pipe with the water outlet (3) (fig. 11) The pump will start when the switch is turned on.

Prime pump chamber with water (Fig. 12)

WARNING

Do not turn on the pump until the pump head is primed with water.

Fill pump head with water before initial use, pour water into outlet port before use.

MAINTENANCE MANUAL

Clean strainer mesh (Fig. 13)

To maintain optimum water flow performance, users should clean strainer mesh components regularly according to water quality. The method to clean is as follows:

Strainer mesh is rotated as the direction of arrow in Fig.14 to separate strainer mesh; clean strainer mesh respectively with clean water; assemble strainer mesh and install them properly for use.

Temperature lowers 4°C or extended outage status

If there is any risks of damage due to frost or freezing, or electric pumps may not be used for a long time, please open screw plug for water drainage to discharge water. When pumps are needed to restart, open pump cover, filled with water and tighten cover before restart.

Tips:

1. In summer or when temperature is high, ensure pump is well ventilated.
2. If electric pump overheats or malfunctions, please turn off power immediately.

SPECIFICATIONS

Rated Power	900W
Max. Delivery Height	42m
Max. Suction Lift	8m
Max. Water Flow	4,500L/hr
Max. Working Temp	35°C
Max. Particle Size	0.5mm
Cable Length	1.5m

COMMON FAILURES AND TREATMENT

Failures	Causes	Measures
No water output from pump	Water pump is not primed (not filled with water)	Turn off pump and refill pump chamber with water
	Water level is lower than bottom valve	Adjust water inlet pipeline to submerge bottom valve
	Leakage of suction pipes	Examine joints sealing of all suction pipes
Deficiency in pressure	Too many elbow connections	Pipe diameter is incorrect please refer to installation instructions page 3
	Debris blocks entrance of pipelines, strainer mesh or pump chamber	Clean pipelines, bottom valve or pump chamber and remove foreign debris
Pump vibration	Pump is not secured correctly	Secure pump



Imported by:

Techtronic Industries Australia Pty Ltd
31 Gilby Road, Mount Waverley, VIC 3149
Melbourne, Australia

Techtronic Industries N.Z. Limited
Unit C
70 Business Parade South
Highbrook
Auckland 2013
New Zealand