

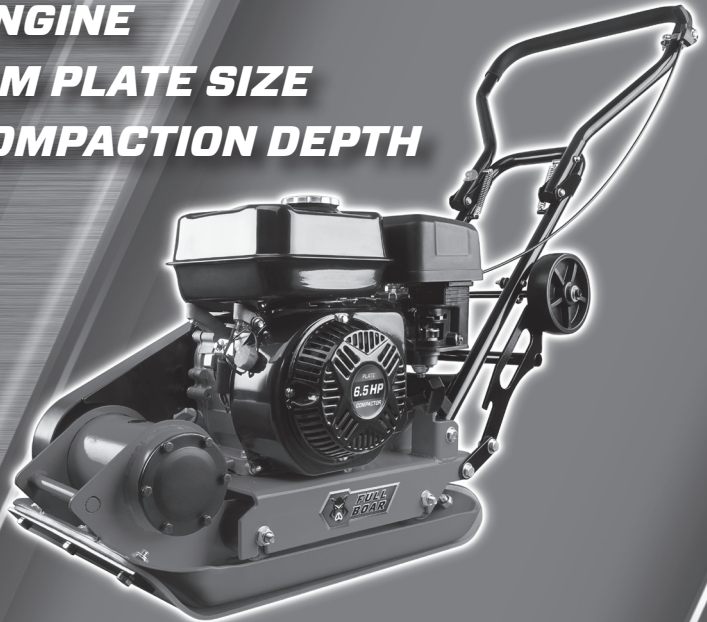

FULL BOAR

6.5HP PLATE COMPACTOR

- **196CC ENGINE**
- **51 X 37CM PLATE SIZE**
- **30CM COMPACTION DEPTH**



INSTRUCTION MANUAL



WARNING: Read all safety warnings and all instructions. Failure to follow the warnings and instructions may result in electric shock, fire and/or serious injury. Save all warnings and instructions for future reference.

SPECIFICATIONS - MODEL NO. FBPPC-650

Compactor specifications

- Vibration frequency:** 5,500 vpm
- Centrifugal force:** 11 kN
- Compaction depth:** 30 cm
- Travel speed:** 15m/min
- Plate size:** 510 x 370 mm
- Plate thickness:** 6 mm
- Noise level:** 105 dB(A)
- Weight:** 60 kg

Engine specifications

- Power:** 6.5 HP
- Capacity:** 196 cc
- No load speed:** 3600 rpm
- Type:** 4 stroke, air cooled
- Fuel type:** 91 Oct unleaded petrol
- Fuel tank volume:** 3.6 litres
- Oil sump volume:** 600 ml
- Exciter oil volume:** 150 ml

KNOW YOUR PRODUCT

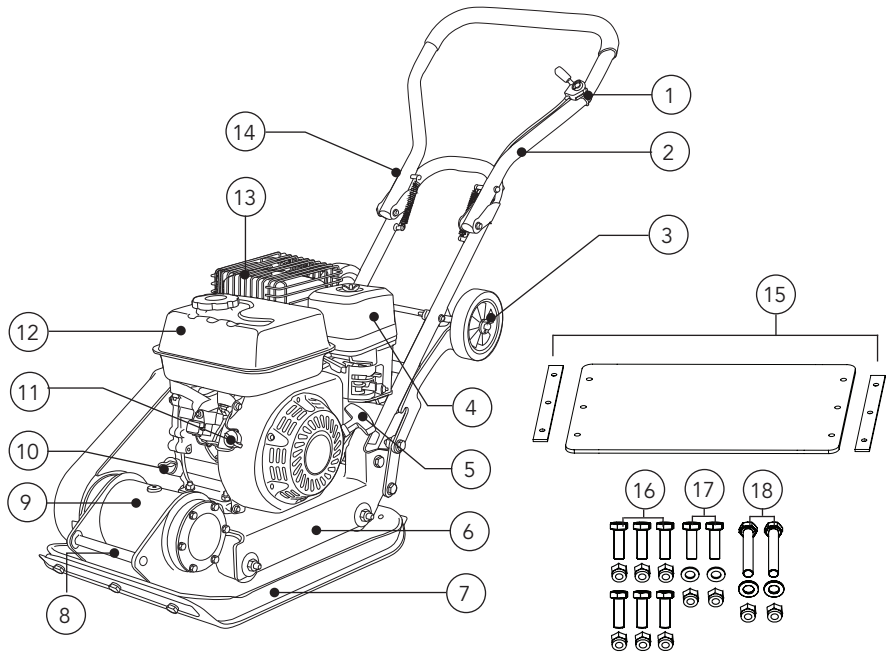

- | | | |
|---------------------------|--------------------------|---------------------------|
| 1. Throttle | 8. Lifting handle | 15. Paving pad kit |
| 2. Handle assembly | 9. Exciter | 16. M10 x 30 Bolt kit x 6 |
| 3. Trolley wheel assembly | 10. Oil fill plug | 17. M10 x 30 Bolt kit x 2 |
| 4. Air filter | 11. Engine On/Off switch | 18. M10 x 65 Bolt kit x 2 |
| 5. Recoil starter | 12. Fuel tank | |
| 6. Engine deck | 13. Muffler | |
| 7. Compacting plate | 14. Handle lock lever | |

TABLE OF CONTENTS

SPECIFICATIONS.....	Page 02
KNOW YOUR PRODUCT.....	Page 02
INTRODUCTION.....	Page 04
SAFETY INSTRUCTIONS.....	Page 04
ASSEMBLY.....	Page 08
PRE-OPERATION INSPECTION.....	Page 11
OPERATION.....	Page 13
MAINTENANCE.....	Page 15
STORAGE.....	Page 20
TRANSPORTING.....	Page 21
TROUBLESHOOTING.....	Page 21
DESCRIPTION OF SYMBOLS.....	Page 22
CONTENTS.....	Page 23
WARRANTY.....	Page 24

INTRODUCTION

Congratulations on purchasing a Full Boar Plate Compactor. Your Full Boar Plate Compactor FBPPC-650 has been designed for paving projects like driveways, landscaping or preparing foundations for concreting.

SAFETY INSTRUCTIONS



WARNING! When using petrol-powered equipment, basic safety precautions, including the following, should always be followed to reduce risk of fire, personal injury and material damage.

Read and understand the manual prior to operating this tool.

Save these instructions and other documents supplied with this tool for future reference.

The manufacturer cannot accept any liability for damage or accidents which arise due to a failure to follow these instructions and the safety information.

GENERAL SAFETY WARNINGS

RISK OF EXPLOSION OR FIRE

What can happen:

- Spilled petrol and its vapours can become ignited from cigarette sparks, electrical arcing, exhaust gases and hot engine components such as the muffler.
- Heat will expand fuel in the tank which could result in a fire.
- Operating the tool in an explosive environment could result in a fire.
- Muffler exhaust heat can damage painted surfaces, melt any materials sensitive to heat (such as siding plastic, rubber or vinyl) and damage live plants. Keep hot tool away from other objects.
- Improperly stored fuel could lead to accidental ignition. Fuel improperly secured could get into the hands of children or other unqualified persons.

How to prevent it:

- Shut off engine and allow it to cool before adding fuel to the tank.
- Use care when filling the tank to avoid spilling fuel. Move tool away from fuelling area before starting engine.
- Keep maximum fuel level 20mm below top of tank to allow for expansion.
- Operate and refuel in well ventilated areas free from obstructions. Never re-fuel indoors.
- Store fuel in a approved container (AS/NZS 2906-1999) for petrol. Store in a secure location away from the work area. Make sure the container is clearly marked "fuel".

GENERAL SAFETY WARNINGS (cont.)

RISK TO BREATHING

What can happen:

- Breathing exhaust fumes can cause serious injury or death.

How to prevent it:

- Operate tool in a well ventilated area. Avoid enclosed areas.
- Never operate unit in a location occupied by other people or animals.

SAVE THESE INSTRUCTIONS

1) Work area

- a) **Keep work area clean and well lit. Cluttered and dark areas invite accidents.**
- b) **Do not operate petrol tools in explosive atmospheres, such as in the presence of flammable liquids, gases, or dust.** Power tools create sparks which may ignite the dust or fumes.
- c) **Keep children and bystanders away while operating a petrol tool.**
Distractions can cause you to lose control.

2) Personal safety

- a) **Stay alert, watch what you are doing and use common sense when operating a petrol tool.** Do not use a power tool while you are tired or under the influence of drugs, alcohol, or medication. A moment of inattention while operating power tools may result in serious personal injury.
- b) **Use safety equipment. Always wear eye protection.** Safety equipment such as a dust mask, non-skid safety shoes, hard hat, or hearing protection used for appropriate conditions will reduce personal injuries.
- c) **Remove any adjusting key or wrench before turning the tool on.** A wrench or a key that is left attached to a rotating part of the petrol tool may result in personal injury.
- d) **Do not overreach. Keep proper footing and balance at all times.** This enables better control of the petrol tool in unexpected situations.
- e) **Dress properly. Do not wear loose clothing or jewellery.** Keep your hair, clothing and gloves away from moving parts. Loose clothes, jewellery or long hair can be caught in moving parts.

3) Petrol tool use and care

- a) **Do not force the petrol tool. Use the correct petrol tool for your application.** The correct petrol tool will do the job better and safer at the rate for which it was designed.
- b) **Do not use the petrol tool if the switch does not turn it on and off.** Any petrol tool that cannot be controlled with the switch is dangerous and must be repaired.
- c) **Turn tool off completely before making any adjustments, changing accessories, or storing petrol tools.** Such preventive safety measures reduce the risk of starting the petrol tool accidentally. Hair can be caught in moving parts.
- d) **Store idle petrol tools out of the reach of children and do not allow persons unfamiliar with the petrol tool or these instructions to operate the petrol tool.** Petrol tools are dangerous in the hands of untrained users.

GENERAL SAFETY WARNINGS (cont.)

- e) **Maintain petrol tools. Check for misalignment or binding of moving parts, breakage of parts and any other condition that may affect the petrol tool's operation.** If damaged, have the petrol tool repaired before use. Many accidents are caused by poorly maintained petrol tools.
- f) **Use the petrol tool, accessories and tool bits etc., in accordance with these instructions and in the manner intended for the particular type of petrol tool, taking into account the working conditions and the work to be performed.** Use of the petrol tool for operations different from intended could result in a hazardous situation.
- g) **This appliance is not intended for use by persons (including children) with reduced physical, sensory or mental capabilities, or lack of experience and knowledge,** unless they have been given supervision or instruction concerning use of the appliance by a person responsible for their safety.
- h) **Children should be supervised to ensure that they do not play with the appliance.**

4) Service

- a) **Have your petrol tool serviced by a qualified repair personnel using only identical replacement parts.** This will ensure that the safety of the petrol tool is maintained.



WARNING! The engine and muffler becomes very hot during operation and remains hot for a while after stopping the engine. Be careful not to touch these components while it is hot. Let the engine cool before storing indoors.



WARNING! Exhaust contains poisonous carbon monoxide. Do not operate pressure washer in confined area. Be sure to operate the petrol compactor in a well-ventilated environment. Using a petrol compactor indoors will kill you in minutes. Never use in the home or in a partly enclosed area such as garages. Only use outdoors and far from open windows doors and vents.



WARNING! Engine exhaust contains carbon monoxide, a poisonous gas that could kill you in minutes. You cannot smell it, see it, or taste it. Even if you do not smell exhaust fumes, you could still be exposed to carbon monoxide gas. If you start to feel sick, dizzy, or weak while using this product, get fresh air right away. See a doctor. You may have carbon monoxide poisoning.



WARNING! Do not operate in hazardous location e.g. Where there may be a risk of explosion of petrol fumes, leaking gas or explosive dust.



WARNING! Do not operate in a confined area where exhaust gases, smoke or fumes could reach dangerous concentrations.

PLATE COMPACTOR SAFETY WARNINGS



WARNING! This appliance is not intended for use by persons (including children) with reduced physical, sensory or mental capabilities, or lack of experience and knowledge, unless they have been given supervision or instruction concerning use of the appliance by a person responsible for their safety.

- 1) **Never refuel while engine is running or hot.** Fuel spilled on a hot engine could result in a fire or explosion.
- 2) **Use caution when handling petrol. Refuel in well-ventilated area. Do not overfill fuel tank and do not spill fuel. Make sure tank cap is closed properly.** Petrol is extremely flammable and is explosive under certain conditions.
- 3) **Never run the engine in an enclosed or confined area.** Exhaust contains poisonous carbon monoxide gas; exposure may cause loss of consciousness and may lead to death.
- 4) **Be careful not to touch the muffler while it is hot. To avoid severe burns or fire hazards, let the engine cool before transporting or storing it indoors.** The muffler becomes very hot during operation and remains hot for a while after stopping the engine. Exhaust may contain chemicals that may cause cancer or reproductive harm.
- 5) **Keep hands, fingers and feet away from the base plate.** Grip the handle of the plate compactor firmly with both hands.
- 6) **Always operate the machine from behind,** never pass or stand in front of the machine when the engine is running.
- 7) **Never place tools or any other item under the plate compactor.**
- 8) **If the unit strikes a foreign object, stop the engine, disconnect the spark plug,** thoroughly inspect the machine for any damage, and repair the damage before restarting and operating the machine.
- 9) **Do not overload the machine capacity** by compacting too deep in a single pass or at too fast a rate.
- 10) **Never operate the unit at high transport speeds on hard or slippery surfaces.**
- 11) **Exercise extreme caution when operating on or crossing gravel drives, walks, or roads.** Stay alert for hidden hazards or traffic.
- 12) **Do not carry passengers.**
- 13) **Never leave the plate compactor unattended while the engine is running.**
- 14) **Always stop the engine when walking from one location to another.**
- 15) **Stay away from the edge of ditches and avoid actions that may cause the plate compactor to topple over.**
- 16) **Always ascend slopes carefully to prevent the plate compactor from toppling over onto the operator.**
- 17) **Always park the unit on a firm and level surface and shut the plate compactor off.**
- 18) **Limit the hours of operation and take periodic breaks to minimize repetition and reduce exposure to vibration to your arm.** Reduce the speed and force in which you do the repetitive movement.

Children should be supervised to ensure that they do not play with the appliance.

Fitting the handle assembly (2)

1. Unfold the handle assembly (2). (fig. 1)

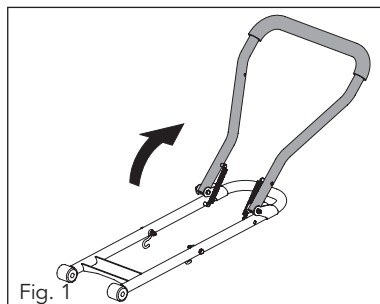

2. Mount the handle assembly (2) to the engine deck (6). Ensure the handle assembly (2) ends slot into the engine deck (12) channels. Place M10 x 65 bolts & washer (18) on the outer side, and tighten with nyloc nuts on the inner side. (fig. 2)

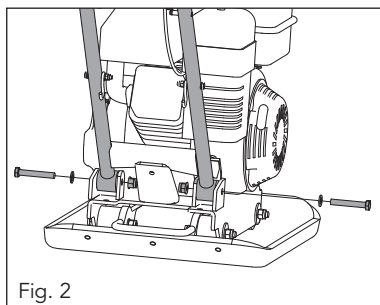

3. Using bolt and washer from throttle (1) attached and secure the throttle (1) onto the handle assembly (2). (fig. 3)

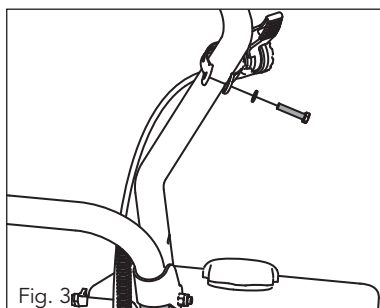

ASSEMBLY (cont.)

Fitting the trolley wheel assembly (3)

1. Line up the holes in the trolley wheel assembly (3) and engine deck (12). The arms of the wheel assembly frame should sit outside the engine deck. Slide M10 x 30 bolts & washer (17) through the holes from one side, then nyloc nuts from the other side and tighten. (fig. 4)

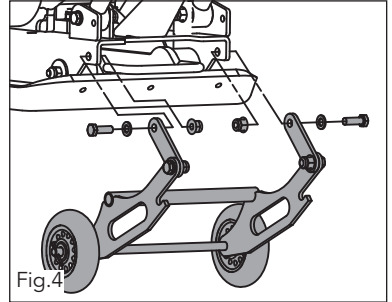

2. The trolley wheel assembly (3) makes moving the plate compactor easier when it is not being used. Before compacting, fold up the trolley wheel assembly (3) and secure with hooks fixed on the handle assembly (2) (fig. 5).

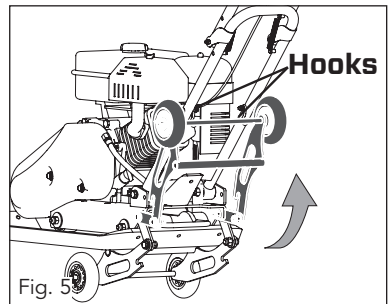

ASSEMBLY (cont.)

Fitting the paving pad kit (15)

The transparent rubber paving pad reduces the vibration when compacting solid slabs of concrete, stones, slates and bricks. It also reduces the chance of cracking the paving slabs when coming into contact with the compacting plate (7).

1. To fit, place the paving pad on a flat surface.
2. Wheel the plate compactor over the paving pad, making sure the pad is aligned with the compacting plate (7).
3. Fix paving pad to the back of the plate compactor first. Align the holes in the compacting plate (7), paving pad and bracket.
4. Secure in place with M10x30 nyloc nuts and bolts (16) (fig. 6)
5. Fold the wheels up and secure with hooks on the handle assembly (2).
6. Using the front lifting handle (8), lift the front of the plate compactor with one hand and with the other hand, pull the paving pad forward to align with the holes in compacting plate (7).

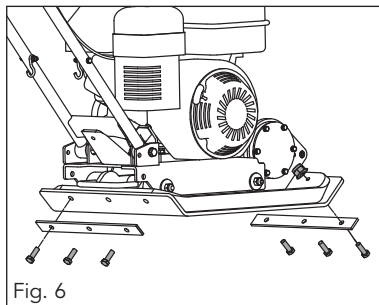

7. Use the remaining bracket, M10x30 bolts and nuts (16) to secure.
8. Use a spanner (not included) to fully tighten all bolts & nuts.

PRE-OPERATION INSPECTION

Environment conditions

The operation of a four-stroke (91 unleaded) engine is affected by:

1. Temperature

- a. Working in low temperatures could lead to difficult cold starting.
- b. Working in very high temperatures could lead to difficult hot starting due to evaporation of the fuel.
- c. Ensure the correct oil is used according to the operating temperatures. (Refer to Engine Oil Inspection on this page).

2. Altitude

- a. When there is a considerable increase in altitude, the load on the machine should be reduced and heavy work load should be avoided.

Engine oil inspection



WARNING! Engine oil has been drained for shipping. Failure to fill engine sump with oil before starting the engine may result in permanent damage and will void warranty.

Note: This unit is fitted with an oil sensor. Failure to fill the engine oil sump to maximum level (600ml) before first use may result in inability to start the plate compactor.

Before starting ensure an oil inspection is conducted. Always use high quality oils, select their viscosity grade according to the operating temperatures.

1. Remove engine oil fill plug (10) and clean on a cloth or rag.
2. Re-insert the oil fill plug momentarily. Remove and look at the oil fill plug to determine oil level.
3. If oil level is low, fill engine sump with oil.
4. After finishing, replace and secure the oil fill plug.

Note: It is recommended that SAE-10W-30 (multi viscosity) oils are used at temperatures from 5 to 35°C and synthetic oils 5W-30 (multi viscosity) is used for temperatures -5 to 5°C.

To change or top up the engine oil, refer to either the maintenance section (pg 15) of this instruction manual.

PRE-OPERATION INSPECTION (cont.)

Fuel inspection



WARNING! Fuel has been drained for shipping. Failure to fill fuel tank with petrol before starting the engine may result in permanent damage and will void warranty.



WARNING! Do not over fill the fuel tank.



WARNING! Do not smoke while re-fueling.

1. Use unleaded petrol with a minimum of Octane 91.
2. Use clean, fresh fuel; purchase fuel in quantities that can be used every 30 days, to prevent gum or foaming inside the container and/or fuel tank.
3. **Do not** use fuel which contains methanol.
4. **Do not** add oil or any kind of fuel additive.

Air filter

The air filter (4) must always be in perfect working order, to prevent debris and dust from being sucked into the engine thus reducing the efficiency and life of the machine.

1. Always keep the air filter (4) free of debris and in perfect working order. Shake off dust and dirt by hand or with compressed air
2. If necessary, replace the filter with an original spare part. Incompatible filtering can impair the efficiency and life of the engine.
3. Never start the engine without the air filter (4) assembled. To change the air filter (4) refer to the maintenance section of this instruction manual.

Checking V-belt(s)

To ensure optimum power transmission from the engine to the exciter (9), the V-belt(s) must be in good condition and operate under proper tension.

1. Turn off engine. Engine must be cool.
2. Remove the belt guard to access the V-belt(s).
3. Check the condition of the V-belt(s). If any V-belt is cracked, frayed, or glazed, it should be replaced as soon as convenient.
4. Check the V-belt tension by squeezing them in the centre. The normal deflection on each side should be 9mm (3/8") to 13mm (1/2") with moderate pressure from your thumb or finger.

OPERATION

Starting the engine



WARNING! Before first use, ensure you have filled the engine sump with engine oil before starting the plate compactor. The oil fill plug (10) must indicate the oil level is at maximum for the engine to start for the first time.

- 1. ENGINE ON/OFF SWITCH** - Move the engine on/off switch to the ON position (fig. 7).

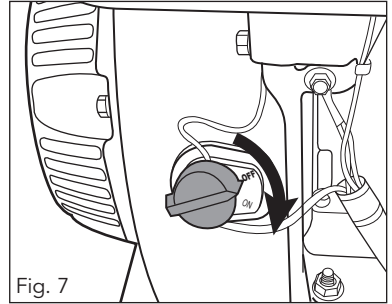

- 2. FUEL** - Move the fuel lever fully to the right, OPEN/ON position (fig. 8).

- 3. CHOKE** - Move the choke lever to the left, choke (closed) start position (fig. 8).

Note: If the engine is still hot, closing the choke is not necessary.

- 4. SPEED CONTROL** - Move the lever half way left towards the  symbol (fig. 8).

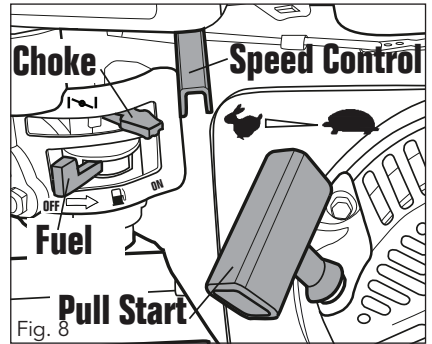

- 5. STARTER** - Grip the recoil starter and slowly pull until resistance is felt, then pull the recoil starter rapidly. Allow the rope to rewind slowly and if necessary, repeat this procedure until the engine starts (fig. 9).

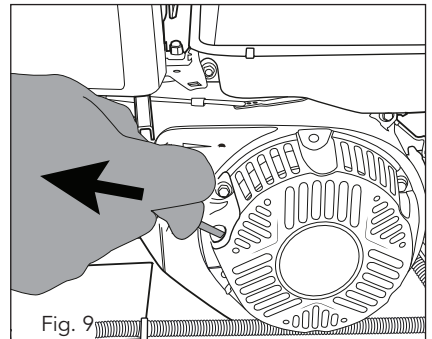

- 6.** Once started move the choke lever right (run) position.

OPERATION (cont.)

Throttle adjustment (fig. 10)

The throttle (1) is used to regulate the RPM of the engine, which also controls the speed at which the plate compactor travels.

The plate compactor is designed to run at an engine speed (engine take off shaft) of 3600rpm (Normally considered full throttle). Running the engine at lower rpm's will result in a decrease of compaction force and lower travel speed. It will create excessive "out-of-synch" vibrations resulting in poor compaction, manoeuvrability, excessive wear to the machine, and discomfort to the operator.

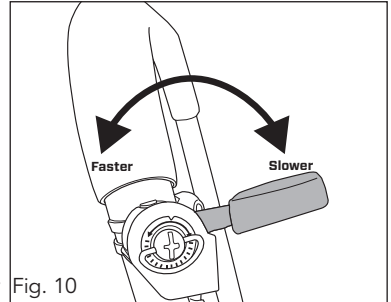

1. To increase the speed of the engine, move the throttle control (1) up.
2. To decrease the speed of the engine, move the throttle control (1) down.

Stopping the engine

1. Move the throttle lever (1) down to slow the engine speed and allow to idle for 10 seconds (fig. 10).
2. Turn the engine on/off switch to the off position (fig. 11)
3. Move the fuel lever fully to the left CLOSED/OFF position (fig. 12)

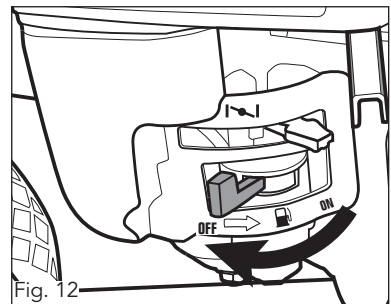
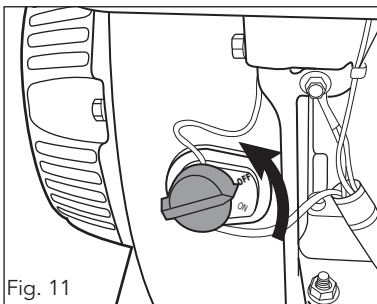

MAINTENANCE

Preventive maintenance

1. Turn off engine. Engine must be cool.
2. Inspect the general condition of the plate compactor. Check for loose screws, misalignment or binding of moving parts, cracked or broken parts, and any other condition that may affect its safe operation.
3. Remove all debris from the plate compactor with a soft brush, vacuum, or compressed air.
4. Clean the bottom of the compactor base as soon as it begins to pick up soil being compacted. The unit cannot do a good job if the bottom surface is not smooth and clean.



WARNING! Never use a "pressure washer" to clean your plate compactor. Water can penetrate tight areas of the unit and cause damage to spindles, pulleys, bearings, or the engine. The use of pressure washers will result in shortened life and reduce serviceability.

Changing the engine oil

1. While the engine is still warm, remove the oil fill plug (10) and then use a 17mm spanner to loosen the nut on oil drain hose (fig. 13). Be careful not to lose the rubber seal inside the nut.
2. Lower the drain hose into a suitable container to catch the used oil. Allow the oil to drain completely then reinstall the rubber seal and oil drain hose. Ensure it is secured properly.
3. Refill the engine sump with 600ml of recommended engine oil (refer to pg 11), then replace the oil fill plug (10).

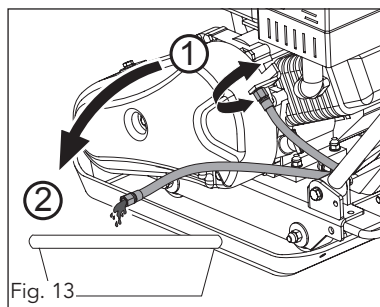

Changing air filter

1. Remove the air filter cover (4) by unscrewing and removing the wing nut, washer and cover.
2. Remove and inspect the filter. It must be intact and clean. If it isn't, either clean or replace the filter.
3. Replace the filter, filter cover, washer and secure with the wing nut.

Tensioning V-belt(s) fig. 14 & 15

Proper belt tension is critical to good performance. The normal deflection on each side should be 9mm (3/8") to 13mm (1/2") with moderate pressure from your thumb or finger.

Proper adjustment will assure long belt life. Too much or too little belt tension will cause premature belt failure.

1. Loosen the lock nuts B, leaving enough space between the nut and bracket.
2. Loosen 4 engine mount bolts (do not remove) only enough to move the engine forward.

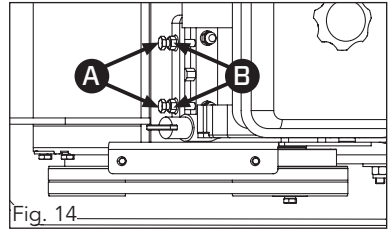

Note: Two of the engine mount bolts are not shown in fig. 15. They are located on the opposing side of the engine deck.

3. Push engine toward the back of the plate by turning the adjustment bolts A to remove any slack in V-belt(s).

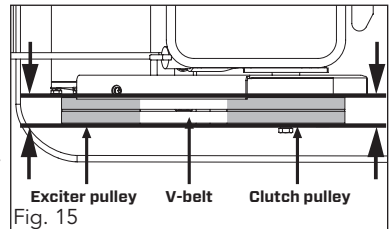

WARNING! When adjusting the belt(s), make sure that the clutch pulley is in alignment with exciter pulley.

4. Tighten the engine mount bolts.
5. When the V-belt tension is correct, tighten the lock nuts B against the bracket.
6. Replace the belt guard.

Note: If the adjustment bolts run out of adjustment, the belt(s) may have to be replaced.

MAINTENANCE (cont.)

Replacing V-belt(s) fig. 14 & 15

Only fit A725 V-belts to this plate compactor. This type of V-belt is available as a common spare part. Both V-belts should be replaced at the same time because they will wear evenly through normal use. Work on one belt at a time.

1. Loosen the lock nuts B and bolts A shown in above figure (fig. 15).
2. Loose 4 engine mount bolts (do not remove) only enough to move the engine forward.
3. Slide the engine toward the front of plate and slip the old V-belt(s) off of the pulley and install the new V-belt(s) in their place.
4. Position the V-belt(s) over the engine pulley.
5. Move the engine back.



WARNING! When adjusting the belt(s), make sure that the clutch pulley is in alignment with exciter pulley.

6. Check the V-belt tension by squeezing them in the centre. The normal deflection on each side should be 9mm (3/8") to 13mm (1/2") with moderate pressure from your thumb or finger.
7. When the V-belt tension is correct, tighten the engine mount bolts and the lock nuts B.
8. Replace the belt guard.



WARNING! When removing or installing the drive belt(s), be careful not to get your fingers caught between the belt and pulley.

MAINTENANCE (cont.)

Exciter lubrication

The exciter housing is pre-serviced using Automatic Transmission Fluid Dextron III, Mercon, EXXON (ESSO) NUTO H-32 or its equivalent. Change fluid after 200 hours of operation.

1. Let exciter (9) cool before changing exciter oil.
2. Remove the belt guard and V-belt(s).
3. Loosen the bolts that hold the engine deck (6) to the compacting plate (7).
4. Lift the engine deck (6), with the engine attached, from the compacting plate (7) (fig. 16).

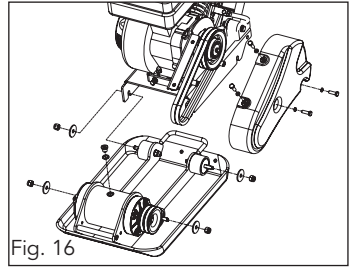

5. Remove the drain plug from the top of the exciter housing (9). Tilt the compacting plate (7) upside down so oil can drain from the exciter housing. Examine oil for metal chips as a precaution to future problems. (fig. 17)
6. Return compacting plate to the upright position.

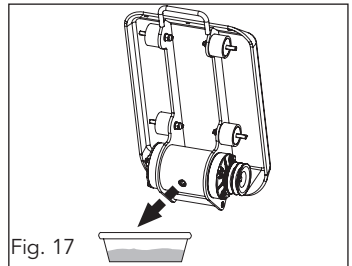

7. Fill the exciter housing (9) with the recommended exciter oil. (150ml capacity) (fig. 18)

WARNING! Do not overfill - overfilling can result in excessive temperatures in the exciter.

8. Apply pipe sealant to drain plug and reinstall into top of exciter housing.
9. Reinstall engine deck (12), V-belt(s) and belt guard. Ensure all bolts are fully tightened.

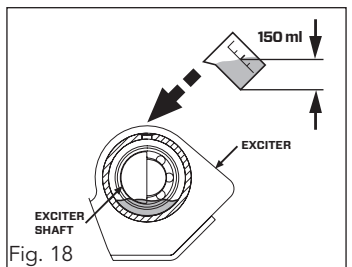

MAINTENANCE (cont.)

Spark plug

When the engine will not start and everything has been checked, it is likely the spark plug will need replacing. The spark plug is not covered under warranty.

To replace or clean the spark plug:

1. Remove the spark plug lead.
2. Using a spanner (not included), remove the spark plug.
3. Clean the electrode with a metal brush and remove any carbon build-up.
4. Using a thickness gauge (not included), check for the right gap (0.6-0.8mm) between the centre electrode and side electrode.
5. Refit the spark plug and tighten with a spanner.

Note: Ozito Industries will not be responsible for any damage or injuries caused by the repair of the plate compactor by an unauthorised person or by mishandling of the grinder

Spare Parts

Limited spare parts are available subject to availability. Please contact your local Bunnings Special Orders Desk to order the required spare parts.

STORAGE

If the plate compactor will not be used for a period longer than 30 days, following the steps below to prepare your unit for storage.

1. Drain the fuel tank completely. Stored fuel can start to go stale in 30 days. Stale fuel has high gum content and can clog the carburettor and restrict fuel flow.
2. Start the engine and allow it to run until it stops. This ensures no fuel is left in the carburettor. Run the engine until it stops. This helps prevent deposits from forming inside the carburettor and possible engine damage.
3. While the engine is still warm, drain the oil from the engine. Refill with fresh oil.
4. Allow the engine to cool. Remove the spark plug and put 60 ml of SAE-30 of high quality motor oil into the cylinder. Pull the starter rope slowly to distribute the oil. Replace the spark plug.



WARNING! Remove the spark plug and drain all of the oil from the cylinder before attempting to start the engine after storage.

5. Use clean cloths to clean off the outside of the compactor and to keep the air vents free of obstructions



WARNING! Do not use any strong detergents or petroleum based cleaners when cleaning plastic parts. Chemicals can damage plastics.

6. Release handle lock lever (14) from handle and carefully fold the upper handle down. Do not allow control cables to become pinched or bent.
7. Store your plate compactor in upright position in a clean, dry building that has good ventilation

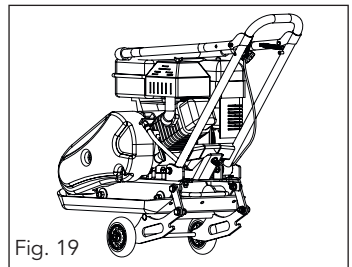

Fig. 19



WARNING! Do not store compactor with fuel in a non-ventilated area where fuel fumes may reach flame, sparks, pilot lights or any ignition sources. Use only approved fuel containers.

TRANSPORTING

To avoid burns or fire hazards, let engine cool before lifting / transporting machine or storing indoors.

The unit can be lifted by the handles in front (8) and back of the unit as shown (fig. 20).

The unit must be transported in the upright position to prevent fuel from spilling. Do not lay machine on its side or top.

Secure or tie down unit using the lifting handle to prevent machine from sliding or tipping over.

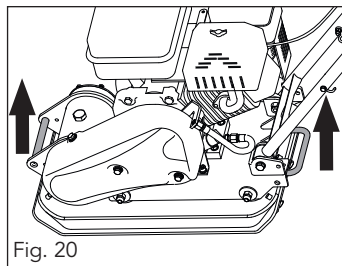

Fig. 20



WARNING! Plate compactor may fall and cause damage or injury if lifted incorrectly. Lift using handles at base of plate. Take care when lifting as the plate compactor is heavy a 2 person lift is recommended.

TROUBLESHOOTING

Problem	Possible Cause	Suggested Solution
Engine fails to start.	Throttle control lever not in correct starting position	Move throttle control lever to start position
	Choke not in ON Position	Throttle must be positioned at choke for a cold start
	Engine flooding.	Wait a few minutes to restart, but do not use choke
	Oil level is too low	Fill engine sump with oil to maximum capacity (600mL).
	Spark plug wire disconnected.	Attach spark plug wire securely to spark plug.
	Out of fuel or stale fuel.	Fill with clean, fresh fuel.
Engine runs erratically.	Unit running on CHOKE.	Move choke lever to OFF.
	Dirty air cleaner.	Clean or replace air cleaner.
Engine overheats.	Engine oil level low.	Fill crankcase with proper oil.
	Dirty air filter.	Clean or replace air filter.
Compactor is difficult to control when pounding (machine jumps or lurches forward)	Too high engine speed on hard ground.	Set the throttle lever at lower speed.

CARING FOR THE ENVIRONMENT







Power tools that are no longer usable should not be disposed of with household waste but in an environmentally friendly way. Please recycle where facilities exist. Check with your local council authority for recycling advice.



Recycling packaging reduces the need for landfill and raw materials. Reuse of recycled material decreases pollution in the environment. Please recycle packaging where facilities exist. Check with your local council authority for recycling advice.

DESCRIPTION OF SYMBOLS

mm	Millimetre	cm	Centimetre
cc	Cubic centimetre	db	Decibel
/min	Revolutions or reciprocation per minute	vpm	Vibrations per minute
hp	Horse Power	kN	KiloNewton
	Read instruction manual		Warning
	Wear eye and ear protection		Wear gloves
	Regulator compliance mark		

CONTENTS

- 1 x Plate compactor
- 1 x Trolley wheel assembly
- 1 x Handle assembly
- 1 x Paving pad kit
- 1 x Spark plug (spare)
- 1 x Air filter (spare)
- 6 x M10 x 30 Bolt & nut (fitting paving pad)
- 2 x M10 x 30 Bolt, nut & washer (fitting trolley wheel assembly)
- 2 x M10 x 65 Bolt, nut & washer (fitting handle assembly)

Note. The manufacturer's liability shall be deemed void if the machine is modified in any way and the manufacturer shall therefore accept no liability for any damages arising as a result of modifications.

Distributed by:
Ozito Industries Pty Ltd

AUSTRALIA (Head Office)

1-23 Letcon Drive, Bangholme Victoria, Australia, 3175

Telephone: 1800 069 486 AUS

WARRANTY

YOUR WARRANTY FORM SHOULD BE RETAINED BY YOU AT ALL TIMES. IN ORDER TO MAKE A CLAIM UNDER THIS WARRANTY YOU MUST RETURN THE PRODUCT TO YOUR NEAREST BUNNINGS WAREHOUSE (see www.bunnings.com.au or www.bunnings.co.nz for store locations) WITH YOUR BUNNINGS REGISTER RECEIPT. PRIOR TO RETURNING YOUR PRODUCT FOR WARRANTY PLEASE TELEPHONE OUR CUSTOMER SERVICE HELPLINE:

**Australia 1800 069 486
New Zealand 0508 069 486**

TO ENSURE A SPEEDY RESPONSE PLEASE HAVE THE MODEL NUMBER AND DATE OF PURCHASE AVAILABLE. A CUSTOMER SERVICE REPRESENTATIVE WILL TAKE YOUR CALL AND ANSWER ANY QUESTIONS YOU MAY HAVE RELATING TO THE WARRANTY POLICY OR PROCEDURE.

1 YEAR WARRANTY

Your product is guaranteed for a period of **12 months from the original date of purchase**. If a product is defective it will be repaired in accordance with the terms of this warranty. Warranty excludes consumable parts, for example: wheels, bearings.

The benefits provided under this warranty are in addition to other rights and remedies which are available to you under law. The warranty covers manufacturer defects in materials, workmanship and finish under normal use.

Our goods come with guarantees that cannot be excluded under Australian Consumer law & Consumer Guarantees Act 1993 (NZ). You are entitled to a replacement or refund for a major failure and to compensation for other reasonably foreseeable loss or damage. You are also entitled to have the goods repaired and replaced if the goods fail to be of acceptable quality and the failure does not amount to a major failure.

WARRANTY EXCLUSIONS

The following actions will result in the warranty being void.

- If the tool has been operated on a supply voltage other than that specified on the tool.
- If the tool shows signs of damage or defects caused by or resulting from abuse, accidents or alterations.
- Failure to perform maintenance as set out within the instruction manual.
- If the tool is disassembled or tampered with in any way.
- The warranty excludes damage resulting from product misuse or product neglect.

This warranty is given by Ozito Industries Pty Ltd.

ABN: 17 050 731 756

Ph.1800 069 486

Australia/New Zealand (Head Office)
1-23 Letcon Drive, Bangholme, Victoria, Australia 3175