

Mondella

Concerto

Ultra Bidet Smart Seat

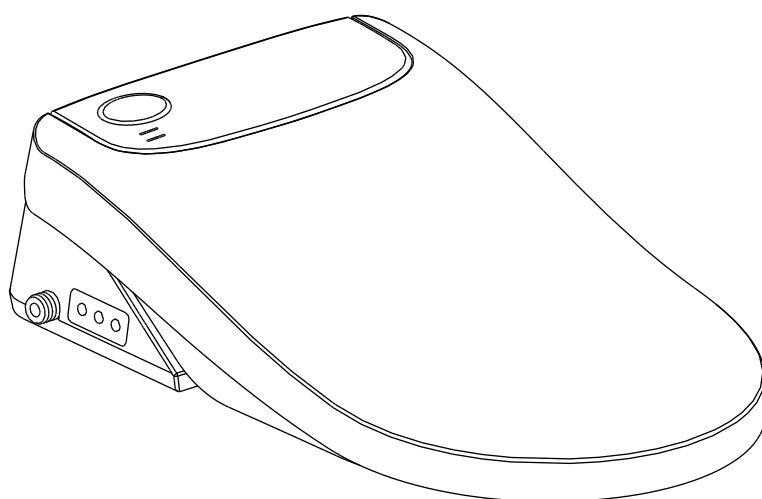

| | |
|--------------------------|------------|
| Rated voltage | 220-240V~ |
| Rated frequency | 50-60Hz |
| Rated power | 1050-1250W |
| Waterproof | IPX4 |
| Anti-electric shock TYPE | TYPE I |

www.mondella.com.au

Support and Technical Advice
E: supportau@fgi-industries.com

USER GUIDE & INSTALLATION MANUAL

Content

Before Use

| | |
|-------------------------|----|
| Safety Instructions | 01 |
| Technical Specification | 03 |
| Packaging Contents | 04 |
| Product Overview | 05 |

Installation

| | |
|--|----|
| Installation Instructions | 06 |
| 1. Product dimensions | |
| 2. Installation of mounting plate | |
| 3. Installation and disassembly of smart toilet seat | |
| 4. Connecting the water supply pipe | |
| 5. Installation of the remote control | |

Instructions for Use

| | |
|---|----|
| Preparation Before Use | 09 |
| Auto Open/Close Seat Function | 10 |
| Seat Functions | 11 |
| 1. Seat control functions | |
| 2. Remote control functions including LED display | |

Maintenance

| | |
|--|----|
| Maintenance | 17 |
| 1. Main unit maintenance | |
| 2. Spray nozzle maintenance | |
| 3. Inlet filter cleaning | |
| 4. Tank anti-freezing and anti-bacterial maintenance | |
| Troubleshooting Guide | 19 |

This product must be installed in accordance with all local, State and National Standards and Regulations, by qualified and licensed trades. To ensure your safety and best user experience, please read this manual thoroughly prior to using the bidet seat. The illustrations in this manual are indicative only, please refer to the physical product.

IMPORTANT SAFETY INFORMATION

This smart toilet seat is not to be used by persons (including children) with reduced physical, sensory or mental capabilities, or with lack of experience and knowledge, unless they have been given supervision or instruction concerning use of the appliance in a safe way and understand the hazards involved. Cleaning and user maintenance must not be carried out by children.

! READ ALL INSTRUCTIONS BEFORE USING



DANGER –To reduce the risk of electrocution:

1. Do not use while bathing or splash water or other liquids on the smart toilet seat at any time.
2. Do not place or store product where it can fall or be pulled into a tub or sink.
3. Do not place in, or drop into water or other liquid.
4. Do not reach for a product that has fallen into water. Unplug immediately.
5. Do not wash the main unit or electrical plug with water, detergent or any liquid.
6. Do not handle the electrical plug with wet hands.
7. Do not put a hand or anything else over the air dryer outlet or block the outlet of the air dryer.
8. Never disassemble, repair or modify this product.
9. During installation, disassembly, repair and maintenance of the product, the power plug must be switched off and removed and water supply shut off.



WARNING –To reduce the risk of burns, electrocution, fire, or injury to persons.

1. Close supervision is necessary when this product is used by, on, or near children or any person with reduced physical, sensory or mental capabilities, or with lack of experience and knowledge.
2. Use this product only for its intended use, as described in this manual. Do not use attachments that are not recommended by the manufacturer.
3. Never operate this product if it has a damaged cord or plug, if it is not working properly, if it has been dropped or damaged, or dropped into water. Do not repair, contact Customer Support.
4. Keep the cord away from heated surfaces.
5. Never use while sleeping or drowsy.
6. Never drop or insert any object into any opening or hose.
7. Do not use outdoors or operate where aerosol (spray) products are being used or where oxygen is being administered.
8. Connect this product to a properly grounded outlet only. See Grounding Instructions.
9. Do not throw cigarettes or any burning or combustible object into toilet, as this may cause fire.
10. This product is an electrical appliance, so it must be placed far away from water. The appliance must not come into contact with urine or be wet by cleaning agents or other liquids.
11. Do not lay smart toilet seat on side or upside down while the product is plugged in.
12. Do not use other electrical appliances in the same socket as the smart toilet seat, this may cause fire.
13. Do not use a power extension cord or an unstable loose power outlet to power the smart toilet seat.
14. Only install with the new hose supplied with this smart toilet seat to avoid the possibility of leakage, fire or electrical shock. Only install with supplied components.

IMPORTANT SAFETY INSTRUCTIONS



CAUTION – Indicates that failure to follow these instructions may cause injury or property damage.

1. Do not install or use the product in wet places such as a steam room etc.
2. Only use with potable water.
3. It is recommended to use a waterproof electrical outlet which must be installed in a safe place that will not get wet and in accordance with local, State and National regulations.
4. This product should be used with 220V-240V, 50/60Hz electrical current only, load current is at least 10A. Power plug must be equipped with ground fault circuit interrupter or ground fault electrical leakage protector or similar high sensitive, rapid type leakage switch (Rated sensitive current under 10mA).
4. During a thunderstorm, it is strongly recommended to remove the power plug from power outlet.
6. Do not stand on ceramic toilet.
7. Ceramic toilet must be installed with floor fixing bolts.
8. Do not stand on smart toilet seat (including children) or place heavy items on smart toilet seat.
9. Do not lean against the seat lid when using the product, this may damage the seat lid.
10. This product is equipped with a soft-closing seat. Heavy pressing or pushing may damage the soft-close damper.
11. Do not use lacquer, thinner, petrol, alcohol, detergent, insecticide, toilet cleaner or a scrubbing brush to clean the product.
12. Do not expose seat to direct sunlight.
13. Do not connect water supply to heater outlet. Make sure inlet water temperature is between 4-35°C
14. When the room temperature is less than 4°C, please drain the water to avoid water freezing in smart toilet seat or hose.
15. Where possible, increase room temperature to prevent the toilet from being damaged due to freezing.
16. When moving the product from a cold or humid environment into normal room temperature, wait for 2 hours until condensation has fully evaporated. Doing so can prevent the product from an electrical short-circuit.
17. When not using the product for over three (3) days, drain the water from tank and pull the electrical plug from the power outlet.
18. If product malfunctions, stop using immediately, shut off power and contact Customer Support.

GROUNDING INSTRUCTIONS

This product must be installed in accordance with relevant local, State and National Standards and Regulations, by qualified and licensed trades.

This product should be grounded. In the event of an electrical short circuit, grounding reduces the risk of electric shock by providing an escape wire for the electric current. This product is equipped with a cord containing a grounding wire with a grounding plug. The plug must be plugged into an outlet that is properly installed and grounded.





DANGER – Improper use of the grounding plug can result in a risk of electric shock.

This product is factory equipped with a specific electric cord and plug to permit connection to a proper electric circuit. Make sure that the product is connected to an outlet having the same configuration as the plug. No adapter should be used with this product. Do not modify the plug provided — if it will not fit the outlet, have the proper power outlet installed by a qualified electrician. If the product must be reconnected for use on a different type of electric circuit, the reconnection must be made by a licensed and qualified electrician only.

TECHNICAL SPECIFICATION

| | | Mondella Concerto Ultra Bidet Seat | |
|---------------------------|--------------------------|---|------------|
| Main Unit | Rating pressure | 220 - 240V, 50/60Hz | 230V, 50Hz |
| | Rating power | 1050 - 1250W | 1150W |
| | Water pressure range | Minimum water pressure 0.07MPa (20L/min. flowing pressure). Maximum water pressure 0.8MPa (Hydrostatic pressure) | |
| | Electrical Cord | Approx 1.5m length | |
| Cleaning Device | Container capacity | 400ml | |
| | Heating power | 1000W | |
| | Water temperature | 6 levels | |
| | Water flow | 5 levels | |
| | Cleansing mode | Rear cleaning and front/feminine cleaning | |
| | Spray cleansing location | 5 positions | |
| | Water pressure protector | Pressure stabiliser, Automatic pressure discharging | |
| | Anti-fail devices | Fast water discharge device, Automatic nozzle cleaning, Anti-siphon device, Anti-backflow device (not high hazard), Filter device | |
| | Safety devices | Temperature controller, Thermal fuse, Ground protection, Air burning preventer | |
| Drying Device | Warm wind speed | Over 4m/s | |
| | Warm wind temperature | 6 levels | |
| | Heating power | 250W | |
| | Safety device | Temperature sensor, Temperature controller, Thermal fuse | |
| Heated Sensor Seat | Surface temperature | 6 levels | |
| | Heating power | 50W | |
| | Open/Close seat function | Auto open and close, soft close seat | |
| | Heat burning protection | The seat temperature will automatically lower to level 1 after 10 minutes of user being seated. | |
| | Safety device | Seat sensor, Temperature sensor, Temperature controller, Thermal fuse | |
| Intelligent | Night light | Intelligent, often in the off state | |
| | User ID setting | To avoid interference from multiple Ultra Smart Seats in residence. | |

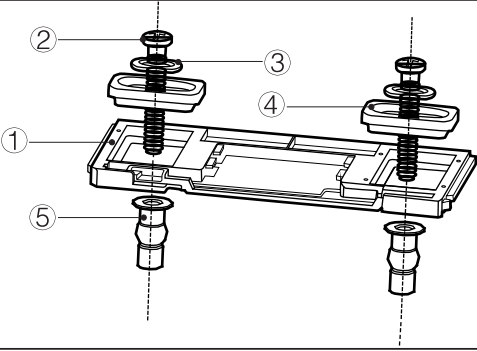
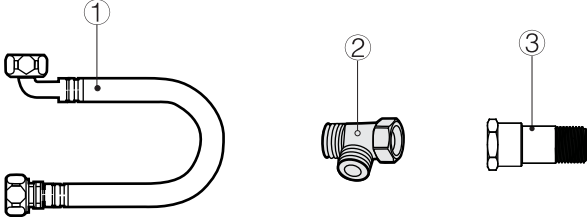
PACKAGING CONTENTS

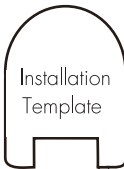
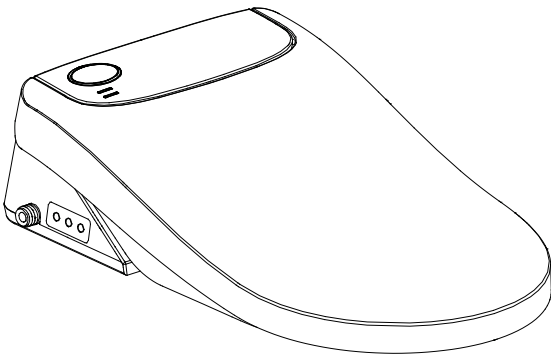
| | | |
|---|----------------------------------|---|
| Remote Control & Holder | Remote Control & Holder |  |
| Mounting Plate & Parts | ① Base plate |  |
| | ② Bolt (2 pcs) | |
| | ③ Flat Washer (2 pcs) | |
| | ④ Plastic Plate (2 pcs) | |
| | ⑤ Expansion Bolt (2 pcs) | |
| Water Supply | ① Hose (1 pc) |  |
| | ② T Valve (1 pc) | |
| | ③ Dual Check Valve (1 pc) | |
| Installation Manual & Template | User Guide & Installation Manual |   |
| | Installation Template | |
| Smart Toilet Seat | |  |

PRODUCT OVERVIEW

PLEASE NOTE
This product must be installed in accordance with all relevant local, State and National Standards and Regulations, by qualified and licensed trades.

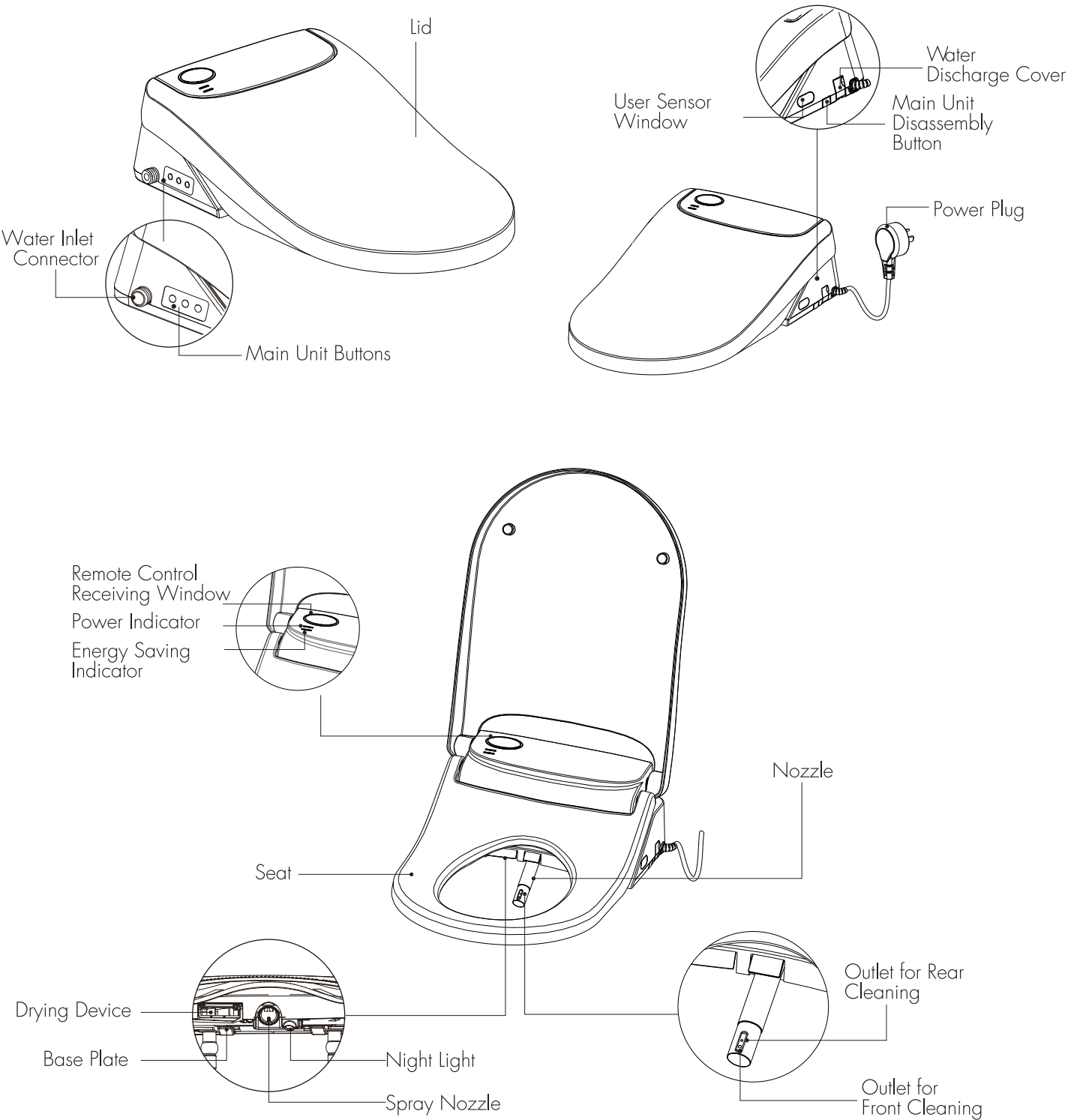

INSTALLATION INSTRUCTIONS

Product Dimensions

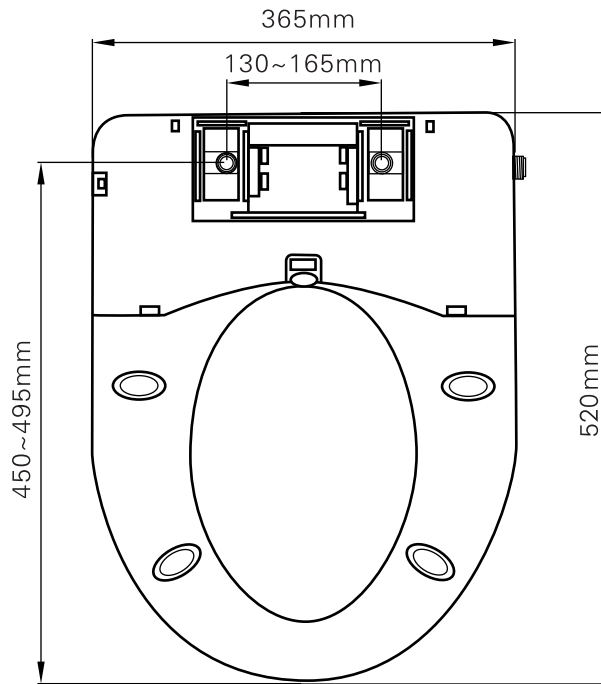

Installation of Base Plate

Unfold the installation template, align the template with the edge of the ceramic bowl to determine exact position to install the seat base plate. Place the base plate within the template to accurately proceed with the installation of the base plate.

Press the expansion bolts into the installation holes in top of pan, then install the base plate, plastic plates, flat washers and bolt as per the drawing below. Tighten the bolts.

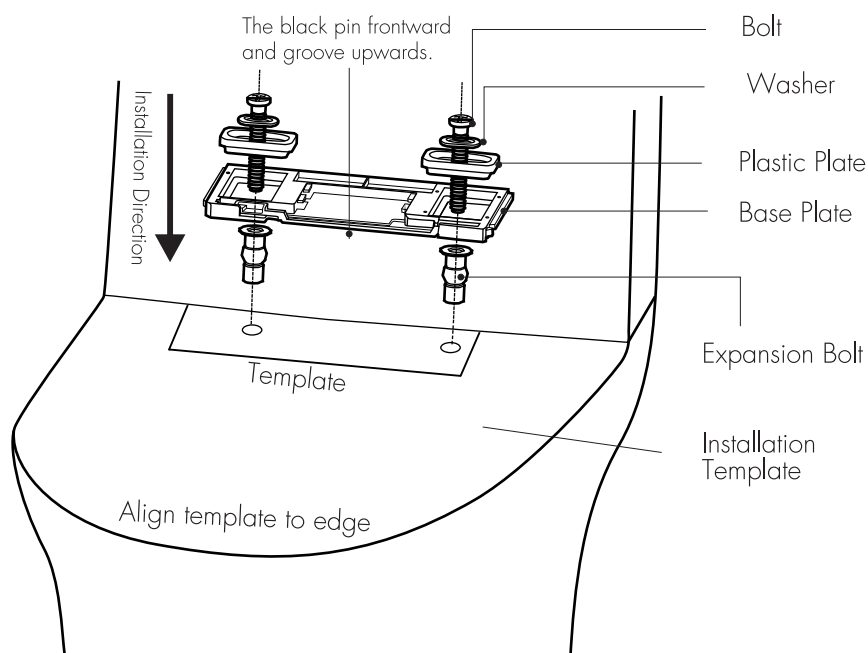

Installation and Disassembly of Smart Toilet Seat

Installation

Slide the seat back onto the base plate until a "click" is heard.

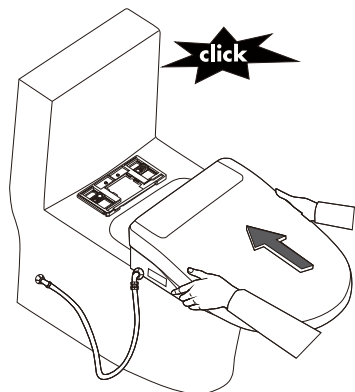

Installation

Disassembly

Press the "removal button" on seat, until a "click" is heard, and slide it out.

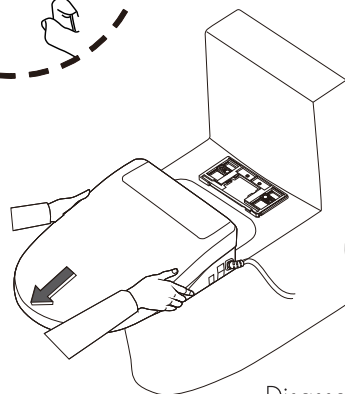
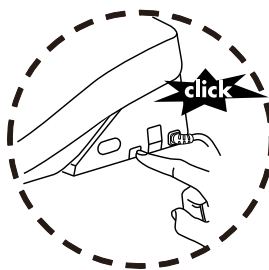

Disassembly

Note:

When disassembling unit, before pulling out the smart toilet seat, release hand from "disassembly button".

Connecting the Hose

1. Connect T valve to shut-off valve, then install high hazard backflow prevention device (not included). Install dual check valve as shown and then the bidet water supply hose. Finally, connect the toilet water supply hose to the T valve.

WARNING: A high hazard rating backflow prevention device is required as per AS/NZS 3500.1 It must be installed upstream of the smart bidet seat.

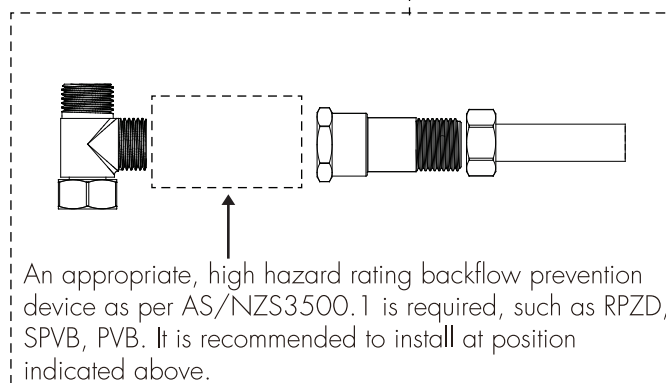
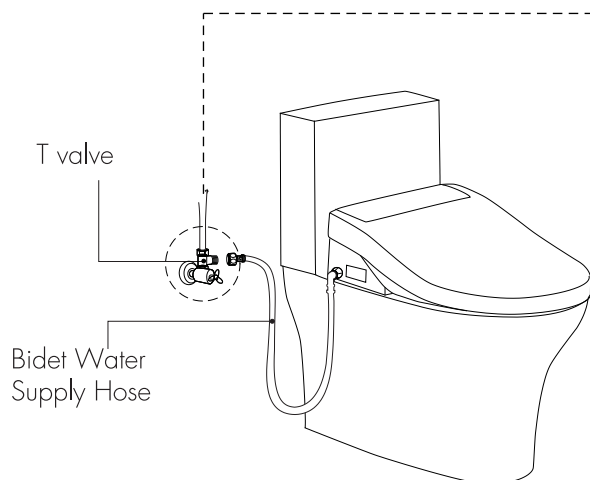

Note:

Do not distort or damage the water supply hose to avoid any leakage.

Use the new hose and T valve as supplied in this package.

Do not use old hose or accessories as these could damage the product and may be dangerous.

Installation of the Remote Control

Determine placement of remote control holder on wall. Ensure end-user is able to reach the remote control when seated.

1. Drill a hole of $\varnothing 6\text{mm}$ on the wall with a depth of 35mm.

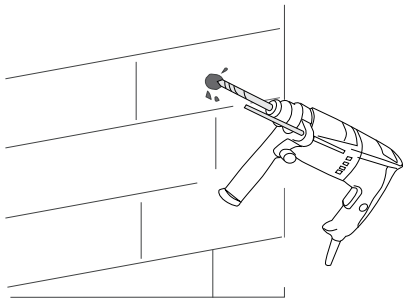

2. Remove strip from back of holder to expose double sided adhesive.

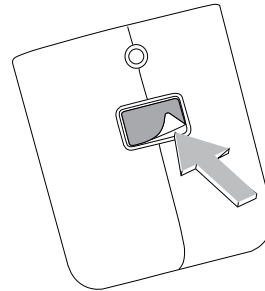

3. Insert wall plug into drilled hole in the wall and mount holder to the wall with screw. Adhere the double sided adhesive on holder by pressing to the wall, tighten the screw.

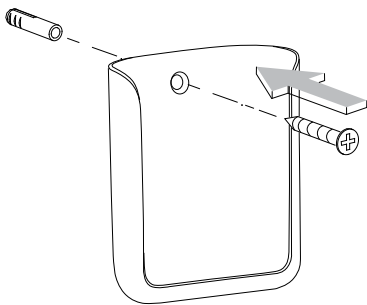

4. Install 2 x AAA batteries (not included) to remote control and place in holder.

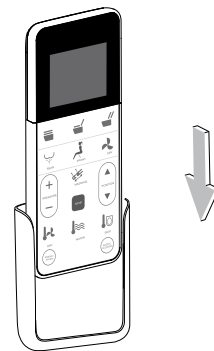

Notice: Please do not install and use the product in a moist space such as steam room. Do not install in area where remote can get wet.

PREPARATION BEFORE USE

Checking the power and water supply

1. Connect the water supply hose and turn on the valve. Check for any leakage.

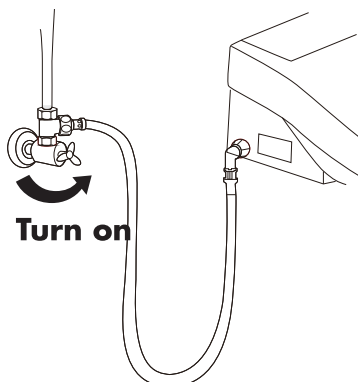

2. Plug unit into power outlet and the unit will power on.

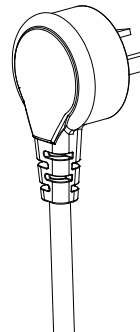

3. The main unit sounds a "click", the power light and energy saver light will flash. Power light on and energy saver light off means device is conducting a self-inspection.

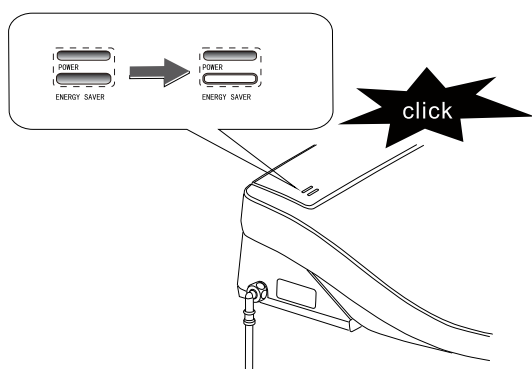

4. The unit sounds a second "click" to indicate that self-inspection has finished.

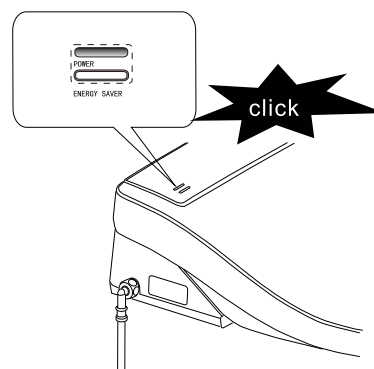

5. The water starts to flow into tank and heating will take 3 minutes.

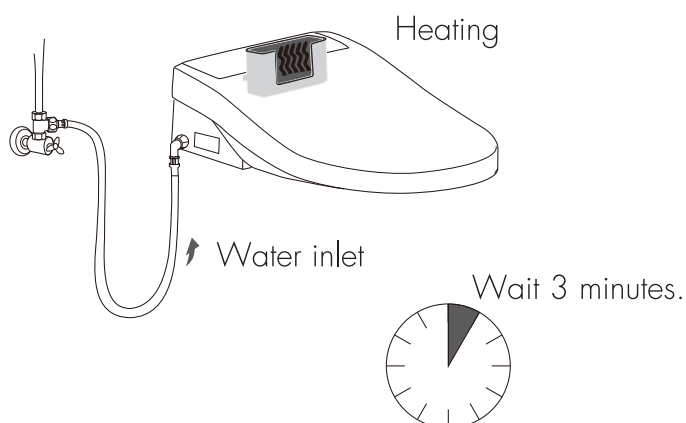

AUTO OPEN/CLOSE SEAT FUNCTION

The factory default for the auto open/close function is “closed”. Please ensure lid is in the closed position when operating open/close function by remote control for the first time.

Lid Auto Open with Sensor

When user approaches the seat, the user sensor window detects the user and the power and energy saver indicator lights up and the seat lid automatically opens.

Please Note: In warmer months when the room temperature is above 30°C, the temperature difference between user and surrounds will become smaller so the sensing window may not detect user. Please use remote control to open/close seat lid.

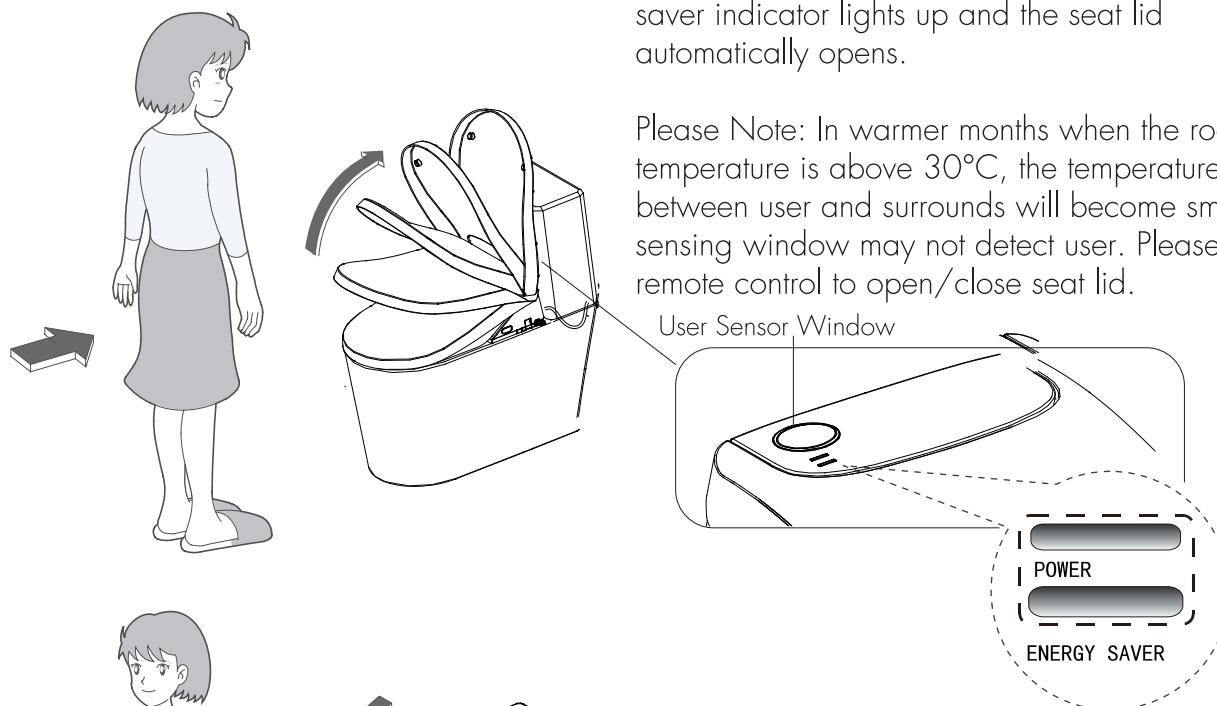

Seat Lid Close

The seat lid will automatically close 60 seconds after the user leaves the seat.

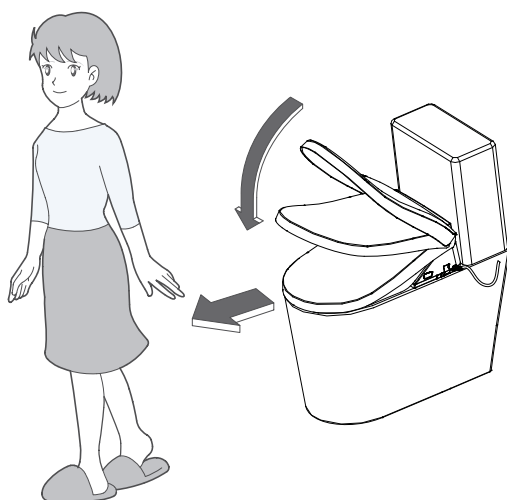

Open Seat Lid and Seat



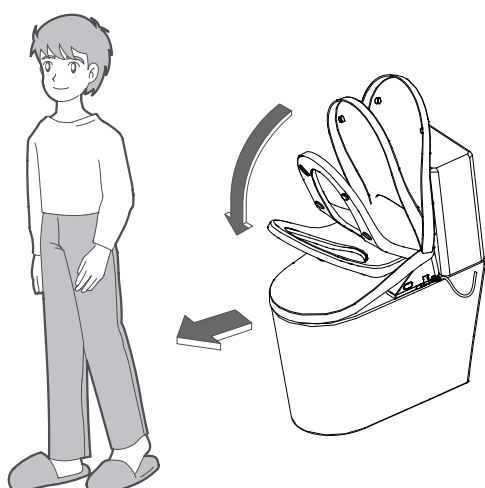

Open the seat by remote controller or hand. The lid and seat will be closed 60 seconds after the user leaves.

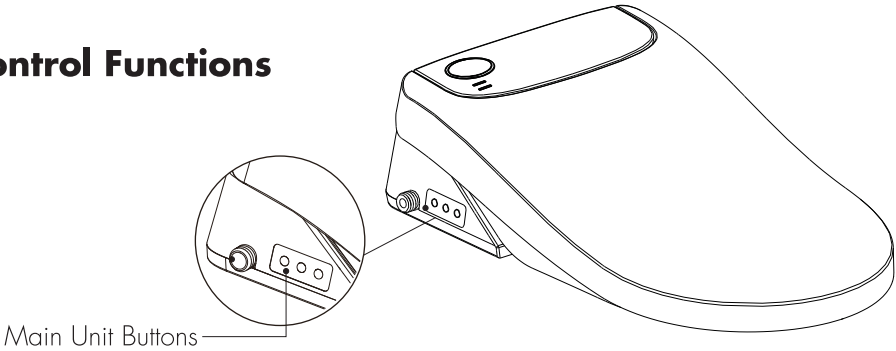

SEAT FUNCTIONS

Seat Control Functions



| | | |
|--|--|---|
|  |  Power | Connect the seat power supply to enter functional mode, the power light will be on. Press and hold "Power" button to enter standby mode and the power light turns off. A short press of the "Power" button will restore functional mode and the power light will turn on. In functional mode: When user is seated, a short press of the "Power" button will stop the function of rear clean, front clean or drying. When not in use, a short press of the "Power" button will enter Energy Saving mode and the Energy Saver light will turn on. Another short press of "Power" button will enter functional mode and power light will turn on. |
| |  Front Cleaning Button | User can activate front cleaning wash by pressing "Front Cleaning" button. Repressing the "Front Cleaning" button or "Power" button will cease this wash function. After a cycle, this function will finish automatically. If user continues to sit, the drying function will commence and will then stop after one cycle. |
| |  Rear Cleaning Button | User can activate rear cleaning wash by pressing "Rear Cleaning" button. Repressing the "Rear Cleaning" button or "Power" button will cease this wash function. After a cycle, this function will finish automatically. If user continues to sit, the drying function will commence and will stop after one cycle. When not in use, pressing "Rear Cleaning" button will extend wand to clean the nozzle and spray wand. |

Notes

When unit is in functional mode, the Power light turns on and Energy Saver light turns off. When in Energy Saver mode, the Power light turns off and Energy Saver light is on. When in Standby mode, both lights are off.

When unit is in Energy Saver mode and user is seated, the unit will automatically enter functional mode. The Energy Saver mode will be restored after use.

The default setting for above functions are mid level (temperature and water flow). Use the remote control to decrease or increase temperature or flow controls.

If the product is not in use for 72 hours, the water in the tank will automatically discharge for 90 seconds and then refresh with new water supply to avoid potential build up of bacteria.

Remote Control Functions Including LED Display

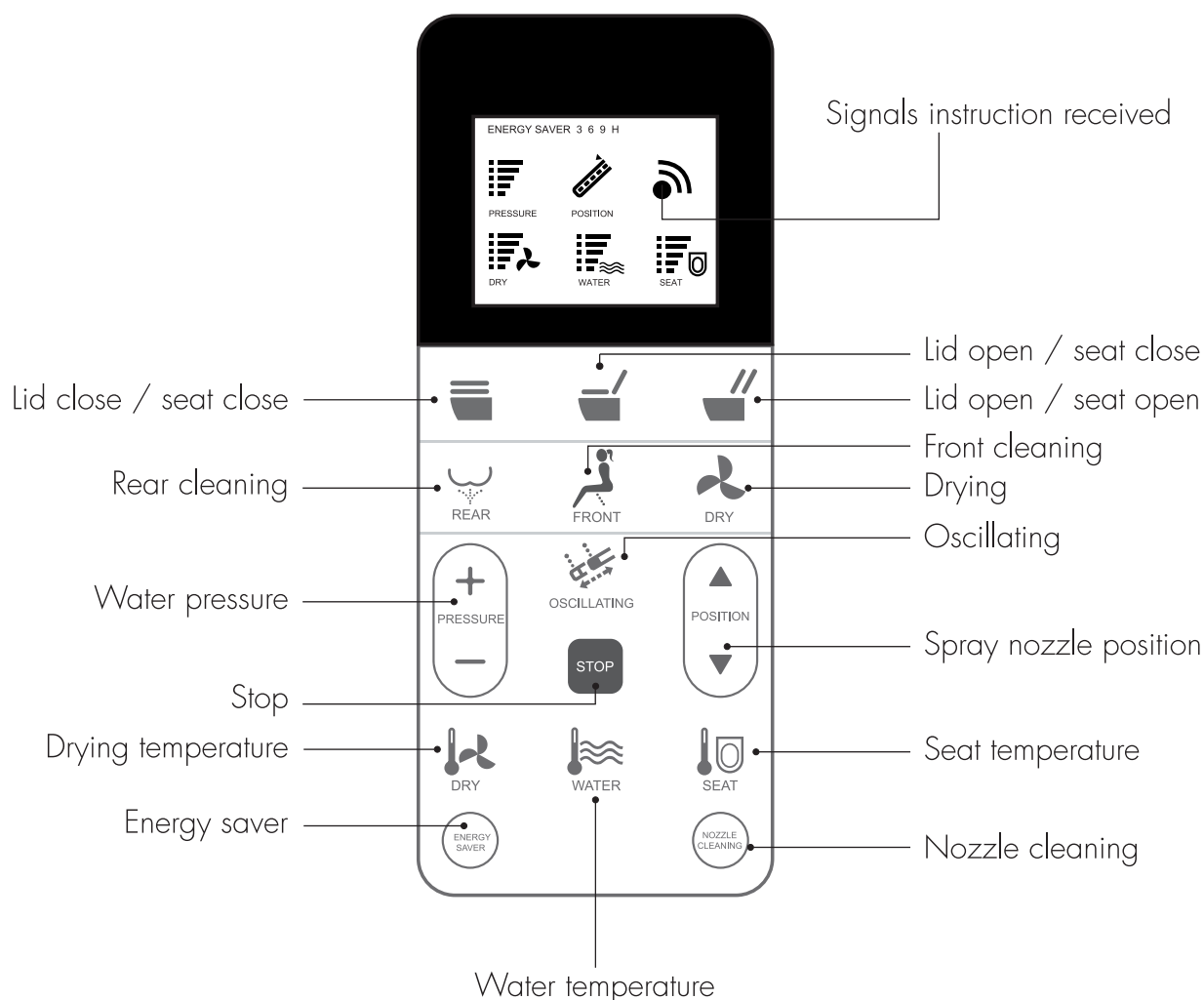

Auto lid open/close

Press "  " button to close seat lid.

Press "  " button to open lid and close seat.

Press "  " button to open lid and seat.

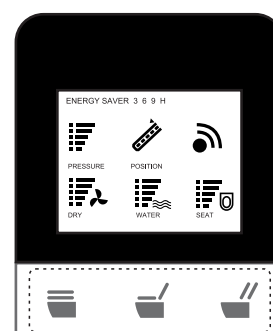

Press " STOP " button and hold it whilst pressing "  " button, it sets the mode of auto open/close. Repeat above action to stop this function.

(The default setting of auto open/close is in the off state, so it needs to be turned on at first use by pressing " STOP " and hold it whilst pressing "  " button.)

If the auto open/close function isn't functioning as it should, it can be reset by powering off (unplugging) and then powering on (plugging in). Then, press 'STOP' button and hold it whilst pressing lid open/seat open "  " button.

Rear / Front Cleaning

Press "REAR"/"FRONT" button, and the wand will extend accordingly and release water to clean the rear/front portion of body. The function will automatically stop after a cycle of cleaning. The "STOP" button can be pressed to cease function immediately.

Drying Function

Press "DRY" button to activate warm airflow for drying function. The drying function will stop after one cycle or will automatically stop when user leaves the seat.

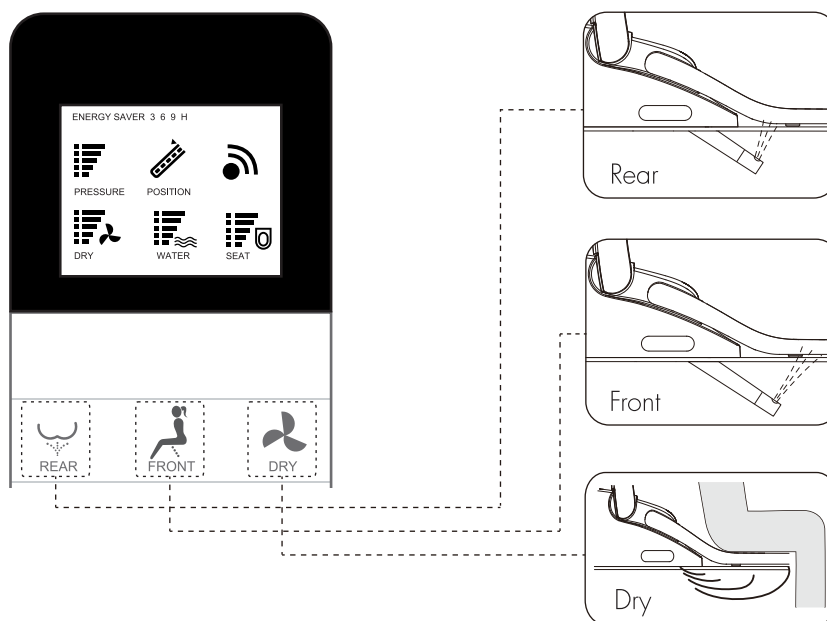

Oscillating Function

Press "OSCILLATING" button to activate oscillating function. The nozzle moves forward and back to extend the cleaning scope. Press "OSCILLATING" button again to stop the function.

Spray Nozzle Position Adjustment

During "REAR" or "FRONT" cleaning mode, use "POSITION" controls "▲" or "▼" to move the position of the wand forward or backward across 5 positions.

Water Pressure Adjustment

During "REAR" or "FRONT" wash mode, use "PRESSURE" controls "+" or "-" to adjust the water pressure across 5 levels.

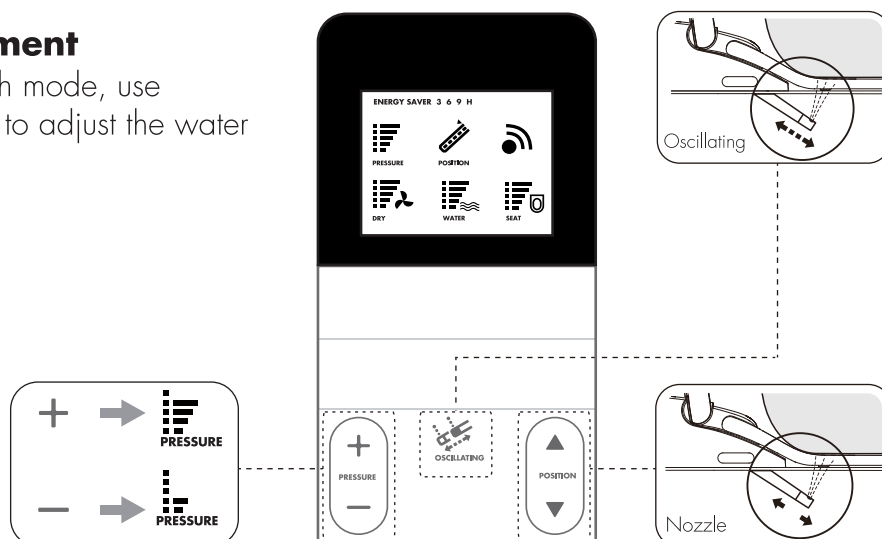

Temperature Adjustment

Drying Temperature Adjustment

Press "DRY" button to adjust temperature for drying.
The LCD display of 1 to 5 lines means level 1 to 5. NO display means normal temperature (this is the 6th setting).

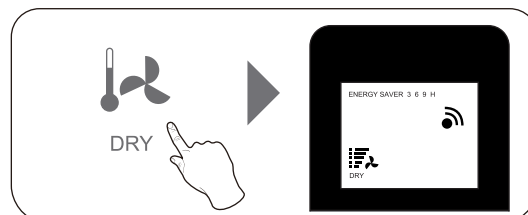

Water Temperature Adjustment:

Press "WATER" button to adjust temperature for rear and front cleaning.

The LCD display of 1 to 5 lines means level 1 to 5.
NO display means normal temperature (this is the 6th setting).

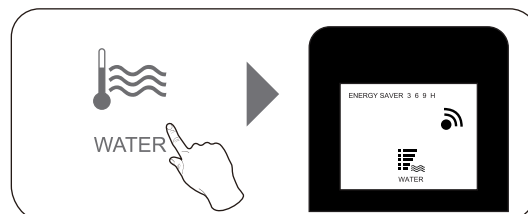

Seat Temperature Adjustment

Press "SEAT" button to adjust temperature of seat.
The LCD display of 1 to 5 lines means level 1 to 5.
NO display means normal temperature (this is the 6th setting).

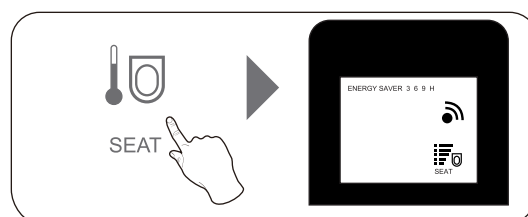

Energy Saver

Setting an energy saver time zone

Press "ENERGY SAVER" button and the LCD screen displays energy saver and time options. It shows three options of energy saver period as 3-6-9-off, which can be selected accordingly. For example, user can set from 9:00 to 15:00 as an energy saver zone by following these steps:

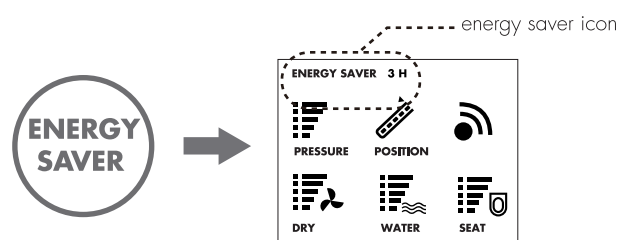

1. Press "ENERGY SAVER" button at desired time e.g. 9:00, LCD screen displays "ENERGY SAVER" icon.
2. Press "ENERGY SAVER" button again, LCD screen shows figure "6", and the "ENERGY SAVER" icon disappears after 3 seconds, the energy saver zone is now set. The toilet enters the energy saver mode from 9:00 to 15:00 every day. During this period, power light is off, and the energy saver light is on. It goes back to normal operation mode after energy saver time zone ends.

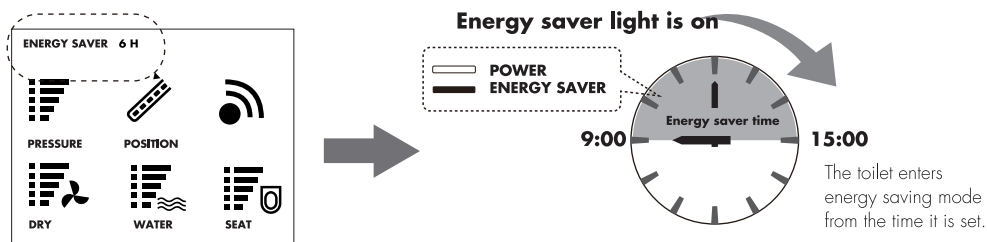

3. To cancel the energy saver setting: Press "ENERGY SAVER" button continuously until this function is cancelled. (Nothing displays on the screen.)
4. Change energy saver mode: Press "ENERGY SAVER" button, and select the new time frame, either 3H, 6H or 9H and leave it until "ENERGY SAVER" icon disappears.

The toilet will be under energy saver mode automatically after being set. Under energy saver mode, seat temperature is on low temperature status (first level) to achieve energy saver.

Please note: If user sits on the seat, the energy saver mode is paused, and the seat enters into functional mode, the seat starts to heat immediately (to previously selected seat temperature). The energy saver mode restores after the user leaves.

When the energy saver mode is set, the icon disappears automatically.

Nozzle Cleaning

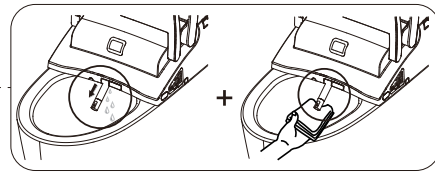

Nozzle Self-Clean & Wand Extension:

A short press of "NOZZLE CLEANING" button, will cause the nozzle to self-clean and then extend forward with no spray for manual cleaning. User may continue to clean nozzle manually.

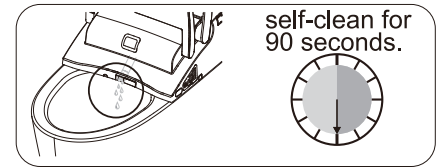

90 Second Nozzle Self Clean:

A long press of "NOZZLE CLEANING" button will result in a 90 second self-clean where the spray won't extend forward whilst the nozzle self-cleans.

Combination Button

Night Light

Pressing "STOP" button, then "DRY" button, the night light will be in the off state. Repeat the process for night light to switch to intelligent state. Repeating the above process will alternate the night light between off state and intelligent state.

Quiet mode

Press "STOP" button and then "OSCILLATING" button to turn off sound to avoid noise in the night; Repeat the process to restart sound function.

User Code

The user code needs to be set to avoid disturbance from remote controls when more than one Ultra Bidet Seat is used in a residence. Power on the smart toilet seat for setting the User Code and power off others in the residence.

1. Press "STOP" button and then "REAR" button to enter into User Code settings. The remote control shows only water pressure and spray position level, and characters will blink on the screen.
2. Press water pressure buttons of "+" and "-", to choose User Code 1-9.
3. Press "STOP" button and then "REAR" button again, remote control will save the setting and exit User Code setting window, the buzzer will ring "click" to indicate successful setting.
4. The sum of water pressure and position level on LCD is the user code. Restart to clear the User Code and reset.

Notes

1. When pressing a button on the remote control, the signal indicator on the LED display will flash which means the signal has been sent out. The smart seat sounds a "click", which means the main unit receives the signal and executes the instruction. If the signal indicator doesn't flash, the button is not efficiently pressed and needs to be re-pressed. If the buzzer does not sound, the main unit hasn't received the signal. Please regulate the remote control direction and re-press the button.
2. In the case of a power outage during wand's spray operation, the wand can not retract to its home position, please wait until the power is reset. In case of a power outage for a long period, please push the wand softly back by hand. Do not push hard to avoid damage to the wand and appliance.
3. When the body touches the seat and sounds a "click", front cleaning, rear cleaning and drying functions are ready. The nozzle will continue to spray for 1-2 seconds after user stands up during spray operation, so please press "STOP" button before standing up.
4. If a user presses "NOZZLE CLEANING", the wand will extend for manual cleaning. If the user leaves without pressing "NOZZLE CLEANER" or "STOP" button after cleaning to retract wand, the nozzle wand will automatically retract after 10 minutes or when a user next sits on the seat.

MAINTENANCE

Main Unit Maintenance

1. Shut off power supply for maintenance.
2. Wipe product with a soft damp cloth.
3. Open the seat, press the release button on the right side of the smart toilet seat and pull the seat forward. Clean under seat with a soft damp cloth.
4. After cleaning, reinstall the seat back to main unit as per instruction "Assembly and Disassembly" of smart toilet seat.

Note: Do not pour hot water on the product.

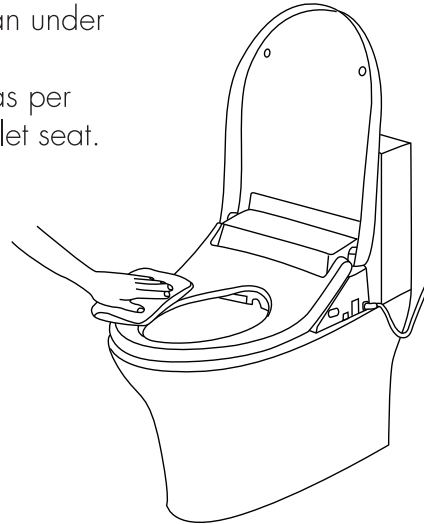

Spray Nozzle Maintenance

1. Press "NOZZLE CLEANING" button and wand will extend out. Wipe the wand clean with a soft, damp cloth. Press "NOZZLE CLEANING" or "STOP" to retract wand.
2. Hold "NOZZLE CLEANING" button and the wand will not extend out. The nozzle will automatically spray to self-clean.
3. Press "NOZZLE CLEANING" button or "STOP" button and the nozzle will stop cleaning.

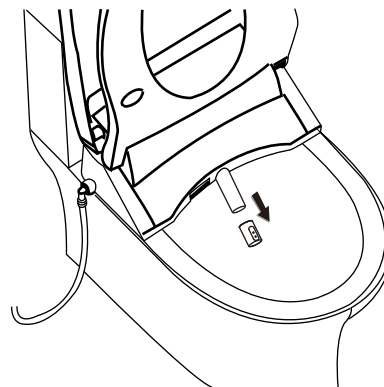
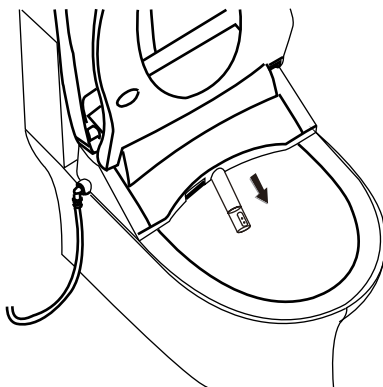

Notes

1. Do not apply force when pushing or pulling the wand as this may damage the mechanism.
2. Spray nozzle may be disassembled and cleaned.

Inlet Filter Cleaning

1. Pull out electrical plug, shut off water supply valve and remove water supply hose.
2. Remove the filter. Use a brush to clean the filter.
3. Put the filter back into inlet after cleaning and then connect the water supply hose.

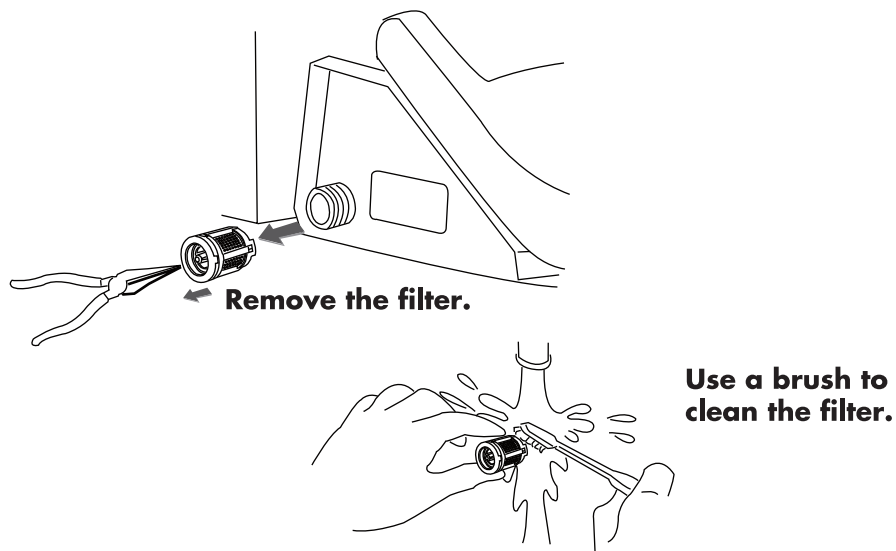

Tank Anti-Freezing and Anti-Bacterial Maintenance

When room temperature is under 4°C or electricity is disconnected, or user is away for a period of time, the water inside the tank should be discharged.

1. Open the tank cover, press the discharge button, turn on valve to discharge the water.
2. Lightly press the discharge button protruding part to turn off discharging valve and cover.

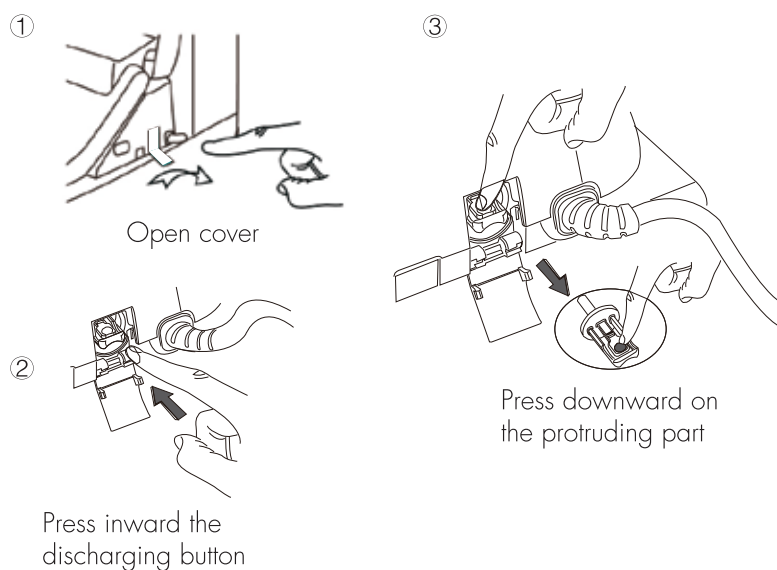

Note: Before discharging water, the power must be off.

TROUBLESHOOTING GUIDE

| Issue | Possible Cause | Solution |
|--|--|--|
| No wash function | Water supply hose has kinked causing a blockage | Resolve the kinked hose |
| | Fill valve is off | Turn on the fill valve |
| | Water supply is cut off | Connect water supply and wait for the water |
| Poor water flow | Water supply hose kinked causing partial block | Resolve the kinked hose |
| | Fill valve is not fully turned on | Turn on the fill valve fully |
| | Filter is dirty & causing blockage | Clean the filter |
| The water is not hot | The water temperature is set on normal temperature level | Reset the water temperature |
| | In standby mode or energy saver mode | Switch to function mode, and then wash after 3 minutes |
| Seat temperature is not hot | The seat temperature is set on normal temperature level | Reset the seat temperature |
| | In standby mode | Shift to function mode and allow 3 minutes to heat. |
| Wind temperature is not hot | The dryer temperature is set on normal temperature level. | Reset the dryer temperature |
| No air from dryer | In standby mode or energy saver mode | Shift to function mode to use dryer function |
| Spray wand will not retract | Power off | Push back the wand lightly and wait for the power |
| | Wand blocked by impurities | Clear away the impurities |
| Spray wand can not extend | Power off | Push back the wand lightly and wait for the power |
| | User not detected in sensing area | Reposition body to user detection sensing area |
| Remote Control Display not working | Batteries may need replacing | Replace the batteries |
|  Caution | If the problems cannot be resolved as per instructions above, please shut-off the power, and contact Customer Support. | |

