

## PLUMBERS INSTALLATION GUIDE JUMPER VALVE TAP SETS

### Basin Set

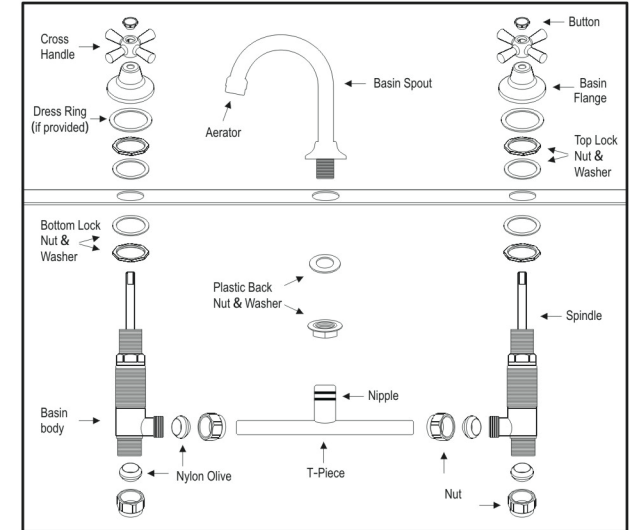

1. Assemble the t-piece into the basin bodies. Check the hole alignments with the basin/bench top. Un-assemble and cut the t-piece ends down to correct size if required.
2. Remove the top lock nuts and washers from the basin bodies.
3. Remove the plastic back nut and washer from the basin spout and place them loosely over the t-piece nipple. (washer on top)
4. Position the basin tee assembly into the vanity basin/bench top so the top threads of the basin bodies are accessible through the top. Bottom lock nuts can be lowered to suit.
5. Place the washer and lock nuts on the installed bodies and tighten. Tighten the bottom lock nuts up to bench level.
6. Push the basin spout down with a swiveling motion, locating it into the t-piece nipple. Once fully down be sure to centre the spout before tightening the plastic back nut.
- Note the copper t-piece can be bent up or down (within reason) to ensure the nipple is at the correct position inside the spout base.
7. Place the dress ring over each spindle. Note dress rings are not provided/required for chrome plated sets.
8. Install the basin flanges by threading them onto the spindle.
9. Install the cross handles by slotting them onto the spindle.
10. Screw the hot and cold button onto spindles, thus securing the handles.
11. Connect the hot and cold water lines to the basin bodies. If using flexible connectors, the bottom nuts and nylon olive fitted to the basin bodies will not be required.
12. Remove the aerator from the basin spout. Turn on the taps to flush out any fillings or debris from the pipes. Re-install the aerator. The aerator contains a water reducing flow device.
13. Check for leaks above and below bench level.



### Bath/Shower/Wall Top Assembly/Basin Top Assembly/Laundry Set/Wall Sink

1. Install the spindle by screwing it into the wall/basin. Ensure that the jumper valve & red fibre washer are installed correctly. Refer to image 1. Tighten firmly with a spanner.
2. Place the dress ring over each spindle. Note dress rings are not provided/required for chrome plated sets.
3. Install the wall flanges by threading them onto the spindle locking nuts.
4. Install the cross handles by slotting them onto the spindle.
5. Screw the hot and cold button onto spindles, thus securing the handles.
6. Check for leaks.
7. Bath/Shower/Wall Sink outlets - place a generous amount of thread tape lightly around the existing 1/2" threaded nipple in the wall prior to installing the outlet.
8. Screw the outlet into position, trying not to over tighten it in order to have the outlet in the desired vertical position.
9. Do not use shower arm or spout as a lever when tightening.

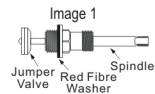

### Washing Machine Set



1. Place a generous amount of thread tape lightly around the existing 1/2" threaded nipple in the wall prior to installing the washing machine cocks.
2. Place the chrome back plate over the nipple then screw the washing machine cocks into position until tight. Use a shifter to gently tighten the bodies into the correct vertical position.
3. Install the flanges by threading them onto the spindle.
4. Install the handles by threading them onto the spindle.
5. Screw the hot and cold button onto spindles, thus securing the handles.
6. Check for leaks.

### Working Specifications:

In accordance with Australian standards requirements it is recommended that all tapware be installed by a licensed plumber. Please refer to the warranty card for service agreement.

- \* Hot and cold water inlet pressures should be equal.

Inlet pressure range: 150-1000 kPa

**NOTE** - New Regulation: ~ 500 kPa maximum operating pressure at any outlet within a building.

(Ref. AS/NZS 3500.1-2003, Clause 3.3.4)

- \* All pipework must be thoroughly flushed prior to installation, as foreign materials may block the flow regulating device and reduce the flow of water. Aerator insert housing must be retightened to prevent removal by hand.
- \* This tap set has a low flow rate and may not be suitable for connection to some Instantaneous Gas Water Heaters, some Tempering Valves, some Solar Water Heaters & some Thermostatic Mixing Valves. Check with the manufacturers of these products.
- \* Not recommended for gravity feed systems, tank water systems or bore water systems.
- \* Isolating stop taps must be fitted to the hot & cold water supply connections in accordance with local authority installation codes.

### CARING FOR YOUR PRODUCT

- \* Under no circumstances should you install tapware using acetone silicones.
- \* Never use harsh detergents or abrasive cleaners, as these will scratch the surface. Using a soft dry cloth or a soft cloth with warm soapy water is recommended.
- \* Where your tapware remains dry in use, a soft cloth can be used to remove surface dust. Alternatively, a wipe over with warm soapy water is all that is required to maintain the finish in perfect condition for a lifetime of use.
- \* Use of wax based furniture cream should be avoided as these can result in a build up of deposits, which could detract from the appearance.
- \* Do not use undue pressure and wipe in one direction only.