

click®

BLADELESS AIR PURIFYING FAN

WITH REMOTE CONTROL



INSTRUCTION MANUAL

Item No : 0612567

IMPORTANT SAFEGUARDS

When using electrical appliances, in order to reduce the risk of fire, electric shock and/or injury, these basic safety precautions should always be followed:

SAFETY PRECAUTIONS

Read all instructions carefully, even if you are quite familiar with the appliance.

- To protect against the risk of electric shock, DO NOT IMMERSE power cord or plug in water or any other liquid.
- Do not throw the charger into fire and do not expose it to extreme heat. The charger could explode or burst.
- Do not use this product if it appears to be damaged.
- Use only the AC adaptor supplied with this product to recharge this product.
- This appliance is not intended for use by persons (including children) with reduced physical, sensory and mental capabilities, or lack of experience and knowledge, unless they have been given supervision or instruction concerning use of the appliance by a person responsible for their safety.
- Children should be supervised to ensure that they do not play with the appliance.
- Always unplug the unit when not in use.
- Do not operate unit with a damaged power cord or plug, or after a malfunction, has been dropped or is damaged in any manner. Return the unit to an authorised service facility for examination.
- This unit is not intended for use in bathrooms, laundry areas or similar moist indoor locations. Never locate the unit where it may fall into a bathtub or other water container.
- Do not run the power cord under carpeting or cover the power cord with throw rugs, runners or the like. Arrange the power cord away from traffic areas and where it will not be tripped over.
- Do not place the power cord over any part of the unit.
- Do not plug this unit into an extension lead, double adapter or power board.
- To disconnect the unit set main switch to OFF then remove the plug from the outlet.
- This unit has hot electrical parts inside. DO NOT use it in areas where gasoline, paint or flammable liquids are used or stored.
- Do not insert or allow foreign objects to enter any ventilation or exhaust opening as this may cause an electric shock, fire or could damage the unit.
- Use the unit only as described in this booklet. Any other use not recommended by the manufacturer may cause fire, electric shock or injury to persons.
- Fully remove the power cord from the power cord tidy before use. Always uncoil the power cord before applying power.
- This product must always be used AND STORED in the upright position.
- Do not use this unit with a programmer, timer or any other device that switches the unit on automatically, since a fire risk exists if the unit is covered or positioned incorrectly.
- Do not touch the power supply or power cord with wet hands.
- Unplug appliance when cleaning, removing/ replacing filter, or moving the device.
- Use indoor only.
- If it is necessary to move the unit after the water has been added, roll gently to the required position.
- Do not move the machine when it is in use.
- Do not block air circulation.
- Place the machine on a level surface.

- Unplug the appliance during cleaning.
- Do not touch the Ultrasonic vibration plate.
- Clean regularly as per Maintenance instructions to avoid malfunction.
- Always unplug from power supply before maintenance.
- Keep away from directing sunshine heat sources and air conditioners or fans.
- Always keep on stable flat surface do not place on carpet, duvet or unstable area.
- CAUTION: DO NOT COVER the appliance in any way in order to avoid overheating and fire.
- Do not run the cable under carpets, do not cover it with carpets or similar covers. Route the cable outside the traffic area to avoid tripping the cable.
- Turn off all controls before pulling the plug and pull the plug out of the socket if you are not going to use the device for a long time.
- Do not place any objects on the air inlet or outlet. Make sure that the ventilation openings are free of dust, lint, hair and other obstacles that could impair the air flow.
- The fan should be set up dry on a horizontal platform and should not be near heat sources, corrosive air and moisture. The fan should be kept a distance of 150 mm around to ensure good air circulation.

WARNING:

If the adaptor is damaged, the adaptor must be replaced by the manufacturer, its service agent or similarly qualified persons in order to avoid a hazard.

This product has not been designed for any uses other than those specified in this booklet.

SAVE THESE INSTRUCTIONS

FEATURES OF YOUR BLADELESS FAN WITH AIR PURIFIER

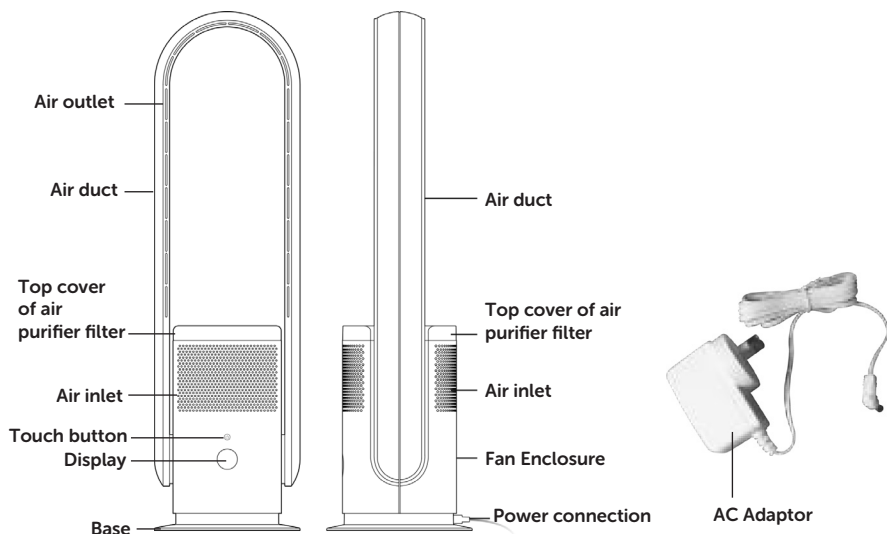

Product Specifications

AC Adaptor

Input voltage :100-240V AC, 50/60Hz 1.2Amax

Output voltage: 24V DC, 1.5A

Oscillation: $80^{\circ} \pm 5^{\circ}$

Power: 35W

Frequency: 50-60Hz

Timer: 1-8H

Scope of delivery contents : Fan assembly, power supply cord, remote control, operating instructions.

NOTE: As a result of continual improvements, the design and specifications of the product within may differ slightly to the unit illustrated on the packaging.

YOUR BLADELESS FAN AND AIR PURIFIER

Congratulations on the purchase of your new Bladeless Fan and Air Purifier.

Before first using your the appliance, it is most important that you read and follow the instructions in this use and care booklet, even if you feel you are quite familiar with this type of appliance.

Your attention is drawn particularly to the section dealing with IMPORTANT SAFEGUARDS. Find a place and keep this booklet handy for future reference.

This the appliance is fully portable, with sturdy base and a modern design.

OPERATION

1. Carefully remove the Fan from the plastic bag and carton.Place the Fan on a level surface in a stable upright position.
2. Connect the the adaptor plug into the socket on the Fan.
3. Unwind the power cord and Plug the mains plug of the adaptor into a Main power socket outlet(230-240V). Ensure that the voltage on the specifications plate is the same as in your home.
4. Switch on and off

Connect the power supply, the LED display lights up and the machine goes into standby mode. Click the appliance Power Button "⏻" to turn on the Fan, the buzzer will beep once and the fan will start. Press and hold the power button "⏻" for 2 seconds, the buzzer will beep twice and the fan will stop running after you release your finger.

5. Set the air volume

When the fan is operating: Click the button "⏻" to adjust the air volume from 1 to 9.

6. Oscillation

When the fan is operating, press and hold the screen touch button "⏻" for 1 second. The buzzer beep once and the fan starts to oscillate. Press and hold the screen touch button "⏻" again for 1 second. The buzzer beep once and the fan stops oscillating.

7. Air movement direction



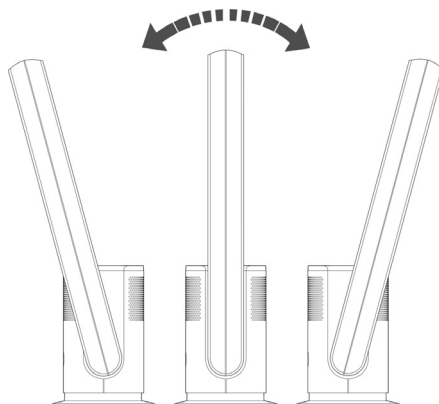

Adjust the fan head position after fan has stopped. Hold fan body with one hand and set the wind outlet 15° before and after. push fan head backwards or forwards maximum 15 Degrees to your desired direction.

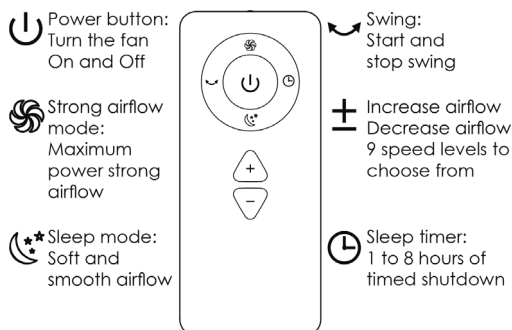

Warning: Only adjust the tilt angle after the fan has stopped operating. Do not tilt the fan head more than it is intended to. Doing so will damage the fan.

REMOTE CONTROL



-  The device can be switched on and off by pressing the "ON & OFF" button.
-  Press the "strong airflow mode" button on the remote control. The display will show "HH" and the airflow strength will increase. Press again to exit strong airflow mode. (You can also exit the current mode by pressing the "+ - "Exit button.)
-  Press the "Sleep mode" button on the remote control. The display shows "LL" and the airflow force is reduced. Press again to exit the night sleep mode. (You can also exit the current mode by pressing the "+ - "Exit button.)
-  Press the "Oscillation" button on the remote control to switch on the oscillating function. This fan can swing 80° left and right. Press this button again to stop oscillating process.
- + -** Press the "+" button on the remote control to increase the air volume. Press the "-" button to decrease the air volume. There are 9-speed settings.
-  Press the timer button on the remote control to set 1 to 8 hours. Press the timer button on the remote control, the display shows: "0" to cancel the timer. After the timer function is set, other functions can be used normally. When the device is turned off, the timing setting is also canceled.

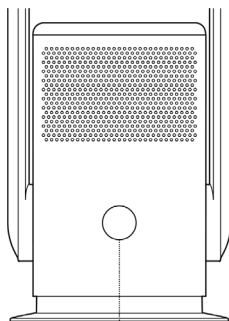

Signal receiver

The remote control should be pointed at the remote control signal receiver on the display to maximize the remote control signal.



Possible phenomenon

1. This fan may respond to the remote control of other devices.
2. If you use the remote control of this fan, other devices may respond.

This is due to the overlapping frequencies of the remote control.

There is no quality problem in the product itself. To avoid misuse, keep the remote control away from other electrical devices during operation.

Battery Replacing (For Remote Control)

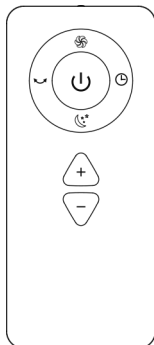

Battery installations:

Open the battery cover on the back of the Remote Control.

Insert two new AAA 1.5V alkaline batteries align with polarity indicator markings (+/-) inside the battery compartment.

Reattach the battery cover, making sure the locking tabs click into place.

Note: Make sure the batteries are installed correctly in the remote control by aligning the +/- polarity marking in the battery compartment with the batteries.

WARNINGS:

- Keep batteries out of children's reach.
- Use only alkaline batteries. Do not use rechargeable batteries.
- Do not use old and new or different types of batteries in combination. Do not use the remote if the batteries have leaked.
- Remove the batteries if they are discharged or if the remote control is not being used for a long period of time. Dispose of used batteries immediately.
- Battery must be recycled or disposed of properly. Do not dispose of battery in a fire, oven or near any flammable object as this may cause an explosion. Do not dispose of battery in regular trash, municipal waste stream or by fire as battery may leak or explode.

Always ensure to keep batteries out of reach from children when removing or replacing batteries in the remote control.

INSTALLATION

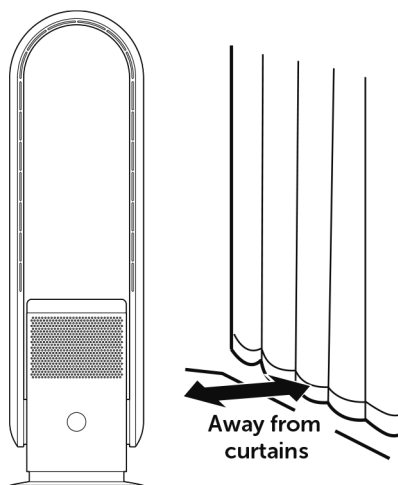

- Please use the fan on a flat platform. Do not place the fan in an unstable place, such as an inclined or soft surface, to avoid damage or malfunctions caused by the fan tipping over.
- Avoid blocking the air inlet when using. Keep away from the curtains to avoid objects blocking the air inlet and the fan not working.
- Do not place any objects within 30 cm of the air outlet, otherwise the blower effect will be impaired.

FILTER REPLACEMENT

This machine is equipped with an air cleaning filter.

Before using the fan, the filter should be installed in the fan so that the air can be cleaned.

Installation and replacement method of air cleaning filter:

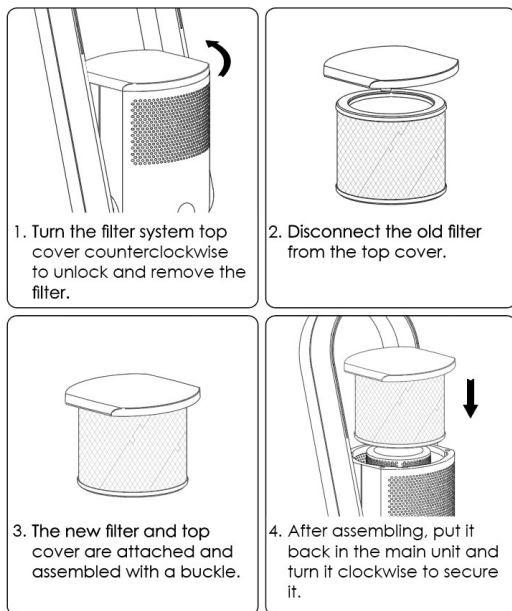

Auto reminder of Filter Replacing



- The fan has a memory function. After a total of 720 hours of operation, the display (as shown in the figure) lights up cycle indicator light when turned on, the buzzer sounds 5 times and the status is displayed after 5 seconds.
- After replacing the filter screen, the power button on the remote control device can clear the alarm for 5 seconds and the operating time is reset again.

MAINTENANCE AND CLEANING

Before maintenance work, pull the mains plug out of the socket.

Surface

Gently wipe the fan surface with a soft, dry cloth. If the surface of the fan is dirty, dilute it with a mild detergent and wipe the surface of the fan with a soft cloth. Then wipe them off with a dry, soft cloth.

Air inlet & air outlet

Use a soft brush or vacuum cleaner to clean the dust at the air inlet and outlet. If there is too much dust, this can affect the fan.

Remote control

Gently wipe the surface of the remote control with a soft, dry cloth. If it will not be used for a long time, please remove the button battery in the remote control.

Power plug

Please clean the power plug with a soft, dry cloth.

SAFE KEEPING

1. After the fan has been cleaned, it can be stored in a plastic bag.
2. Keep away from vibrations and electrical devices with cooling / heating function.
3. Do not expose it to direct sunlight, hot and humid places.
4. Keep out of the reach of kids.

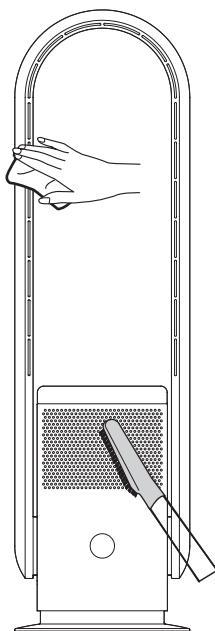

DISPOSAL

Do not dispose of packaging or the product through your household waste! The product and packaging are made from recyclable materials (plastics, metals, paper).

If the product is no longer suitable for use dispose of it in an environmentally friendly manner in accordance with your local council.

NOTES

WARRANTY CONDITIONS FOR PURCHASE IN AUSTRALIA & NEW ZEALAND

Thank you for purchasing one of our quality Click products. Please keep your receipt as proof of purchase, as this will authenticate your warranty. Any claim under this warranty must be made within 1 year of the date of purchase of the product. To make a claim under the warranty, take the product(with proof of purchase) to any Bunnings store(see www.bunnings.com.au for store locations).

Bunnings Group Ltd bears reasonable, direct expenses of claiming under the warranty. You may submit details and proof for consideration. The warranty covers manufacturer defects in materials, workmanship and finish under normal use. This warranty is provided in addition to other rights and remedies you may have under law: our goods come with guarantees which cannot be excluded under the Australian Consumer Law or the Consumer Guarantees Act(NZ). You are entitled to replacement or refund for a major failure and to compensation for other reasonably foreseeable loss or damage. You are also entitled to have the goods repaired or replaced if the goods fail to be of acceptable quality and the failure does not amount to a major failure. The warranty excludes damage resulting from product misuse or product neglect. The warranty covers domestic use only and does not apply to commercial applications. neglect. The warranty covers domestic use only and does not apply to commercial applications.

This warranty is given by Bunnings Group Limited.
ABN 26 008 672 179, Botanicca 3, Level 2 East Tower 570 Swan Street, Burnley, VIC 3121,
e-mail: CustomerSupport@bunnings.com.au, PH: 1800 797 586.
Bunnings NZ Limited: PO Box 14436, Panmure Auckland 1741,
email: OnlineEnquiries@bunnings.co.nz PH: 1800 797 586

WARRANTY EXCLUSIONS

Damage to the base or diffuser or any part through accident, misuse or negligence.

