

Mondella

Concerto Heated Bidet Seat

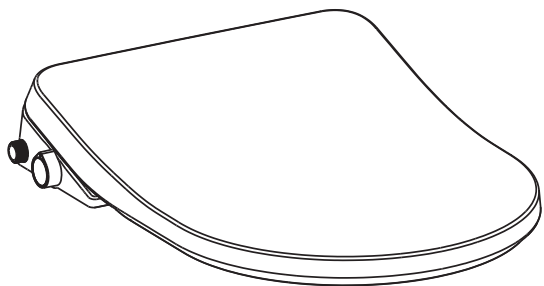

WMTS-051:2021
WMK26575
SAI GLOBAL

Rated voltage	220-240V~
Rated frequency	50/60Hz
Rated power	960W
Waterproof	IPX4
Anti-electric shock	TYPE I

www.mondella.com.au

Support and Technical Advice

E: supportau@fgi-industries.com

USER GUIDE AND INSTALLATION MANUAL

CONTENTS

Before Use	Safety Instructions	01
	Technical Specifications	04
	Packaging Contents	05
	Product Overview	06
Installation	Installation Instructions	07
	1. Product dimensions	
	2. Installation procedure	
	3. Connecting the water supply	
	4. Connecting the power supply	
Instructions For Use	Bidet Seat Function	10
	1. Default settings	
	2. Seat control functions	
	3. Protection functions	
Maintenance	Cleaning and Maintenance	12
	1. Spray nozzle maintenance	
	2. Filter cleaning	
	3. Surface Cleaning	
	4. Other maintenance	
	Troubleshooting Guide	14

SAFETY INSTRUCTIONS

This product must be installed in accordance with local, State and National Standards and Regulations, by qualified and licensed trades.

To ensure your safety and best user experience, please read this manual thoroughly prior to using the bidet seat. The illustrations in this manual are indicative only, please refer to the physical product.

Symbol Description



Danger! High risk, lethal hazards or severe injuries



Caution! Low risk, minor injuries



Warning! Medium risk, severe injuries



Tips

This smart toilet seat is not to be used by persons (including children) with reduced physical, sensory or mental capabilities, or with lack of experience and knowledge, unless they have been given supervision or instruction concerning use of the bidet smart seat in a safe way and understand the hazards involved.

Cleaning and user maintenance must not be carried out by children.



DANGER!

To reduce the risk of electrocution

- This device is an electrical appliance and must be connected to a grounding system in accordance with local, State and National regulations.
- The socket circuit connected to the product must have a residual current protective device with a rated residual operating current not exceeding 30mA.
- Ensure that sockets and plugs are located away from water supply in accordance with local, State and National regulations.
- If the power cord becomes damaged, unplug unit immediately and contact Customer Support for replacement. The power cord may only be replaced by a qualified and licensed technician, assigned by the manufacturer's service agent.
- All wiring regulations must be followed in circuit construction.
- The device is an electrical appliance and must not be used in a wet or humid environment e.g. a steam room. An exhaust fan or air vent should be used in conjunction with the appliance to ensure sufficient airflow within the room.

SAFETY INSTRUCTIONS



WARNING!

To reduce the risk of burns, electrocution, fire, or injury to persons:

- Do not use with a loose power outlet.
- Ensure the electrical plug of the seat is plugged into a power outlet that is earthed.
- Do not handle the power cord or plug with wet hands.
- Do not pull on the power cord or plug.
- Do not place open flames, candles, cigarettes, or similar objects on or nearby the toilet.
- When sitting on the toilet for a prolonged time, turn off seat warming.



CAUTION!

To reduce the risk of malfunction or damage to the product:

- This product must only be used with potable water. Do not use with industrial water, circulating water, waste water or any other water source other than potable water.
- Ensure installation complies with all local, State and National regulations regarding water supply and drainage.
- The power voltage is 220-240V~ 50/60Hz. Use the specified power supply only.
- Water Pressure Range: 0.1- 0.75 MPa.
- Water Temperature Range: 4 - 35°C . Do not install this bidet seat in rooms where the temperature may fall below 4°C.
- Do not allow the water inlet hose and power cord to be severely pinched, bent, or kinked.
- Do not allow bidet seat to be knocked against the ceramic toilet.
- Do not place the bidet seat upside down.
- Ensure the toilet and bidet seat is not installed until wet area waterproofing is completed.
- To avoid damage to ceramic toilet, do not tighten the nuts excessively when installing the seat to avoid damage to the product. Do not bed toilet base with cement.
- Installation must only be carried out with new fittings supplied with this product. Do not reuse old hoses or fittings, as this may damage the product.
- Do not remove the static film on the product during installation to avoid scratching the surface of the product.
- After installation, please connect water supply first, then power supply.

SAFETY INSTRUCTIONS

- Do not expose the product to sunlight directly, as this may cause product discoloration or temperature instability.
- When moving the product, please hold the main body. If only handling the seat cover and/or seat, the components may become separated from the main unit.

TIPS

- Due to water flow testing in factory before delivery, a small amount of water may flow out when removing the product from packaging, this is normal.
- The installation of Product must meet and strictly follow AS/NZS 3500.1 and WMTS-051 and any other relevant local, State and National regulations.
- A backflow prevention device is installed inside this product. This Atmospheric Vacuum Breaker (AVB) is rated as a high hazard backflow prevention device as per the National Construction Code Volume 3, Plumbing Code of Australia (PCA).

TECHNICAL SPECIFICATIONS

Mondella Heated Bidet Seat	
Model	FHSS101
Water Inlet	Left Side
Power Cord Inlet	Right Side
Net Weight	3.5kg
Rated Voltage	220-240V~, 50/60Hz
Rated Power Consumption	960W (Under the conditions: entering water temperature of 15°C, flow rate 600ml/min)
Maximum Power Consumption	1550W/220V
Length of Power Cord	1.5m
Water Supply Pressure	0.1 ~ 0.75MPa
Water Supply Temperature	4 ~ 35°C
Ambient Temperature	4 ~ 40°C
Protection Class	IPX4
Water Volume	0.7L/min (at a water pressure of 0.18 MPa)
Water Temperature	3 Settings (Normal temp/35/38°C)
Water Heater Power Consumption	1500W/220V
Seat Temperature	3 Settings (Room temp/33/37°C)
Seat Heater Power Consumption	50W/220V
Nozzle & Seat	Antibacterial
Slow Closing Seat/Lid	Yes

PACKAGING CONTENTS

1. Heated Bidet Seat

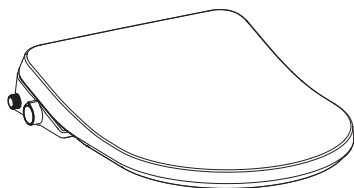

2. Installation Template

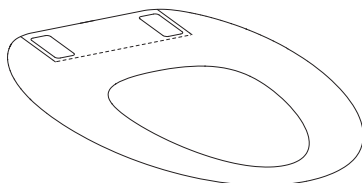

3. Seat Mounting Fittings



Screw (2)



Adjustment Plate (2)

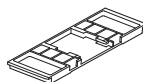

Base Plate (1)



Expansion Bolt (2)



Nut (2)

4. T Valve with filter

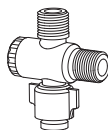

5. Water inlet hose



Filter screen

6. User Guide & Installation Manual



PRODUCT OVERVIEW

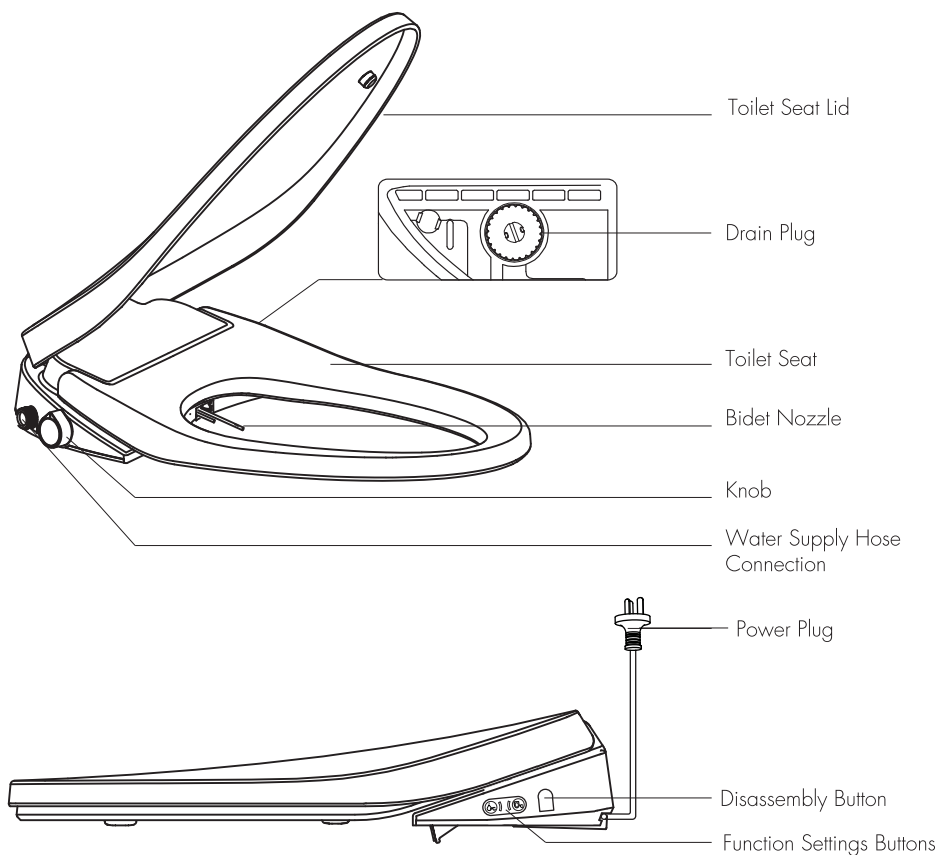

Function Settings Buttons

Knob

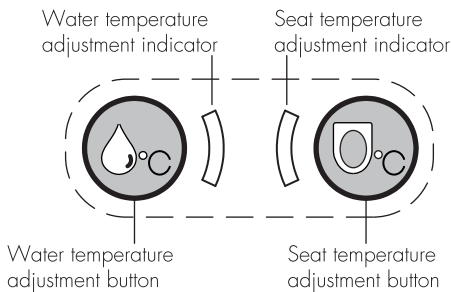

INSTALLATION INSTRUCTIONS

Please Note: This product must be installed in accordance with all local, State and National Standards and Regulations, by qualified and licensed trades.

Product Dimensions

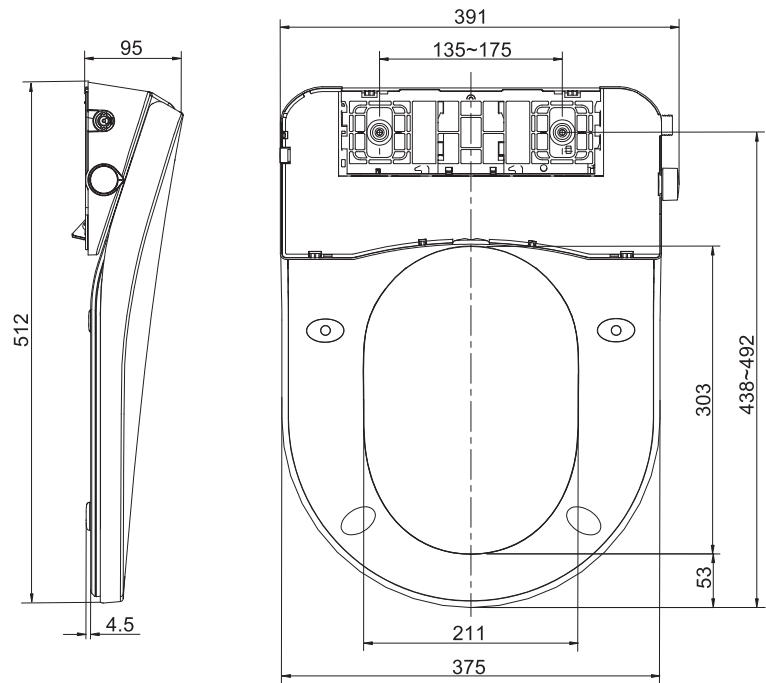

Unit: mm

Installation tools



Phillips Head Screwdriver

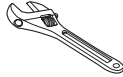

Spanner



Bucket and Rag

Pre-installation precautions

1. Water supply pressure: 0.1-0.75MPa.
2. Shut-off valve shall be located close to the location where this product is installed.
3. Shut-off valve shall be opened to clear impurities and sludge in the embedded pipe prior to installation, so that the pipe will not be clogged and the product functions are normal.
4. Please use the new hose supplied with the product. Do not install used or any other hose with the product.

Installation Procedure.

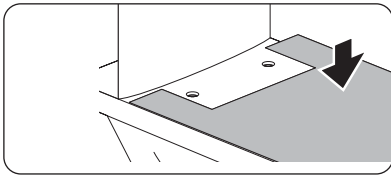

1. Place the installation template on the toilet pan as shown. Align it with the rim of toilet and align base plate within the template.

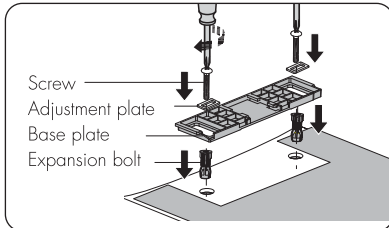

2. Install seat mounting fittings
 - (1) Insert the expansion bolts into the pan holes.
 - (2) Place the base plate in the location specified by the installation template. Install the other fittings sequentially as shown.
 - (3) Tighten the screws with screwdriver.

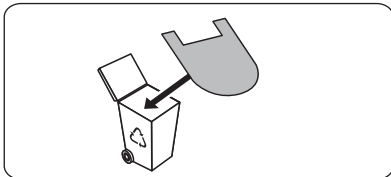

3. The installation template is designed for one time use. Please discard it after the installation is complete.

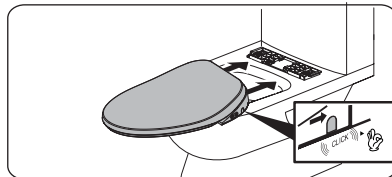

4. Holding the whole seat and not just the seat lid, slide the Heated Bidet Seat into the fixing bracket in the specified direction until a 'click' is heard. Please note, pushing on only the seat lid can cause a mechanical failure.

Connecting water supply hoses

Note: There are two methods of connecting water supply (A) and (B) as shown below.

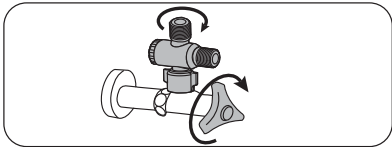

1(A). Close the shut-off valve and fix the T valve to the shut-off valve. Ensure that the rubber seal rings are loaded.

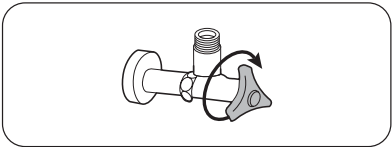

1(B). Turn off the water supply.

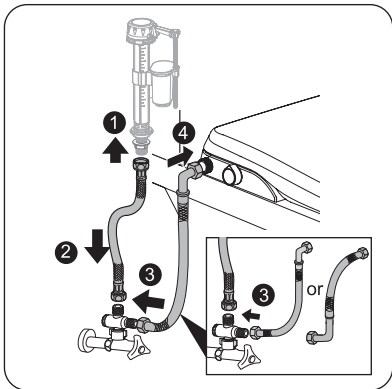

2(A). As shown above, connect the water supply hoses to the seat and toilet inlet valve. Ensure that the seal rings are loaded.

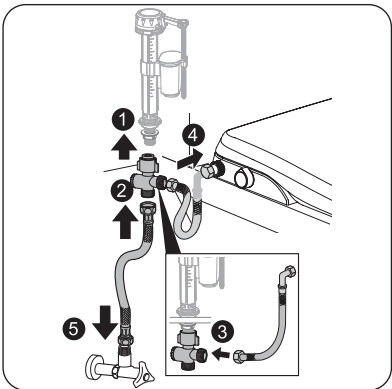

2(B). As shown above, connect the water supply hoses to the seat and toilet inlet valve. Ensure that the seal rings are loaded.

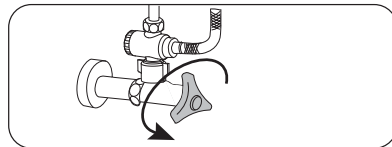

3(A). Open shut-off valve to check for water leakage.

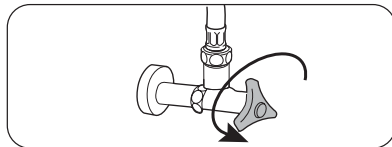

3(B). Open shut-off valve to check for water leakage.

Power connection

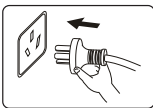

Please make sure the power plug is dry before connecting to the power supply.
1. Insert the power plug into the power socket.

BIDET SEAT FUNCTION

Default setting

When power is turned on, the product will self-test and after the self-test, a beep will sound after which the Heated Bidet Seat is ready for use.
The default water temperature is approximately 35°C.
The default seat temperature is approximately 33°C.
Knob light and night light are always on.

Seat Control Functions

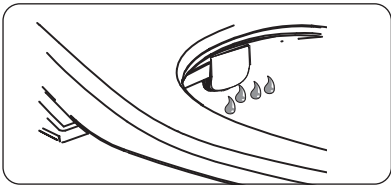
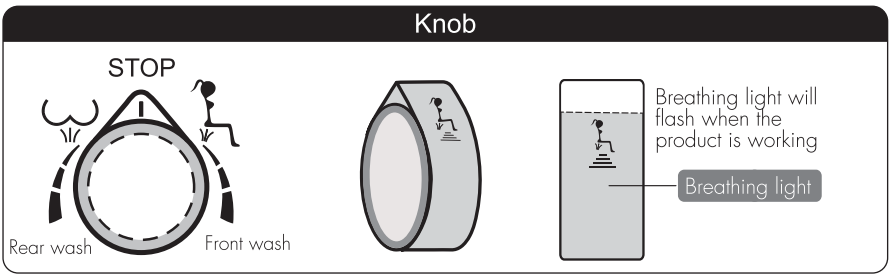

Self-cleaning function before & after use

After the user is seated, the device will commence self-cleaning of the nozzles before use. After bidet wash function is complete, the product will again commence self-cleaning of the nozzle.

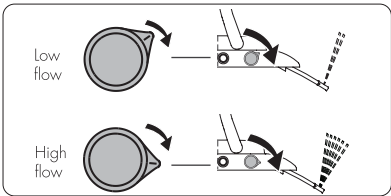

Front wash function

Rotate the knob in clockwise direction as shown on left.
After self-cleaning, the nozzle extends and water is sprayed for cleaning.
The flow varies with rotation of the knob as shown.

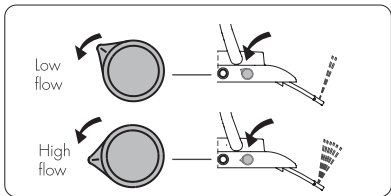

Rear wash function

Rotate the knob in anti-clockwise direction as shown on left.
After self-cleaning, the nozzle extends and water is sprayed for cleaning.
The flow varies with the rotation of knob as shown.

Function settings key

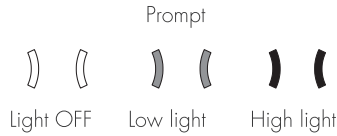
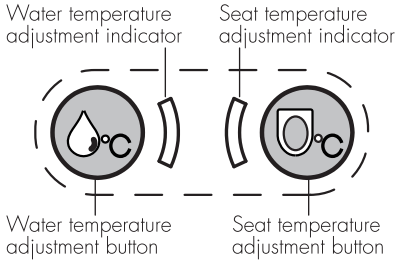

The knob lamp can be turned off by pressing the water temperature adjustment button and the seat temperature adjustment button at the same time.

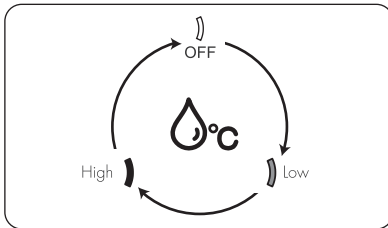

- Repeatedly pressing “°C” will switch water temperature setting in the sequence indicated in left figure.
- When switched to OFF, you will hear one long confirmation tone. When switching to the other settings, you will hear a short confirmation tone.
- Low water temperature is approx. 35°C
High water temperature is approx. 38°C

The water heating function is turned ON only when the user is seated.

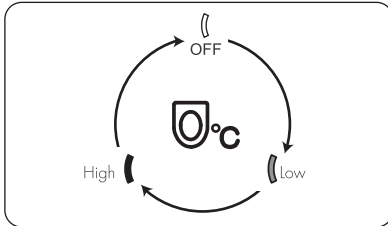

- Repeatedly pressing “°C” will switch seat temperature setting in the sequence indicated in left figure.
- When switched to OFF, you will hear one long confirmation tone. When switching to the other settings, you will hear a short confirmation tone.
- Low seat temperature is approx. 33°C
High seat temperature is approx. 37°C

Protection Functions:

1. Temperature scalding protection function: 5 minutes after the body is seated, the product will commence temperature scalding protection mode with temperature of approx. 29°C.
2. Alarm function: when the user is not seated and the knob has not been turned off, the seat will sound an alarm.
3. Water temperature protection function:
 - (1) When the water temperature exceeds 43°C during use, the flowing water will cease and the product will automatically switch to self-cleaning mode.
 - (2) When the water temperature returns to normal, the wash function may continue.

Note: When the rinse is over, turn the knob to the neutral stop position to prevent splashing.

Normal use during power failure

The water temperature and seat temperature cannot be adjusted when the power supply for product is cut off, however the flushing function with normal temperature may be used.

CLEANING & MAINTENANCE

Clean the Nozzle/Spray Tube Manually

- Pull the nozzle in and out gently and repeat 5 times;
- Hold the nozzle gently, use a soft cloth, sponge or small brush dipped in neutral detergent, then wipe the nozzle and spray tube.

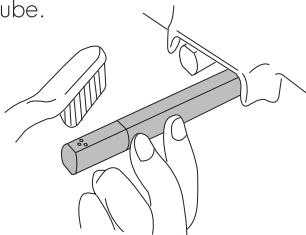

Clean Filter Screen

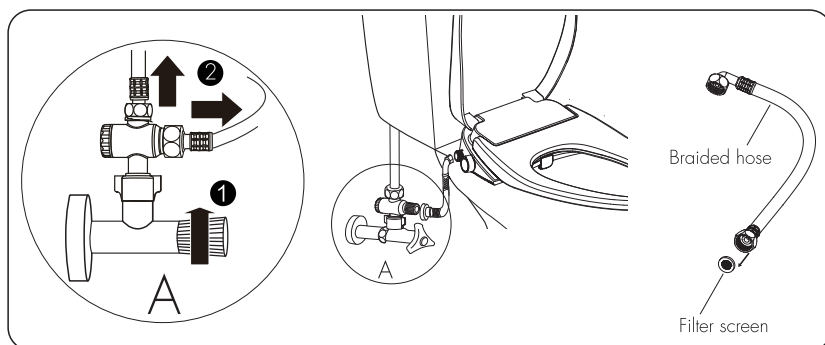

i Tips:

- Make sure that the shut-off valve is closed and the power is off before cleaning the filter screen.
- During cleaning process, product must be thoroughly separated from water inlet hose;
- Reinstall the filter screen in reverse order after cleaning.

Product Surface Cleaning

⚠ Note: Please cut off power supply before cleaning.

- Wipe the product surface with a sponge or soft cloth dampened with room temperature water or a neutral detergent.
- Lift the seat cover and the seat when cleaning other parts of the toilet suite with cleaning agents.
- Do not replace seat lid until all cleaning agent in toilet bowl are completely removed, otherwise the surface may corrode by the evaporation of cleaning agent.

Product Maintenance in Winter

It is important to prevent water in the bidet seat and any pipes from becoming frozen. Do not use product when the ambient temperature is below 4°C. Turn power off, close the shut-off valve and drain the water from the product until ambient temperature returns to 4°C or higher.

When Not in Use

When this product is not used for a period of time, drain the water in the product and cut off the power supply:

- Close shut-off valve to stop the water inlet.
- Remove water inlet hose from the shut-off valve, and release the water in the water inlet hose.
- Close the upper cover, press and hold the disassembly button by hand, move the product to the front, and then complete the removal.
- Store the product in a cool and dry place.

TROUBLESHOOTING GUIDE

Common Fault Diagnosis

When there is a product issue, please refer to this Troubleshooting Guide. If the product is still not working properly, please contact Customer Support.

Check power supply to ensure power supply is working normally

Check water supply to ensure water supply is working normally

⚠ Note: When water leakage occurs, close the shut-off valve and cut off water supply.

Water Leakage

Issue	Possible cause	Solution
Base gap leakage	Pressure maintaining valve is damaged	Cut off the power supply, close the shut-off valve and contact Customer Support.
Washing module leakage	Knob is not set to OFF position	Reset knob to OFF
	Control valve has failed	Cut off the power supply, close the shut-off valve and contact Customer Support.

Seat Heating

Issue	Possible cause	Solution
Seat temperature is not sufficient	Seat temperature set at low setting	Adjust seat temperature to higher setting.
Seat temperature is too high	Seat temperature is set at high setting	Adjust seat temperature to lower setting.
Temperature is too low with initial seat contact	Seat heating function not enabled	Enable seat heating function in advance.
Seat will not heat	Seat heating coil	Cut off power supply, contact Customer Support.

Washing failure analysis

Issue	Possible cause	Solution
Spray tube extends too slowly	Cool water should be released from front end before washing.	It is normal, and provides normal wash approximately 5s later.
Insufficient water amount	Knob is not completely turned on.	Continue to turn knob further to increase water flow.
Insufficient water temperature	Water temperature is set at low setting.	Adjust water temperature to higher setting.
Water temperature is too low	Water temperature is set at lowest gear.	Adjust water temperature to higher setting.
	Automatic protection mode for excessively high temperature	Adjust temperature after self-cleaning mode completes.
Water flows out when seated	Self-cleaning function is enabled	It is normal, and water flow will automatically stop after approximately 5 seconds.
Water is not heated Breathing light not flashing	Electrical supply is abnormal	Cut off power supply, contact Customer Support.
Vibration and noise occurs when the knob is turned on	Water pressure abnormal	Close the shut-off valve and reinstall the water inlet hose.
The movement of the nozzle / spray tube is jamming	Water scale causes increased resistance to the movement.	Please refer to the method for manual cleaning of nozzle/spray tube in Cleaning and Maintenance.

Night light analysis

Issue	Possible cause
Night light is not ON.	Power cord of night light may be damaged. Contact Customer Support.
Knob light is not ON	Power cord of knob light may be damaged. Contact Customer Support.

Alarm function

Issue	Possible cause	Solution
Continuous beeping	Knob switch is not set to OFF state when away from seat	Set knob to OFF state.

