

# EUROMATIC



## Electric Fireplace Heater

### USER MANUAL

Model Number FP119

After Sales Support

☎ (AU) 1300 886 649 (NZ) 0800 836 761 | ✉ [info@tempo.org](mailto:info@tempo.org)



E209

# Contents

	Page
Important Safety Instructions	3
Product Overview	7
Getting Started	8
Operating Instructions	9
Other Useful Information	11

# Important Safety Instructions

## READ CAREFULLY AND KEEP FOR FUTURE REFERENCE

Read this manual thoroughly before first use, even if you are familiar with this type of product. The safety precautions enclosed herein reduce the risk of fire, electric shock and injury when correctly adhered to. Make sure you understand all instructions and warnings. Keep the manual in a safe place for future reference, along with any warranty information, your purchase receipt and packaging. If you sell or transfer ownership of this product, please pass on these instructions to the new owner.

**Always follow basic safety precautions and accident prevention measures when using an electrical appliance, including the following:**

### Electrical safety and cord handling

- **Voltage:** Before plugging in the heater, make sure your outlet voltage and frequency correspond to the voltage stated on the appliance rating label.
- **Electrical outlet / circuit:** Always plug this heater into a separate wall outlet socket that must be properly earthed. To ensure you do not overload the circuit, do not operate another high-wattage product on the same circuit.
- **Connection:** To insert the plug, grasp it firmly and guide it into the outlet.
- **WARNING: No extension cord:** Do not use the heater with a power board, plug adaptor or extension cord as these may overheat and create a fire risk.
- **Power supply:** To avoid a hazard due to inadvertent resetting of the thermal cut-out, do not connect the heater to an external switching device such as a timer, or to a circuit that is regularly switched on/off by your energy provider.
- **Protect the power cord:**
  - Do not operate the heater with the cord coiled up; always fully unwind.
  - Do not twist or kink the cord or let it touch heated surfaces.
  - Do not put any stress on the cord where it connects to the product.
  - Never carry the heater by the cord.
  - Arrange the cord away from any traffic areas so no one will trip over it.
  - Do not run the cord under carpeting or cover it with rugs, runners, etc.
  - Do not reach for an appliance that has fallen into water. Switch off and unplug immediately.
- **WARNING: To reduce the risk of fire, electric shock or injury:**
  - Never touch the heater with wet or damp hands or feet.
  - Do not use the heater if any part of it has become wet. Immediately call a qualified service technician to inspect the heater and replace any part of the electrical system that has got wet.
  - Never spill liquid into the heater; never immerse the cord, plug or any part of the appliance in water or other liquids.

# Important Safety Instructions (Cont.)

- **WARNING: Damage:** Do not pick up or operate the appliance if the power cord, plug or housing is damaged, after it malfunctions or has been dropped or damaged in any manner. Check the power cord regularly for visible damage. If it is damaged, it must be replaced by the manufacturer or authorised service agent in order to avoid a hazard. Contact our after sales support centre.
- **Plug:** It is normal for the plug to feel warm to the touch; however, a loose fit between the AC outlet and plug may cause overheating and distortion of the plug. Contact a qualified electrician to replace a loose or worn outlet.
- **After use:** Always switch off the heater and disconnect the power when the heater is not in use and before cleaning, servicing, moving or storing it. Grip the plug when disconnecting, do not pull on the cord.
- **Safety switch:** Unless your home is already fitted with a residual current device (safety switch), we recommend installing an RCD with a rated residual operating current not exceeding 30mA to provide additional safety protection when using electrical appliances. See your electrician for professional advice.

## Usage conditions and restrictions

- **Domestic use:** This appliance is intended for indoor household use only. It is not suitable for commercial, industrial or trade use. Do not use it outdoors.
- **Space heating only:** Do not use this appliance for anything other than its intended purpose, e.g., do not use it as a drying rack for clothes or shoes. Only use the heater as described in this manual. Any other use is not recommended and may cause fire, electric shock or injury.
- **Protect from moisture:** This appliance is not intended for use in bathrooms, laundry areas and similar indoor locations. Never locate this appliance where it may fall into a bathtub or otherwise become exposed to water.
- **Accessories:** The use of accessory attachments not recommended by the appliance distributor may result in fire, electric shock or personal injury.
- **Ventilation:** Only use this heater in a well ventilated area.
- **Keep openings clear:** To prevent a possible fire and electrical hazard, do not insert or allow objects to enter any air outlet, ventilation or exhaust openings. Do not block air intakes or exhaust openings in any manner. Wipe the air openings clean if they become clogged. Never place the heater on a soft surface (such as a bed or a couch) where the air openings may be blocked.
- **WARNING: No external timer:** Never operate the heater on a program switch, external timer switch or any other appliance for automatic operation, as there is a risk of fire if the heater is covered or positioned incorrectly.

# Important Safety Instructions (Cont.)

- **No vibration:** Do not operate this heater in areas with noticeable vibration, as this could cause a breakdown of the bulb.
- **Usage restriction:** This appliance is not intended for use by persons (including children) with reduced physical, sensory or mental capabilities, or lack of experience and knowledge, unless they have been given supervision or instruction concerning use of the appliance by a person responsible for their safety.
- **Children and pets:** Supervise children to ensure they do not play with the heater. Keep the product out of the reach of children and pets.
- **WARNING: Do not leave on unattended during use!** Always switch it off and unplug it from the power outlet when not in use and before moving it. Do not use the heater in small rooms when they are occupied by persons not capable of leaving the room on their own, unless constant supervision is provided.
- **Operate upright:** Always place the heater in an upright position.
- **Flammable materials:** Do not insert or place flammable materials (such as paper, plastic or cardboard) in, on or near the product.
- **Supervision:** Take utmost care and supervise when operating the heater in the presence of young children or disabled people as the fire guard (the grille at the front of the heater) does not give full protection.
- **WARNING: Do not use the heater while sleeping** or place it near a person who is sleeping.
- **To avoid creating a fire risk, do not use the heater:**
  - In front of or immediately below a power outlet
  - Near flammable materials or surfaces (such as furniture, curtains, pillows, bedding, papers, clothes), or near open flames. Keep such materials at least 1m away from the front of the heater and 50cm away from the sides and rear (do not place towels or other objects on the heater)
  - In any areas where petrol, paint or other flammable liquids are stored, such as in a garage or workshop, as the heater has hot and arcing parts inside which may spark
  - Near a window where it may get splashed with rain
  - On long pile carpet or a flokati rug
  - In the immediate vicinity of a bath, shower or swimming pool.
- **Floor surface:** Only operate the heater on a flat, steady, dry, stable and heat-resistant surface. Do not place it on or near surfaces that may be damaged by heat (such as delicate rugs, wallpaper, floor coverings not made of heat-resistant material, etc.). Do not use it on soft surfaces such as bedding or long pile or soft carpeting, where openings may become blocked.

# Important Safety Instructions (Cont.)

- **Service:** This heater contains no user-serviceable parts inside. Do not attempt to open and repair the heater yourself. Other components should only be serviced by a qualified technician. In case of malfunction, disconnect the plug immediately and contact our after sales support centre for advice.
- **Do not open:** All covers are intended to prevent direct access to the heating elements and must be in place during use.
- **Storage:** To avoid damaging the heater during storage or transport, keep the heater in a dry place, free from excessive vibration.
- **Misuse:** Improper use or placement may result in the risk of fire, electric shock and/or injury. We accept no liability for any eventual damages or injury caused by improper use, incorrect handling or noncompliance with the instructions.

## CAUTION: HOT!

- Some parts of this heater can become very hot during use and remain hot for some time afterwards. To avoid burns and personal injury, do not allow bare skin to touch hot surfaces. Always let the heater cool down before touching it, even if it is unplugged from the power supply.
- Be particularly careful when children and vulnerable persons are present.
- Attachments, when furnished, may become hot during use. Allow any attachments to cool before handling them.
- Do not move the heater when it is in use; allow it to cool sufficiently before moving it. If moving the heater is essential while it is still hot, take extra care and wear protective oven mitts or gloves to avoid burns.
- A heater has hot and arcing or sparking parts inside. Always maintain your distance from the product during use to avoid serious burns and personal injury.



## DANGER! Do not cover!

Do not cover the heater in any manner as it may overheat and become a fire risk.

# Product Overview

## Parts of the heater

Front view (angled)



1 Front safety grille

2 Log flame effect

3 Feet (4)

Rear view (without feet)

4 ON/OFF [ O / I ] switch

5 [ I ] Low heat (800W) switch

6 [ II ] High heat (1600W) switch

7 Thermostat control

8 Air intake grilles

9 Power cord and plug

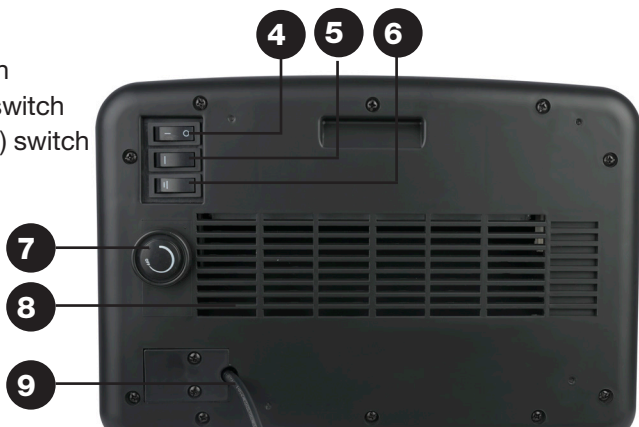

**NOTE:** Due to continued product improvement, images and illustrations in this manual may vary slightly from the product purchased. All images in this manual are for reference purposes only. Parts are not necessarily pictured to scale.



# Getting Started

## Unpacking

- **Carton:** This product has been packaged to protect it against transportation damage. Unpack the appliance and keep the original packaging carton and materials in a safe place. It will help prevent any damage if the product needs to be transported in the future, and you can use it to store the appliance when it is not in use. In the event it is to be disposed of, please recycle all packaging materials where possible.
- **Plastic wrapping** can be a suffocation hazard for babies and young children, so ensure all packaging materials are out of their reach and disposed of safely.
- **Cord:** Unwind the cord to its full length and inspect the cord and the plug for damage. Do not use the heater if the appliance or its cord has been damaged or is not working properly. In case of damage, contact our after sales support centre for advice on examination, repair or return of the damaged product.
- **Documentation:** Make sure you have read and understood all instructions and warnings in this manual. Refer to the Product Overview, page 7, to familiarise yourself with the product and identify all parts. Pay particular attention to the safety instructions on the previous pages.
- **Feet:** The heater is packaged with the feet unattached. You must attach them before turning on the heater.

## Feet installation

- Put a soft covering on a table or benchtop and carefully lay the heater on top with the bottom end at the edge of the table.
- Take the four feet out of the plastic bag and connect them to the underside of the appliance. Insert the feet into their respective spaces at the underside of the heater and turn to secure, as pictured below:

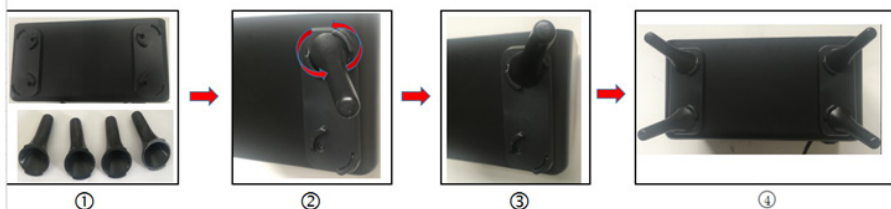

- Turn the heater in an upright position after the feet are properly fitted.



# Operating Instructions

## Set-up location requirements

Place the heater in an upright position on a firm, level, dry and heat-resistant surface, taking into consideration all relevant safety information on the previous pages. The appliance is suitable for providing auxiliary heating. It is not suitable for use on its own to heat large spaces. Ensure that there is sufficient distance from the wall, fixtures and other appliances. The distance must be at least 1m at the front of the heater to exclude the risk of fire.

## Connecting the heater

- Make sure the ON/OFF switch at the back of the appliance is in the OFF [ O ] position, then plug in the heater and switch the power on at the outlet.
- Always use a separate socket that has no other high wattage appliances connected at the same time – do not use a power board, socket adaptor or extension cord.

## Switching on

- Once the plug is securely inserted, set the ON/OFF switch (1) to the ON [ I ] position. The unit will start operation in ‘flame only’ mode.
- To run the appliance as a heater, you will have to select the heat output.

## Selecting the heat output

- Press the [ I ] low heat switch (2) to select approximately 800W heat output and fan operation.
- Press both the [ I ] low and [ II ] high heat (3) switches to select approximately 1600W heat output and fan operation.

**NOTE:** You have to press both heat output buttons for high heat output.

## Setting the thermostat

- Turn the thermostat control (4) clockwise to the maximum setting until the room is comfortably warm.
- When the room temperature is comfortable, slowly rotate the knob anticlockwise (turn to the left) until the heater cycles off. It will now cycle on and off to maintain the temperature at this set level.

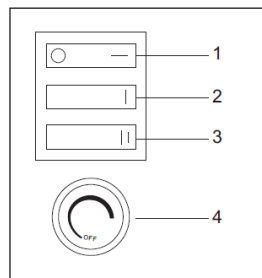

## Switching off

- Press the ON/OFF [ O / I ] switch to switch the unit off. The flame effect, fan operation and heating will stop.
- Unplug the heater from the power outlet.

# Operating Instructions (Cont.)

## FIRST USE

The heater may produce fumes or odour when it is first heating up. This is due to the components being new and can be disregarded safely. It is entirely harmless. When switching on the heater for the first time, allow it to run at full power until all odour and/or smoke has dissipated. Ensure there is adequate ventilation.

## Safety features

### Overheat protection

The unit is equipped with an overheat protection mechanism, which shuts off the heater automatically in case of overheating. Should the overheat protection be triggered, switch off the heater, unplug it and let it cool down for at least 10 minutes. Remove any obstructions. Plug the heater in again and operate as normal.

Make sure that there is sufficient room all around the heater so that the appliance can properly dissipate the heat generated, and that nothing is covering or obstructing the air outlet or intake.

The most common cause of overheating is deposits of dust or fluff in the appliance. Ensure these deposits are removed regularly by unplugging the appliance and vacuum cleaning air vents and grilles. If you cannot establish a cause and the fault occurs repeatedly, please contact our after sales support centre for advice.

### Tip-over safety switch

The heater has a tip-over safety switch, which will turn off the heater if it is tipped over or tilted. It will start working again as soon as the unit is placed upright. But take extreme care when standing the heater upright, as it may still be hot. Inspect it for damage, especially to the heating elements and supply cord. Do not operate the heater if any damage is visible.

## Troubleshooting

If your heater fails to operate, or you experience any other problem with the heater, contact our after sales support centre for advice. Do not attempt to open the heater and repair it yourself. Any repairs must be carried out by a qualified technician. Before phoning for a service, please ensure that:

- Your heater is properly plugged in.
- The outlet and circuit breaker or fuse are working properly.
- The thermostat control knob is set to the desired temperature position.
- The overheat protection has not been triggered.

# Other Useful Information

## Care and cleaning

The heater requires regular cleaning to ensure trouble-free operation.

### CAUTION!

- Always switch off and disconnect the heater from the power supply and let it cool down before cleaning the heater or carrying out maintenance.
- Do not attempt to open the heater and repair it yourself. Any repairs must be carried out by a qualified technician.

Before cleaning the heater, switch it off and allow it to cool. Disconnect the electricity supply to the appliance.

Use a vacuum cleaner to clean dust and fluff from the air outlet and intake grilles. Use a soft, damp cloth (not wet) to wipe the exterior of the heater to remove dust and dirt. Allow some time for the heater to dry before reconnecting it to the power supply.

**CAUTION:** Do not use abrasive cleaning powders, solvents or furniture polish, as this can damage the surface finish. Do not let liquid enter the appliance. Do not immerse any part in water or other liquids.

## Storage

If you are not going to use the heater for a while, please unplug it from the power outlet. We recommend you store the heater in its original packaging to protect it from dust. Store the heater in a cool, dry place, free from excessive vibration and out of children's reach.

## Technical specifications

Voltage	220–240V~ 50–60Hz
Power	1400–1600W
Dimensions (mm, approx. )	340 (L) x 170 (D) x 300 (H)
Weight (kg, approx.)	3kg

## Responsible disposal

At the end of its working life, do not throw this appliance out with your household rubbish. Electrical and electronic products contain substances that can have a detrimental effect on the environment and human health if disposed of inappropriately. Observe any local regulations regarding the disposal of electrical consumer goods, and dispose of it appropriately for recycling. Contact your local authorities for advice on recycling facilities in your area.

## **Warranty returns**

Should you for any reason need to return this product for a warranty claim, make sure to include all accessories with the product.

## **Product does not work?**

If you encounter problems with this product, or if it fails to perform to your expectations, make sure to contact our After Sales Support Centre on (AU) 1300 886 649 or (NZ) 0800 836 761 for advice.

Distributed by Tempo (Aust) Pty Ltd ABN 70 106 100 252

PO BOX 6056 Frenchs Forest, Australia NSW 2086

Customer Helpline:

(AU) 1300 886 649 (NZ) 0800 836 761

Email: [info@tempo.org](mailto:info@tempo.org)

For an electronic copy of this manual, please contact our after sales support centre.