

AEG

A18SPC12

Original instructions

Important!

It is essential that you read the instructions in this manual before assembling, operating and maintaining the product.

Subject to technical modifications.

Battery port

LED indicator

Keyhole hanger

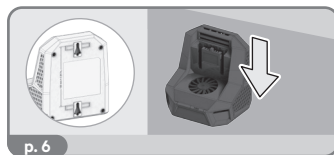
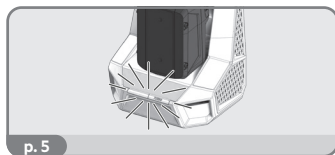
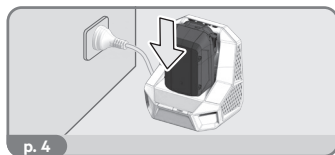
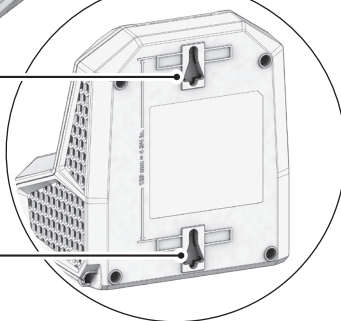
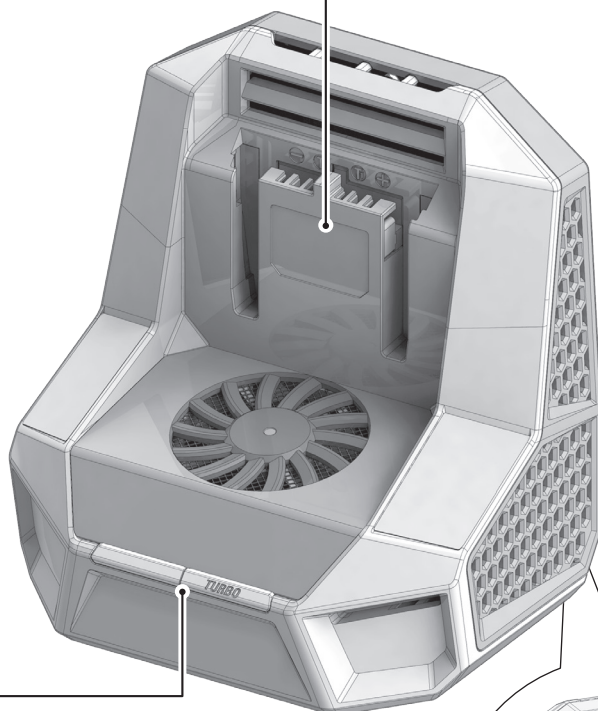

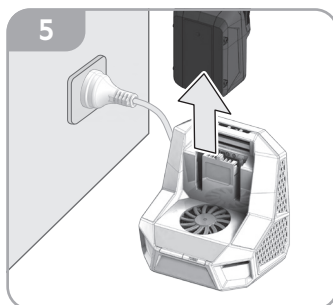
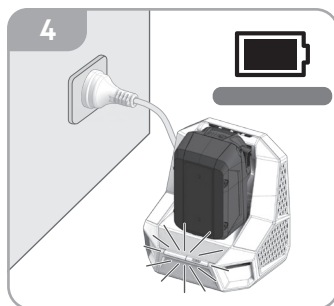
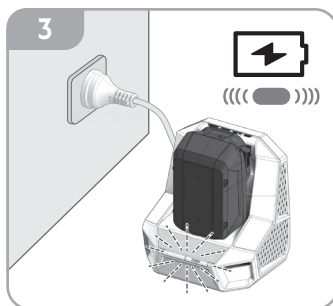
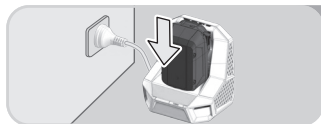

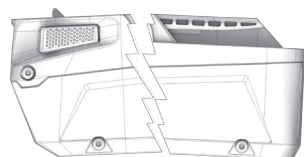
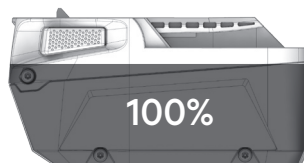
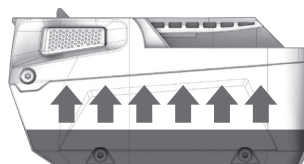
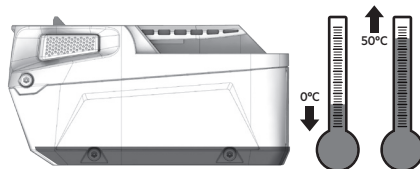
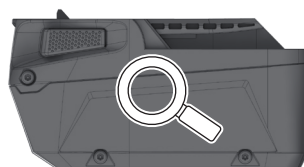
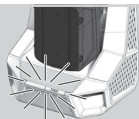

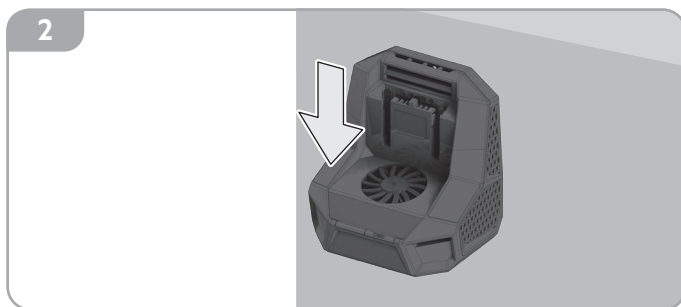
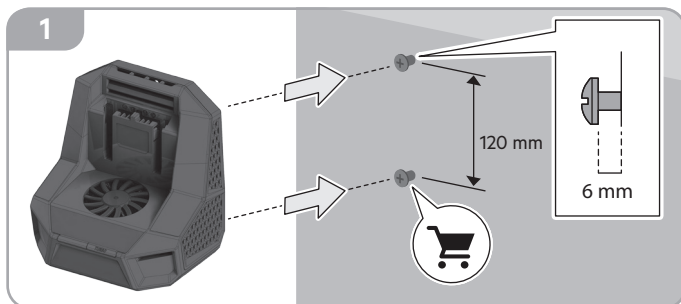



TECHNICAL DATA

A18SPC12

| | |
|--|---------------|
| Type | Charger |
| Rated voltage | 18 V |
| Quick charge current | 12 A |
| Charger input | 220 - 240V AC |
| Recommended ambient charging temperature | +5 to +40 °C |
| Weight without battery pack | 1.2 kg |

COMPATIBLE BATTERY PACKS

| Battery pack | Voltage | Battery capacity | Number of cell for battery | Cell type | Approximate charge time (100% of charge) |
|--------------|---------|------------------|----------------------------|-------------|--|
| L1820S | 18 V | ≤ 2.0 Ah | 5 | Lithium-Ion | 32 minutes |
| A18FB2 | | ≤ 2.0 Ah | 5 | | 32 minutes |
| A18B4 | | ≤ 4.0 Ah | 5 x 2 | | 38 minutes |
| A18FB4 | | ≤ 4.0 Ah | 5 x 2 | | 38 minutes |
| A18FB5 | | ≤ 5.0 Ah | 5 x 2 | | 45 minutes |
| A18OB6 | | ≤ 6.0 Ah | 5 x 2 | | 50 minutes |
| L1860R-X5 | | ≤ 6.0 Ah | 5 x 2 | | 50 minutes |
| A18OB8 | | ≤ 8.0 Ah | 5 x 2 | | 50 minutes |
| L1890R | | ≤ 9.0 Ah | 5 x 3 | | 65 minutes |

CHARGER SAFETY WARNINGS

The product is not intended to be used or cleaned by persons with reduced physical, sensory or mental capabilities, or lack of experience or knowledge, unless they have been given instructions concerning the safe use of the appliance by a person legally responsible for their safety. They should be supervised whilst using the product. Children shall not use, clean or play with the product, which when not in use should be secured out of their reach.

Read all safety warnings and all instructions. Failure to follow the warnings and instructions may result in electric shock, fire and/or serious injury.

Do not recharge primary cells (non-rechargeable).

The product must not be damp and should never be used in a damp environment.

The product is for indoor use only.

Do not cover any ventilation slots, and provide adequate ventilation during operation.

Mains voltage must correspond with the voltage specifications on the product.

Before using the product, check that the charger enclosure, cable, and plug are not damaged. If damage is found, do not use the product and bring it to an authorised service centre for repair.

Do not use the product if it has suffered any heavy shock or jolting, or if it is damaged in any other way.

When charging, do not expose the product to sunlight or other heat source. The recommended temperature range at charging vicinity is 5° to 40°C.

Due to the heat generated during charging, do not use the product on a combustible surface.

Do not use the product near flammable materials, such as cloth, packaging materials, paint, spray paint or aerosols, lubricants, thinners, petrol containers, gas containers, or gas appliances.

Never modify, disassemble, or attempt to repair the product yourself.

Do not allow the charger or battery packs to become contaminated with any material that could be conductive, such as metallic particles from grinding, cutting, or machining processes.

Protect the battery contact terminals from metallic objects to avoid a short circuit, which can cause fire or explosion.

Unplug the product from the power socket when it is not in use or when cleaning it.

Use only an extension cable that is approved and in good condition.

Do not charge battery packs that show signs of leaks. Dispose of them properly.

Never charge a damaged battery pack. Replace damaged battery packs immediately.

Before every use, examine the supply cord for damage. If there are signs of damage, it must be replaced by a qualified person at an authorised service centre to avoid a hazard.

ADDITIONAL BATTERY SAFETY WARNINGS

⚠ WARNING! To reduce the risk of fire, personal injury, and product damage due to a short circuit, never immerse your tool, battery pack, or charger in fluid or allow fluid to flow inside them. Corrosive or conductive fluids, such as seawater, certain industrial chemicals, and bleach or bleach containing products, etc., can cause a short circuit.

Do not dispose of used battery packs in the household refuse or by burning them. AEG distributors offer to retrieve old batteries to protect our environment.

Battery packs that have not been used for some time should be recharged before use.

For an optimum lifetime, the battery packs have to be fully charged after use.

For battery pack storage longer than 30 days:

- Store the battery pack where the temperature is below 27°C and away from moisture.
- Store the battery packs in a 30% - 50% charged condition.
- Every six months of storage, charge the pack as normal.

Battery pack protection

The battery pack has overload protection that protects it from being overloaded and helps to ensure long life.

Under extreme stress, the battery electronics turn off the product automatically. To restart, turn the product off and then on again. If the product does not start up again, the battery pack may have discharged completely. Recharge the battery pack.

Transporting lithium batteries

Lithium-ion batteries are subject to the Dangerous Goods Legislation requirements.

Transportation of those batteries has to be done in accordance with local, national, and international provisions and regulations.

- Batteries can be transported by road without further requirement.



- Commercial transport of lithium-ion batteries by third parties is subject to Dangerous Goods regulations. Transport preparation and transport are exclusively to be carried out by appropriately trained persons and the process has to be accompanied by corresponding experts.

When transporting batteries:

- Ensure that the battery contact terminals are protected and insulated to prevent short circuit.
- Ensure that the battery pack is secured against movement within the packaging.
- Do not transport batteries that are cracked or leaking.
- Check with the forwarding company for further advice.

SPECIFIED CONDITIONS OF USE

The charger is intended only to charge the compatible battery packs listed in this manual.

The product is only for indoor use, in dry conditions.

The product is not intended to charge any other type of battery or be used as a power supply. It should never be used in explosive or flammable environments.

Do not use the product for any other purpose.





WALL MOUNTING

Carefully select a stable wall for mounting the charger. Make sure that there is no hindrance to mounting work or operation. The maximum gross weight of the charger is approximately 2.4 kg. Provide sufficient reinforcement for the wall if necessary.

Mount the charger in a vertical orientation only. Install two screws on the wall to mount the charger. Otherwise, the charger may fall and cause serious injury.

Check the tightness of the screws on a regular basis. Make sure that the head of the screws fit properly in the wall mounting holes to hold the charger firmly in place. Otherwise, the charger may fall because of loose screws.

LED INDICATORS

| | | |
|---|-------------------|---|
|  | Continuous orange | Battery is being evaluated. / Battery is waiting to be charged. |
|  | Flashing orange | Battery is too hot or cold. Charging will begin when battery reaches correct charging temperature. |
|  | Flashing green | Battery is being charged. |
|  | Continuous green | Charging is complete. |
|  | Continuous red | Battery or charger is defective. |

OPERATION

CHARGING THE BATTERY PACK

- Battery packs are shipped in a low charge condition. Therefore, you should charge them before first use. If the charger does not charge the battery pack under normal circumstances, bring both the battery pack and charger to an authorised service centre.
- Make sure that the power supply is normal household voltage, 220–240V, 50Hz, AC only.
- Make sure that the battery pack latch clicks into place and that the battery pack is secured in the charger before charging.

NOTE: When the battery becomes fully charged, the green LED remains on. It is normal for the battery pack to become slightly warm to touch while charging.

- Do not place the charger and battery pack in an area of extreme heat or cold. They work best at normal room temperature.

NOTE: When charging, the charger and battery pack should be placed in a location where the temperature is more than 5°C but less than 40°C.

CHARGING A COOL BATTERY PACK

- Insert the battery pack into the charging port. Make sure that the battery pack latch clicks into place.
- Connect the product to a power supply.
- Disconnect the product from the power supply when the battery pack becomes fully charged.
- Press the battery pack latches to unlock the battery pack from the product.
- Remove the battery pack from the product.

CHARGING A HOT BATTERY PACK

When using a tool continuously, the cells in the battery pack become hot. A hot battery pack should be allowed to cool down for approximately 30 minutes before recharging.

MAINTENANCE

When not using or when cleaning the product, disconnect it from the power supply and remove the battery pack.

Avoid using solvents when cleaning plastic parts. Most plastics are susceptible to various types of commercial solvents. Use clean cloth or soft brush to remove dirt and dust.

Do not, at any time, let brake fluids, gasoline, petroleum-based products, and penetrating oils come in contact with plastic parts. These products contain chemicals that can damage, weaken, or destroy plastic.

Hazardous voltages are present within the product; do not disassemble.

If the supply cord is damaged, it must be replaced by a special cord or assembly available from the manufacturer or its service agent.

Use only AEG accessories and spare parts. Should components that have not been described need to be replaced, contact one of our AEG service agents (see our list of guarantee/service addresses).

If needed, an exploded view of the tool can be ordered. Please state the Article No. as well as the machine type printed on the label and order the drawing at your local service agents or directly at:

Techtronic Industries Australia Pty Ltd

PO Box 1065
Mount Waverley VIC 3149
Tel. no. 1300 234 797
Australia

Techtronic Industries N.Z. Limited

PO Box 12-806
Penrose AUCKLAND 1642
Tel. no. 0800 234 797(0800 AEGPWR)
New Zealand

CLEANING THE CHARGER

Unplug the charger power cord from the power supply before cleaning to prevent serious personal injury.

Clean the charger surface (except labels) using a damp cloth with a mild detergent.

Do not use any strong detergents on the plastic housing. They can be damaged by certain aromatic oils, such as pine and lemon, and by solvents such as kerosene.

Moisture can cause a shock hazard. Wipe off any moisture with a soft dry cloth.

STORAGE

Store the product in a cool dry place between 10°C and 38°C.







SYMBOLS



Read the instructions carefully before starting the product.

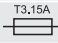

CAUTION! WARNING! DANGER!

| | |
|--|---|
|  | Class II equipment |
|  | For indoor use only |
|  | Time-lag fuse 3.15 A |
|  | Direct current |
|  | Accessory - Not included in standard equipment, available as an accessory. |
|  | <p>Do not dispose of waste electrical and electronic equipment as unsorted municipal waste.</p> <p>Waste electrical and electronic equipment must be collected separately.</p> <p>Waste light sources have to be removed from the equipment.</p> <p>Check with your local authority or retailer for recycling advice and collection point.</p> <p>According to local regulations, retailers may have an obligation to take back waste electrical and electronic equipment free of charge.</p> <p>Your contribution to the reuse and recycling of waste electrical and electronic equipment helps to reduce the demand of raw materials.</p> <p>Waste electrical and electronic equipment contain valuable and recyclable materials, which can adversely impact the environment and the human health if not disposed of in an environmentally compatible manner.</p> <p>Delete personal data from waste equipment, if any.</p> |
|  | Regulatory Compliance Mark (RCM). Product meets applicable regulatory requirements. |





AEG

www.aegpowertools.com.au
www.aegpowertools.co.nz

Techtronic Industries Australia Pty Ltd

31 Gilby Road, Mount Waverley,
VIC, 3149, Australia

Techtronic Industries N.Z. Limited

Unit C, 70 Business Parade South,
Highbrook, Auckland 2013, New Zealand

961153846-01A

*AEG is a registered trade mark used under
license from AB Electrolux (publ).*