

Basin Set

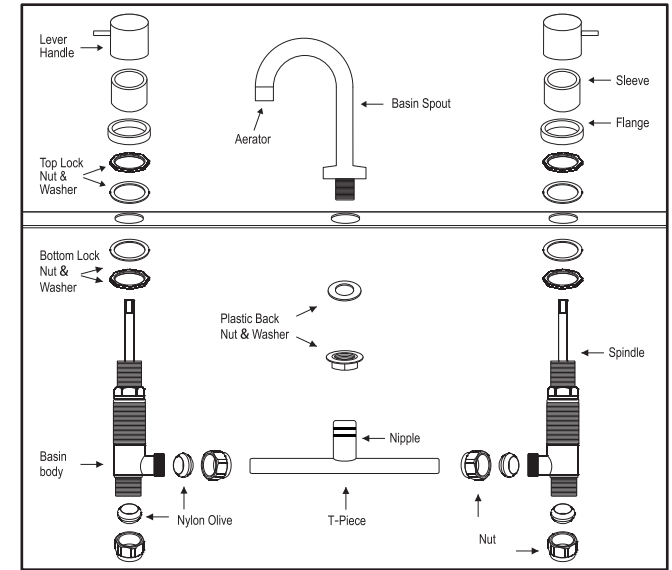

1. Assemble the T-Piece into the basin bodies. Check the hole alignments with the basin/bench top. Disassemble and cut the T-Piece ends down to correct size if required.
 2. Remove the top lock nuts and washers from the basin bodies.
 3. Remove the plastic back nut and washer from the basin spout and place them loosely over the T-Piece nipple (washer on top).
 4. Position the Basin Tee assembly into the vanity basin/bench top so the top threads of the basin bodies are accessible through the top. Bottom lock nuts can be lowered to suit.
 5. Place the washer and lock nuts on the installed bodies and tighten. Tighten the bottom lock nuts up to bench level.
 6. Push the basin spout down with a swivelling motion, locating it into the T-Piece nipple. Once fully down be sure to centre the spout before tightening the plastic back nut.
- NOTE:** the copper T-Piece can be bent up or down (within reason) to ensure the nipple is at the correct position inside the spout base.
- NOTE:** refer to Ceramic Disc Installation Guide for alignment tips (separate page).
7. Thread the sleeves onto the spindles and tighten them by hand. Slide the flanges over the sleeves and push them firmly against the basin/bench top.
 8. Install the handles by slotting them onto the spindle. Ensure levers are lined up with the Hot handle facing 9 O'clock and the Cold handle facing 3 O'clock, as shown in the image above.
 9. Using the provided Allen key, tighten the grub screw in the handle into the spindle, thus securing the handles. Refer to figure (i).
 10. Connect the hot and cold water lines to the basin bodies. If using flexible connectors, the bottom nuts and nylon olive fitted to the basin bodies will not be required.
 11. Remove the aerator from the basin spout with the provided tool. Turn on the taps to flush out any filings or debris from the pipes. Re-install the aerator. The aerator contains a water reducing flow device.
 12. Check for leaks above and below bench level.



Bath/Shower/Wall Top Assembly



1. Install the Ceramic Disc Spindles (refer to Ceramic Disc Installation Guide - separate page).
2. Install the sleeves by threading them onto the spindle locking nuts. Slide the flanges over the sleeves and push them firmly against the wall.
3. Install the handles by slotting them onto the spindle. Ensure levers are lined up with the Hot handle facing 9 O'clock and the Cold handle facing 3 O'clock, as shown in the images above.
4. Using the provided Allen key, tighten the grub screw in the handle into the spindle, thus securing the handles. Refer to figure (i).
5. Check for leaks.
6. Bath/shower spouts - place a generous amount of thread seal tape lightly around the existing 1/2" threaded nipple in the wall prior to installing the spout.
7. Screw the spout into position, trying not to over tighten it in order to have the spout in the desired vertical position.
8. Do not use the spout as a lever when tightening.

Washing Machine Set



1. Place a generous amount of thread seal tape lightly around the existing 1/2" threaded nipple in the wall prior to installing the washing machine cocks.
2. Place the chrome back plate over the nipple, then screw the washing machine cocks into position until tight. Use a shifter to gently tighten the bodies into the correct vertical position.
3. Install the handles by slotting them onto the spindle. Ensure the levers are lined up with the Hot handle facing 9 O'clock and the Cold handle facing 3 O'clock, as shown in the image above.
4. Using the provided Allen key, tighten the grub screw in the handle into the spindle, thus securing the handles. Refer to figure (i).
5. Check for leaks.

Figure (i)

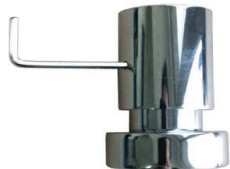

Using the provided Allen key, locate the grub screw through the hole in the back of the handles and tighten it into the spindle, thus securing the handles.

WORKING SPECIFICATIONS

In accordance with Australian standards requirements it is recommended that all tapware be installed by a licensed plumber.

Please refer to the warranty card for service agreement.

- Hot and cold water inlet pressures should be equal.

Inlet pressure range: 150-500kPa.

Pressure limiting valves should be installed where water pressure exceeds 500kPa.

NOTE - New Regulation: 500kPa maximum operating pressure at any outlet within a building.

(Refer AS/NZS 3500.1-2015, Clause 3.3.4)

- All pipework must be thoroughly flushed prior to installation, as foreign materials may block the flow regulating device and reduce the flow of water. Aerator insert housing must be re-tightened to prevent removal by hand.
- This tap set has a low flow rate and may not be suitable for connection to some Instantaneous Gas Water Heaters, some Tempering Valves, some Solar Water Heaters & some Thermostatic Mixing Valves. Check with the manufacturer of these products.
- Not recommended for gravity feed systems, tank water systems or bore water systems.
- Isolating stop taps must be fitted to the hot and cold water supply connections in accordance with local authority installation codes.

CARING FOR YOUR PRODUCT

- Under no circumstances should you install tapware using acetone silicones.
- Never use harsh detergents or abrasive cleaners, as these will scratch the surface. Using a soft dry cloth or a soft cloth with warm soapy water is recommended.
- Where your tapware remains dry in use, a soft cloth can be used to remove surface dust. Alternatively, a wipe over with warm soapy water is all that is required to maintain the finish in perfect condition for a lifetime of use.
- Use of wax based furniture cream should be avoided as these can result in a build up of deposits, which could detract from the appearance.
- Do not use undue pressure and wipe in one direction only.