

Buildashed Specifications

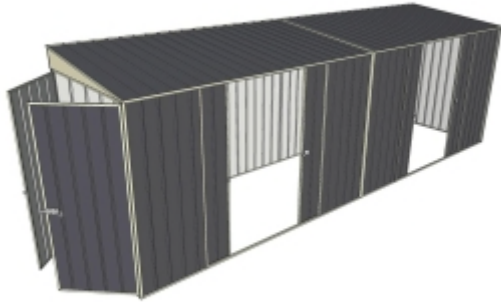

Color	Colorbond Equivalent*	Bunnings I/N
Grey	Monument	0378284
Green	Pale Eucalypt	3317657
Cream	Paperbark	3317658
Zinc	Galvanized Steel	3317659

Equivalent color names listed are Trademarks of Bluescope Steel Limited and are only used for comparison. The use of color names indicates no more than color equivalency.

Model	S15H260S22S26
Roof type	Skillion
Exterior dimension	1510mm x 5980mm
Interior dimension	1440mm x 5940mm
Height @ wall	1900mm
Height @ ridge	2100mm
Primary door type	Double Hinged
Primary door height	1845mm
Primary door opening	1430mm
Secondary door type	Dual Double Sliding
Secondary door height	1870mm
Secondary door opening	1440 + 1440mm
Area	9.03sq mt
Slab size	1635mm x 6105mm x 100mm

Floor Plan

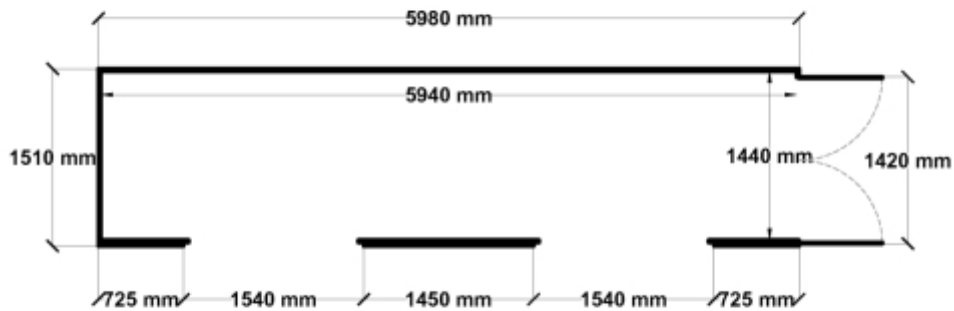

Features

- 1.9m wall height for more head room
- All holes pre-drilled for easy assembly
- Mid-wall frame for extra strength
- Your shed will arrive in 9 boxes, with no box greater than 25kg
- Easy to follow video enhanced instructions.

Anchor brackets and masonry bolts are supplied with this shed.

Heavy duty door channel protector ramps are supplied with this shed.

All measurements listed have a tolerance of +/- 10mm

