

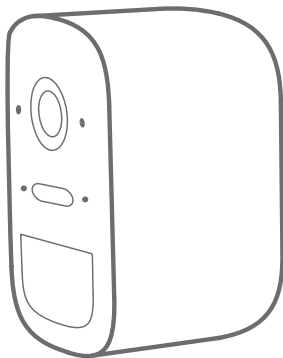

QUICK START GUIDE

eufyCam 2C Pro

WIRE-FREE HD SECURITY CAMERA



Anker Innovations Limited. All rights reserved. eufy Security and eufy Security Logo are trademarks of Anker Innovations Limited, registered in the United States and other countries. All other trademarks are the property of their respective owners.

TABLE OF CONTENTS

What's Included **01** | **04** Mounting the Camera

Product Overview **02** | **08** Charging eufyCam 2C Pro

Adding eufyCam 2C Pro **03** | **09** Safety Statement

I / WHAT'S INCLUDED

For eufyCam 2C Pro Installation



eufyCam 2C Pro
(T8142)



Mounting
Bracket



Micro-USB
Charging Cable



Mounting Screws
and Anchors

2 / PRODUCT OVERVIEW

eufyCam 2C Pro

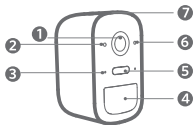

1. Lens
2. Light sensor
3. Microphone
4. Motion sensor
5. Spotlight
6. Status LED
7. SYNC button

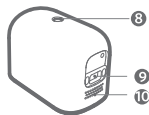

8. Mounting hole
9. Charging port
10. Speaker

3 / ADDING EUFYCAM 2C PRO

Add eufyCam 2C Pro to Your Existing System

On Eufy Security app, follow the onscreen instructions to add your eufy Security devices. Choose **Add Device**, then select eufyCam 2C Pro to add it to your system.

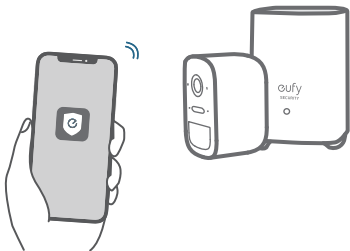

4 / MOUNTING THE CAMERA

Find a Good Mounting Spot

To find a spot to mount eufyCam 2C Pro, you need to test wireless signal strength.

- ① Open the eufy Security app, go to **Camera Settings > Mounting Guide**.
- ② To test the wireless signal strength, take your camera and phone to the location where you want to mount the camera.
- ③ Move the camera as close to your HomeBase as possible if the wireless signal strength is poor.

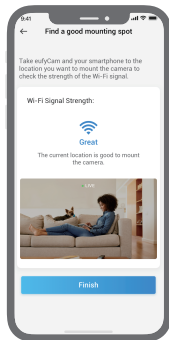

Select Height and Location

Hang eufyCam 2C Pro 7-10 ft (2-3 m) above the ground. This height maximizes the detection range of the motion sensor of eufyCam 2C Pro. Avoid placing eufyCam 2C Pro under direct sunlight.

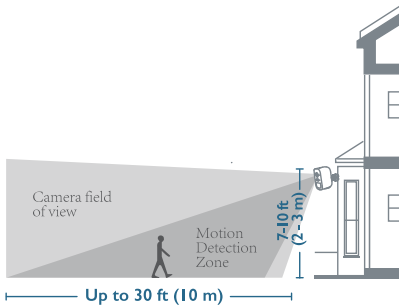

Mount the Camera

The eufyCam 2C Pro can be mounted both indoors and outdoors.

1. Turn the knob of the mounting bracket clockwise to loosen and disassemble it.

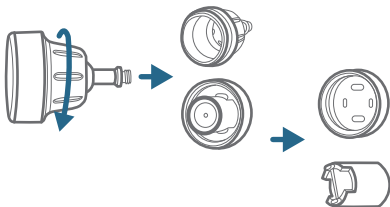

2. Drill holes with a 15/64 inch (5.95mm) drill bit, then insert the anchors into the holes; anchors are necessary for walls that are made out of hard materials such as concrete, brick, or stucco.

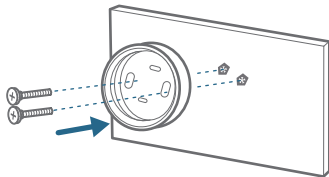

Mount the Camera

3. Firmly screw the base of the mounting bracket onto the wall. Fasten the ball knob of the bracket to the base of the bracket.

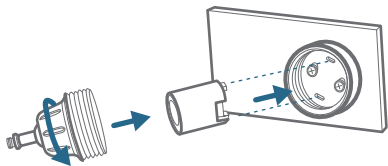

4. Tighten eufyCam 2C Pro to the mounting bracket and adjust the viewing angle by checking the live stream feed in the eufy Security app.

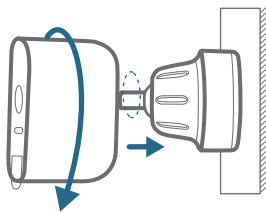

5 / CHARGING

EUFYCAM 2C PRO

Charge eufyCam 2C Pro

Method 1

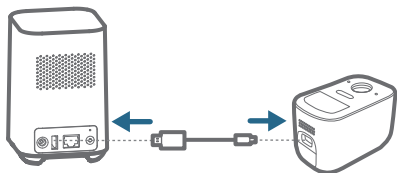

Method 2

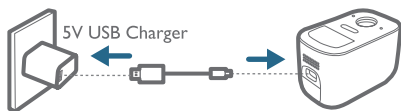

LED indication	Charging: Steady blue
	Fully charged: Off
Charging time	5 hours

6/ NOTICE

FCC Statement

This device complies with Part 15 of the FCC Rules. Operation is subject to the following two conditions: (1) this device may not cause harmful interference, and (2) this device must accept any interference received, including interference that may cause undesired operation.

Warning: Changes or modifications not expressly approved by the party responsible for compliance could void the user's authority to operate the equipment.

Note: This equipment has been tested and found to comply with the limits for a Class B digital device, pursuant to Part 15 of the FCC Rules. These limits are designed to provide reasonable protection against harmful interference in a residential installation.

This equipment generates uses and can radiate radio frequency energy and, if not installed and used in accordance with the instructions, may cause harmful interference to radio communications. However, there is no guarantee that interference will not occur in a particular installation. If this equipment does cause harmful interference to radio or television reception, which can be determined by turning the equipment off and on, the user is encouraged to try to correct the interference by one or more of the following measures: (1) Reorient or relocate the receiving antenna. (2) Increase the separation between the equipment and receiver. (3) Connect the equipment into an outlet on a circuit different from that to which the receiver is connected. (4) Consult the dealer or an experienced radio/TV technician for help.

FCC Radio Frequency Exposure Statement

The device has been evaluated to meet general RF exposure requirements. The device can be used in fixed/mobile exposure condition. The min separation distance is 20cm.

09

Notice: Shielded cables

All connections to other computing devices must be made using shielded cables to maintain compliance with FCC regulations.

The following importer is the responsible party
Company Name: POWER MOBILE LIFE, LLC
Address: 400 108th Ave NE Ste 400, Bellevue, WA
98004-5541
Telephone: 1-800-988-7973

CE This product complies with the radio interference requirements of the European Community.

Declaration of Conformity

Hereby, Anker Innovations Limited declares that this device is in compliance with the essential requirements and other relevant provisions of Directive 2014/53/EU. For the declaration of conformity, visit the Web site www.eufylife.com

Do not use the Device in the environment at too high or too low temperature, never expose the Device under strong sunshine or too wet environment.

The suitable temperature for eufyCam 2C Pro and accessories is -20°C-50°C.

When charging, please place the device in an environment that has a normal room temperature and good ventilation. It is recommended to charge the device in an environment with a temperature that ranges from 5°C~25°C.

RF exposure information: The Maximum Permissible Exposure (MPE) level has been calculated based on a distance of d=20 cm between the device and the human body. To maintain compliance with RF exposure requirement, use product that maintain a 20cm distance between the device and human body.

CAUTION RISK OF EXPLOSION IF BATTERY IS REPLACED BY AN INCORRECT TYPE. DISPOSE OF USED BATTERIES ACCORDING TO THE INSTRUCTIONS.

Wi-Fi Operating Frequency Range:2412~2472MHz ;Wi-Fi
Max Output Power:17.9 dBm

The following importer is the responsible party (contact
for EU matters only)

Importer: Anker Technology (UK) Ltd

Importer Address: Suite B, Fairgate House, 205 Kings Road,
Tyseley, Birmingham, B11 2AA, United Kingdom



This product is designed and manufactured with
high quality materials and components, which can be
recycled and reused.



This symbol means the product must not be
discarded as household waste, and should be delivered to
an appropriate collection facility for recycling. Proper
disposal and recycling helps protect natural resources,
human health and the environment. For more information
on disposal and recycling of this product, contact your local
municipality, disposal service, or the shop where you
bought this product.

IC Statement

This device complies with Industry Canada licence-exempt
RSS standard(s). Operation is subject to the following two
conditions:

- (1) this device may not cause interference, and
- (2) this device must accept any interference, including
interference that may cause undesired operation of the
device."

Le présent appareil est conforme aux CNR d'Industrie
Canada applicables aux appareils radio exempts de licence.

L'exploitation est autorisée aux deux conditions suivantes:

- (1) l'appareil n' doit pas produire de brouillage, et
- (2) l'utilisateur de l'appareil doit accepter tout brouillage
radioélectrique subi, même si le brouillage est susceptible
d'en compromettre le fonctionnement."

This Class B digital apparatus complies with Canadian
ICES-003.

Cet appareil numérique de la classe B est conforme à la
norme NMB-003 du Canada.

IC RF Statement:

When using the product, maintain a distance of 20 cm
from the body to ensure compliance with RF exposure
requirements.

Lors de l'utilisation du produit, maintenez une distance de
20 cm du corps afin de vous conformer aux exigences en
matière d'exposition RF.

Customer Service

Warranty

12-month limited warranty

Call Us

United States

+1 (800) 988 7973 Mon-Fri 9AM-5PM (PT)

United Kingdom

+44 (0) 1604 936 200 Mon-Fri 6AM-11AM (GMT)

Germany

+49 (0) 69 9579 7960 Mon-Fri 6:00-11:00

Email Us

Customer Support: support@eufylife.com

Anker Innovations Limited

Room 1318-19, Hollywood Plaza, 610 Nathan Road,
Mongkok, Kowloon, Hong Kong

 @EufyOfficial

 @EufyOfficial

 @EufyOfficial

