

6. TROUBLESHOOTING

WARNING! ENSURE THE TOOL IS SWITCHED OFF AND THE BATTERY IS REMOVED BEFORE PERFORMING ANY OF THE FOLLOWING TASKS.

WARNING! ALWAYS WEAR PROTECTIVE EQUIPMENT WHEN REMOVING JAMMED NAILS."

Jammed Nail

1. Open the jam release latch to check for any jammed nails inside.

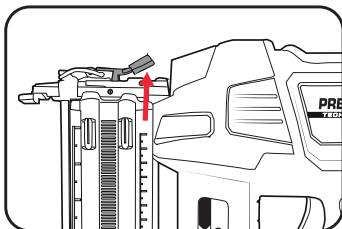

2. Open the jam release latch. (1) Using a pair of pliers, carefully remove any jammed nails. (2)

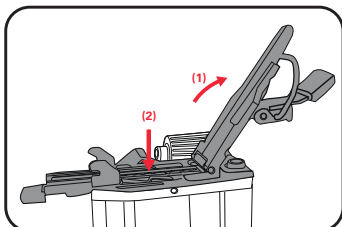

3. Check for any jammed nails in the magazine.

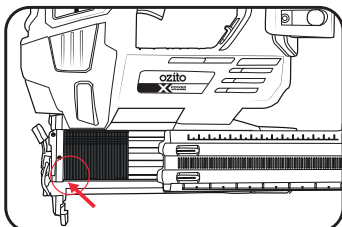

WARNING! THIS JAM RELEASE LATCH SHOULD 'CLICK' SHUT SECURELY BEFORE USE TO PREVENT ACCIDENTAL MISFIRING.

Short Battery Runtime

Ensure the battery is properly charged. It will take 4-5 charging cycles before the battery reaches optimum charge and run time.

MAINTENANCE

WARNING! BEFORE CLEANING OR CARRYING OUT ANY MAINTENANCE PROCEDURE, ENSURE THAT THE BATTERIES HAVE BEEN REMOVED.

Cleaning

- Keep the ventilation slots of the tool clean at all times to ensure efficient operation.
- After each use, blow air through the tool housing to ensure it is free from all dust, dirt, etc. Build up of dust or dirt particles may cause the tool to overheat and shorten the life of the tool.
- If the housing of the tool requires cleaning, do not use solvents. Use of a cloth only is recommended.
- Never allow any liquid to get inside the tool, never immerse any part of the tool into liquid.

Storage

When not in use, the tool should be stored in a dry, frost free location, keep out of children's reach.

Note: Ozito Industries will not be responsible for any damage or injuries caused by repair of the tool by an unauthorised person or by mishandling.

DESCRIPTION OF SYMBOLS

V	Volts	mm	Millimeters
	Direct Current		Warning
/min	Revolutions or reciprocations per minute		Regulatory Compliance Mark (RCM)
	Wear eye & ear protection	Ah	Ampere Hour
	Read Instruction Manual		

CARING FOR THE ENVIRONMENT



Power tools that are no longer usable should not be disposed of with household waste but in an environmentally friendly way. Please recycle where facilities exist. Check with your local council authority for recycling advice.



Recycling packaging reduces the need for landfill and raw materials. Reuse of recycled material decreases pollution in the environment. Please recycle packaging where facilities exist. Check with your local council authority for recycling advice.

SPARE PARTS

Spare parts can be ordered from the Special Orders Desk at your local Bunnings Warehouse.

For further information, or any parts not listed here, visit www.ozito.com.au or contact Ozito Customer Service:

Australia 1800 069 486

New Zealand 0508 069 486

E-mail: enquiries@ozito.com.au



ELECTRICAL SAFETY



WARNING! When using electric tools basic safety precautions should always be followed to reduce the risk of fire, electric shock and personal injury.

- Read the whole manual carefully and make sure you know how to switch the tool off in an emergency, before operating the tool. Save these instructions and other documents supplied with this tool for future reference.
- This appliance is not intended for use by persons (including children) with reduced physical, sensory or mental capabilities, or lack of experience and knowledge, unless they have been given supervision or instruction concerning use of the appliance by a person responsible for their safety. Children should be supervised to ensure that they do not play with the appliance.
- This appliance is compatible and only to be used with all batteries & chargers from the Ozito PXC range. Refer to the PXC battery and charger manuals for information regarding charging, use and storage.

- **WARNING!** Always remove the battery from the tool:
 - when the batteries are to be charged,
 - when the tool is left unattended,
 - when the tool is being checked, cleaned, or having maintenance work done,
 - when the tool is to be stored,
 - or if the tool vibrates abnormally.
- Do not combine different types of batteries or new and used batteries.
- Do not use modified or damaged batteries.



GENERAL POWER TOOL SAFETY WARNINGS



WARNING! Read all safety warnings, instructions, illustrations and specifications provided with this power tool. Failure to follow all instructions listed below may result in electric shock, fire and/or serious injury.

Save all warnings and instructions for future reference.

The term "power tool" in the warnings refers to your mains-operated (corded) power tool or battery-operated (cordless) power tool.

1) Work area safety

- a) **Keep work area clean and well lit.** Cluttered or dark areas invite accidents.
- b) **Do not operate power tools in explosive atmospheres, such as in the presence of flammable liquids, gases or dust.** Power tools create sparks which may ignite the dust or fumes.
- c) **Keep children and bystanders away while operating a power tool.** Distractions can cause you to lose control.

2) Electrical safety

- a) **Power tool plugs must match the outlet. Never modify the plug in any way. Do not use any adapter plugs with earthed (grounded) power tools.** Unmodified plugs and matching outlets will reduce risk of electric shock.
- b) **Avoid body contact with earthed or grounded surfaces, such as pipes, radiators, ranges and refrigerators.** There is an increased risk of electric shock if your body is earthed or grounded.
- c) **Do not expose power tools to rain or wet conditions.** Water entering a power tool will increase the risk of electric shock.
- d) **Do not abuse the cord. Never use the cord for carrying, pulling or unplugging the power tool. Keep cord away from heat, oil, sharp edges or moving parts.** Damaged or entangled cords increase the risk of electric shock.
- e) **When operating a power tool outdoors, use an extension cord suitable for outdoor use.** Use of a cord suitable for outdoor use reduces the risk of electric shock.
- f) **If operating a power tool in a damp location is unavoidable, use a residual current device (RCD) protected supply.** Use of an RCD reduces the risk of electric shock.

3) Personal safety

- a) **Stay alert, watch what you are doing and use common sense when operating a power tool. Do not use a power tool while you are tired or under the influence of drugs, alcohol or medication.** A moment of inattention while operating power tools may result in serious personal injury.
- b) **Use personal protective equipment. Always wear eye protection.** Protective equipment such as a dust mask, non-skid safety shoes, hard hat or hearing protection used for appropriate conditions will reduce personal injuries.
- c) **Prevent unintentional starting. Ensure the switch is in the off-position before connecting to power source and/or battery pack, picking up or carrying the tool.** Carrying power tools with your finger on the switch or energising power tools that have the switch on invites accidents.
- d) **Remove any adjusting key or wrench before turning the power tool on.** A wrench or a key left attached to a rotating part of the power tool may result in personal injury.
- e) **Do not overreach. Keep proper footing and balance at all times.** This enables better control of the power tool in unexpected situations.
- f) **Dress properly. Do not wear loose clothing or jewellery. Keep your hair and clothing away from moving parts.** Loose clothes, jewellery or long hair can be caught in moving parts.
- g) **If devices are provided for the connection of dust extraction and collection facilities, ensure these are connected and properly used.** Use of dust collection can reduce dust-related hazards.
- h) **Do not let familiarity gained from frequent use of tools allow you to become complacent and**

ignore tool safety principles. A careless action can cause severe injury within a fraction of a second.

4) Power tool use and care

- a) **Do not force the power tool. Use the correct power tool for your application.** The correct power tool will do the job better and safer at the rate for which it was designed.
- b) **Do not use the power tool if the switch does not turn it on and off.** Any power tool that cannot be controlled with the switch is dangerous and must be repaired.
- c) **Disconnect the plug from the power source and/or remove the battery pack, if detachable, from the power tool before making any adjustments, changing accessories, or storing power tools.** Such preventive safety measures reduce the risk of starting the power tool accidentally.
- d) **Store idle power tools out of the reach of children and do not allow persons unfamiliar with the power tool or these instructions to operate the power tool.** Power tools are dangerous in the hands of untrained users.
- e) **Maintain power tools and accessories. Check for misalignment or binding of moving parts, breakage of parts and any other condition that may affect the power tool's operation. If damaged, have the power tool repaired before use.** Many accidents are caused by poorly maintained power tools.
- f) **Keep cutting tools sharp and clean.** Properly maintained cutting tools with sharp cutting edges are less likely to bind and are easier to control.
- g) **Use the power tool, accessories and tool bits etc. in accordance with these instructions, taking into account the working conditions and the work to be performed.** Use of the power tool for operations different from those intended could result in a hazardous situation.
- h) **Keep handles and grasping surfaces dry, clean and free from oil and grease.** Slippery handles and grasping surfaces do not allow for safe handling and control of the tool in unexpected situations.

5) Battery tool use and care

- a) **Recharge only with the charger specified by the manufacturer.** A charger that is suitable for one type of battery pack may create a risk of fire when used with another battery pack.
- b) **Use power tools only with specifically designated battery packs.** Use of any other battery packs may create a risk of injury and fire.
- c) **When battery pack is not in use, keep it away from other metal objects, like paper clips, coins, keys, nails, screws or other small metal objects, that can make a connection from one terminal to another.** Shorting the battery terminals together may cause burns or a fire.
- d) **Under abusive conditions, liquid may be ejected from the battery; avoid contact. If contact accidentally occurs, flush with water. If liquid contacts eyes, additionally seek medical help.** Liquid ejected from the battery may cause irritation or burns.
- e) **Do not use a battery pack or tool that is damaged or modified.** Damaged or modified batteries may exhibit unpredictable behaviour resulting in fire, explosion or risk of injury.
- f) **Do not expose a battery pack or tool to fire or excessive temperature.** Exposure to fire or temperature above 130 °C may cause explosion.
- g) **Follow all charging instructions and do not charge the battery pack or tool outside the temperature range specified in the instructions.** Charging improperly or at temperatures outside the specified range may damage the battery and increase the risk of fire.

6) Service

- a) **Have your power tool serviced by a qualified repair person using only identical replacement parts.** This will ensure that the safety of the power tool is maintained.
- b) **Never service damaged battery packs.** Service of battery packs should only be performed by the manufacturer or authorized service providers.



18GA BRAD FINISHING NAILER SAFETY WARNINGS



WARNING! This appliance is not intended for use by persons (including children) with reduced physical, sensory or mental capabilities, or lack of experience and knowledge, unless they have been given supervision or instruction concerning use of the appliance by a person responsible for their safety.

- Avoid using power tools for long periods of time without breaks. Vibration from tools can be transmitted into your hands and arms.
- Where possible, use clamps or a vice to hold the workpiece. It is safer than using your hand.
- Always assume that the tool contains fasteners. Careless handling of the nailer can result in unexpected firing of fasteners and personal injury.
- Do not point the tool towards yourself or anyone nearby. Unexpected triggering will discharge the fastener causing an injury.
- Do not actuate the tool unless the tool is placed firmly against the workpiece. If the tool is not in contact with the workpiece, the fastener may be deflected away from your target.

- Disconnect the tool from the power source when the fastener jams in the tool. While removing a jammed fastener, the nailer may be accidentally activated if it is plugged in.
- Use caution while removing a jammed fastener. The mechanism may be under compression and the fastener may be forcefully discharged while attempting to free a jammed condition.
- Do not use this nailer for fastening electrical cables. It is not designed for electric cable installation and may damage the insulation of electric cables thereby causing electric shock or fire hazards.
- Always use both hands to operate the tool. Your secondary hand should be used to press the back of the tool firmly down onto the surface to be fastened.
- Do not point the LED into the eyes of humans or animals.



18V CORDLESS

18GA BRAD FINISHING NAILER

INSTRUCTION MANUAL

SPECIFICATIONS

Input:	18V
Firing Rate:	60/min
Magazine Capacity:	100 x C1 Brad Nails
Nail Size:	18 Gauge 15-50mm
Weight:	2.8kg

ozito.com.au

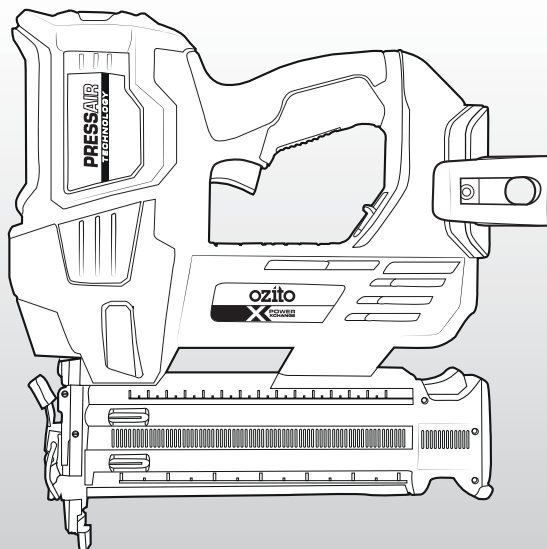

STANDARD EQUIPMENT

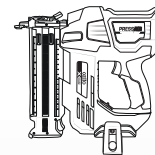

Cordless 18GA Brad Finishing Nailer



500 x 50mm 18 Gauge C1 Brad Nails

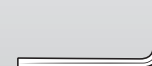

Hex Key



Belt Clip

PXNGS-218

5 YEAR
REPLACEMENT WARRANTY

WARRANTY

IN ORDER TO MAKE A CLAIM UNDER THIS WARRANTY YOU MUST RETURN THE PRODUCT TO YOUR NEAREST BUNNINGS WAREHOUSE WITH YOUR BUNNINGS REGISTER RECEIPT. PRIOR TO RETURNING YOUR PRODUCT FOR WARRANTY PLEASE TELEPHONE OUR CUSTOMER SERVICE HELPLINE:

Australia 1800 069 486

New Zealand 0508 069 486

TO ENSURE A SPEEDY RESPONSE PLEASE HAVE THE MODEL NUMBER AND DATE OF PURCHASE AVAILABLE. A CUSTOMER SERVICE REPRESENTATIVE WILL TAKE YOUR CALL AND ANSWER ANY QUESTIONS YOU MAY HAVE RELATING TO THE WARRANTY POLICY OR PROCEDURE.

WARNING

The following actions will result in the warranty being void.

- If the tool has been operated on a supply voltage other than that specified on the tool.
- If the tool shows signs of damage or defects caused by or resulting from abuse, accidents or alterations.
- Failure to perform maintenance as set out within the instruction manual.
- If the tool is disassembled or tampered with in any way.

The benefits provided under this warranty are in addition to other rights and remedies which are available to you at law.

Our goods come with guarantees that cannot be excluded at law. You are entitled to a replacement or refund for a major failure and for compensation for any other reasonably foreseeable loss or damage. You are also entitled to have the goods repaired or replaced if the goods fail to be of acceptable quality and the failure does not amount to a major failure.

Generally you will be responsible for all costs associated with a claim under this warranty, however, where you have suffered any additional direct loss as a result of a defective product you may be able to claim such expenses by contacting our customer service helpline above.

5 YEAR REPLACEMENT WARRANTY

Your Product is guaranteed for a period of 60 months from the original date of purchase and is intended for DIY (Do It Yourself) use only. If a product is defective it will be replaced in accordance with the terms of this warranty. **Lithium Ion batteries and chargers are covered by a 36 month warranty** and are excluded from the warranty extension. Warranty excludes consumable parts.

KNOW YOUR PRODUCT

CORDLESS 18GA BRAD FINISHING NAILER

- | | |
|--------------------------------|--------------------------------|
| 1. Fire Trigger | 8. Nail Level Indicator |
| 2. Sure Grip Handle | 9. LED Worklight |
| 3. Battery Seating | 10. Safety Striker Cap |
| 4. Belt Clip | 11. Jam Release Latch |
| 5. Magazine Release | 12. Depth Adjustment Dial |
| 6. Nail Magazine | 13. Safety Striker Cap (extra) |
| 7. Fire Type Adjustment Switch | |

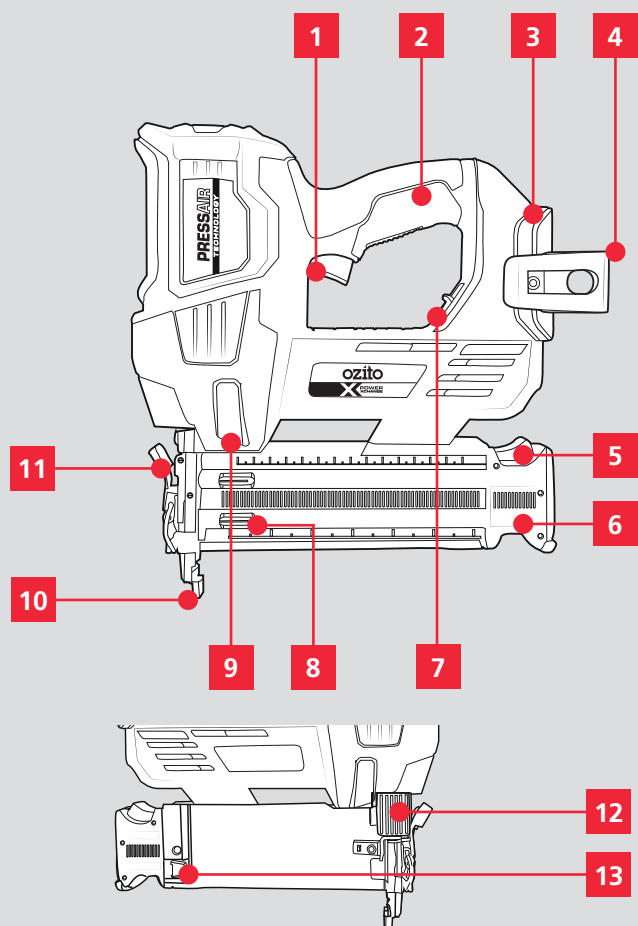

BATTERY & CHARGER

This tool is compatible with all batteries & chargers from the Ozito PXC range.

ONLINE MANUAL

Scan this QR Code with your mobile device to take you to the online manual.



SETUP & PREPARATION

1. FITTING THE BATTERY

Installing The Battery Pack

1. Slide the battery into the battery seating until it clicks into place.

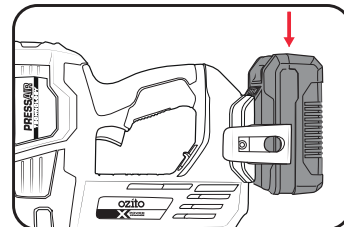

Removing The Battery Pack

1. Hold down the battery release button and then slide the battery out.

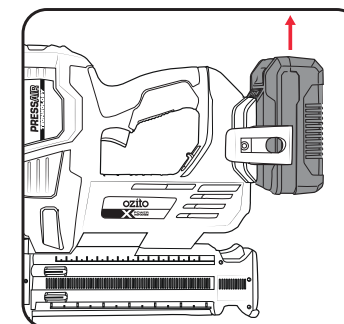
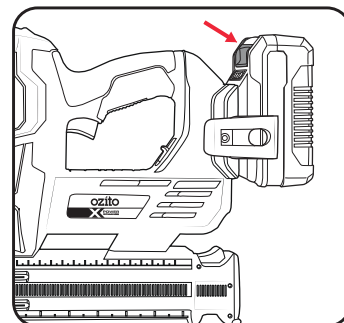

5 YEAR
REPLACEMENT WARRANTY

2. NAIL SELECTION

Selecting Nails

Accessories to suit this Staple Nail Gun can be purchased from Bunnings Warehouse.

Fastener	Common Applications
C1 Brad Nails	Trim Moulding, Panelling, Picture Frames, Model Work, Any Finish Nailing Application.

Nail Measurements

This tool accepts C1 Brad nails upto:

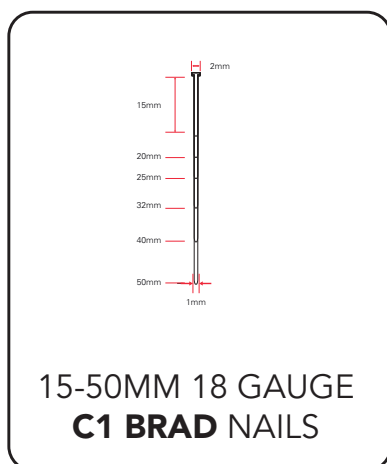

Note: These nail measurements are to scale, allowing you to measure the nail, ensuring the correct nail size is used. This is also positioned on the tool.

3. LOADING THE CARTRIDGE



WARNING! ENSURE THE TOOL IS SWITCHED OFF AND THE BATTERY IS REMOVED BEFORE PERFORMING ANY OF THE FOLLOWING TASKS.

Loading Nails

This staple nailer only accepts 15-50mm 18 gauge C1 Brad nails. Other types of nails could jam the unit. For best results, load a full row of nails before use.

1. Press the cartridge latch down and pull the magazine slider out of the tool.

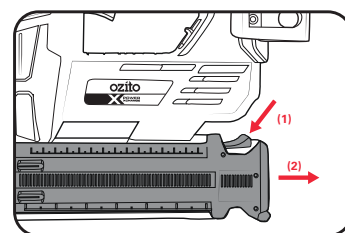

Note: Make sure the jam release latch is closed at all times except when troubleshooting.

2. Insert a row of nails into the opening behind the nose piece. Be sure to align them to the lower left corner of the cartridge.

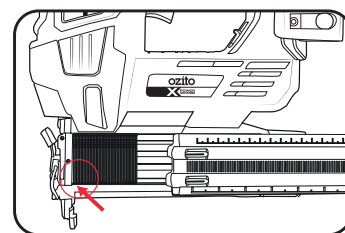

Note: Ensure nails are positioned correctly in the cartridge and not misaligned or inserted upside down.

3. Push the loaded magazine back into the unit until it clips into place.

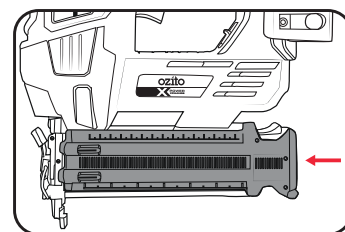

OPERATION

4. CONTROLS



WARNING! ALWAYS USE BOTH HANDS WHEN USING THE TOOL.

Firing A Nail

The Safety Striker System is a two step process where a staple or nail will only fire when the safety striker tip is pushed against the material to be fastened.

1. Push down on the back of the tool to press the safety striker guard and nose piece down onto the worksurface to be fastened.
2. To fire the staple nail gun, squeeze the on/off trigger.

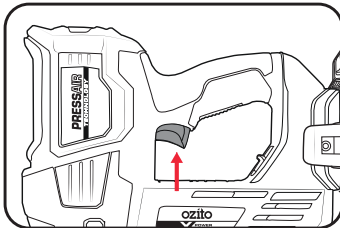
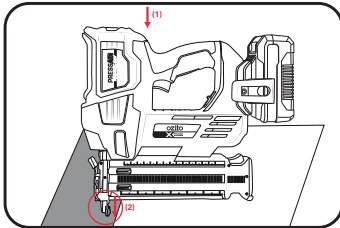

Note: Nails will be discharged off centre, to the right side of the nail gun. Test fire on scrap piece of wood to get the exact placement of the nail relative to the gun before use.

Note: The LED Worklight glows when you press the On/Off Trigger and the battery is attached to the tool.

Nail Firing Force Adjustment

Some jobs require a lighter touch than others; reducing the force that staples or nails are fired at reduces the chance of damaging thinner more delicate surfaces.

Note: Always test the setting on a piece of scrap material after making any adjustments.

1. To adjust the force of the nail gun, turn the dial clockwise to increase the nail depth.

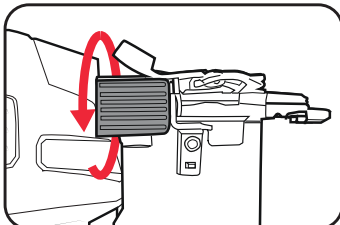

2. Turn the dial anti-clockwise to decrease the nail depth.

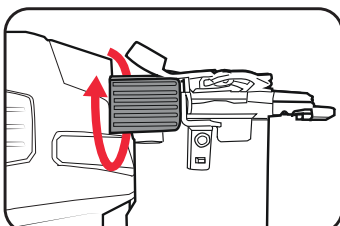

Note: If the nail is not fully penetrating into the workpiece, firmly hold down the nail gun with two hands while firing.

Selecting the Fire Type Adjustment Switch

The Fire Type Adjustment Switch helps to select the firing options between a single shot and continuous shots.

1. Push the switch upwards for a Single Shot adjustment. Place the Nail gun with its Safety Striker tip against the workpiece ready for nailing. Pull the trigger once and let it go again after each shot.

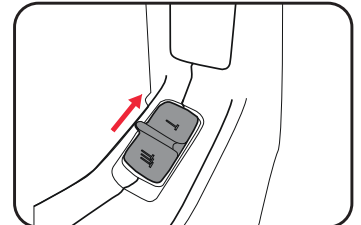

2. Push the switch downwards for a Continuous Shot adjustment. Pull and hold the trigger with its safety striker tip against the workpiece. It will now shoot every time the tip is depressed until the trigger is released.

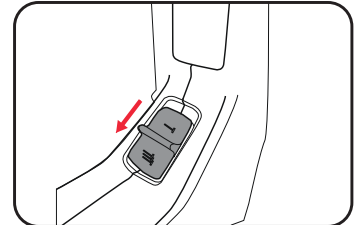

Note: To prevent the cordless nailer from overheating, it is suggested to allow the tool to rest for 20mins after approx 500 shots in continuous mode.

Note: Do not exceed a nail firing rate of 60 shots per minute. Thermal protection would be activated if the motor overheated.

Note: If the nail goes in too far you can adjust the depth of penetration with the depth adjustment dial