

ozito

POWER INVERTER

12V 300W

INSTRUCTION MANUAL

SPECIFICATIONS

Input Voltage:	12V DC
Output Voltage:	240V ~ 50Hz
Output Power:	300W
Peak Output Power:	600W (0.1s)
USB Output:	5V, 2A
Low Voltage Warning:	11V DC
Low Voltage Cut-off:	10.5V DC
Overload Cut-off:	15V DC
Operating Temp.:	0° to 40°C
Fuse:	40A
Battery Min. Capacity:	25Ah
Weight:	0.8kg

ozito.com.au

3 YEAR REPLACEMENT WARRANTY*

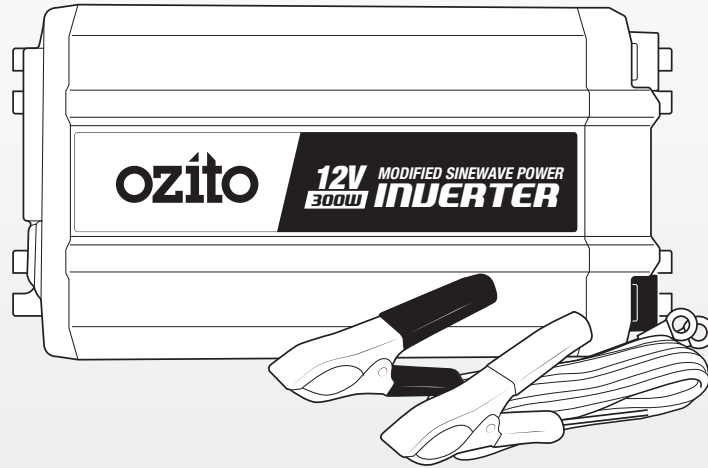

STANDARD EQUIPMENT



Power Inverter

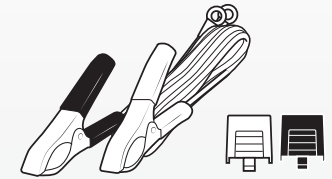

2 x Alligator Clamp Leads & 2 x Terminal Covers

PIM-300

WARRANTY

IN ORDER TO MAKE A CLAIM UNDER THIS WARRANTY YOU MUST RETURN THE PRODUCT TO YOUR NEAREST BUNNINGS WAREHOUSE WITH YOUR BUNNINGS REGISTER RECEIPT. PRIOR TO RETURNING YOUR PRODUCT FOR WARRANTY PLEASE TELEPHONE OUR CUSTOMER SERVICE HELPLINE:

Australia: 1800 069 486

New Zealand: 0508 069 486

TO ENSURE A SPEEDY RESPONSE PLEASE HAVE THE MODEL NUMBER AND DATE OF PURCHASE AVAILABLE. A CUSTOMER SERVICE REPRESENTATIVE WILL TAKE YOUR CALL AND ANSWER ANY QUESTIONS YOU MAY HAVE RELATING TO THE WARRANTY POLICY OR PROCEDURE.

The benefits provided under this warranty are in addition to other rights and remedies which are available to you at law.

Our goods come with guarantees that cannot be excluded at law. You are entitled to a replacement or refund for a major failure and for compensation for any other reasonably foreseeable loss or damage. You are also entitled to have the goods repaired or replaced if the goods fail to be of acceptable quality and the failure does not amount to a major failure.

Generally you will be responsible for all costs associated with a claim under this warranty, however, where you have suffered any additional direct loss as a result of a defective product you may be able to claim such expenses by contacting our customer service helpline above.

3 YEAR REPLACEMENT WARRANTY*

Your product is guaranteed for a period of **36 months from the original date of purchase**. If a product is defective it will be replaced in accordance with the terms of this warranty. Warranty excludes consumable parts, for example: valve adapters and accessories.

*This product is intended for DIY use only and replacement warranty covers domestic use.

WARNING

The following actions will result in the warranty being void.

- If the tool has been operated on a supply voltage other than that specified on the tool.
- If the tool shows signs of damage or defects caused by or resulting from abuse, accidents or alterations.
- Failure to perform maintenance as set out within the instruction manual.
- If the tool is disassembled or tampered with in any way.
- Professional, industrial or high frequency use.

KNOW YOUR PRODUCT

POWER INVERTER

- | | |
|-------------------|----------------------------|
| 1. AC Socket | 6. Positive Terminal Cover |
| 2. Power Switch | 7. Ring Connector |
| 3. Indicator LED | 8. Negative Terminal Cover |
| 4. USB Socket | 9. Positive (Red) Clamp |
| 5. Mounting Point | 10. Negative (Black) Clamp |

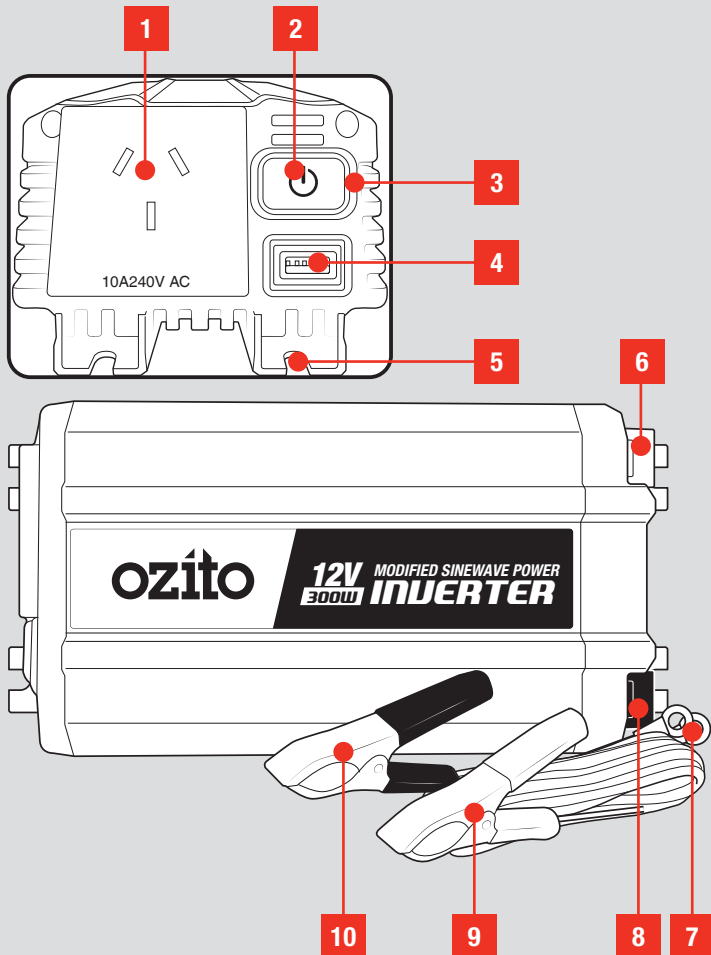

ONLINE MANUAL

Scan this QR Code with your mobile device to take you to the online manual.



3 YEAR REPLACEMENT WARRANTY*

SETUP & PREPARATION

1. ASSEMBLY



WARNING! ENSURE THE TOOL IS TURNED OFF AND DISCONNECTED FROM THE POWER SUPPLY BEFORE PERFORMING ANY OF THE FOLLOWING OPERATIONS.

Connecting The Leads

- Slide the black terminal cover over the ring end of the black connector lead.

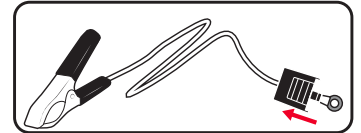

- Place a washer on the short bolt and then the ring connector on the end of the black lead.

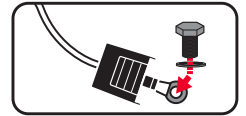

- Place the bolt through the negative terminal on the power inverter and use a nyloc nut to secure this in place.

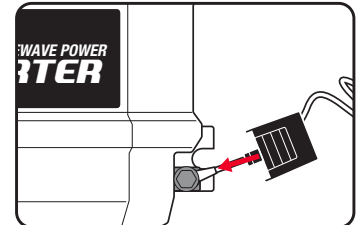

- Press the terminal cover into the slots on the inverter unit.

- Repeat steps 1-4 for the red connector lead and terminal cover.

Attaching The Unit To A Wall

You will need fasteners to suit the type of material you are mounting the power inverter to. The selected fasteners should be 5mm in diameter.

Use the supplied mounting template for easier installation. A digital copy of this can also be found on our website.

- Attach the mounting template to the work surface with masking tape.

Note: Ensure that the final position of the power inverter is close enough to still connect to the power source.

- Drill through the mounting points indicated on the template.

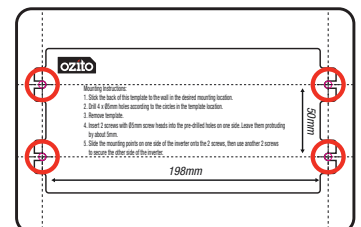

- Remove the template and use the fasteners to attach the power inverter at the mounting points.

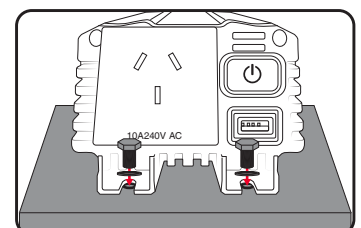

2. CONNECTING THE POWER INVERTER

WARNING! ALWAYS CONNECT THE CLAMPS TO THE POSITIVE BATTERY TERMINALS FIRST.

WARNING! ONLY USE WITH CLASS II EQUIPMENT.

WARNING! DO NOT INVERSE CONNECTOR POLARITIES! FAILURE TO DO SO WILL RESULT IN IRREVERSIBLE DAMAGE TO THE PRODUCT AND WILL VOID THE WARRANTY.

Connecting A Power Source

The power inverter can be connected to the 12V battery in your car. We recommend having the engine running to prevent the battery from running flat during use. Alternatively a standalone 12V battery may be used to power the power inverter.

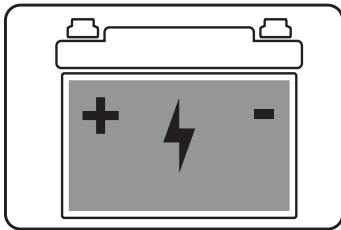

Before connecting the clamps, identify the positive (+) and negative (-) terminal on the battery. The positive terminal should be red and the negative terminal, black. Alternatively, if the terminals are not coloured, the positive terminal should be larger than the negative terminal.

Note: The power source must supply a minimum of 11V up to a maximum of 15V.

Follow the connection order labelled on the clamps.

WARNING! ENSURE THE CLAMPS DO NOT COME INTO CONTACT WITH EACH OTHER DURING USE. CONTACT BETWEEN LIVE CONNECTIONS MAY RESULT IN SPARKS, ELECTROCUTION, FIRE, SEVERE PERSONAL INJURY OR EVEN DEATH.

1. Ensure the leads are correctly installed on the power inverter.

2. Connect the **red (+)** clamp to the **positive terminal of the battery**.

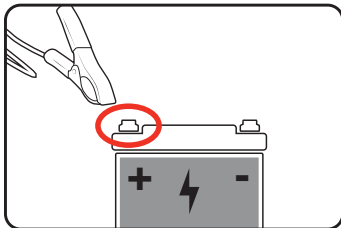

3. Connect the **black (-)** clamp to the **negative terminal of the battery**.

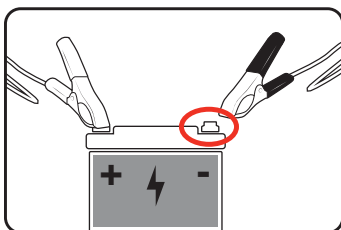

WARNING! DO NOT ALLOW THE CLAMPS TO CONTACT EACH OTHER OR DANGLE LOOSE IN THE ENGINE COMPARTMENT.

WARNING! ONLY GRASP CLAMPS BY THE INSULATED SURFACES.

WARNING! DO NOT INSERT FOREIGN OBJECTS INTO THE POWER INVERTER'S AC OUTLET, FAN OR VENT OPENINGS.

WARNING! THE POWER INVERTER GENERATES THE SAME POTENTIALLY LETHAL AC POWER AS A NORMAL HOUSEHOLD WALL OUTLET. TREAT IT AS YOU WOULD ANY OTHER AC OUTLET.

Connecting An Appliance

The power inverter generates a modified sinewave output. This is suitable for simple electronics, radios, fans and lights, or charging phones.

The power inverter has a continuous output of 300W. Check that the appliance you wish to connect does not require more power than this to operate.

1. Plug the power cord of the desired appliance into the AC output of the power inverter.

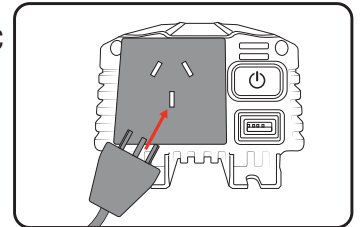

2. Alternatively, a standard USB-A cable (not supplied) can be connected to the USB port.

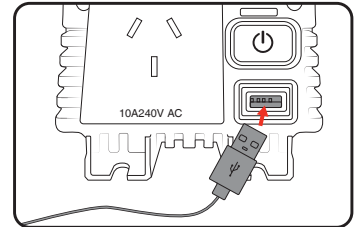

Note: An extension pack can be plugged into the AC outlet to power multiple devices as long as the combined power draw of all the connected devices does not exceed 300W.

OPERATION

3. CONTROLS

Switching The Power Inverter On & Off

1. Press the power button to switch the power inverter on.

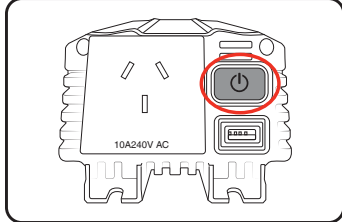

Note: The indicator LED will light up green.



2. Press the power button while the inverter is on to switch the unit off.

Indicator LED

The indicator LED will light up green when a suitable power source is connected.

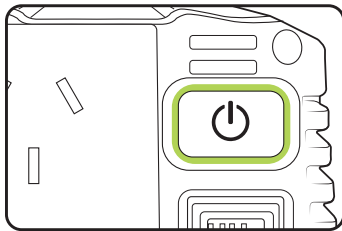

If the voltage supply of the power source drops below 10.5V or is above 15V, or there is an overload on the circuit, the indicator LED will light up red and the power inverter will automatically switch off.

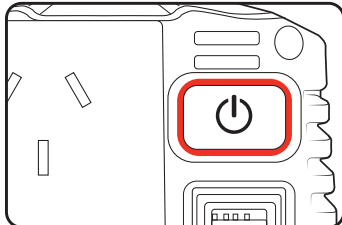

If the interior temperature of the power inverter exceeds 60°C, the unit will automatically shut off to protect the circuitry. If the thermal protection activates, switch off the power inverter and allow it to cool completely before restarting the unit.

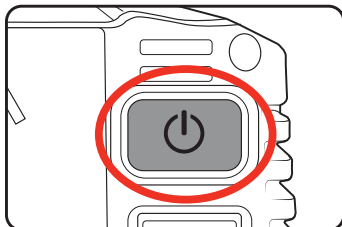

MAINTENANCE

6. APPLIANCE CARE



WARNING! BEFORE CLEANING THE APPLIANCE OR CARRYING OUT ANY MAINTENANCE PROCEDURE, MAKE SURE THAT IT IS DISCONNECTED FROM THE POWER SUPPLY TO PREVENT ACCIDENTAL STARTING.



WARNING! DO NOT WET THE METAL CONTACTS.



WARNING! MAKE SURE THAT THE CLAMPS ARE DISCONNECTED FROM THE POWER INVERTER BEFORE CLEANING.

Cleaning

1. Keep the safety devices free of dirt and dust as much as possible. Wipe the equipment with a clean cloth.
2. Clean the appliance regularly with a dry cloth. Do not use cleaning agents or solvents; these may be aggressive to the plastic parts in the appliance. Ensure that no water can get into the interior of the appliance.

Storage

Pull the mains plug out of the socket, switch off the tool and make sure that it is secured in such a way that it cannot be started up again by any unauthorised person.





Store the tool in a dry location which is not accessible to unauthorised persons.

Fuse

If replacement of the fuse is necessary, this has to be done by a certified electrician in order to avoid a safety hazard.

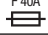
Note: Ozito Industries will not be responsible for any damage or injuries caused by the repair of the tool by an unauthorised person or by mishandling of the tool.

DESCRIPTION OF SYMBOLS

V	Volts	Hz	Hertz
~	Alternating Current	W	Watts
VA	Volt mperes	°C	degrees Celsius
IP20	Ingress protection rating	A	Amperes
— —	Direct Current	F 40A 	40A Fuse
	Regulatory Compliance Mark (RCM)		Warning
	Read Instruction Manual		

CARING FOR THE ENVIRONMENT



Power tools that are no longer usable should not be disposed of with household waste but in an environmentally friendly way. Please recycle where facilities exist. Check with your local council authority for recycling advice.



Recycling packaging reduces the need for landfill and raw materials. Reuse of recycled material decreases pollution in the environment. Please recycle packaging where facilities exist. Check with your local council authority for recycling advice.

SPARE PARTS

Spare parts can be ordered from the Special Orders Desk at your local Bunnings Warehouse.

For further information, or any parts not listed here, visit www.ozito.com.au or contact Ozito Customer Service:

Australia 1800 069 486

New Zealand 0508 069 486

E-mail: enquiries@ozito.com.au

ELECTRICAL SAFETY



WARNING! When using mains-powered tools, basic safety precautions, including the following, should always be followed to reduce risk of fire, electric shock, personal injury and material damage. Read the whole manual carefully and make sure you know how to switch the tool off in an emergency,

before operating the tool.

Save these instructions and other documents supplied with this tool for future reference.

POWER INVERTER SAFETY WARNINGS



The appliance is not to be used by persons (including children) with reduced physical, sensory or mental capabilities, or lack of experience and knowledge, unless they have been given supervision or instruction.

Young children should be supervised to ensure that they do not play with the appliance.

WARNING! Before connecting a tool to a power source (mains switch power point receptacle, outlet, etc.) be sure that the voltage supply is the same as that specified on the nameplate of the tool. A power source with a voltage greater than that specified for the tool can result in serious injury to the user, as well as damage to the tool. If in doubt, do not plug in the tool. Using a power source with a voltage less than the nameplate rating is harmful to the motor.

- The power inverter generates the same potentially lethal AC power as a normal household wall outlet. Treat it as you would any other AC outlet.
- Do not insert foreign objects in to the power inverter's AC outlet, fan or vent openings.
- For indoor use only. Do not expose the power inverter to water, rain, snow or spray.
- Do not under any circumstances, connect the power inverter to AC power.
- Do not use the power inverter in the presence of flammable fumes or gases, such as in the bilge of a petrol powered boat, or near a propane tank.
- Do not use the power inverter in an enclosure containing automotive-type, lead-acid batteries. These batteries, unlike sealed batteries, vent explosive hydrogen gas which can be ignited by sparks from an electrical connection.
- When working on electrical equipment always ensure someone is nearby to help you in an emergency.
- Do not connect live AC power to the power inverter's AC outlet. The power inverter will be damaged even if it is switched off.
- Do not place any objects on top of the power inverter.
- Do not expose to direct sunlight.
- Do not expose the power inverter to temperatures exceeding 40°C.

- Only operate the inverter in ambient temperatures between 0°C and 40°C.
- Do not expose the power inverter to large variations in temperature. This can damage the interior electronics.
- Keep away from surface heating vents or any other heat producing equipment.
- Ensure the area is well ventilated and allow at least 10cm of clearance on all sides of the unit for proper cooling.
- Do not operate the power inverter in dusty and/or dirty environments.
- Do not expose the power inverter to excessive shock and/or vibrations.
- Do not use the power inverter with small battery operated products such as rechargeable flashlights, some rechargeable shavers and night lights that are plugged directly into an AC receptacle to recharge.
- Do not use the power inverter with certain battery chargers for battery packs used in battery powered tools. These chargers will have warning labels stating that dangerous voltages are present at the charger's battery terminals.
- Do not disassemble or modify the power inverter.
- This inverter is a modified sinewave inverter. You should always check the appliance user manual to know whether a modified sinewave power inverter is compatible. If it is not stated in your appliance manual, please contact the manufacturer to seek advice on whether this inverter is suitable for your appliance. We are not responsible for damage to the appliance if a pure sinewave inverter should have been used.
- Do not reverse the polarity of the connections. The negative terminal of the inverter must be connected to the negative terminal of the supplying 12V source, and similarly for the positive terminals. Failure to do so will result in irreversible damage to the product and will void the warranty.
- Only replace the fuse with the same type and specification as the original (40A).
- Take note of any excessive temperature rise or unusual sounds during use. Continuous humming or high heat emission may indicate that the appliance is not suitable for use with this power inverted. Stop the inverter, disconnect it from the power source and discontinue use immediately.
- Only use the power inverter with Class II equipment.
- Do not use the power inverter in the immediate vicinity of strong magnetic fields, such as speakers.